



INSTALLATION INSTRUCTIONS

Accessory
HARD REAR PANEL
P/N 0SU95-HL3-102A (2P)
P/N 0SU95-HL3-102C
(4P-short roof)
P/N 0SU95-HL3-104C
(4P-extended roof)

Application

After '16
SXS700M2/M2D/M4/M4D

Publication No.
MII 15753
Issue Date
January 2017

Honda Dealer: Please give a copy of these instructions to your customer.

PARTS LIST

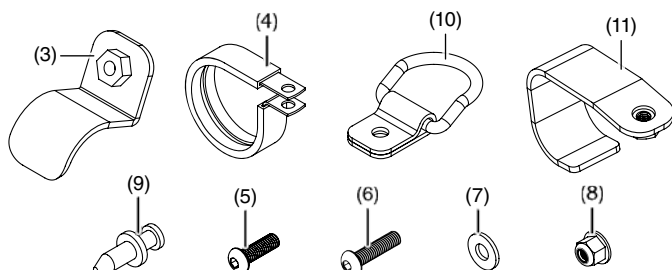
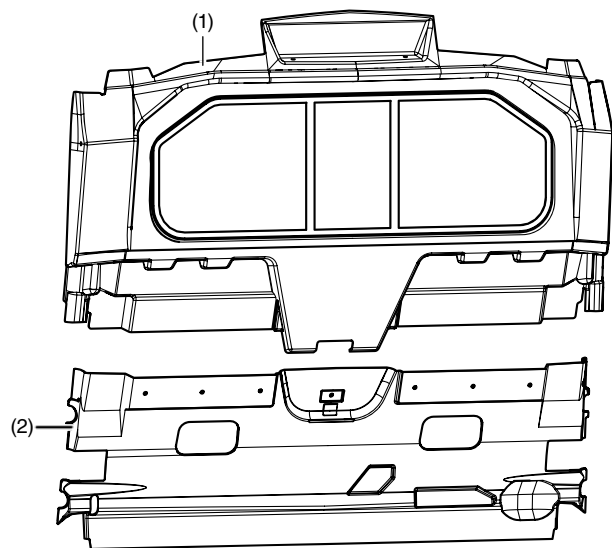

No.	Description	Qty.
(1)	Upper panel	1
(2)	Lower panel	1
(3)	Hook	1
(4)	Clamp	2
(5)	Screw, 6 x 20 mm	2
(6)	Screw, 6 x 25 mm	4
(7)	Flat washer	6
(8)	Nut	2
(9)	Trim clip	6
(10)	Tie-down ring	2
(11)	J-hook bracket	2

TOOLS AND SUPPLIES REQUIRED

Hex wrench (4 mm)
Wrench (10 mm)
Torque wrench
Drill bit (5/16 inch)
Power drill

TORQUE CHART

Tighten all screws, bolts, and nuts to their specified torque values. Refer to the Service Manual for the torque values of the removed parts.

Item	N-m	kgf-m	lbf-ft
Screw	6.8	0.69	5

USE AND CARE INFORMATION

- This accessory will create the need for more frequent air cleaner maintenance. Service the air cleaner daily when operating in dusty conditions.
- Check the accessory mounts frequently and retighten if necessary.
- Replace this accessory with a new one if it is damaged or discolored excessively.
- When this accessory becomes dirty, first rinse it thoroughly with cool water to remove loose dirt, and then wash it with warm, soapy water and a clean cloth or sponge.
- Do not use a brush to clean this accessory as it may scratch the surface.
- Never use petroleum solvents such as gasoline, thinner and benzine to clean this accessory. Also do not use acid or alkaline cleaners.

INSTALLATION

NOTE

- Install this rear panel before installing the roof or door kits.
1. Release and raise the cargo bed to expose the frame behind the front seats.
 2. Remove the seat back cushions by removing the five screws as shown.

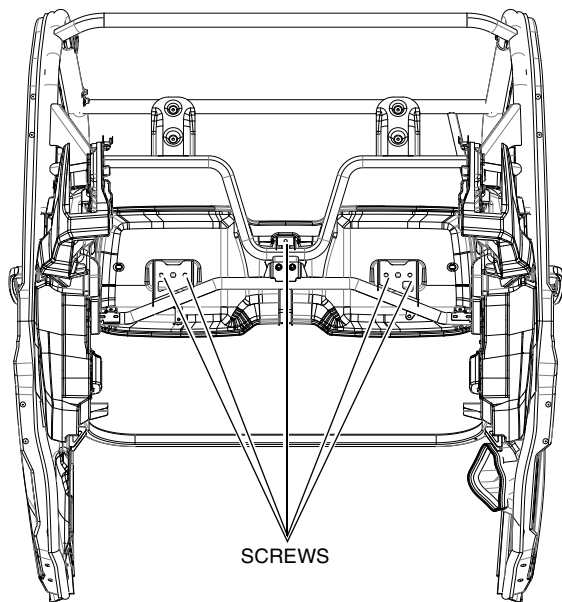

3. Align the lower panel in place (textured side facing rearward) with the inside of the frame, where the seat cushion was removed.

Fit the driver's side of the lower panel in place first, installing the lower panel around the handle and behind the seat belt, as shown.

Flex out the lower panel to slide it behind the passenger seat belt. The lower panel should now be fully in place.

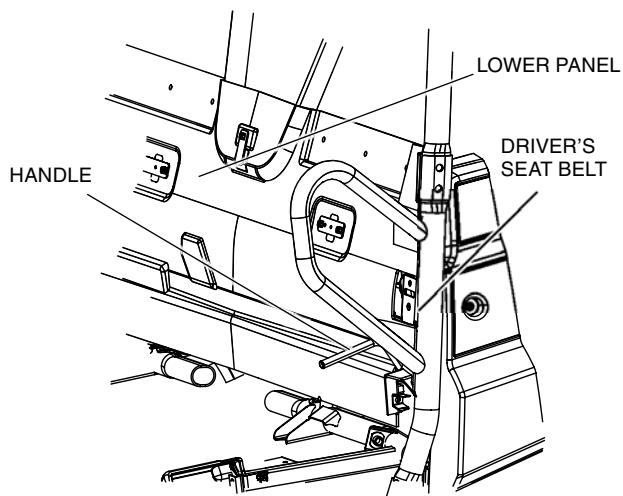

4. Re-install the seat back cushions over the lower panel using four of the screws removed in Step 2 as shown.

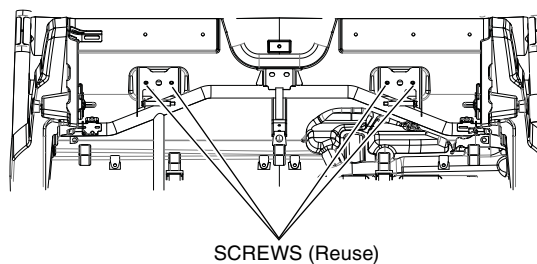

5. Install a 6 x 20 mm screw and flat washer into the middle hole location as shown.

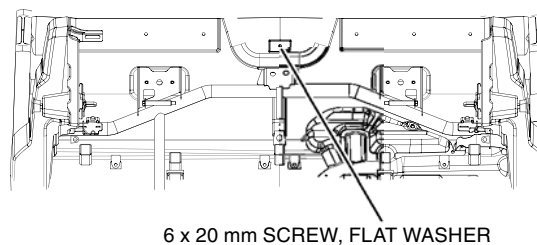

6. Install the hook onto the smooth side of the upper panel using a 6 x 20 mm screw and flat washer as shown.

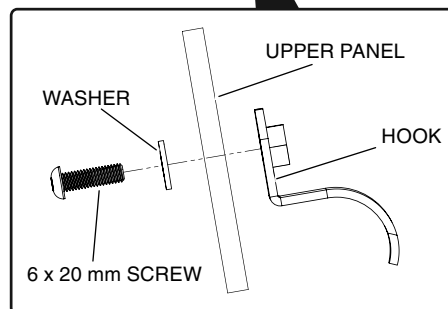
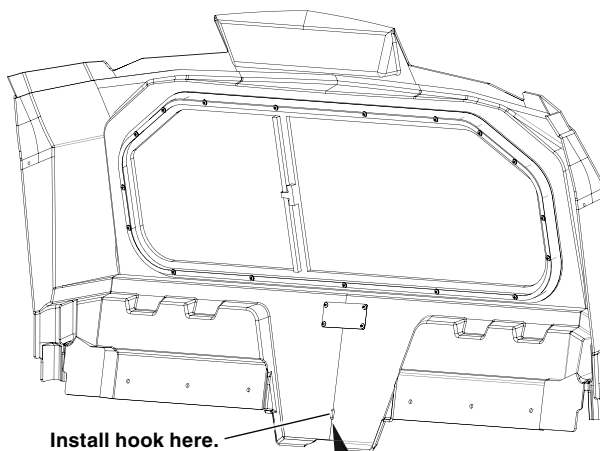

7. Place the upper panel on the outside of the frame. Align the upper panel with the lower panel by sliding the slots from the upper panel over the lower panel as shown. (The cargo bed must be halfway between open and closed.)

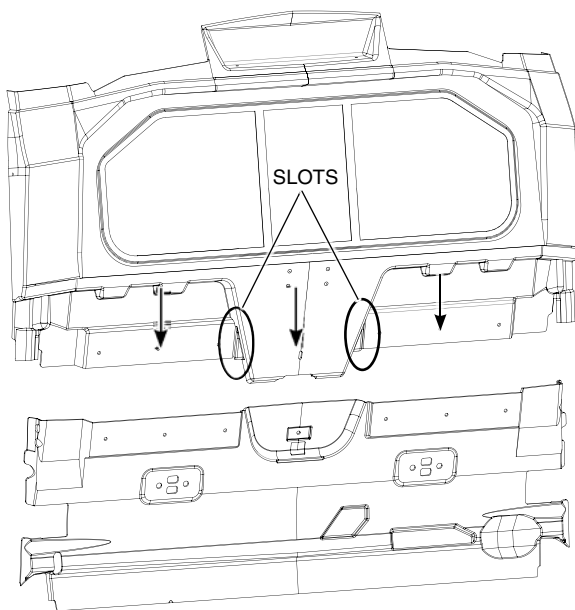

8. Ensure the hook on the upper panel secures onto the frame as shown.

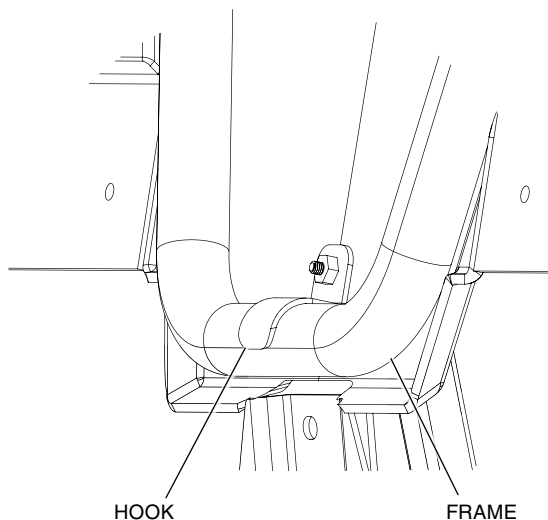

9. Attach two clamps onto the cab frame at the indicated locations with the bolt hole mounting tabs pointing up.

10. Attach two J-hook brackets onto the cab frame at the indicated locations.

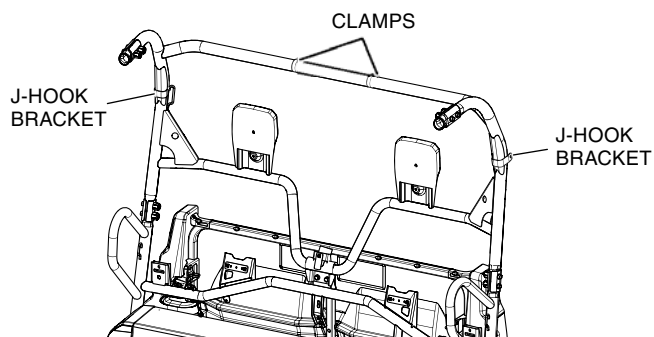

11. Secure the sides of the upper panel to the J-hook brackets using two 6 x 25 mm screws, flat washers and tie-down rings as shown. Leave the hardware loose for now.

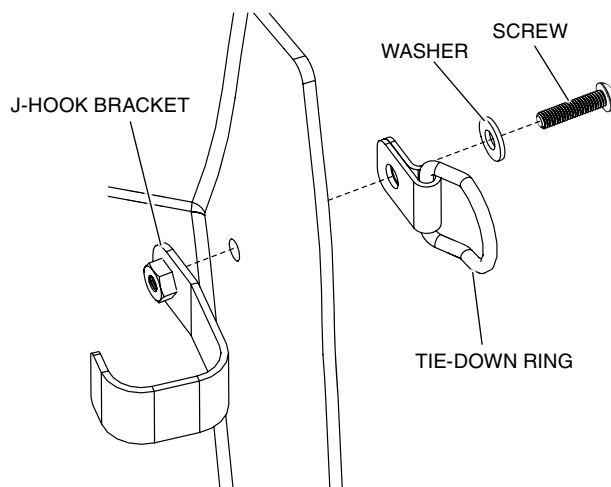

NOTE

- Install the tie-down rings so that they are pointing towards the front of the vehicle as shown.

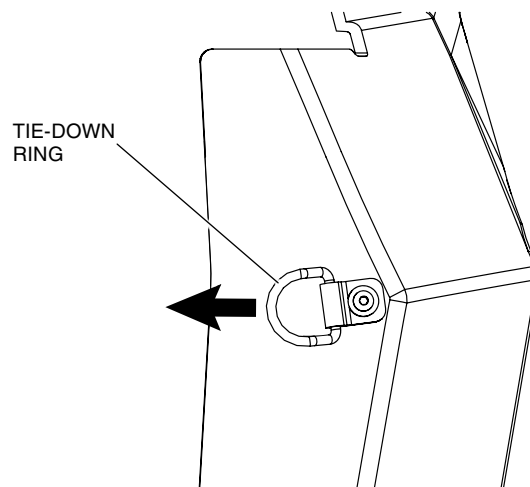

12. Mark the hole drilling locations of both upper clamps on the inside of the panel.

NOTE

- Upper clamps should be spaced approximately 12 inches apart as shown.

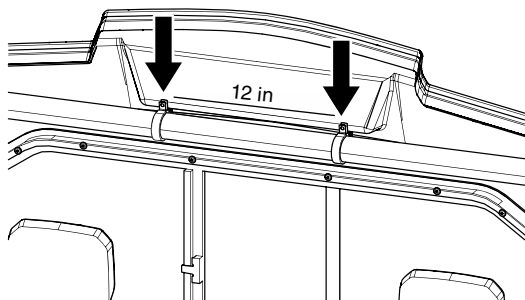

13. Move the clamps out of the way and drill two 5/16 inch holes at the locations marked in Step 12.

14. Secure the top edge of the upper panel to the clamps using two 6 x 25 mm screws, flat washers and nuts as shown.

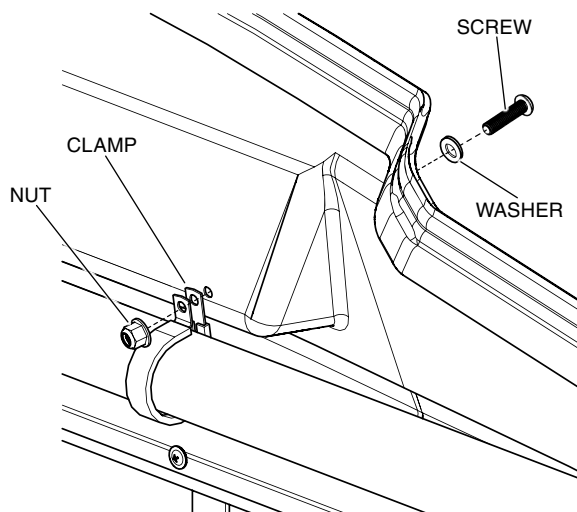

15. Lower the cargo bed. Using the lower panel as a template, drill six holes into the upper panel using a 5/16 inch drill bit.

NOTICE

- Drill shallow, only penetrating through the upper panel so as not to damage the seats.

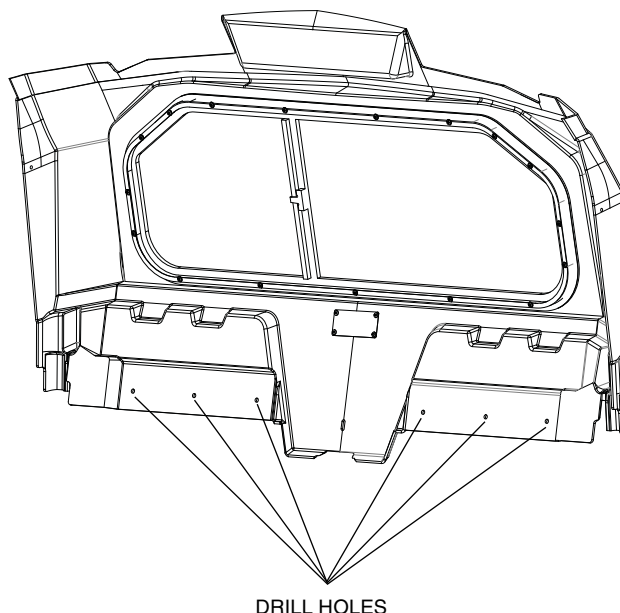

16. Fasten the lower and upper panels together at the locations drilled in Step 10 using six trim clips.

