



INSTALLATION INSTRUCTIONS

Accessory

ACCESSORY SOCKET
P/N 08E70-MKA-D80

Application

After '15
NC700X/XD, NC750X/XD

Publication No.

MII 15736

Issue Date

March 2016

Honda Dealer: Please give a copy of these instructions to your customer.

PARTS LIST

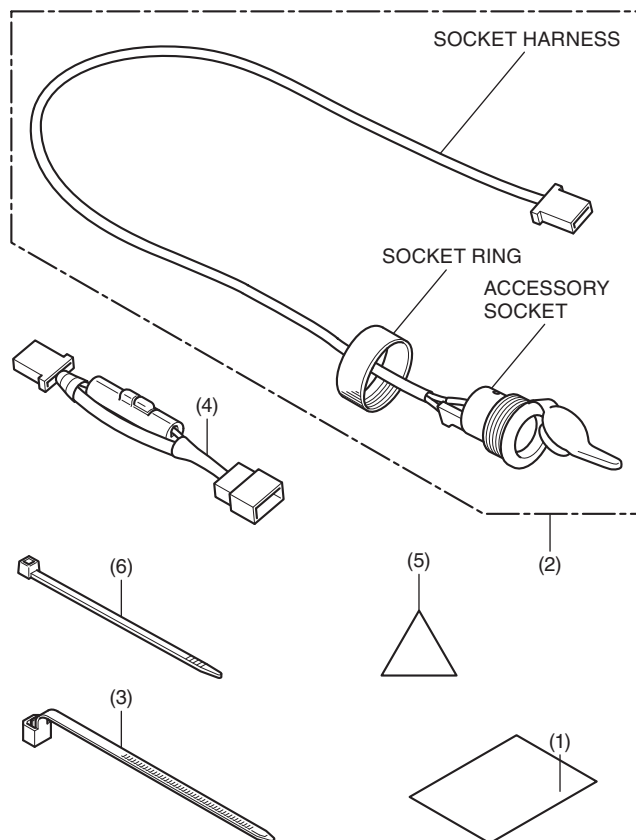

No.	Description	Qty
(1)	Installation Instruction URL	1
(2)	Socket assy.	1
(3)	Wire tie (wide)	1
(4)	Accessory harness	1
(5)	Safety information label	1
(6)	Wire tie (narrow)	1

SUBHARNESS

Sold separately

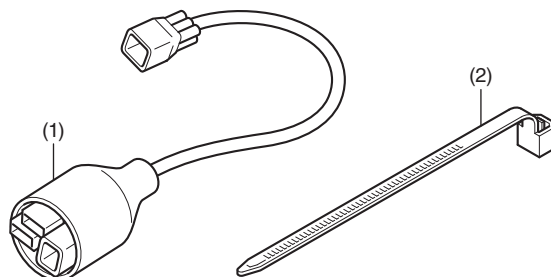

No.	Description	Qty
(1)	Subharness	1
(2)	Wire tie	1

RELAY SET

Sold separately

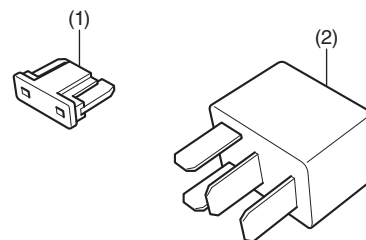

No.	Description	Qty
(1)	Fuse (7.5 A)	1
(2)	Relay	1

TOOLS AND SUPPLIES REQUIRED

Side cutters

Electric drill

Hole saw (30 mm)

Awl

Electrical tape

Isopropyl alcohol

Shop towel

TORQUE INFORMATION

Refer to the Service Manual for the torque values of the removed parts.

INSTALLATION INFORMATION

⚠ CAUTION

- To prevent burns, allow the engine, exhaust system, radiator, etc., to cool before installing the accessory.

NOTE:

- Take care not to damage the painted surfaces of the motorcycle.
- Disconnect the negative (-) cable from the battery before installing this accessory.
- The memory of the clock will be erased when you disconnect the battery. After reconnecting the battery, refer to the motorcycle Owner's manual and reset the clock.
- Trim the excess ends off the wire ties after attaching them to the wire harness. Do not allow the cut part of the wire tie interfere with any harness or brake hose.
- After this accessory installation, check the lights (e.g. right/left turn signal lights and brake lights) for proper operation.
- Heat the bonding surfaces with a hair dryer if the ambient air temperature is below 70°F (21°C).
- The adhesive reaches full strength in 72 hours. Wait at least 24 hours before riding your motorcycle.
- When replacing any other accessory that is required to install this accessory, follow these instructions only.

PREPARING THE RELAY SET

- These procedures are not required for a motorcycle already equipped with the Relay Set.
- Illustration shows NC700X type, other types are similar.

1. Refer to the Service Manual for the motorcycle, remove the motorcycle parts, and disconnect the negative (-) cable from the battery as shown.

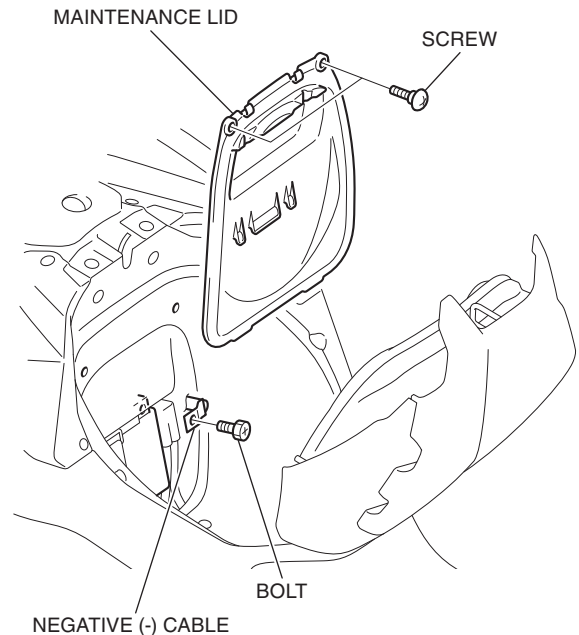

2. Install the relay and fuse in the position shown.

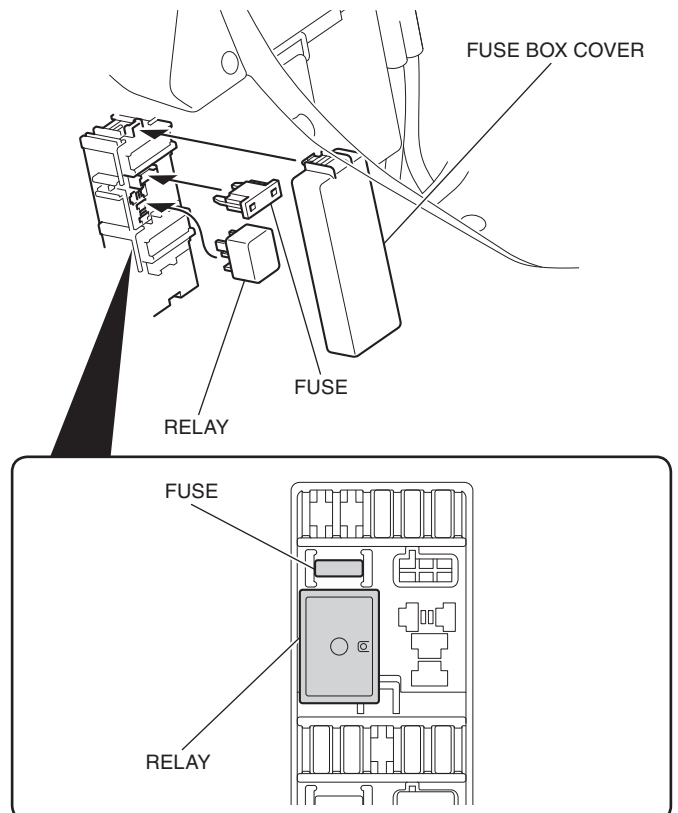

PREPARING THE SUBHARNESS

- This procedure is not required if the motorcycle is already equipped with the subharness for other installed electrical accessories.

1. Refer to the Service Manual for the motorcycle.
Open the pillion seat to remove the rider seat.

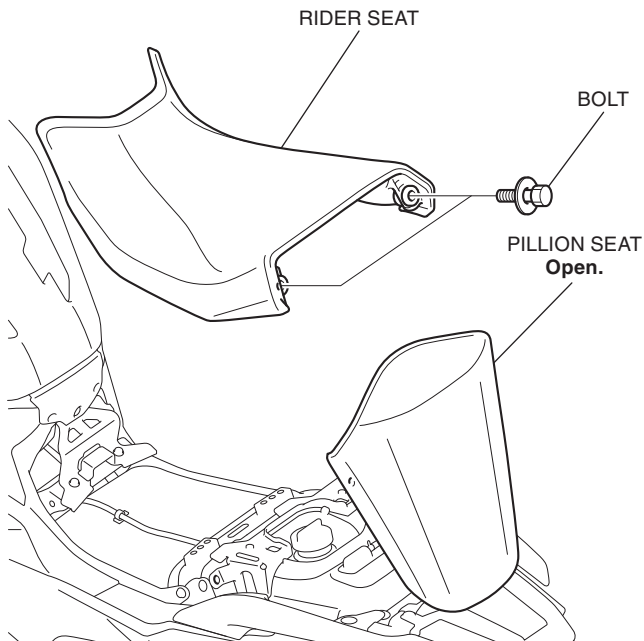

2. Remove the left panel.

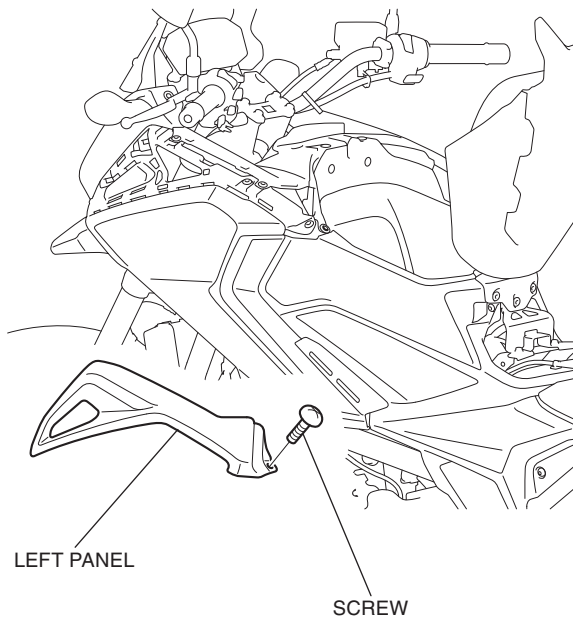

3. Remove the left front side cowl and disconnect the connector.

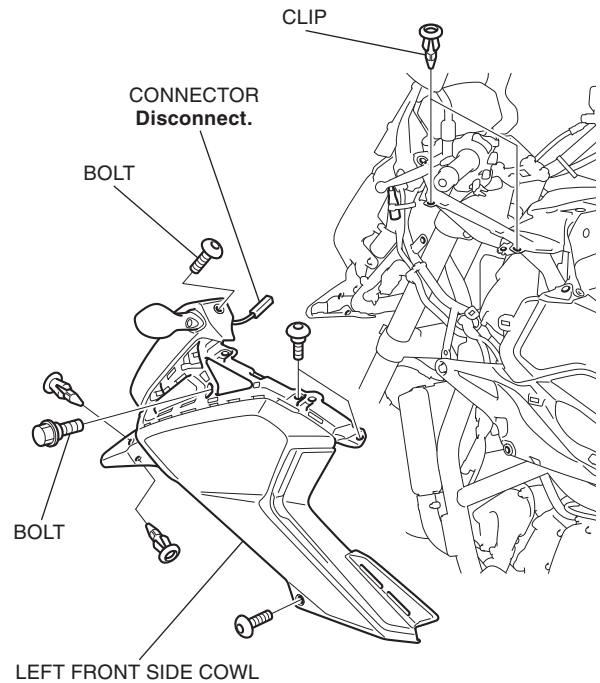

4. Remove the center cover.

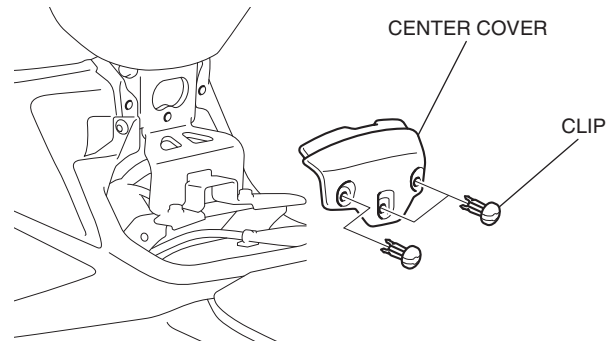

5. Remove the left side cover.

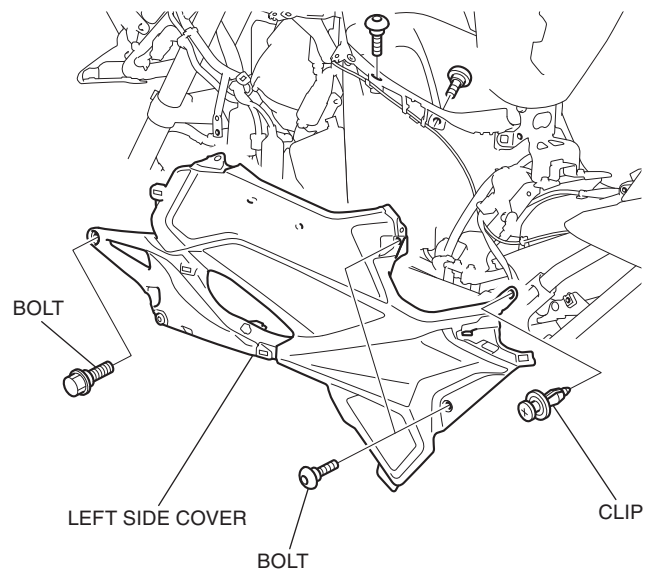

- Release the motorcycle's 6-pin waterproof connector as shown.

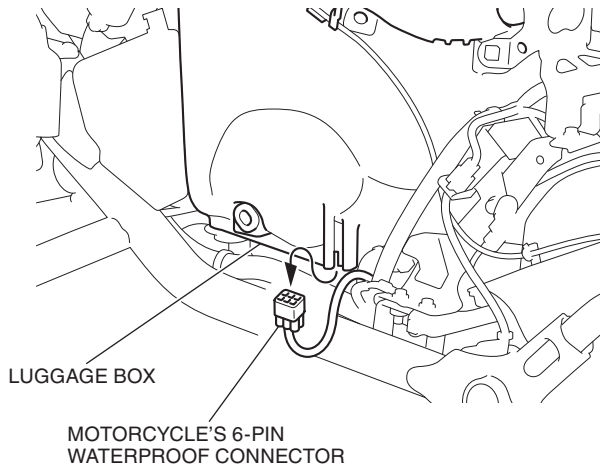

- Connect the subharness as shown.

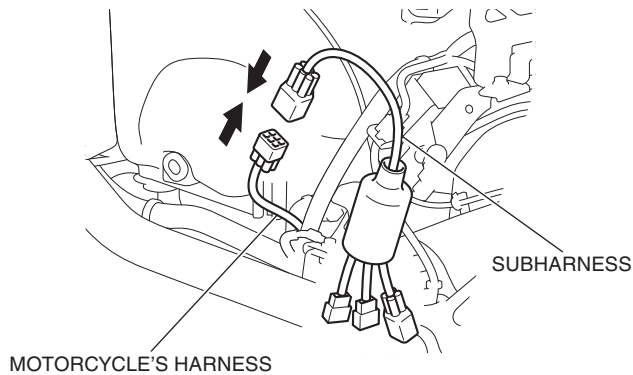

- Secure the 6-pin waterproof connector with the wire ties and electrical tape as shown.

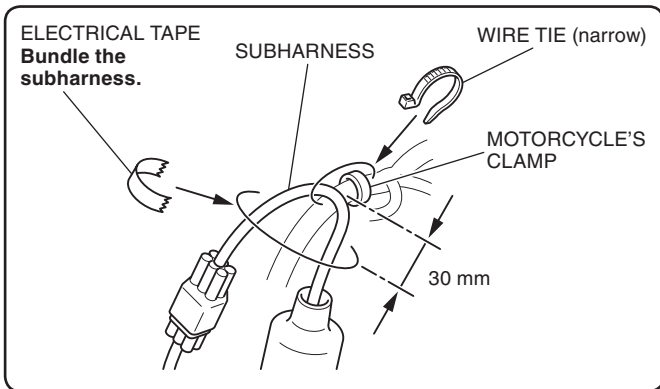

ELECTRICAL TAPE
Secure to the motorcycle's harness.

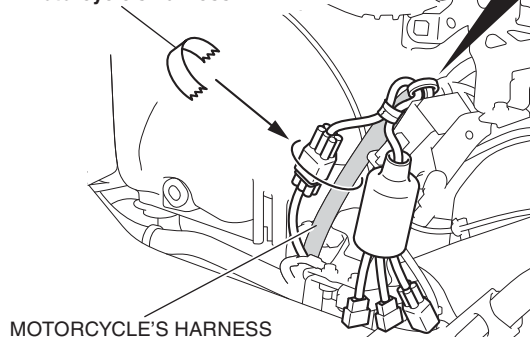

ACCESSORY SOCKET INSTALLATION

- Drill a 30 mm hole along the factory marked line (point) shown using an electric drill and hole saw.
 - Remove the burrs from the edge of the hole.

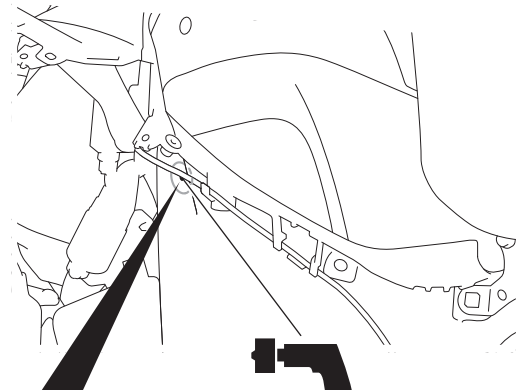

ELECTRIC DRILL
(30 mm HOLE SAW)
Drill at the marked point.

Mark with an awl in the position shown.

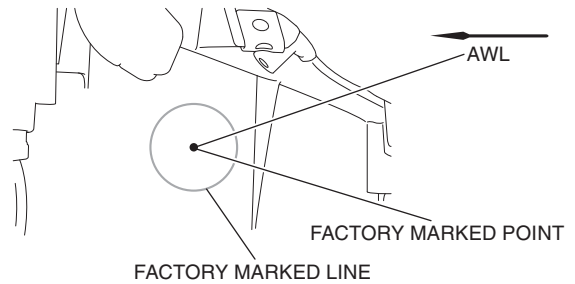

- Install the accessory socket as shown.

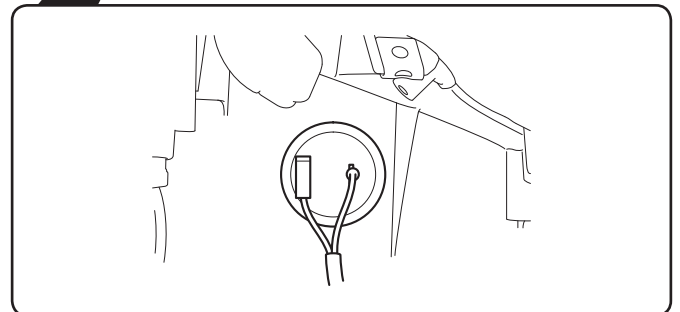
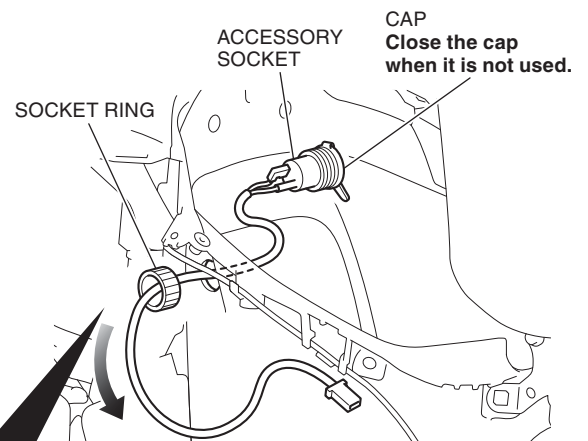

3. Connect the accessory harness as shown.

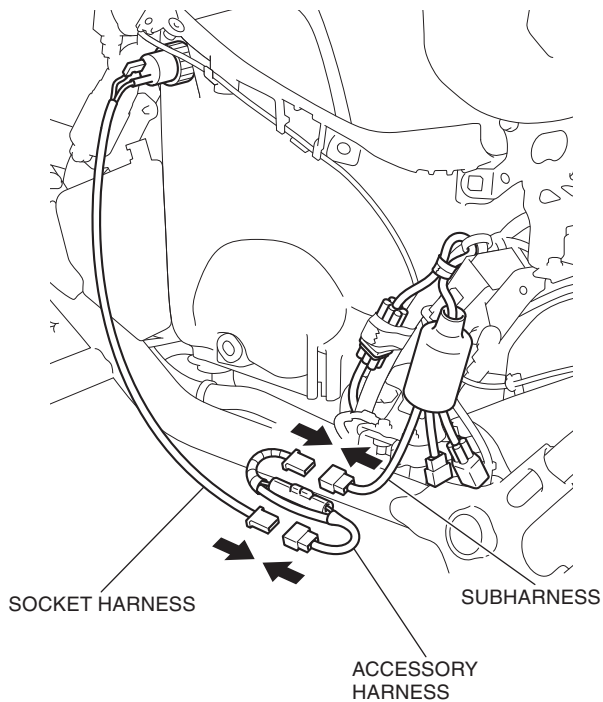

4. Cover the connectors with the harness boot as shown.

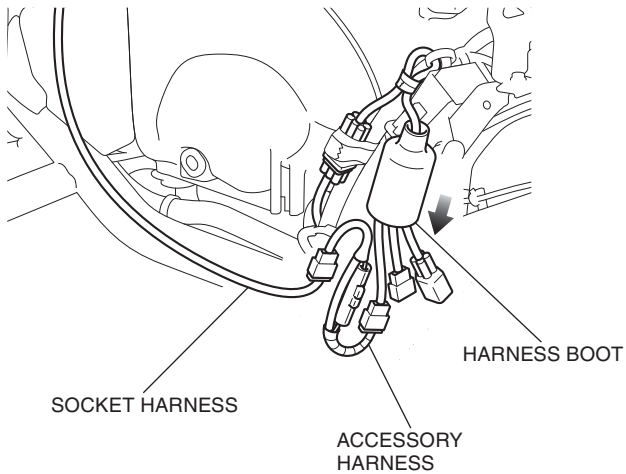

5. Secure the subharness with the wire tie as shown.

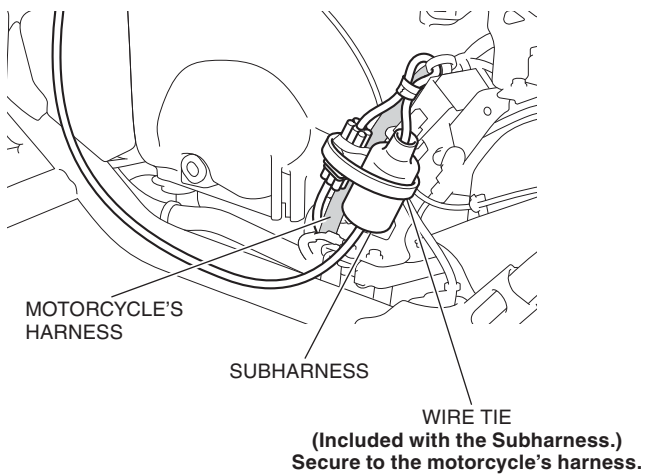

6. Bundle the socket harness and secure it with the wire tie as shown.

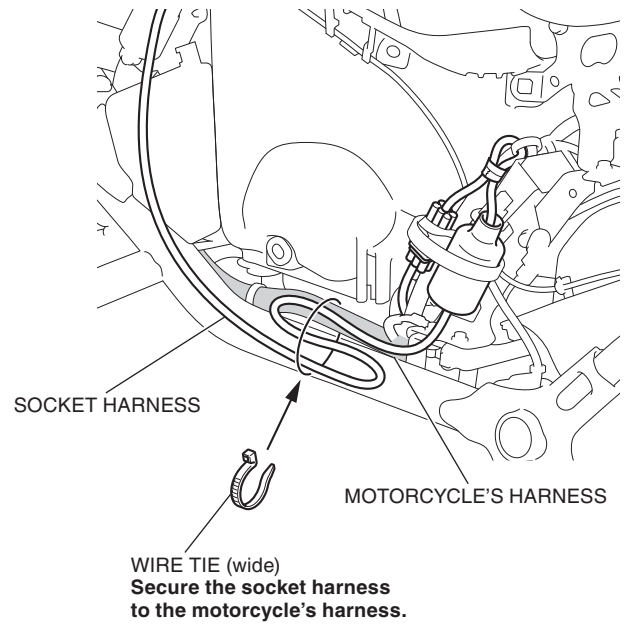

7. Install the motorcycle's parts in the reverse order of removal.

- **Confirm that the harness is not caught or too tight.**

8. Attach the caution label in the position shown.

SAFETY INFORMATION LABEL
Before attaching, thoroughly
clean the area where the caution
label will be attached.

