



INSTALLATION INSTRUCTIONS

Accessory

HMWPE A-ARM GUARDS
(REAR)
P/N 0SP75-HL4-100

Application

SXS1000M3/M5/M6

Publication No.

MII 16218

Issue Date

Revised: August 2022

Honda Dealer: Please give a copy of these instructions to your customer.

PART LIST

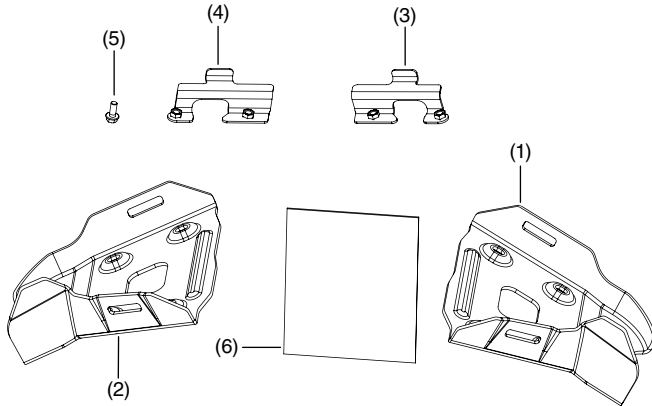

| No. | Description | Qty |
|-----|-------------------------------|-----|
| (1) | HMWPE* Right rear guard | 1 |
| (2) | HMWPE* Left rear guard | 1 |
| (3) | Bracket (A) | 2 |
| (4) | Bracket (B) | 2 |
| (5) | 10 mm flange bolt | 8 |
| (6) | Installation instructions URL | 1 |

* High Molecular Weight Polyethylene

TOOLS REQUIRED

Socket (14 mm)

Ratchet

Torque wrench

TORQUE CHART

Tighten all screws, bolts, and nuts to their specified torque values. Refer to the Service Manual for the torque values of the removed parts.

| Item | N·m | kgf·m | lbf·ft |
|-------------------|-----|-------|--------|
| 10 mm flange bolt | 43 | 4.4 | 32 |

INSTALLATION

⚠ CAUTION

To prevent burns, allow the engine, exhaust system, radiator, etc., to cool before installing the accessory.

Final position of brackets.

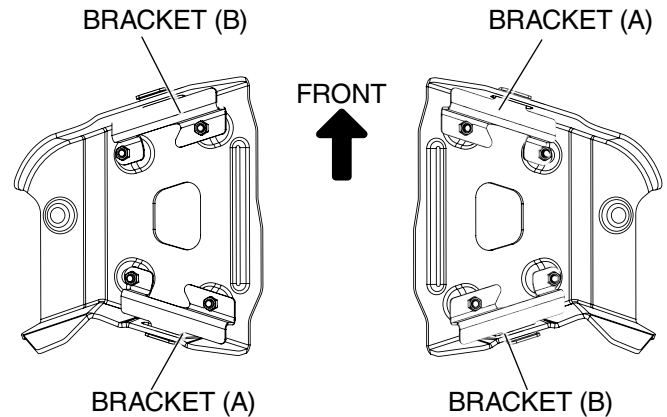

1. Place bracket (B) onto the left A-arm in the position shown.

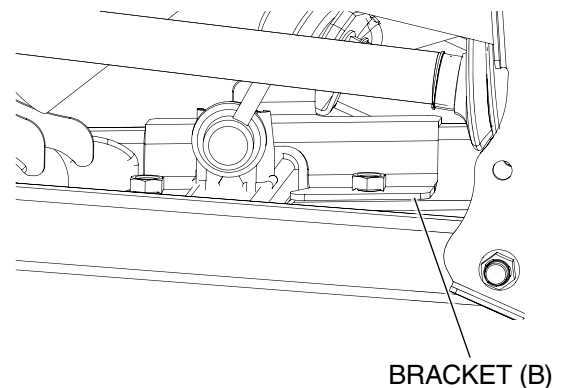

- Loosely install the left rear guard and 10 mm flange bolts as shown.

<Left side>

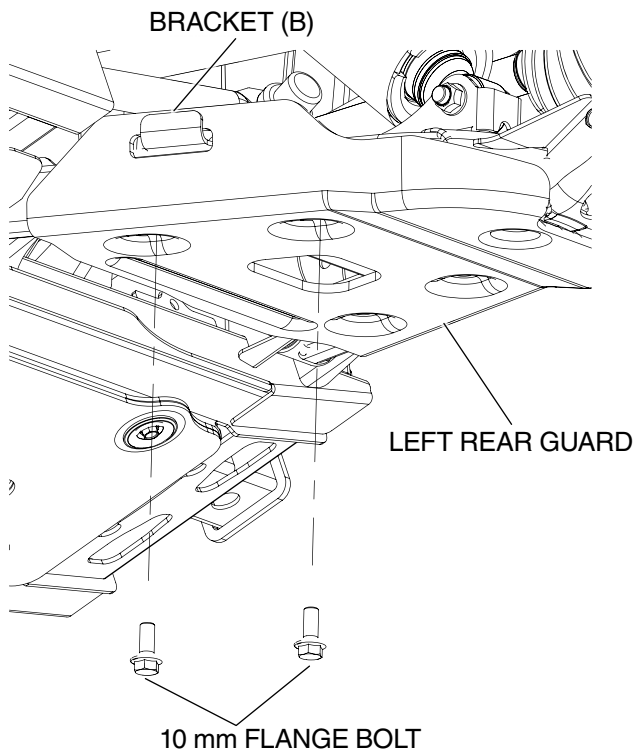

- Loosely install bracket (A) and 10 mm flange bolts as shown.

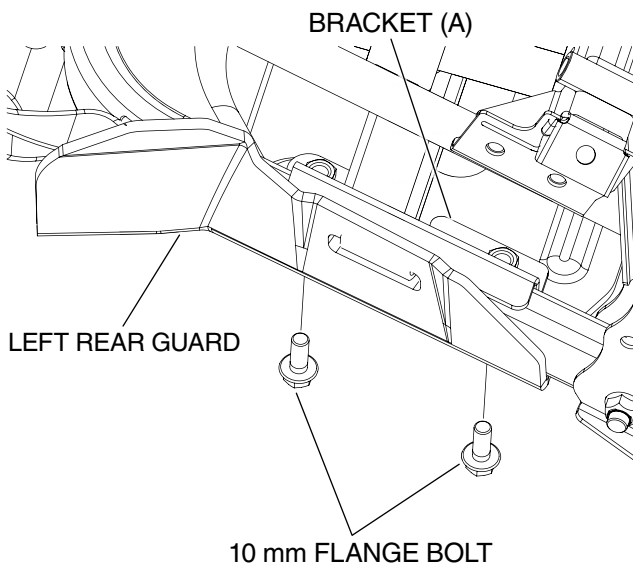

- Tighten the loosely installed 10 mm flange bolts to the value specified in the Torque Chart.

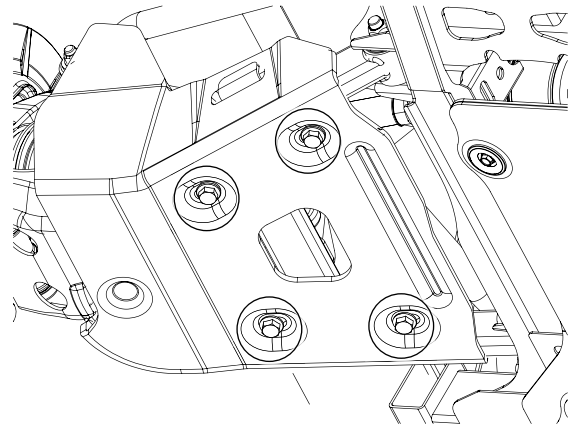

- Repeat Steps 1 through 4 to install the right rear A-arm guard.