



INSTALLATION INSTRUCTIONS

Accessory

LOWER DOOR BAGS
P/N 0SL59-HL6-A00

Application

SXS1000S2X
SXS1000S2R
SXS1000S4
SXS1000S4D

Publication No.

MII 16561

Issue Date

August 2019

Honda Dealer: Please give a copy of these instructions to your customer.

PARTS LIST

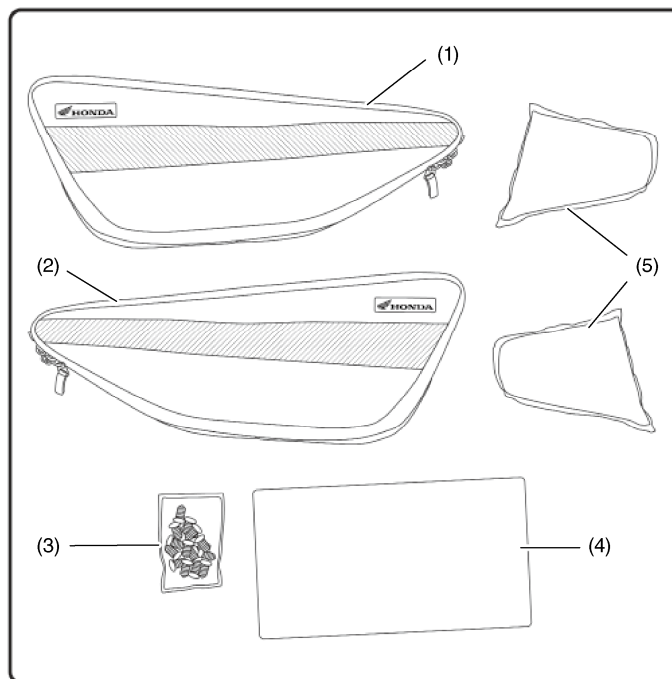

No.	Description	Qty
(1)	Driver lower door bag	1
(2)	Passenger lower door bag	1
(3)	Trim Clips	14
(4)	Drilling templates	2
(5)	Knee pads	2

USE AND CARE INFORMATION

- The weight of the cargo must not exceed the following maximum weight capacity:

Maximum Weight Capacity: 1 lb per bag

- Clean this accessory with warm soapy water and a sponge or soft brush. Let it air dry.
- Do not clean in a washing machine or dryer.

- Accessory Lower Door sold separately.
P/N 08R77-HL6-A00

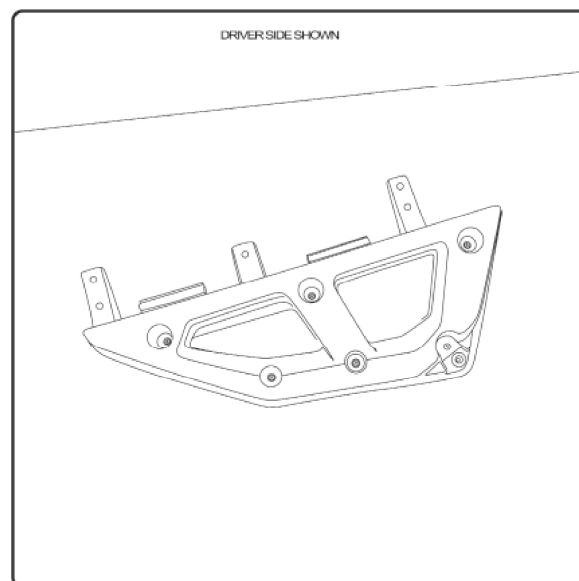

INSTALLATION

NOTE:

There is a DRIVER and PASSENGER side bag. Use the correct drilling template marked for DRIVER or PASSENGER side.

TOOLS REQUIRED

Power drill

8.5 mm drill bit

File

Tape

1. Cut out the supplied templates along the lines to match the exact shape of each door bag.
Make sure to cut out the semi-circles to make it easier to line up the template with the lower door.

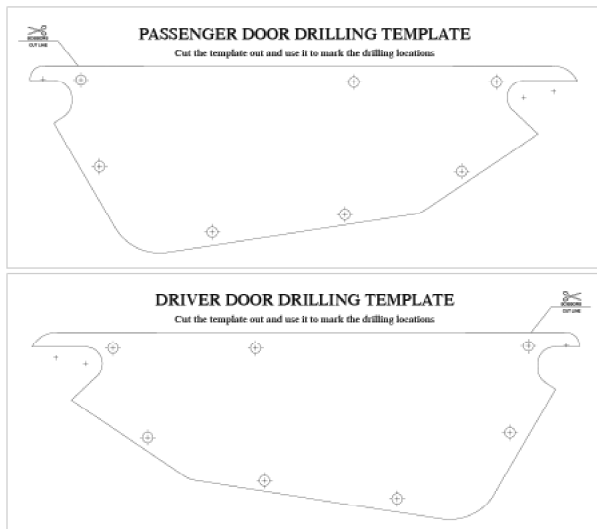

2. Line up the drilling template to the embossed holes on the assembled lower door then tape it in place.

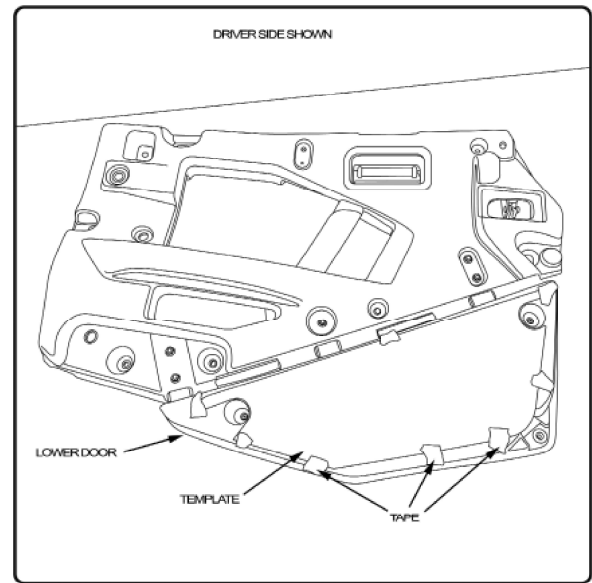

3. Using a center punch or awl, mark the lower door at the center of each crosshair. Carefully remove the template.

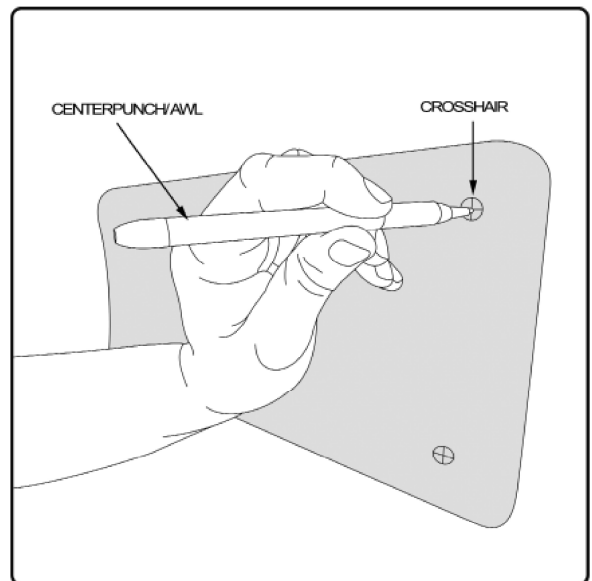

4. Before drilling, wrap a piece of tape around the drill bit 10 mm from the tip to serve as a drill stop. Drill an 8.5 mm hole at each marked point around the lower door. Use a file to remove any burrs.

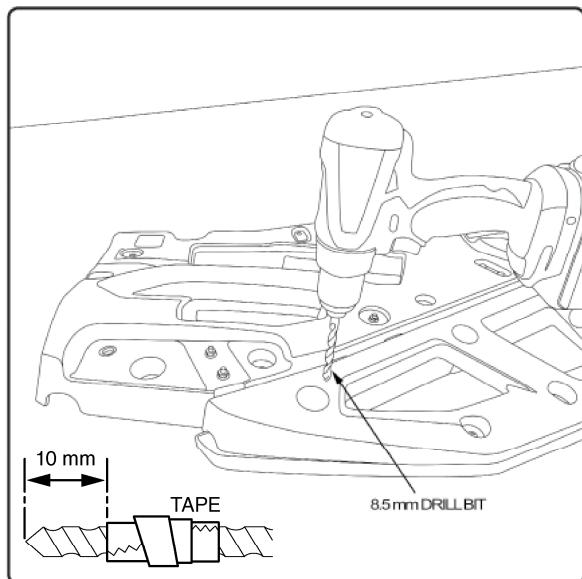

5. Align the holes in the door bag with the drilled holes in the lower door. Install a trim clip through each hole in the bag, into the lower door.

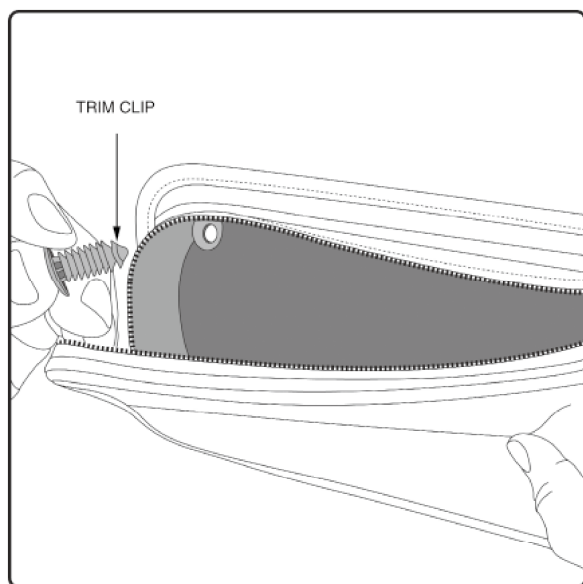

6. Repeat Steps 2 through 5 for the opposite door.

7. Adjust the knee pad placement according to the driver/passenger preference.

