



INSTALLATION INSTRUCTIONS

Accessory

CARGO BOX
P/N 0SL51-HL6-A01

Application

**SXS1000S2X
SXS1000S2R
SXS1000S2XD
SXS1000S4XD**

Publication No.

MII 16561

Issue Date

December 2021

Honda Dealer: Please give a copy of these instructions to your customer.

PARTS LIST

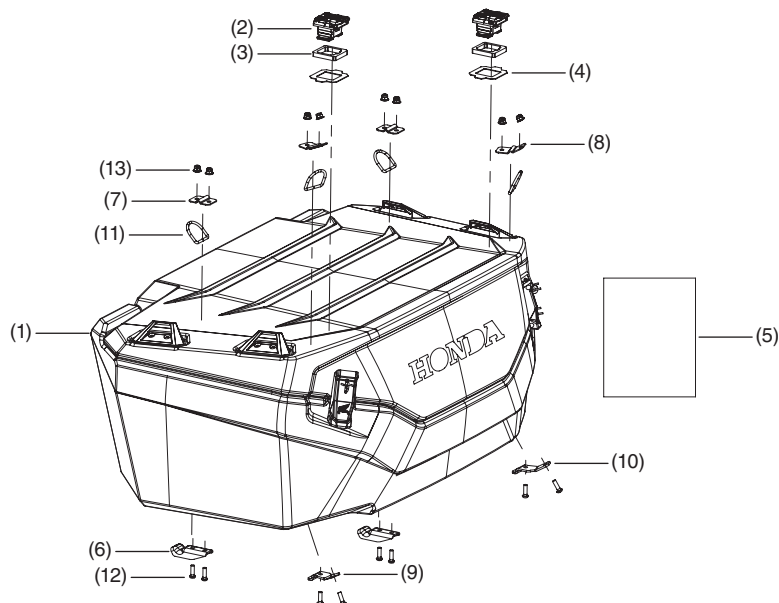

No.	Description	Qty
(1)	Cargo Box	1
(2)	Honda Pro-Connect latch	2
(3)	Rubber Spacer	2
(4)	Snap Ring	2
(5)	Installation Instruction URL	1
(6)	Hook	2
(7)	Inside Plate	2
(8)	Inside Rear Plate	2
(9)	Left Rear Hook	1
(10)	Right Rear Hook	1
(11)	D-Ring	4
(12)	Button Head FL Allen Cap Screw BZ Plated M6 - 0.8 x 20 Full Thread	8
(13)	Hex Nylon FL Nut BZ Plated M6 - 1	8

⚠ WARNING:

Overloading this SxS or improperly carrying cargo can affect handling, braking performance and stability and can lead to a crash resulting in SERIOUS INJURY or DEATH.

- **NEVER** exceed the maximum weight limit printed on the vehicle and in the SxS owner's manual.
- **NEVER** exceed the cargo box maximum capacity: 68 kg/150 lbs.
- **ALWAYS** secure cargo carried in the cargo box to prevent shifting.

NOTE:

- Always make sure the hooks and Honda Pro-Connect® latches are properly engaged before riding.
- Make sure all cargo is secured before riding.
- Please read and follow all instructions and warnings supplied with the cargo box and cargo box mount plate.

MOUNT PLATE

P/N 0SL41-HL6-A01

Sold Separately.

Two mount plates needed for this accessory.

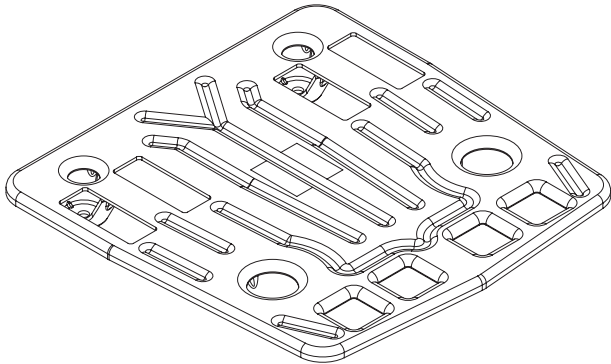

The cargo box requires two of the above mount plates for installation. See plate instructions for installation procedure.

INSTALLATION

1. Install the two hooks (6) with the two inside plate (7), two D-ring (11), four M6 button head flange screws (12) and four hex flange nylon M6 nuts (13). The orientation of the two hooks must be as shown in the pictures below.

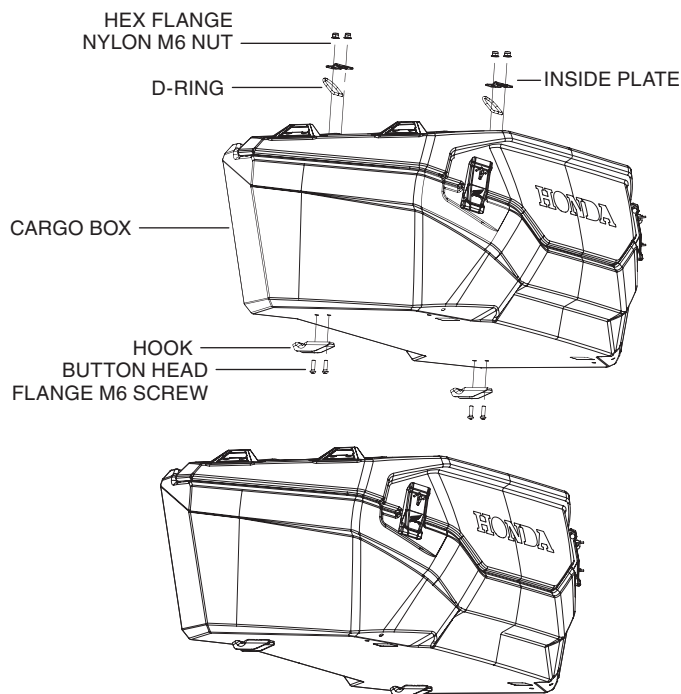

2. Install the left rear hook (9) and the right rear hook (10) with the two inside rear plate (8), two D-ring (11), four M6 button head flange screws (12) and four hex flange nylon M6 nuts (13). The orientation of the two hooks must be as shown in the pictures below.

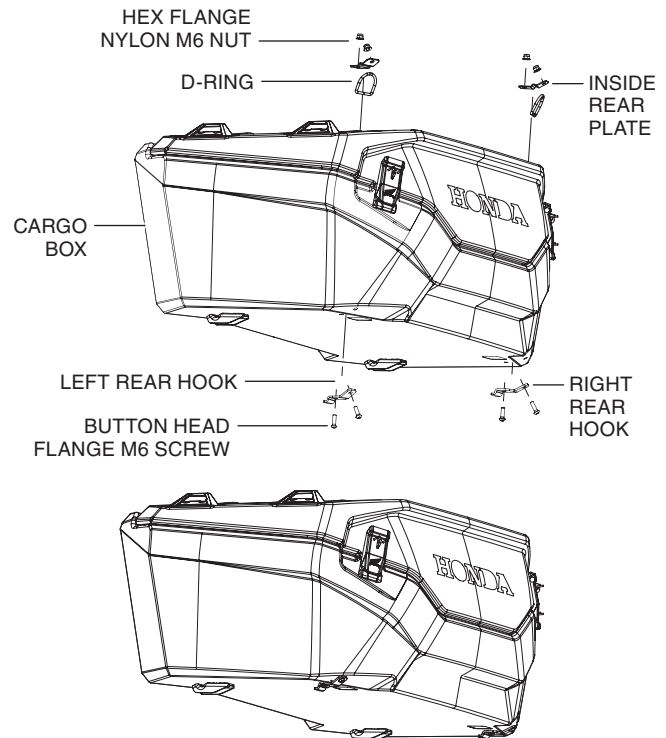

3. Align the rear and front hooks on the corresponding holes of the mounting plate and firmly push the cargo box to engage them. When the hooks are in place, each square hole in the cargo box is also aligned with its corresponding hole in the mounting plate.

The pictures below show the installation.

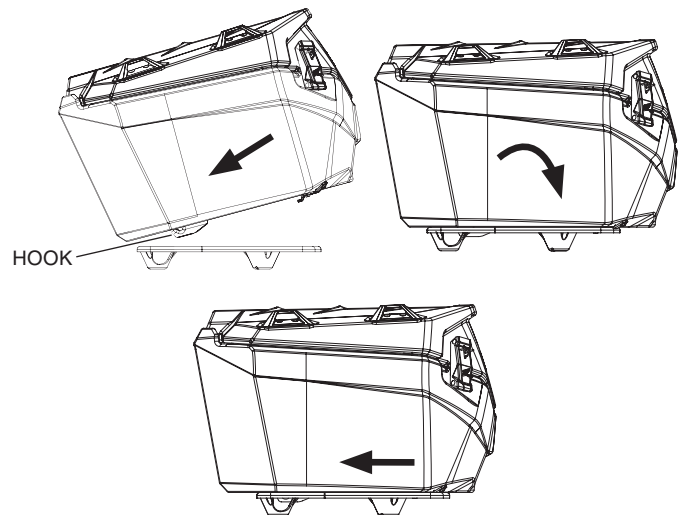

4. Lift the lever on each Honda Pro-Connect latch to unlock them and install the Rubber Spacer and the snap ring on the latches. Install the two Honda Pro-Connect latches in the cargo box.

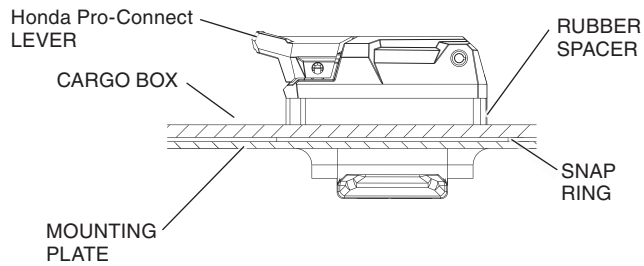

5. Secure the cargo box to the vehicle by pressing down each Honda Pro-Connect lever. Make sure the two hooks and both Honda Pro-Connect latches are well engaged.