



INSTALLATION INSTRUCTIONS

Accessory

FRONT A-ARM GUARDS
P/N 0SK10-HL6-A00

Application

SXS1000S2X
SXS1000S4
SXS1000S4D

Publication No.

MII 16561

Issue Date

August 2019

Honda Dealer: Please give a copy of these instructions to your customer.

PARTS LIST

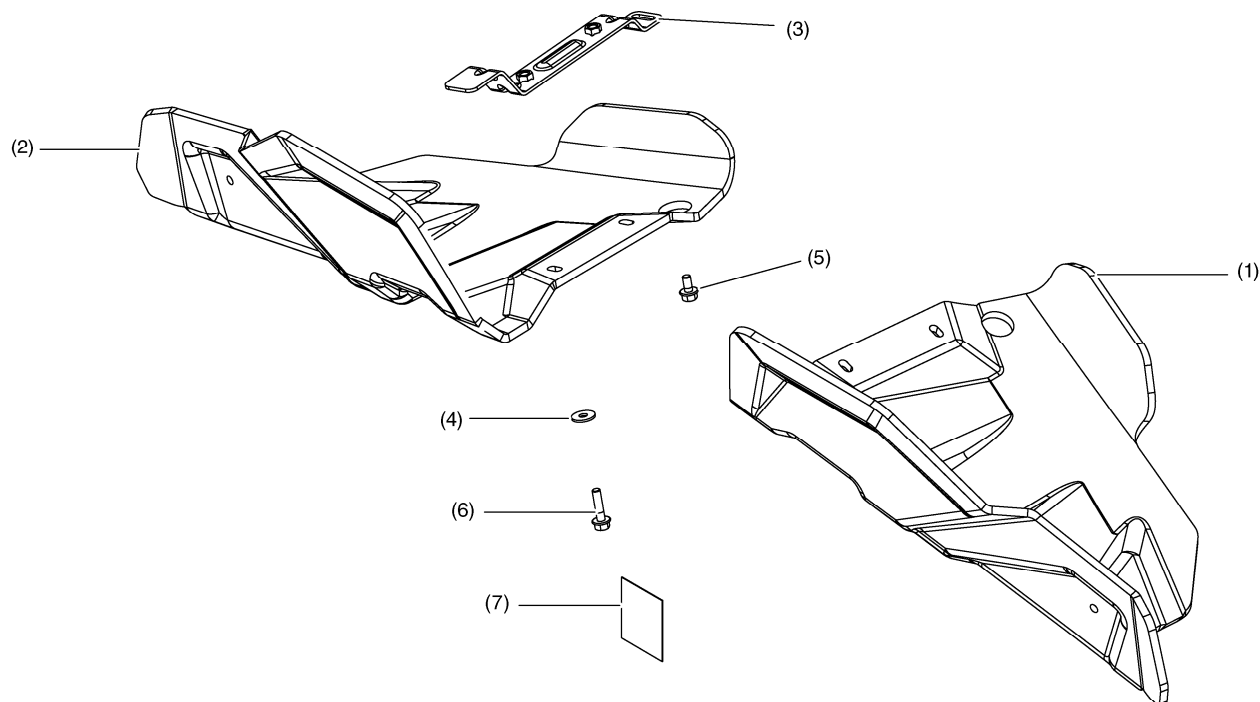

No.	Description	Qty
(1)	Left A-arm guard	1
(2)	Right A-arm guard	1
(3)	Mounting bracket	2
(4)	Fender washer	6
(5)	10 × 12 mm flange bolt	2
(6)	10 × 25 mm flange bolt	8
(7)	Installation Instructions URL	1

TOOLS REQUIRED

Socket (10 mm)

Ratchet

Torque wrench

Box-end wrench (10 mm)

TORQUE CHART

Tighten all screws, bolts, and nuts to their specified torque values. Refer to the Service Manual for the torque values of the removed parts.

Item	N-m	kgf-m	lbf-ft
10 mm flange bolt	9	0.92	6.5

INSTALLATION

⚠ CAUTION

To prevent burns, allow the engine, exhaust system, radiator, etc., to cool before installing the accessory.

1. Remove the original A-arm guard and hardware as shown.

<Left side>

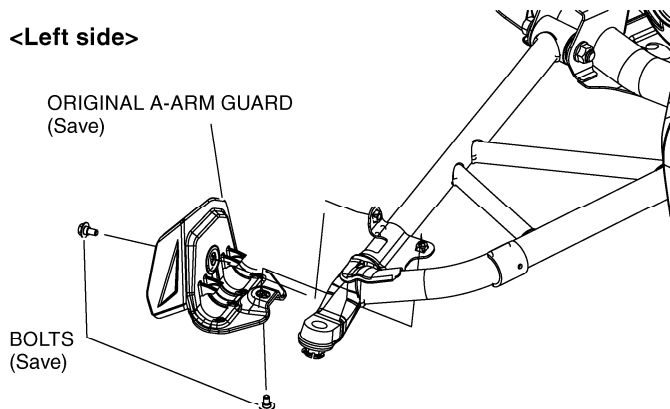

2. Loosely install the mounting bracket with the 10 × 12 mm flange bolt as shown.

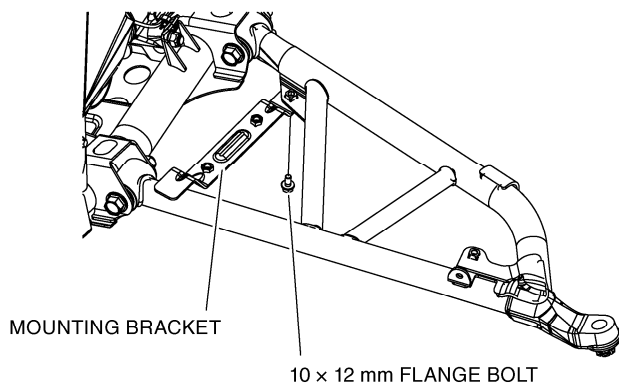

3. Hold the left A-arm guard against the left A-arm as shown. Loosely install the 10 × 25 mm bolt on front of the A-arm guard.

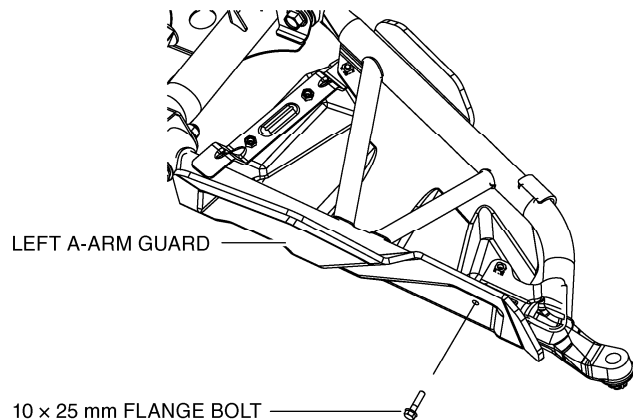

4. Loosely install the fender washers and the 10 × 25 mm flange bolts starting with the closest to the wheel.

LEFT A-ARM GUARD

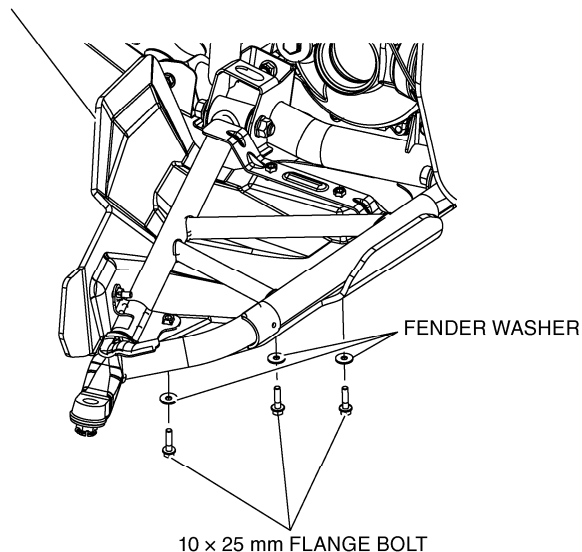

5. Tighten all the bolts the value specified in the TORQUE CHART starting with the one facing forward.

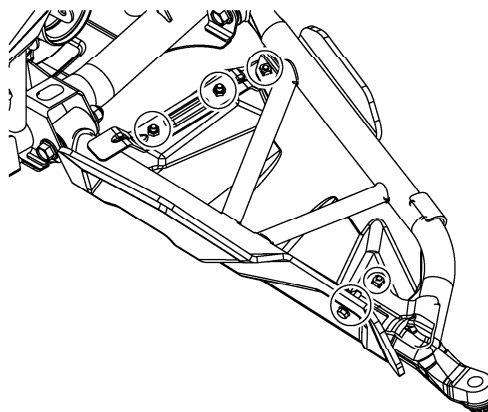

6. Repeat steps 1 through 5 on the right side.