



INSTALLATION INSTRUCTIONS

HEATER
P/N 0SE08-HL6-A00

SXS1000S2X/S2XD/S2R/
S2RD/S4X/S4XD

Publication No.

MII 17811

Issue Date

June 2023

Honda Dealer: Please give a copy of these instructions to your customer.

PARTS LIST

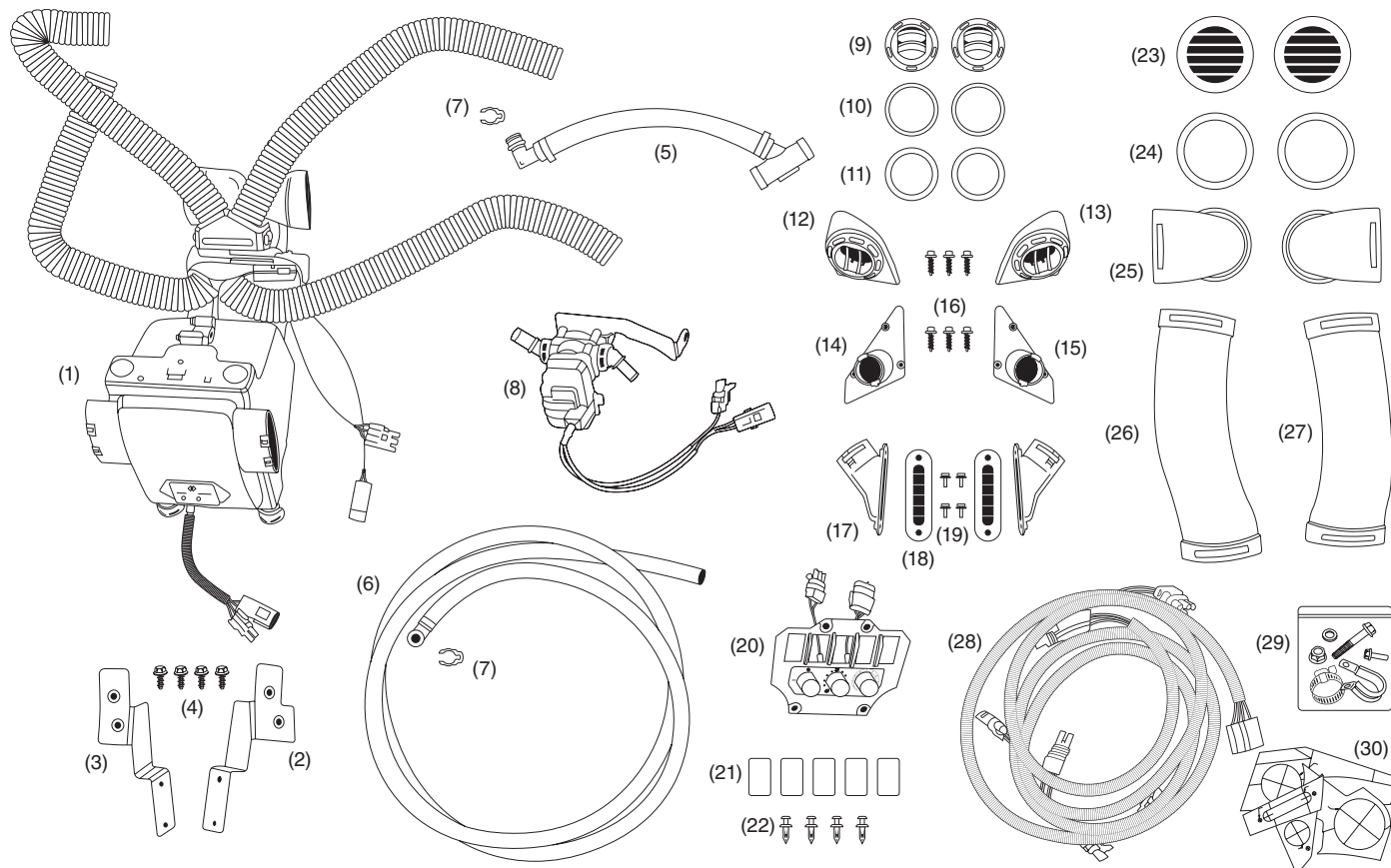

No.	Description	Qty
(1)	Heater assembly	1
(2)	Left heater mount	1
(3)	Right heater mount	1
(4)	Heater assembly mount screw	4
(5)	Heater return hose	1
(6)	Heater inlet hose	1
(7)	Retaining clips	2
(8)	Temperature control valve	1
(9)	Floor vent louver	2
(10)	Female floor vent adapter ring	2
(11)	Male floor vent adapter ring	2
(12)	Left face vent housing	1
(13)	Right face vent housing	1
(14)	Left face vent duct adapter	1
(15)	Right face vent duct adapter	1

No.	Description	Qty
(16)	Face vent mounting screws	6
(17)	Demist duct adapter	2
(18)	Demist vent grill	2
(19)	Demist vent mounting screws	4
(20)	Control panel assembly	1
(21)	Blank plate	5
(22)	Trim clips	4
(23)	Return air grill	2
(24)	Return air adapter ring	2
(25)	Return air adapter housing	2
(26)	Left return air duct	1
(27)	Right return air duct	1
(28)	Heater harness	1
(29)	Hardware kit	1
(30)	Template kit	1

HARDWARE PARTS LIST

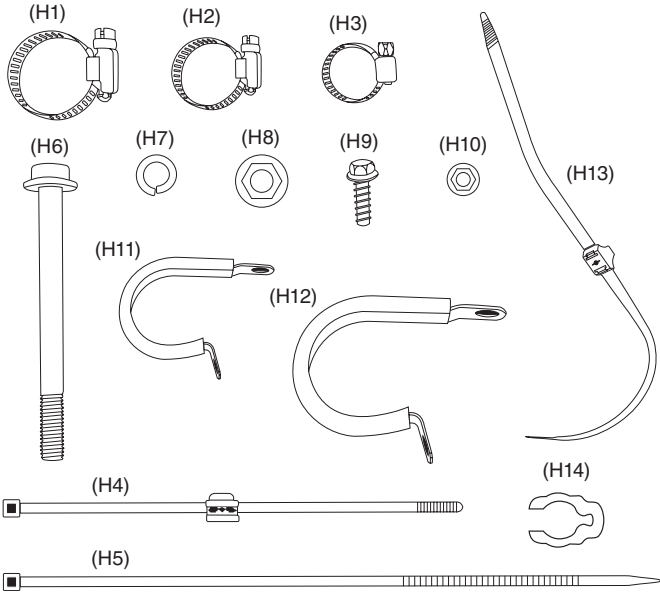

No.	Description	Qty
(H1)	1-1/2 inch hose clamp	2
(H2)	1-inch hose clamp	1
(H3)	7/8-inch hose clamp	2
(H4)	Cable tie panel clip	1
(H5)	Cable tie	10
(H6)	10 x 110 mm bolt	1
(H7)	10 mm lock washer	1
(H8)	10 mm nut	1
(H9)	6 x 20 mm bolt	4
(H10)	6 mm lock nut	4
(H11)	1-inch p-clamp	2
(H12)	1-1/2 inch p-clamp	2
(H13)	Double cable tie	2
(H14)	Retaining clips (spare)	4

TOOLS AND SUPPLIES REQUIRED

- Cable tie cutter
- Phillips screwdriver
- Standard screwdriver
- Drill
- Socket (6 mm, 8 mm, 10 mm, 12 mm, 14 mm, 15 mm, 1/4 inch)
- Drill bit (3/16 inch, 1/4 inch, 5/16 inch)
- Hole saw (1 1/2 inch, 2 1/4 inch, 3 inch)
- Step drill bit (up to 5/8 inch minimum)
- Allen wrench (5 mm)
- 15 mm combination wrench
- Rotary tool
- Hose cutter
- Deburr tool
- Clean drain pan (for reuse of coolant)
- Pro honda hp coolant

Fuse Box

Sold separately (P/N 0SS25-HL4-A00)

The fuse box, busbar, and fuse box mount kit are required for the installation of this accessory.

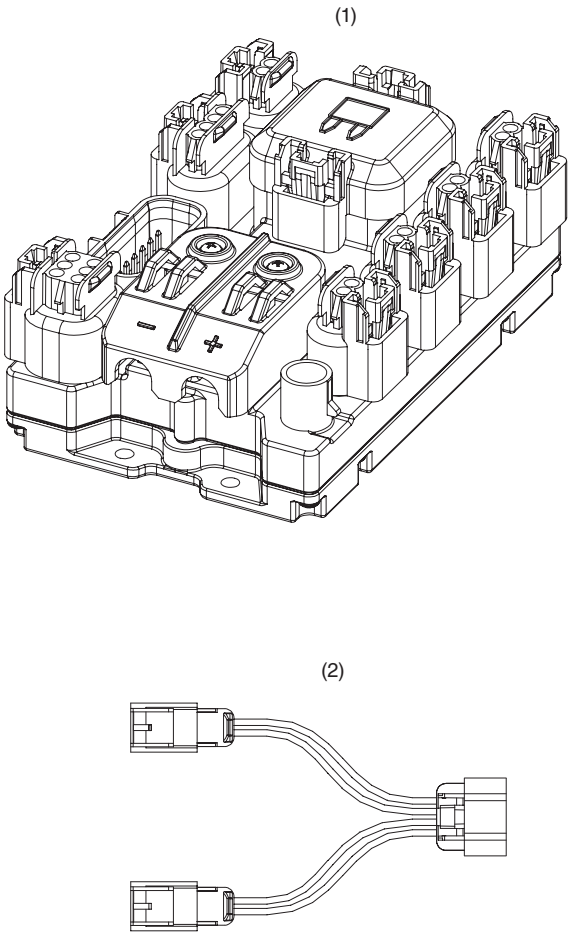

No.	Description	Qty
(1)	Fuse box switcher	1
(2)	Harness, 4-pin to 2-pin (Y-splitter)	1

Busbar

Sold separately (P/N 0SS27-HL6-A00)

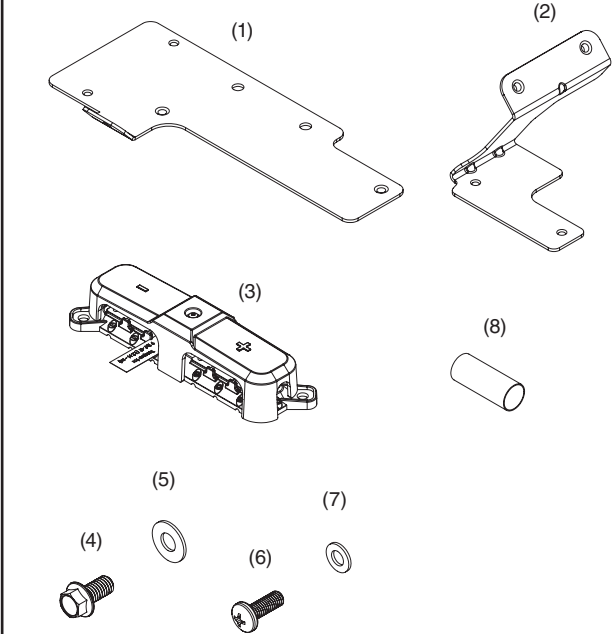

No.	Description	Qty
(1)	Main busbar mounting plate	1
(2)	Busbar lower support bracket	1
(3)	Busbar	1
(4)	6 × 12 mm flange bolt	4
(5)	6 × 14 mm washer	4
(6)	5 × 14 mm phillips screw	2
(7)	5 × 10 mm washer	2
(8)	Heat shrink	2

Fuse Box Mount Kit
Sold separately (P/N 0SS26-HL6-A00)

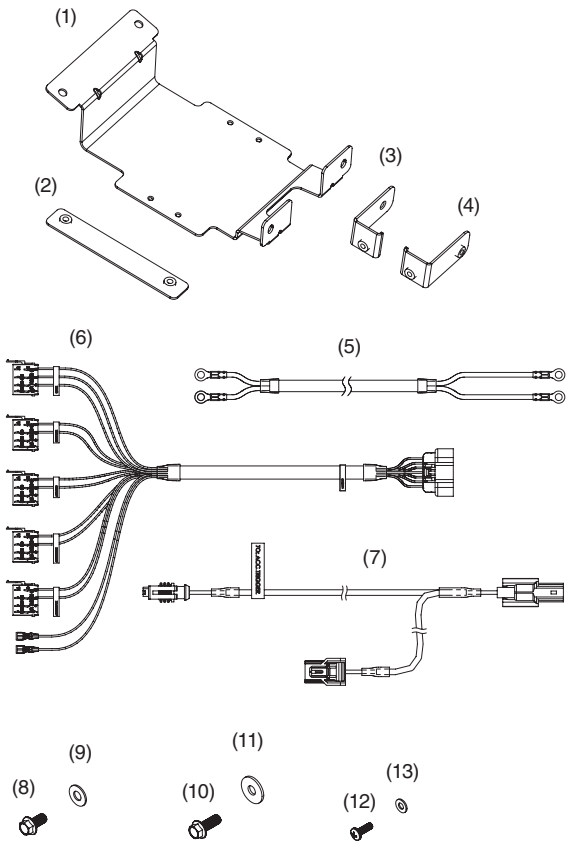

- USE AND CARE INFORMATION**
- Check the accessory mounts frequently and re-tighten if necessary.
 - Replace this accessory with a new one if it is damaged.

TORQUE CHARTS
Tighten all screws, bolts, and nuts to their specified torque values.

Item	N·m	kgf·m	lbf·ft
1-1/2 inch hose clamp	4	0.4	3.0
1 inch hose clamp	4	0.4	3.0
7/8 inch hose clamp	2	0.2	1.5
6 mm flange bolt and nut	12	1.2	9
10 mm flange bolt and nut	12	1.2	9

No.	Description	Qty
(1)	Fuse box mounting plate	1
(2)	Front under bracket	1
(3)	Driver side L-bracket	1
(4)	Passenger side L-bracket	1
(5)	Input power cables	1
(6)	Switch wiring harness	1
(7)	Accessory trigger cable	1
(8)	8 x 12 mm flange bolt	4
(9)	6 x 14 mm washer	4
(10)	8 x 16 mm flange bolt	2
(11)	6 x 18 mm washer	2
(12)	4 x 12 mm phillips screw	4
(13)	4 mm washer	4

HEATER OVERVIEW

Upon completion of installation, vehicle will resemble the following:

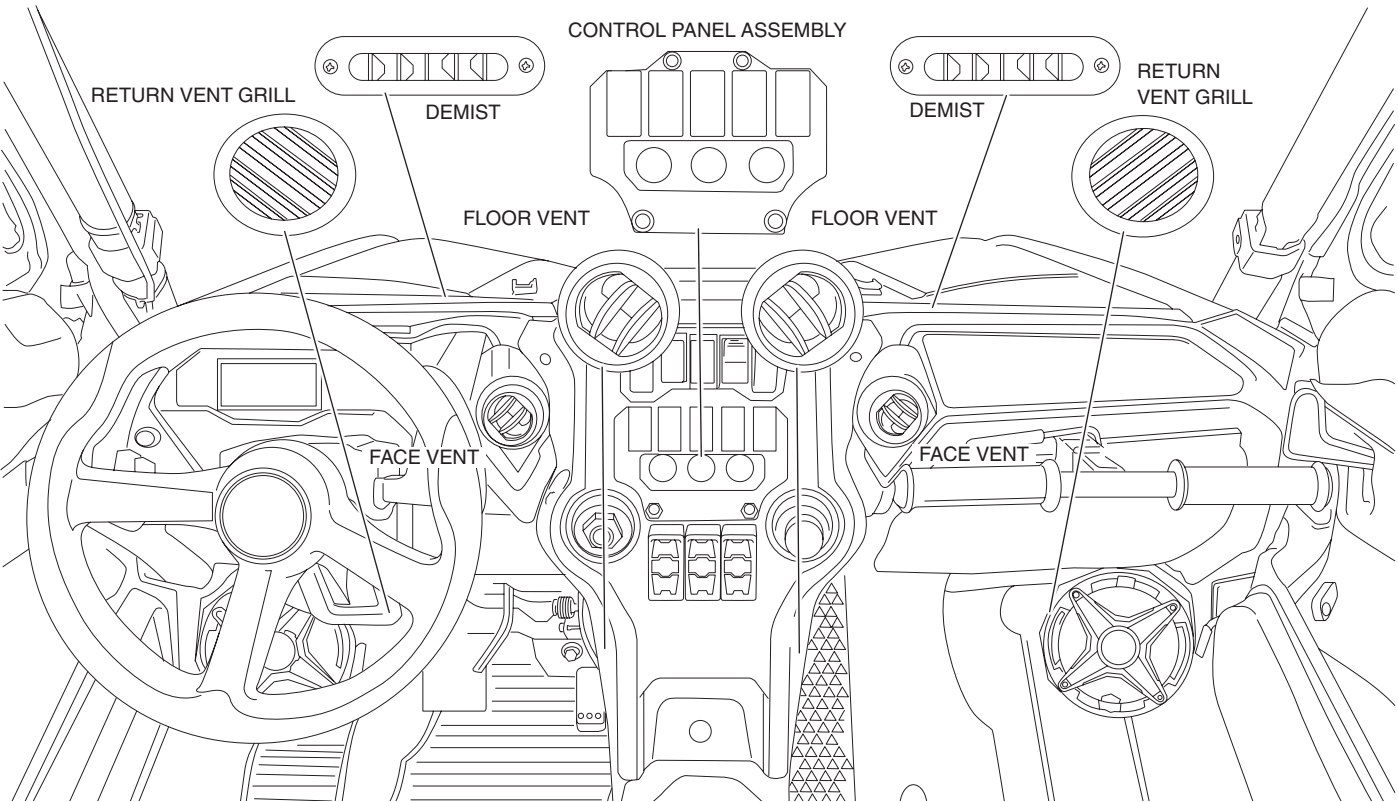
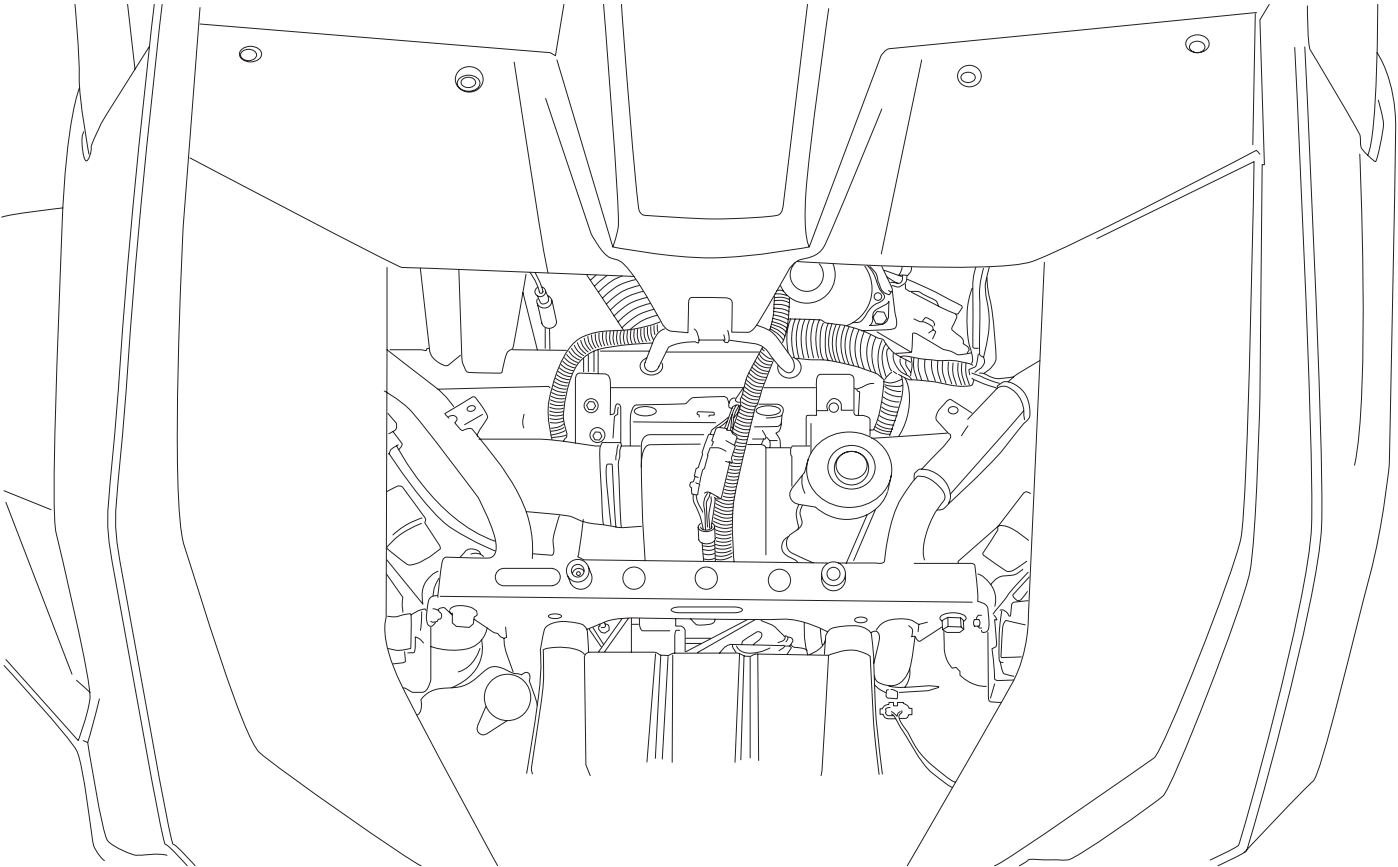

INSTALLATION

Installation should be performed by an authorized Honda dealer or qualified technician.

FOR YOUR SAFETY

Because this installation instruction is intended for the professional service technician, we do not provide warnings about many basic shop safety practices (e.g., Hot parts - wear gloves). If you have not received shop safety training or do not feel confident about your knowledge of safe servicing practice, we recommend that you do not attempt to perform the procedures described in this installation instruction.

VEHICLE PREPARATION FOR HEATER INSTALLATION

1. Install all other required accessory parts before beginning this installation.
2. Refer to the Service Manual for the vehicle and remove:
 - Front hood
 - Rear hood
 - Right side mud cover
 - Seat cushions
 - Front right side seat backrest
 - Front center console
 - Rear center console (Talon 4P)
 - Center instrument panel
 - Glove box
 - Right side center console panel
 - Column damper
 - Fuse box lid
 - Front right side seat bottom cover
 - Right side front floor
3. Disconnect battery.
4. Drain engine coolant according to Service Manual.

HEATER INSTALLATION

5. Install templates and cut holes. Deburr edges as needed.

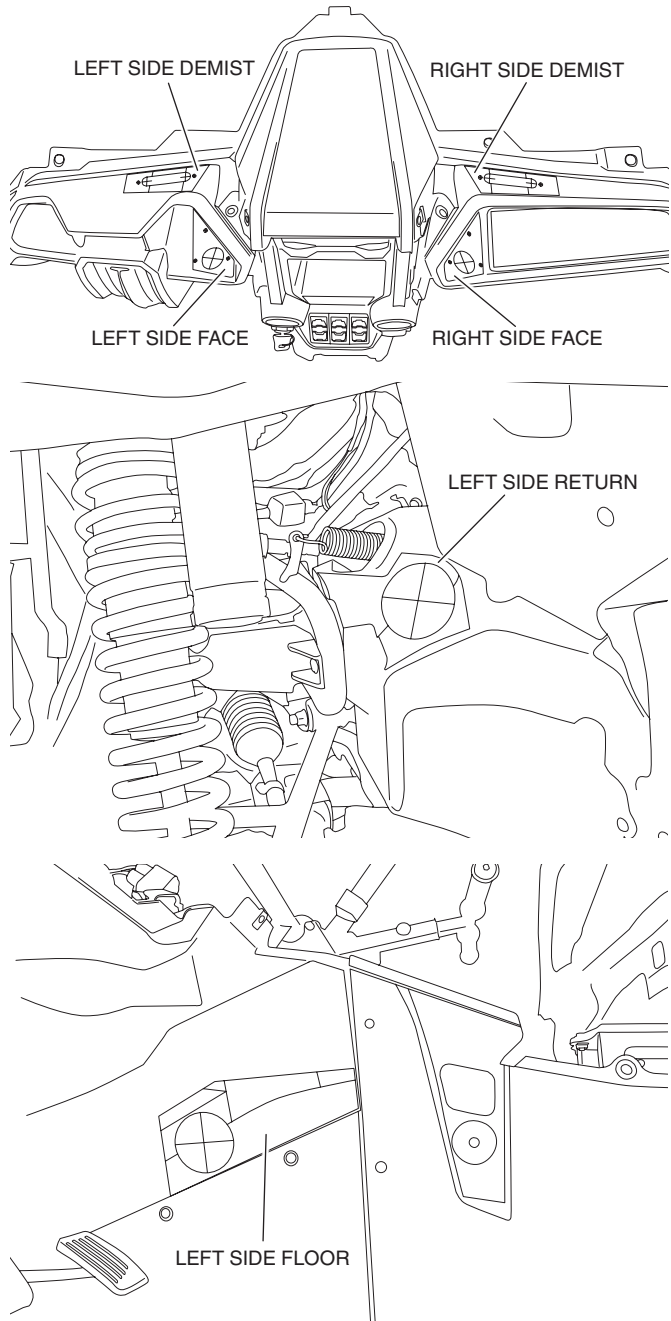

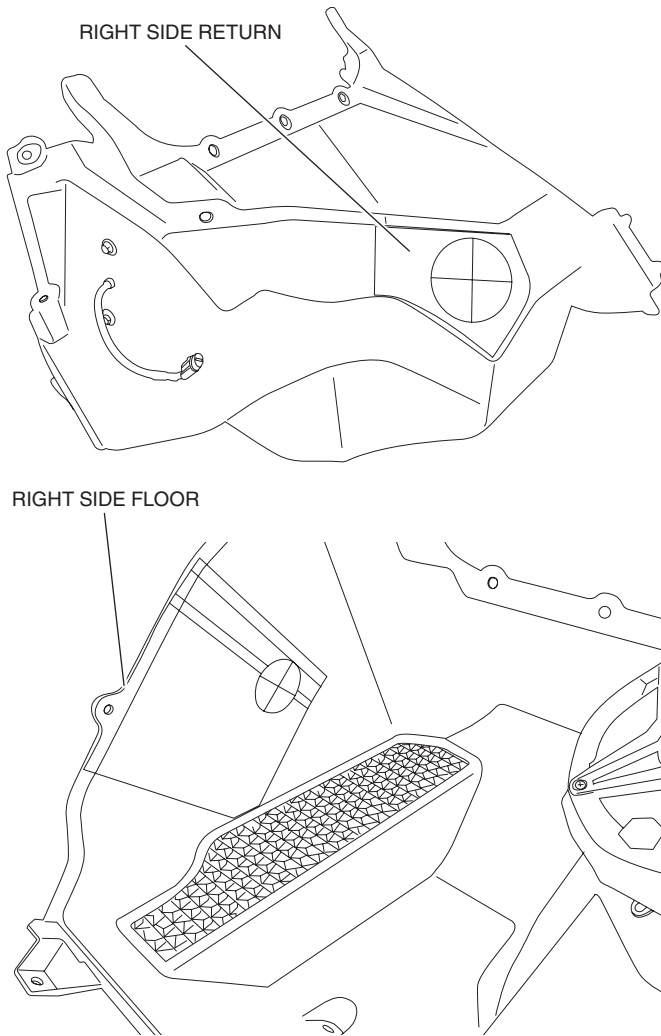

NOTE: If Switch Plate Accessory (P/N: 0SA30-HL6-A10) is already installed, skip steps 6 and 7.



▶ WATCH VIDEO

Scan QR code or visit: tinyurl.com/2akprvfa

6. Place Control Panel Assembly over compartment in center instrument panel. Mark locations of the four holes onto center instrument panel. Then remove Control Panel Assembly and drill holes in all four marked locations with 5/16-inch drill bit.

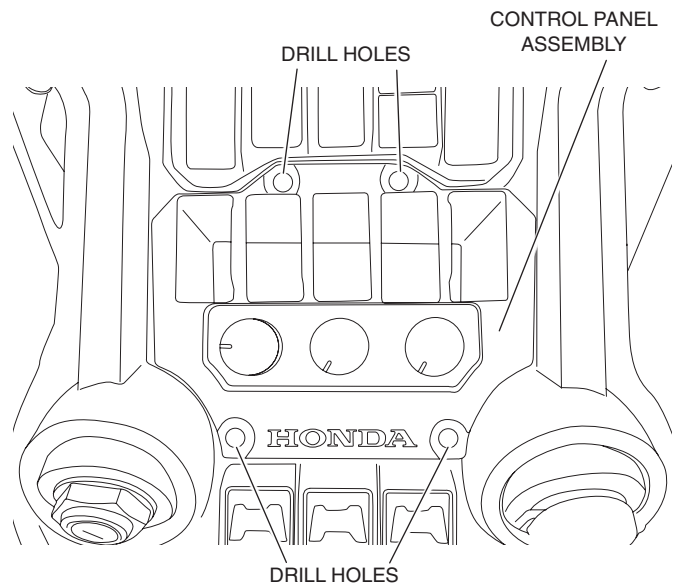

▶ WATCH VIDEO

Scan QR code or visit: tinyurl.com/292txsnf

7. Cut 1-1/2 inch hole in instrument panel pocket as shown.

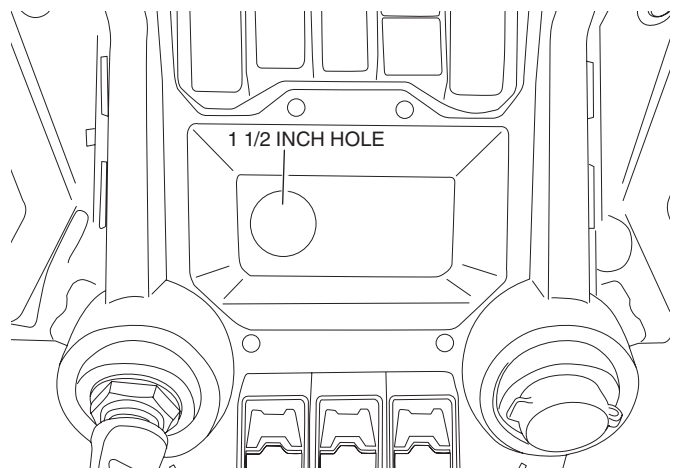

▶ WATCH VIDEO

Scan QR code or visit: tinyurl.com/23aqju2g

8. Install Left and Right Face Vent Assemblies, using three Face Vent Mounting Screws through Left and Right Face Vent Duct Adapter through center instrument panel, and into the Left and Right Face Vent Housings as shown.

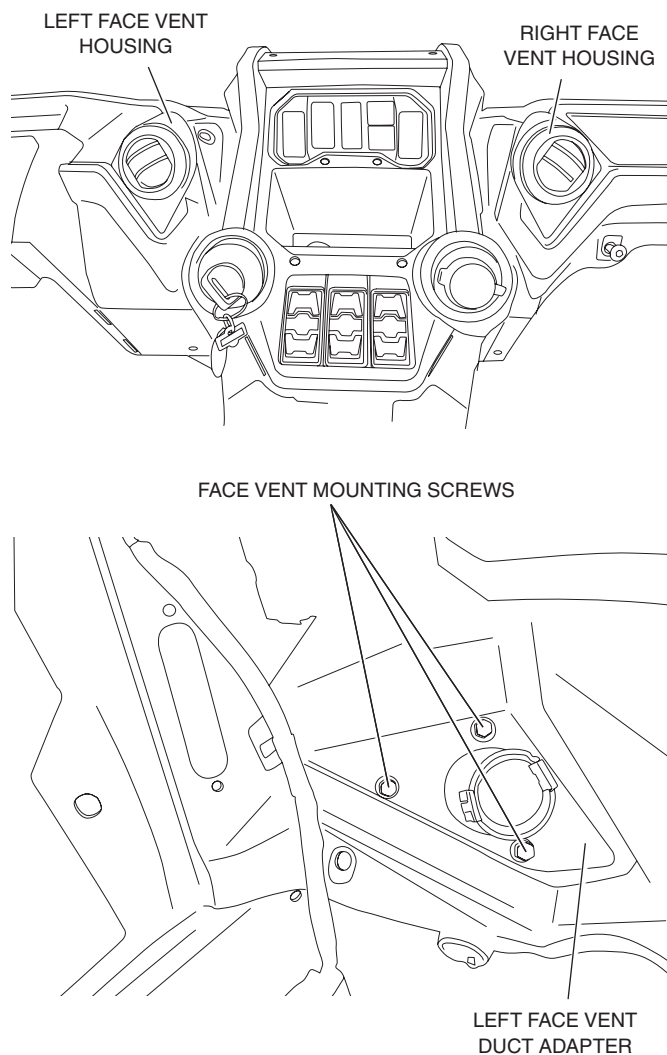

NOTE: Left Face Vent Duct Adapter shown above. Repeat for Right Face Vent Duct Adapter.



WATCH VIDEO

Scan QR code or visit: tinyurl.com/2be3u862

9. Install Demist Vent Grills using two Demist Vent Mounting Screws on each side through center instrument panel as shown and into Demist Duct Adapters.

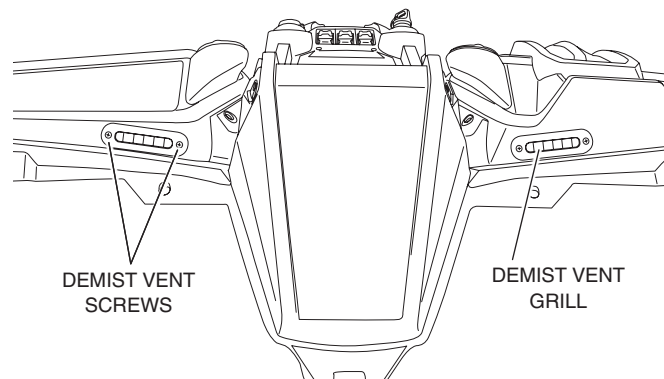

NOTE: Reverse side of dash with Demist Duct Adapters not shown. Be sure that inlet openings face the center of vehicle.



WATCH VIDEO

Scan QR code or visit: tinyurl.com/25khae44

10. Install Male Floor Vent Adapter Ring together through panel into Female Floor Vent Adapter Ring on left side of vehicle. Then snap Floor Vent Louver into Floor Vent Adapter Assembly as shown. Repeat steps for right side.

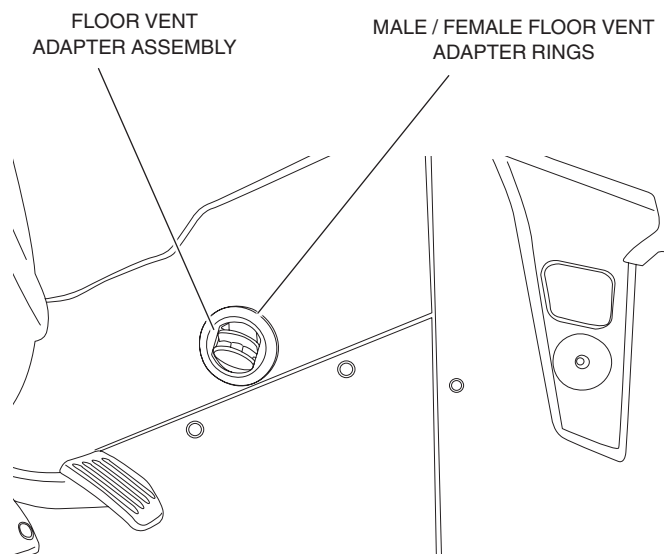

WATCH VIDEO

Scan QR code or visit: tinyurl.com/25spsjq7

11. Mark and cut lower radiator hose as shown. Then install Heater Return Hose using two 1-1/2 inch Hose Clamps as shown. Refer to Torque Chart and tighten hose clamps.

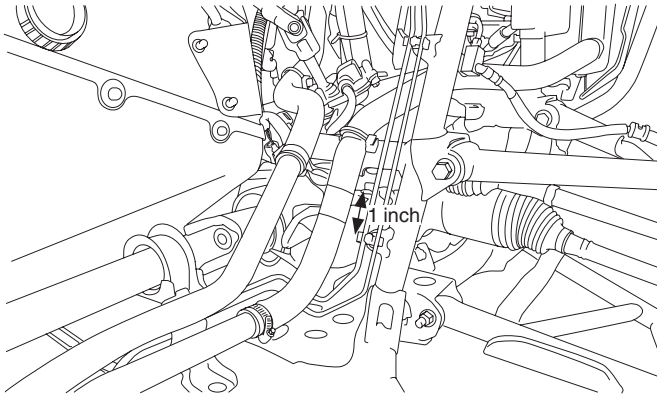

HEATER RETURN HOSE

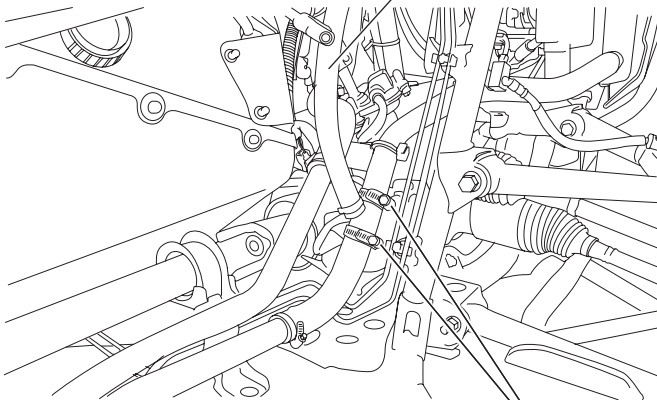

HOSE CLAMPS



WATCH VIDEO

Scan QR code or visit: tinyurl.com/27emwa7e

12. Remove oil cooler hose, then measure, mark and cut hose.

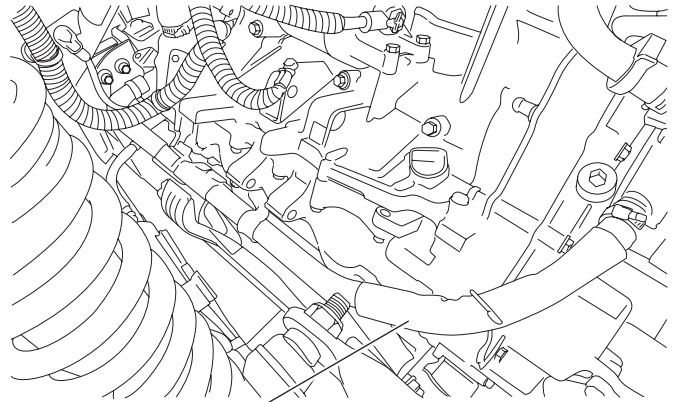

OIL COOLER
HOSE

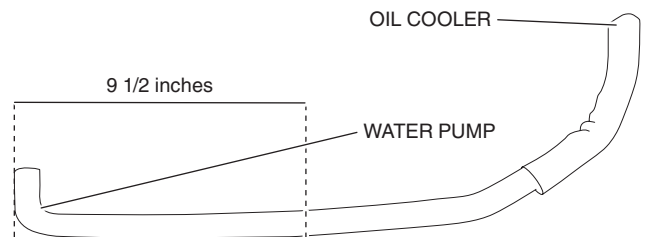

OIL COOLER

9 1/2 inches

WATER PUMP

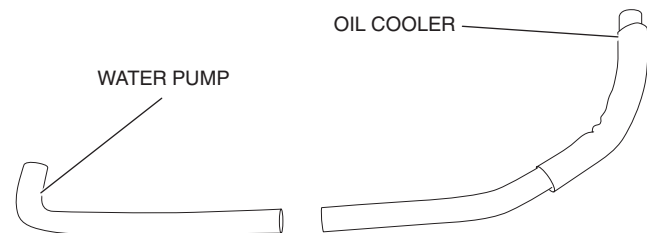

OIL COOLER

WATER PUMP



WATCH VIDEO

Scan QR code or visit: tinyurl.com/26y9444e

13. Connect hose from oil cooler to 45° 1/2-inch OD port and hose to water pump to 90° 1/2-inch OD port on Temperature Control Valve as shown. Install 7/8-inch Hose Clamp loosely over ports.

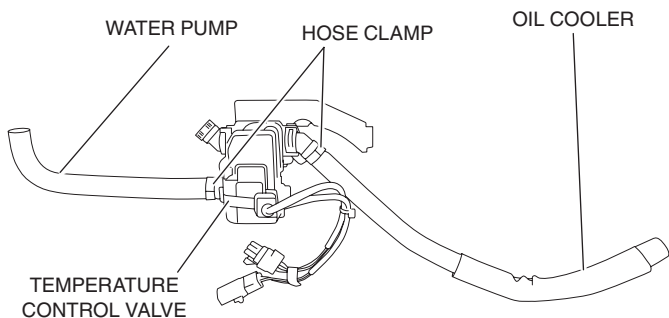

▶ WATCH VIDEO

Scan QR code or visit: tinyurl.com/23w85ozg

14. On starter motor, remove rubber cap (from starter motor terminal), terminal nut, and starter motor cable.

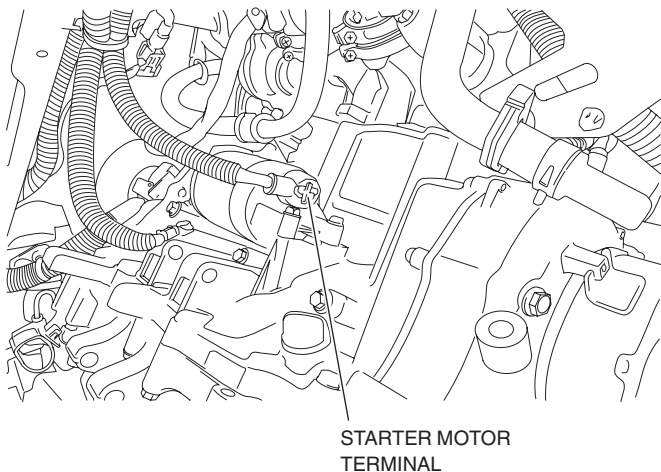

▶ WATCH VIDEO

Scan QR code or visit: tinyurl.com/2bcy3r3h

15. Prepare Heater Inlet Hose:

A) For Talon 4P: Connect Heater Inlet Hose to Temperature Control Valve using 1-inch Hose Clamp as shown. Refer to Torque Chart and tighten hose clamp.

B) For Talon 2P: Cut 31 inches off Heater Inlet Hose then connect to Temperature Control Valve using 1-inch Hose Clamp as shown. Refer to Torque Chart and tighten hose clamp.

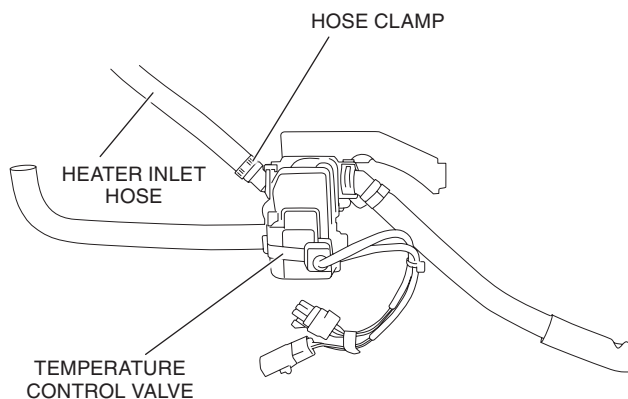

▶ WATCH VIDEO

Scan QR code or visit: tinyurl.com/2dcwy6aw

16. Route and secure Heater Inlet Hose using Cable Ties and two Double Cable Ties starting at rear of vehicle to front of vehicle as shown.

NOTE: Heater Inlet Hose must be routed and secured on frame and away from drive shaft. Do not wrap around evaporator hose if equipped.

NOTE: For Talon 4P, route Heater Inlet Hose as shown.

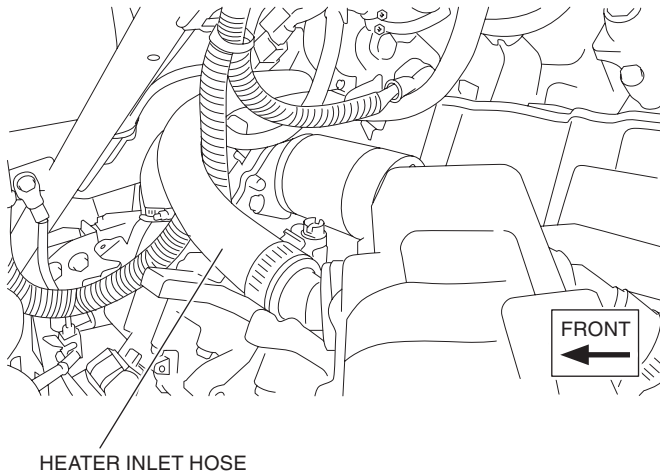

HEATER INLET HOSE



HEATER INLET HOSE

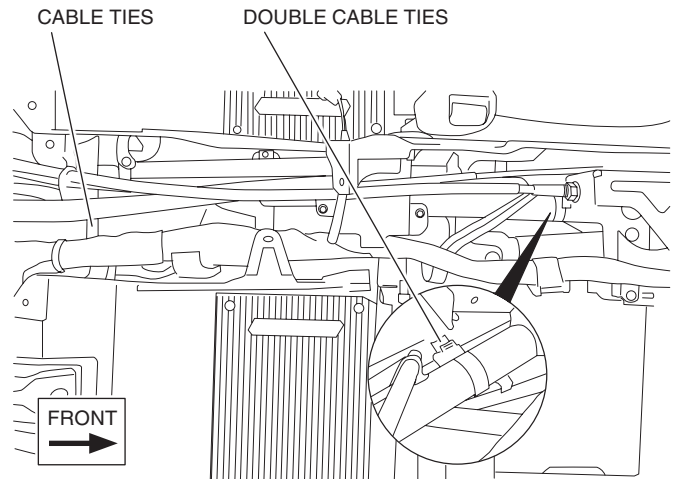

NOTE: Install Double Cable Tie as shown to keep Heater Inlet Hose away from the steering shaft.

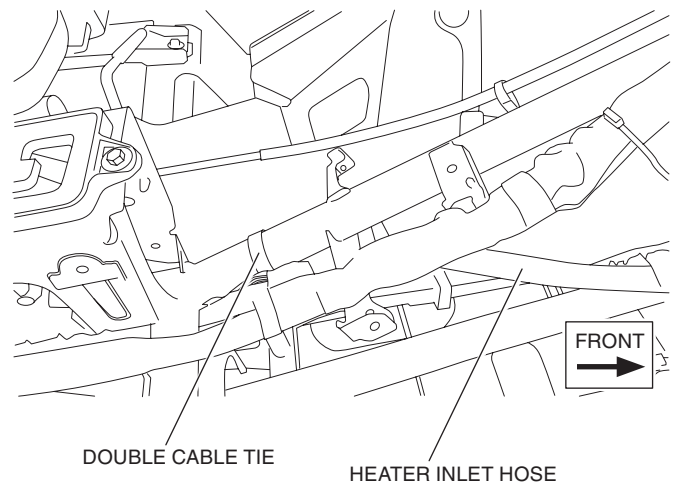

WATCH VIDEO
Scan QR code or visit: tinyurl.com/22u7lh4p

NOTE: For Talon 2P, route Heater Inlet Hose as shown.

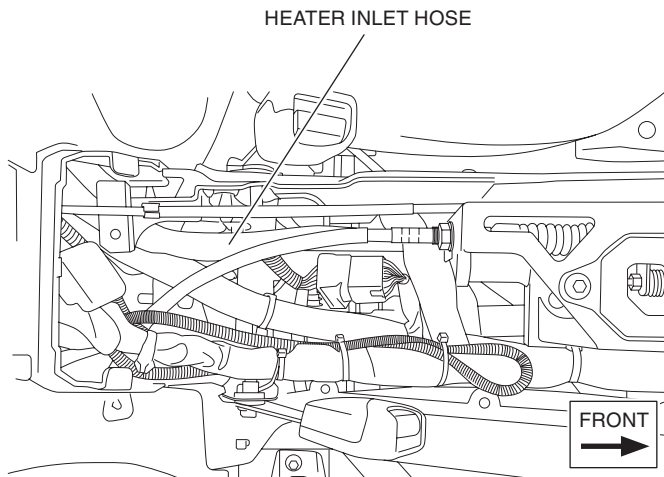

▶ **WATCH VIDEO**

Scan QR code or visit: tinyurl.com/25dzqslr

17. Mount Temperature Control Valve to engine with one M10 × 110 mm Bolt , M10 Lock Washer and M10 Nut. Route starter motor cable over Temperature Control Valve, and reattach terminal nut and rubber cap.

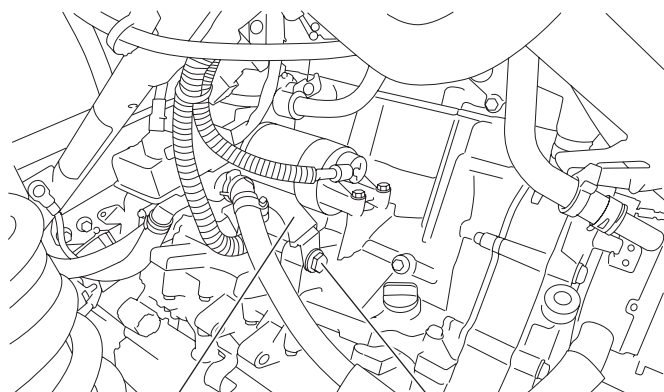

▶ **WATCH VIDEO**

Scan QR code or visit: tinyurl.com/24ahwep4

18. Reconnect oil cooler hose using existing 7/8-inch hose clamp as shown. Refer to Torque Chart and tighten hose clamp.

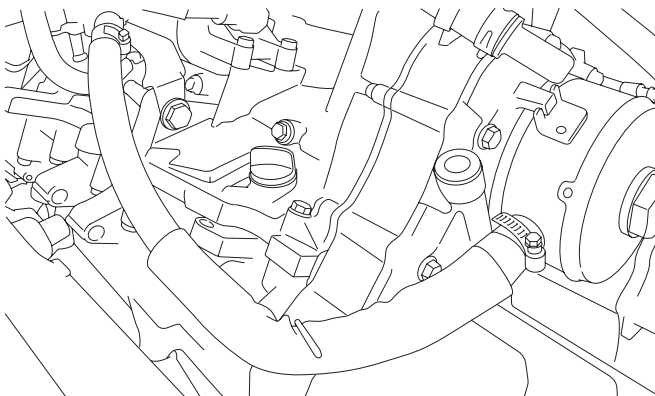

▶ **WATCH VIDEO**

Scan QR code or visit: tinyurl.com/23zz8ym4

19. Reconnect hose to water pump using existing 7/8-inch hose clamp as shown. Refer to Torque Chart and tighten hose clamp.

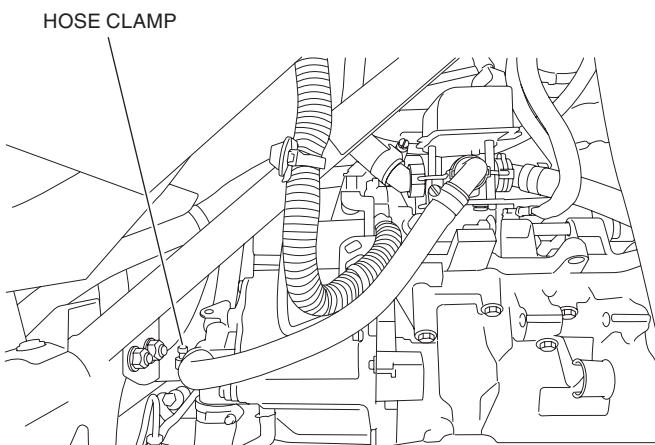

▶ **WATCH VIDEO**

Scan QR code or visit: tinyurl.com/27don4bo

20. Refer to Torque Chart and tighten hose clamps on Temperature Control Valve.

21. At front of vehicle, loosely attach two 1-1/2 inch P-clamps and two 1-inch P-clamps to frame as shown.

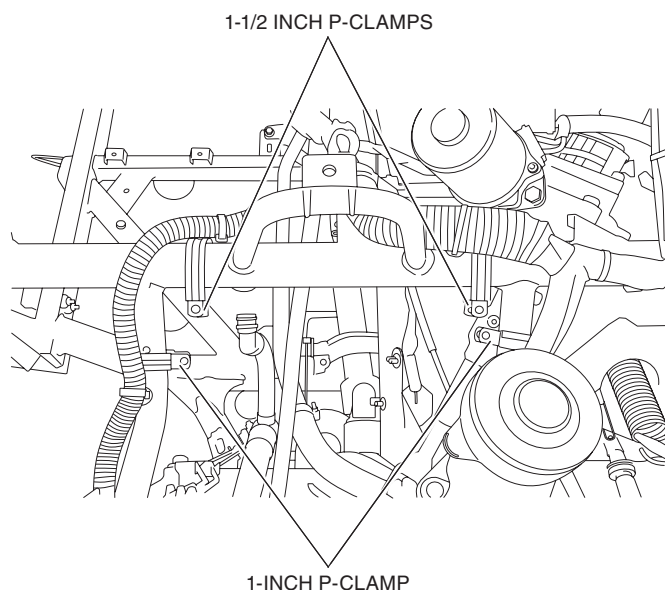

22. Install Left Heater Mount to frame using one 1-inch P-Clamp, one 1 1/2-inch P-Clamp, two M6 × 20 mm Bolts, and two M6 Lock Nuts as shown. Then install Cable Tie Panel Clip as shown.

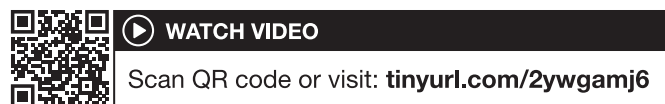
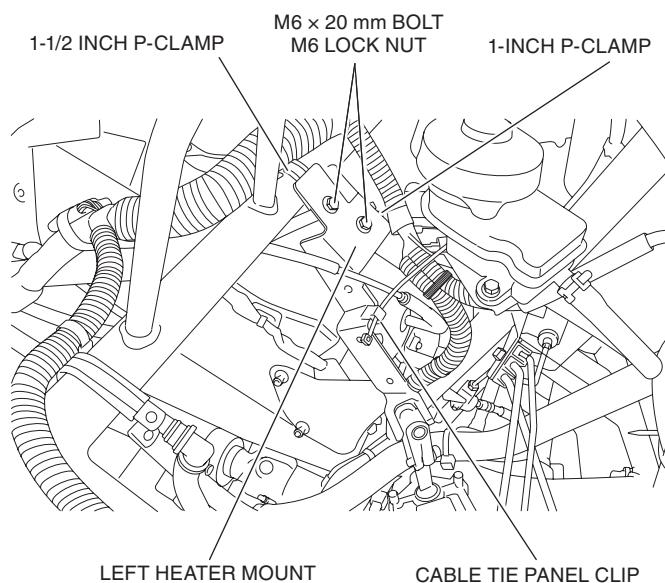

23. Remove plugs from heater core ports and loosely maneuver Heater Assembly as shown. Attach Heater Inlet Hose and Heater Return Hose to the open heater core ports using two Retaining Clips as shown. Ensure ports are locked into position.

NOTE: Use silicone lube on o-rings.

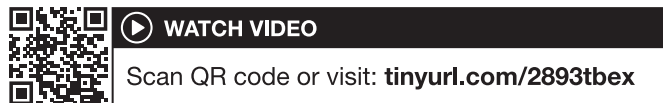
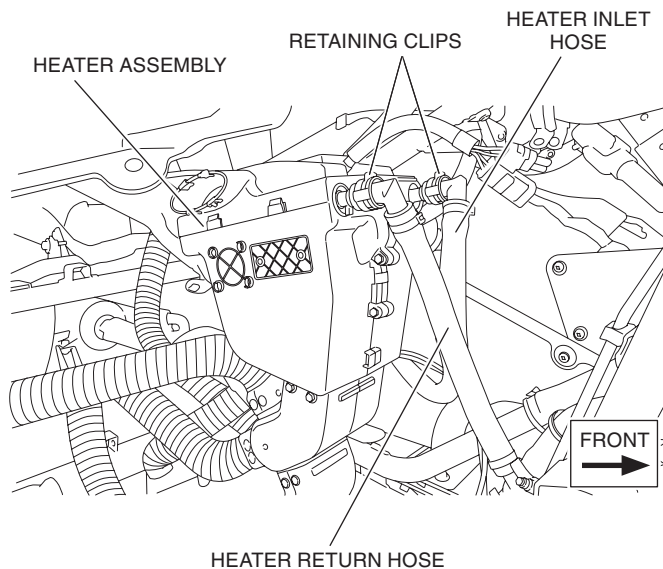

24. Maneuver Heater Assembly into place as shown.

NOTE: Be sure to align mode control ducting with floor vent assembly.

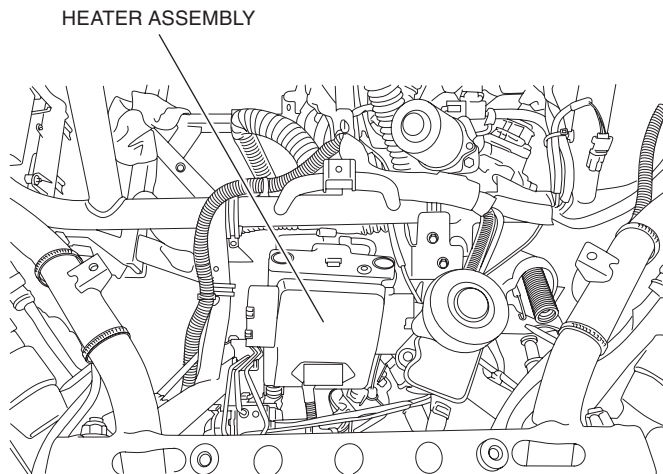

WATCH VIDEO

Scan QR code or visit: tinyurl.com/2aya2784

25. Secure Heater Inlet Hose to Heater Return Hose using Cable Tie as shown.

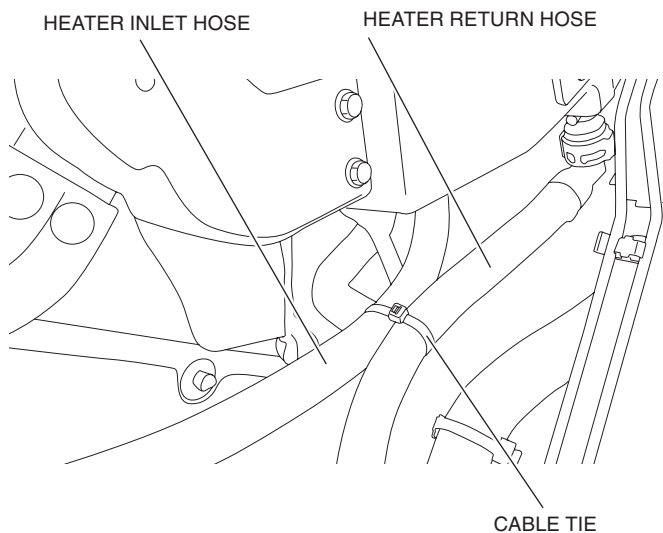

26. Install Right Heater Mount onto frame using one 1-inch P-Clamp, one 1 1/2-inch P-Clamp, two M6 x 20 mm Bolts, and two M6 Lock Nuts as shown.

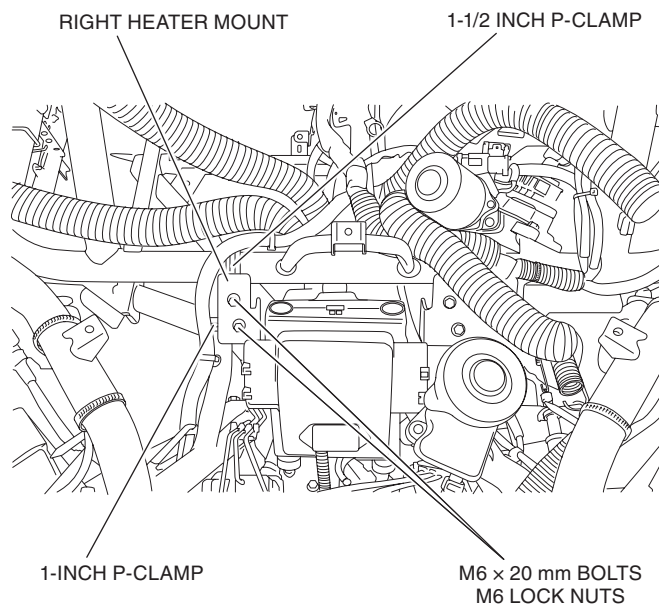

WATCH VIDEO

Scan QR code or visit: tinyurl.com/26bmxpuc

27. Install two Heater Assembly Mount Screws on each side of Heater Assembly.

NOTE: Snug Heater Assembly Mount Screws, over-tightening can cause threads to strip out.

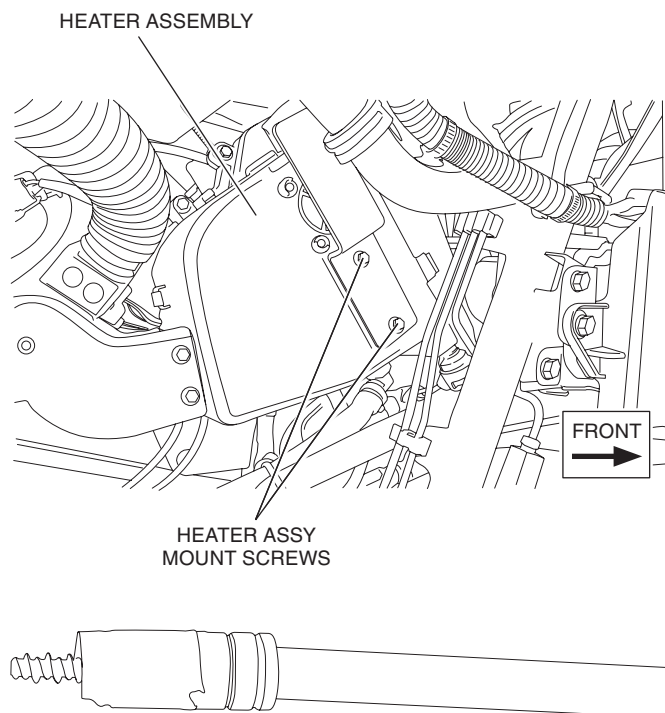

TIP: Use magnetic socket or wrap tape around screw in socket as shown.



WATCH VIDEO

Scan QR code or visit: tinyurl.com/2cyzm9qz

28. Starting at front of vehicle, route Heater Harness along main vehicle harness. Using Cable Tie Panel Clip and Cable Ties, secure to frame and main harness as shown. Connect temperature control valve harness, mode control assembly harness, fan motor, two connections at PWM controller. Control panel connections will be connected at later step.

NOTE: Do not wrap cable ties around evaporation line if equipped.

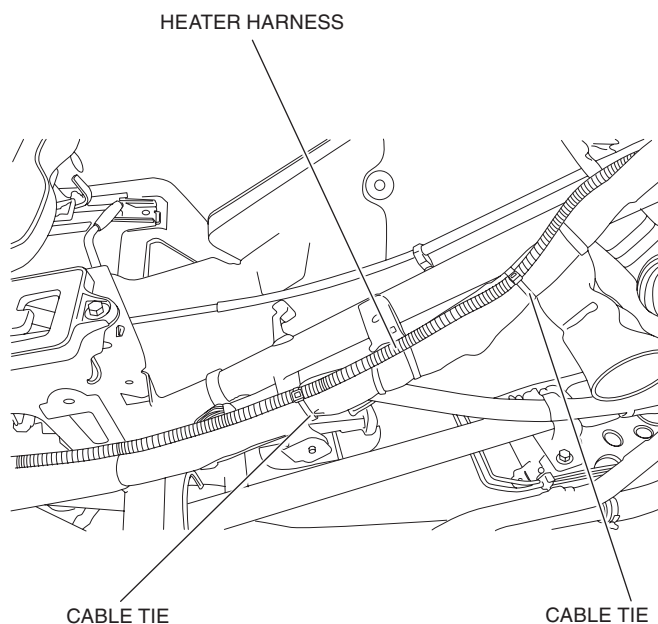
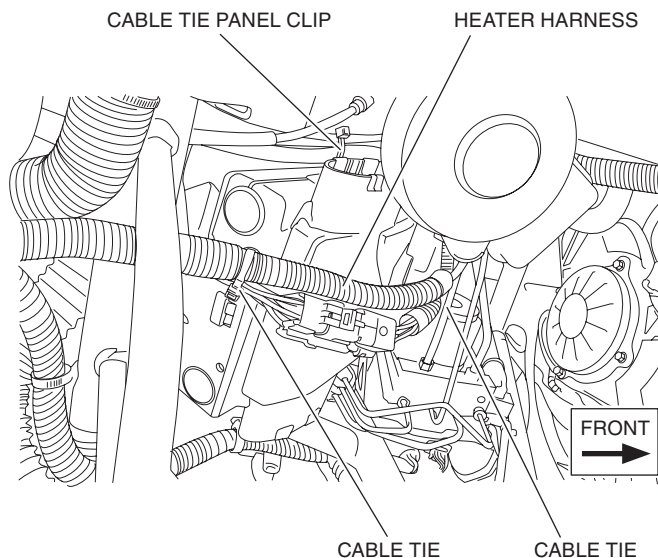

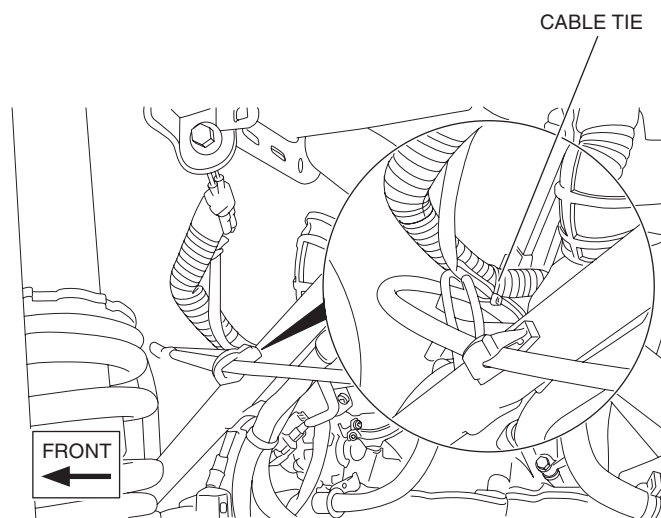
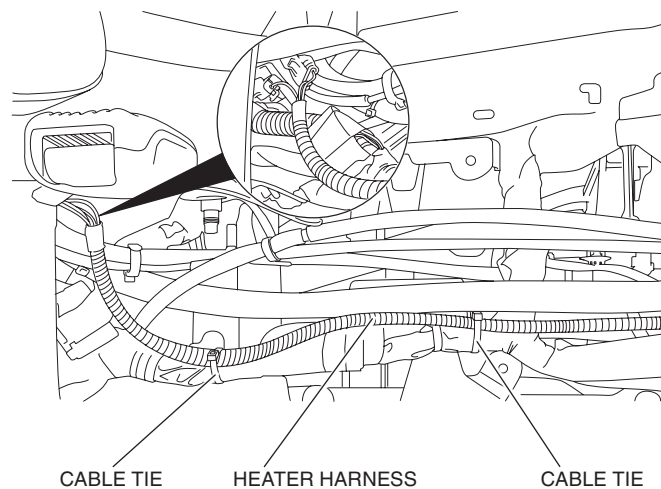
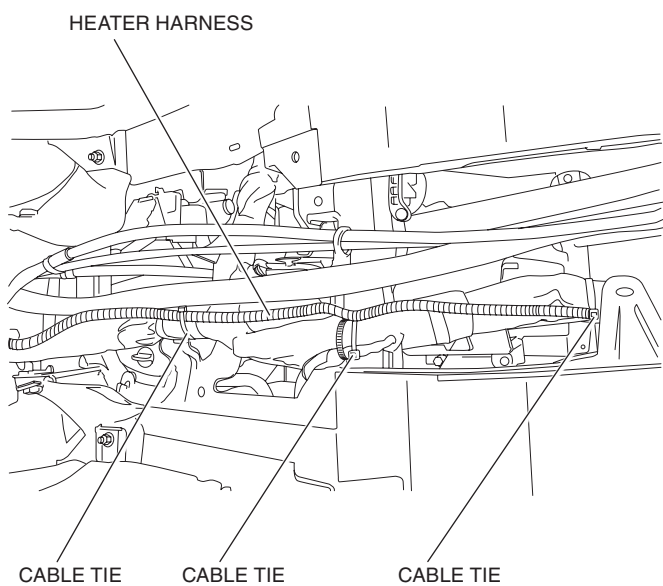
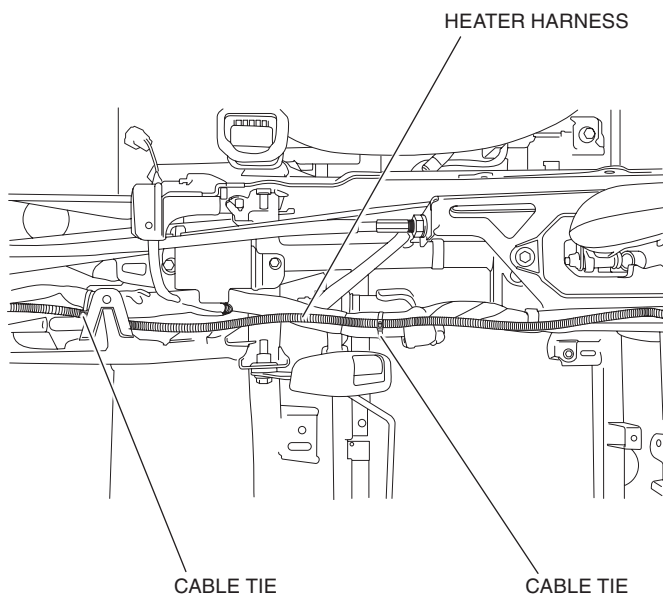

▶ WATCH VIDEO

Scan QR code or visit: tinyurl.com/273r3kex

NOTE: For Talon 2P, coil excess Heater Harness to temperature control harness under center console and away from any moving parts.

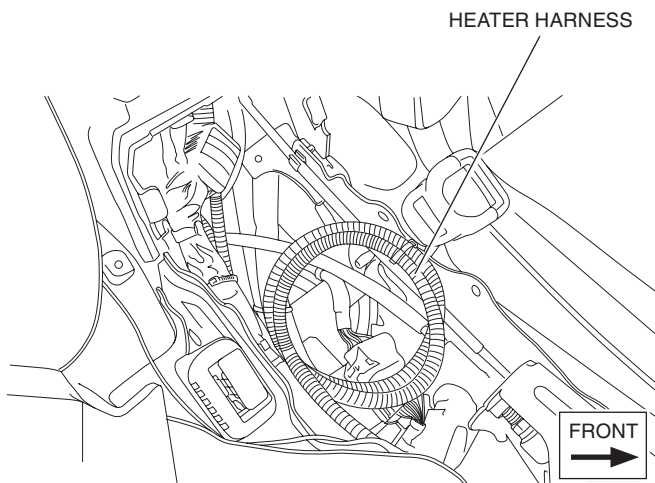

▶ WATCH VIDEO

Scan QR code or visit: tinyurl.com/2ydbq5oq

29. Reassemble components in the following order, in accordance to the Service Manual:

- Right side front floor
- Front right side seat bottom cover

NOTE: Align mode control ducting with floor vent assembly.

- Fuse box lid
- Center instrument panel
- Column damper
- Right side center console panel
- Rear center console (Talon 4P)
- Front center console
- Front right side seat backrest
- Seat cushions
- Right side mud cover

30. Route Heater Harness control panel connections through center pocket hole (cut in step 7) in instrument panel as shown. Then connect control panel connections to corresponding connection on the Control Panel Assembly.

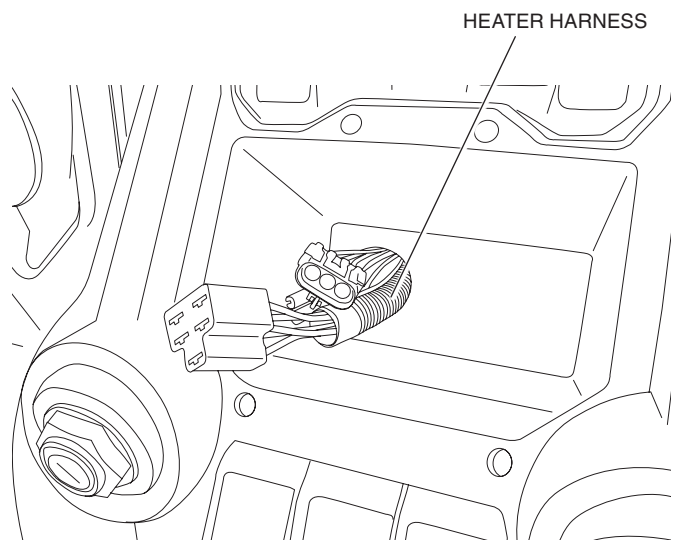

▶ WATCH VIDEO

Scan QR code or visit: tinyurl.com/2adflj5n

31. Install Control Panel Assembly to instrument panel using four Trim Clips as shown. Then snap five Blank Plates into place.

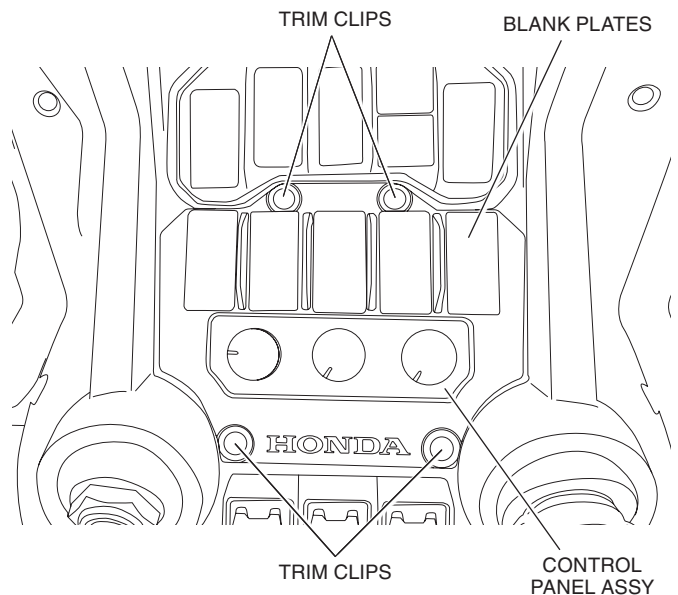

▶ WATCH VIDEO

Scan QR code or visit: tinyurl.com/292qp3av

32. Connect and secure Face Vent Ducting and Demist Vent Ducting using Cable Ties as shown.

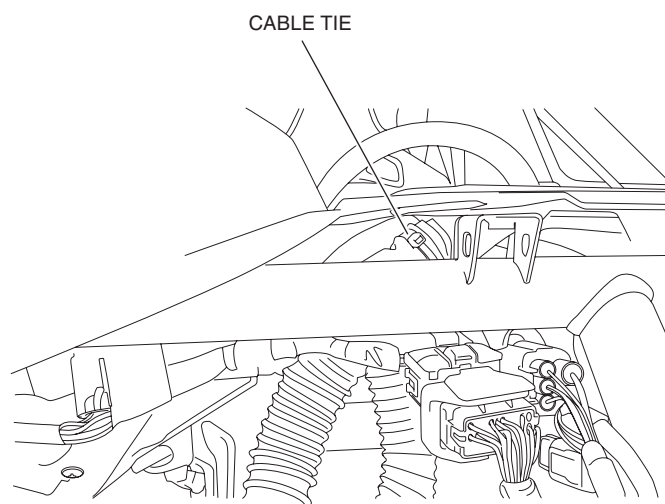
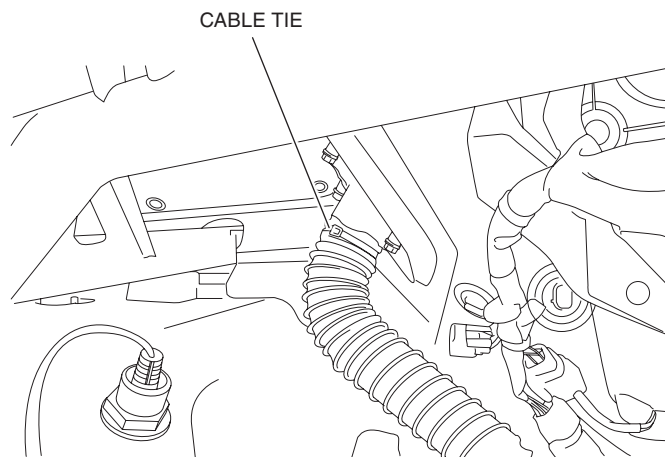
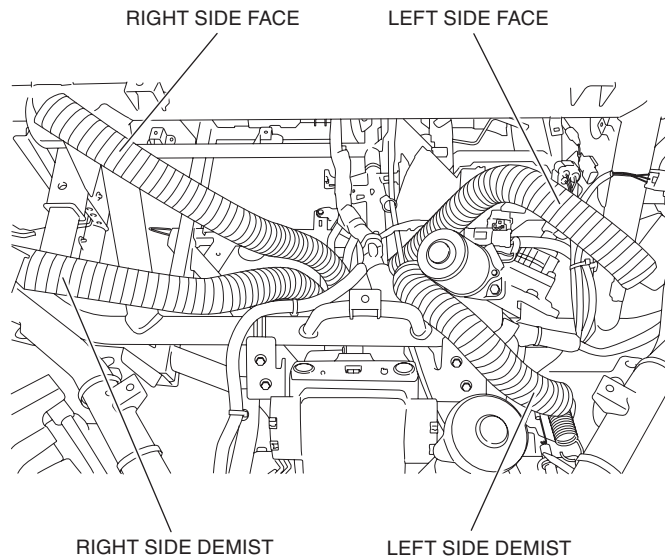

33. Attach Left and Right Return Air Ducts to Heater Assembly as shown.

NOTE: Molded part numbers are on the ends attached to Heater Assembly and facing inside of vehicle.

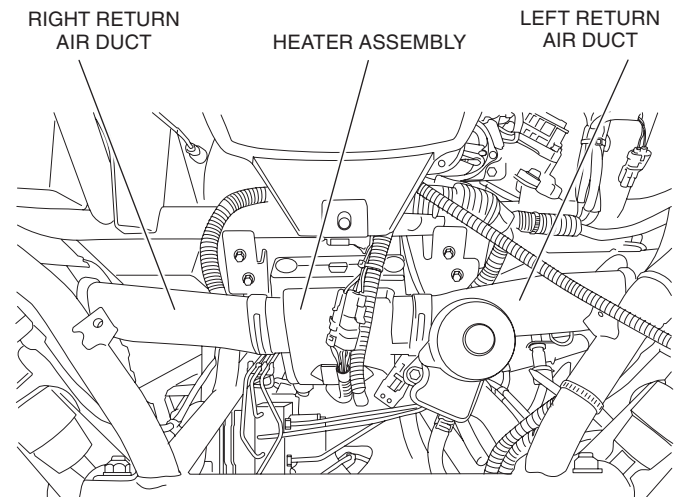

WATCH VIDEO

Scan QR code or visit: tinyurl.com/28lbpct



WATCH VIDEO

Scan QR code or visit: tinyurl.com/228bz2an

34. Attach Return Air Adapter Housings to outside ends of Left and Right Return Air Ducts as shown.

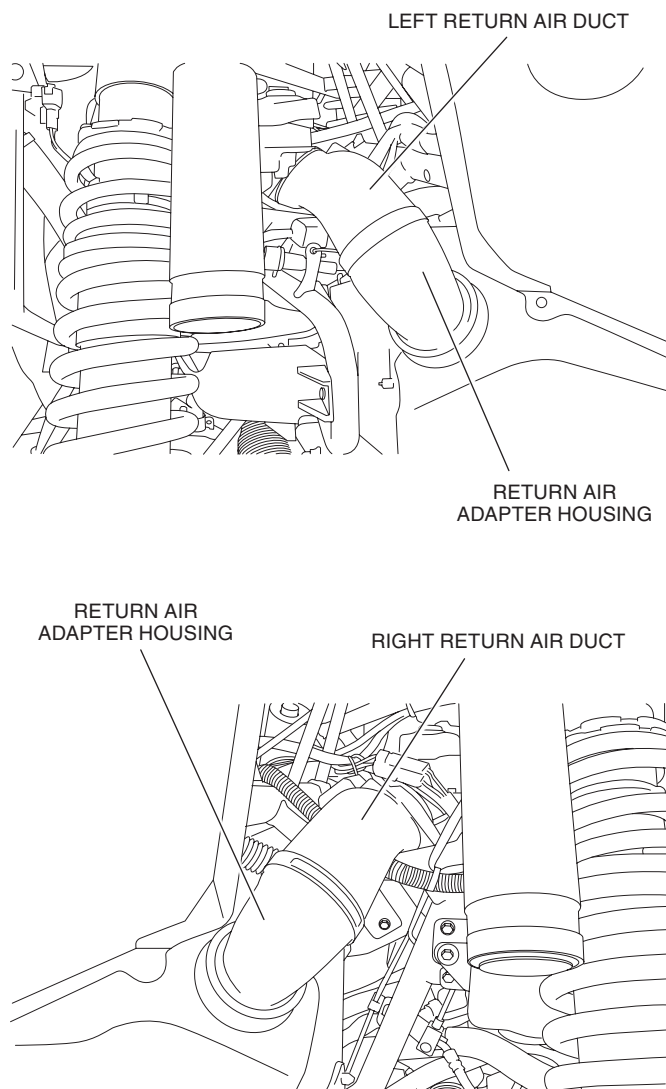

35. Install Return Air Adapter Rings through floor panel and into Return Air Adapter Housings. Then snap Return Air Grills into place as shown.

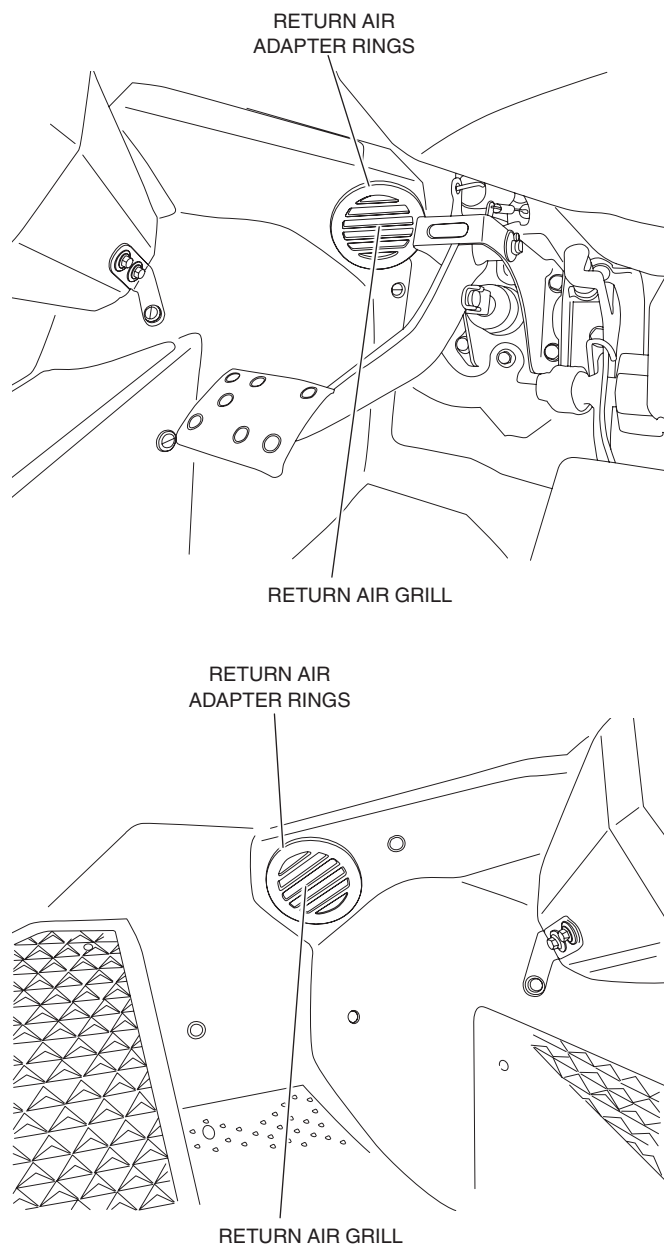

36. Reassemble rear hood in accordance to the Service Manual.

37. Connect Heater Harness power lead to accessory fuse block.

**NOTE: Must be protected by 10 amp fuse.
Additional accessories are not included with
heater kit.**

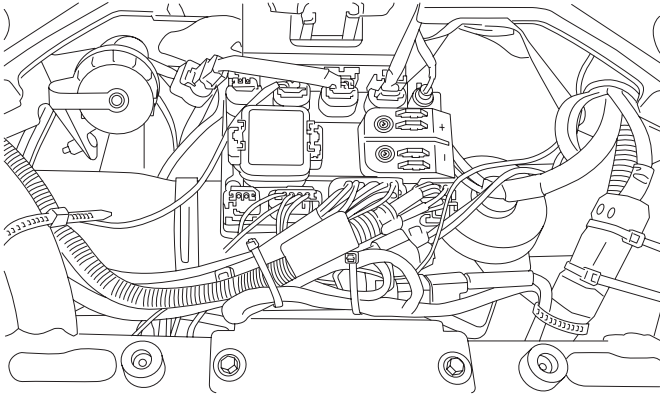

 **WATCH VIDEO**

Scan QR code or visit: tinyurl.com/29akx44r

38. Fill radiator with Pro Honda HP coolant.
39. Connect battery.
40. Bleed engine cooling system according to Service Manual.
41. Reassemble front hood in accordance to the Service Manual.
42. Verify heater functions properly by warming vehicle up to operating temperature, turning temp control to maximum heat, turning fan speed on high, and rotating mode control selection through all configurations. Unit should be blowing warm air. Test drive the vehicle and check the heater performance. Check for leaks and correct as necessary.
43. Top off engine coolant. Make sure the coolant level in the reserve tank is at the MAX level. Coolant will be consumed from the reserve tank as air is expelled from the cooling system during and after test drives. Add coolant to reserve tank as necessary.

TEMPLATES

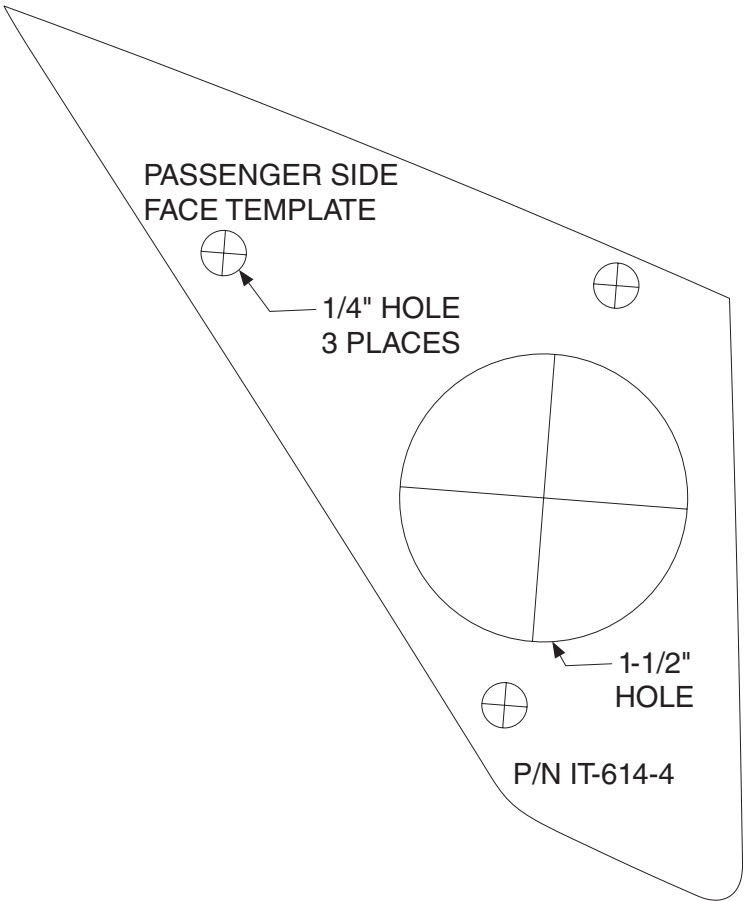
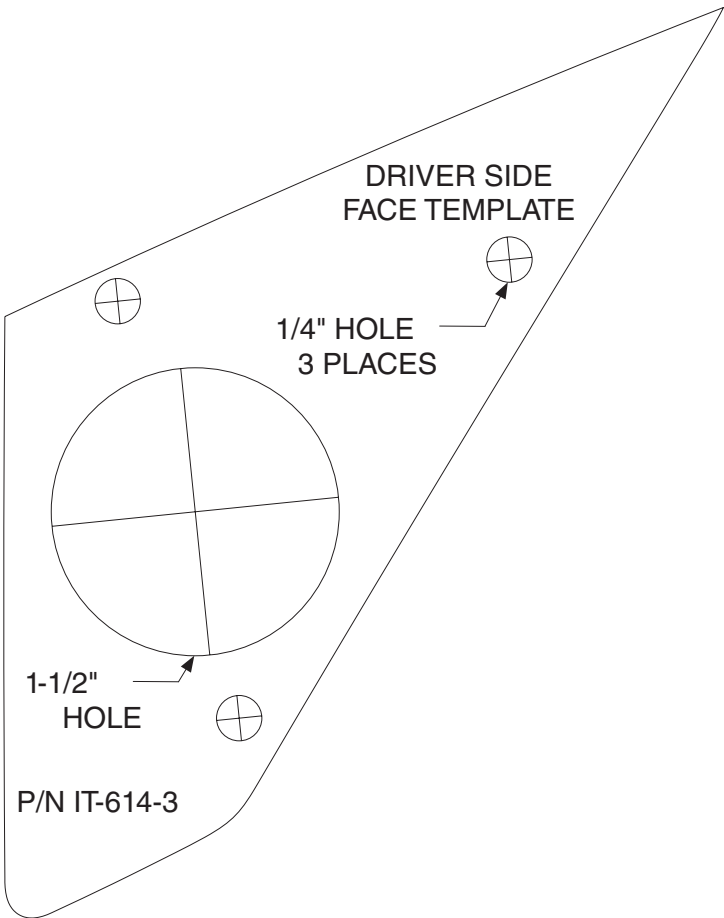
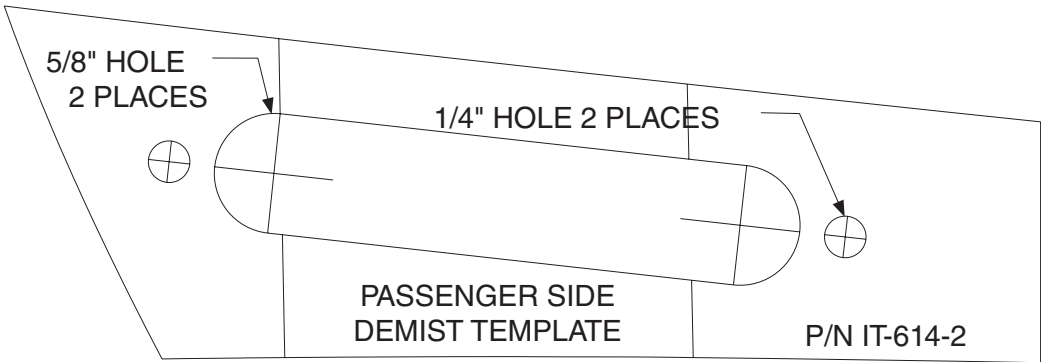
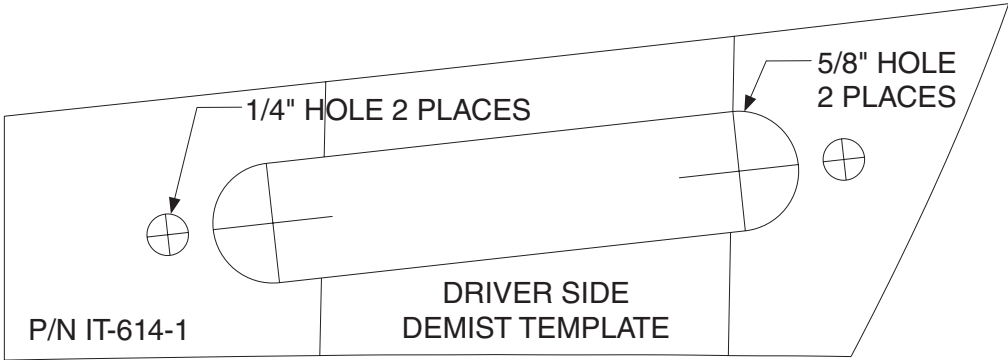

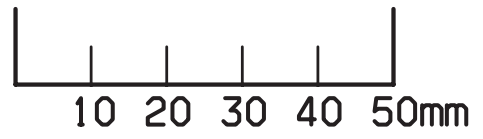
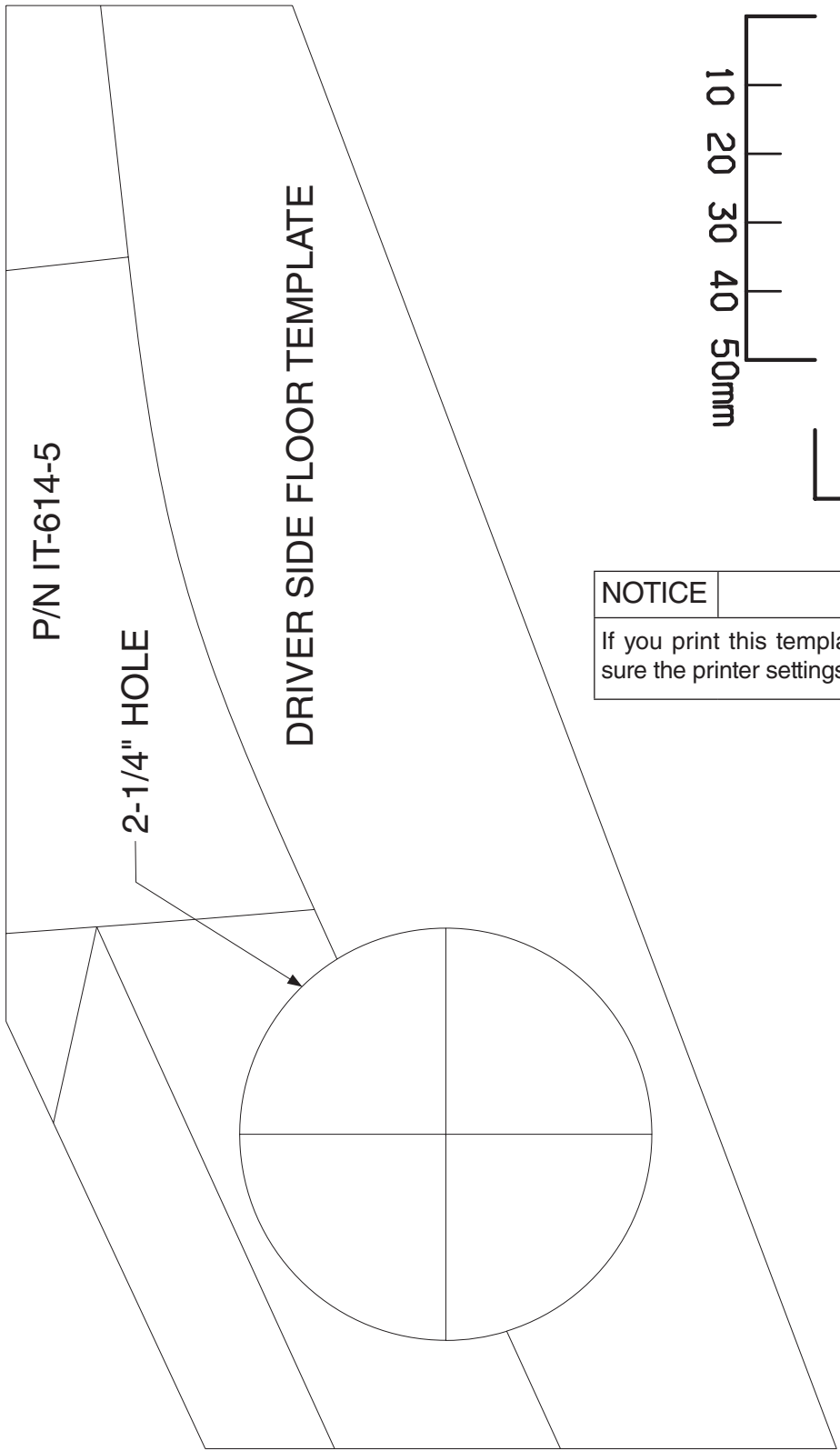

NOTICE	
If you print this template from your local computer, make sure the printer settings do not “scale” or “shrink” the page.	

NOTE: For Passenger Side Floor Template (P/N IT-614-6), cut along cut mark and then register the two pieces together along dashed line before applying.

P/N IT-614-6

PASSENGER SIDE FLOOR TEMPLATE

2-1/4" HOLE



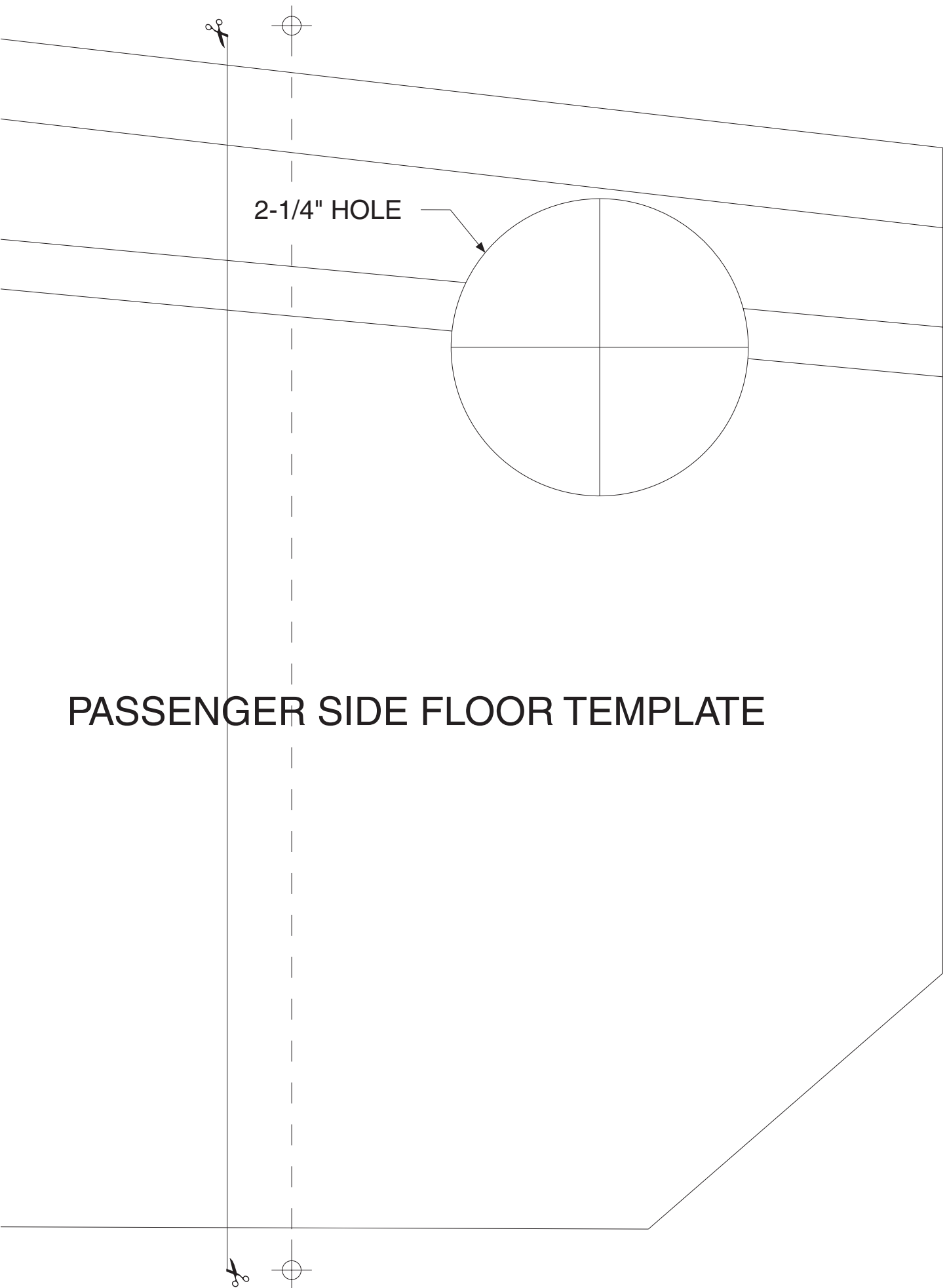

2-1/4" HOLE

PASSENGER SIDE FLOOR TEMPLATE

