

HONDA **INSTALLATION** **INSTRUCTIONS**

Accessory
FOX FRONT SHOCKS
 P/N: 08Z70-HL4 –F00 (M5P/M5D)
 08Z70-HL4 –F50 (M3/M3P)

Application
SXS1000M5P/M5D
SXS1000M3/M3P

Publication No.
MII 16083
 Issue Date
January 2017

PARTS LIST

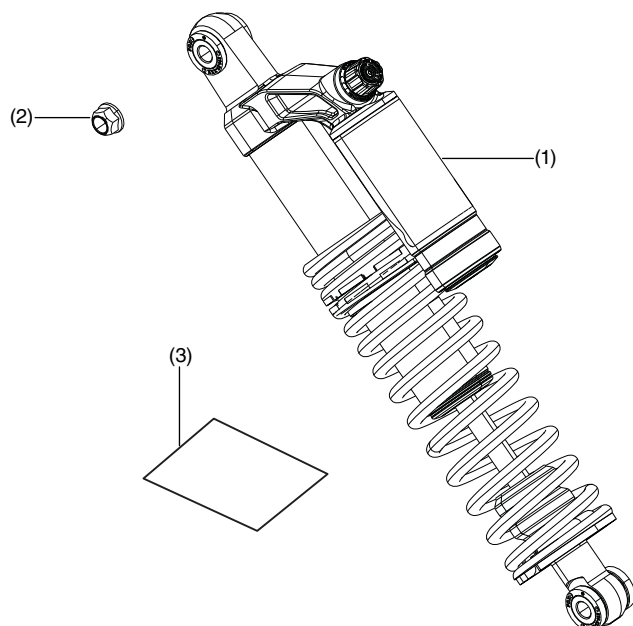

No.	Description	Qty
(1)	Fox front shock absorber	2
(2)	12 mm flange lock nut	4
(3)	Installation instruction URL	1

TOOLS REQUIRED

Box-end wrench (17 mm)

Torque wrench

TORQUE CHART

Tighten all screws, bolts, and nuts to their specified torque values. Refer to the Service Manual for the torque values of the removed parts

Item	N-m	kgf-m	lbf-ft
12 mm flange lock nut	64	6.5	47

USE AND CARE INFORMATION

Check the accessory mounts frequently and retighten if necessary.

INSTALLATION

⚠ CAUTION

- To prevent burns, allow the engine, exhaust system, radiator, etc., to cool before installing the accessory.

NOTE:

- Support the vehicle with an approved lift to raise the front wheels off the ground when installing this accessory.
- Refer to the Owner's Manual or the Service Manual for lift and support points.

- Remove the left front wheel as shown

- Support the vehicle with approved lift to raise the front wheels off the ground.**

<Left side>

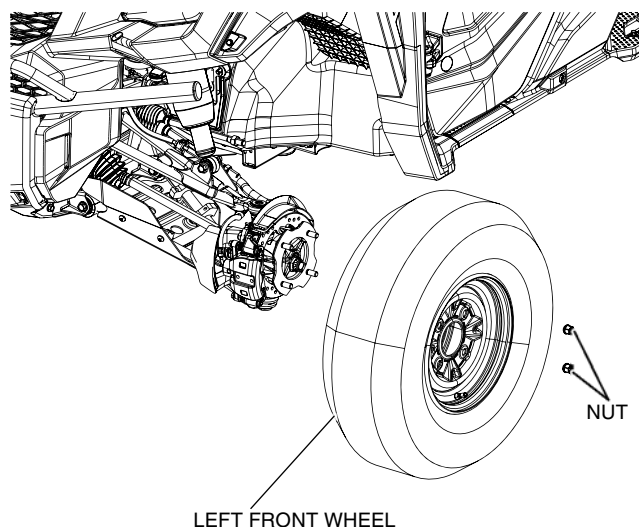

2. Remove the front shock absorber as shown.

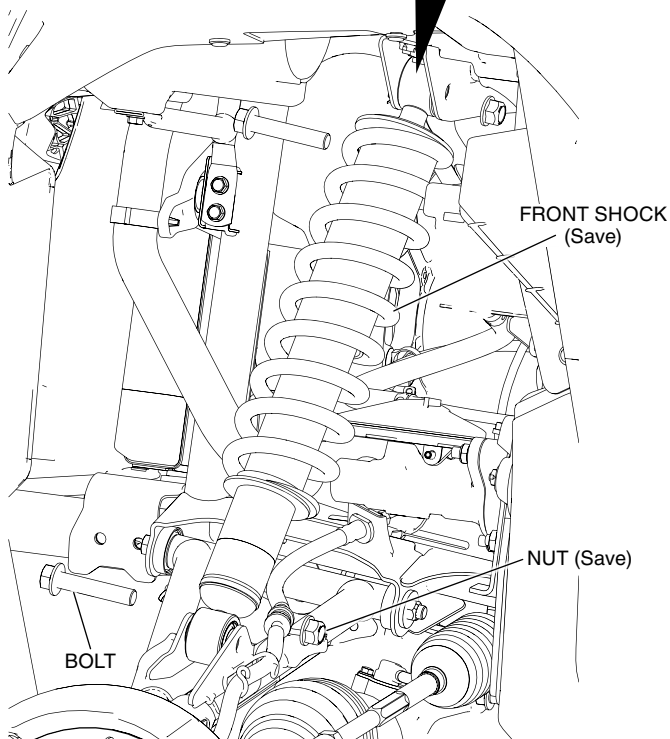
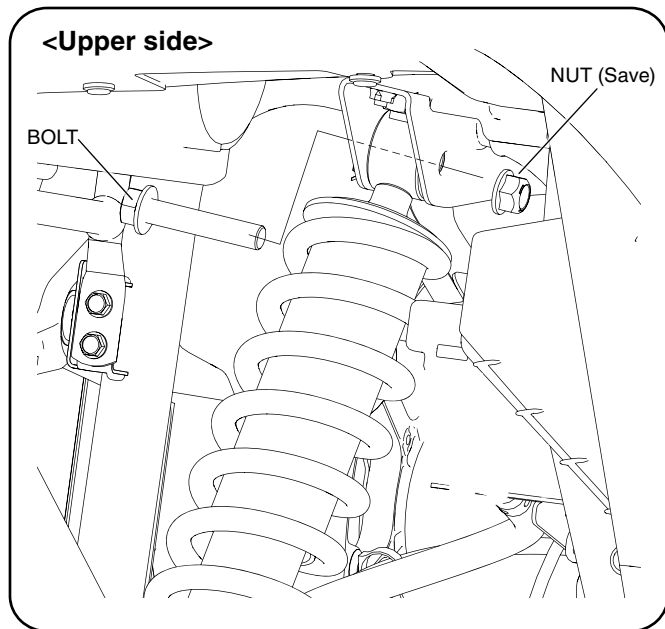

3. Install the accessory shock absorber as shown.

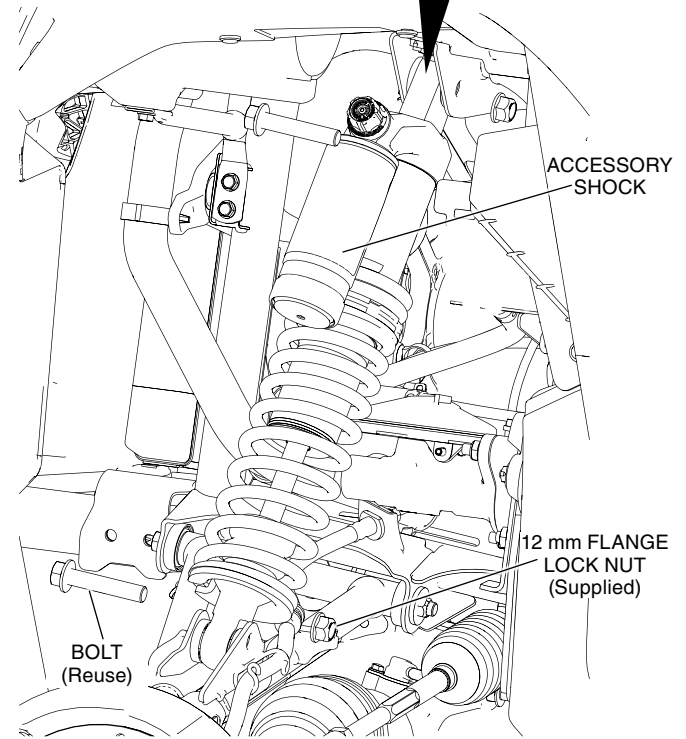
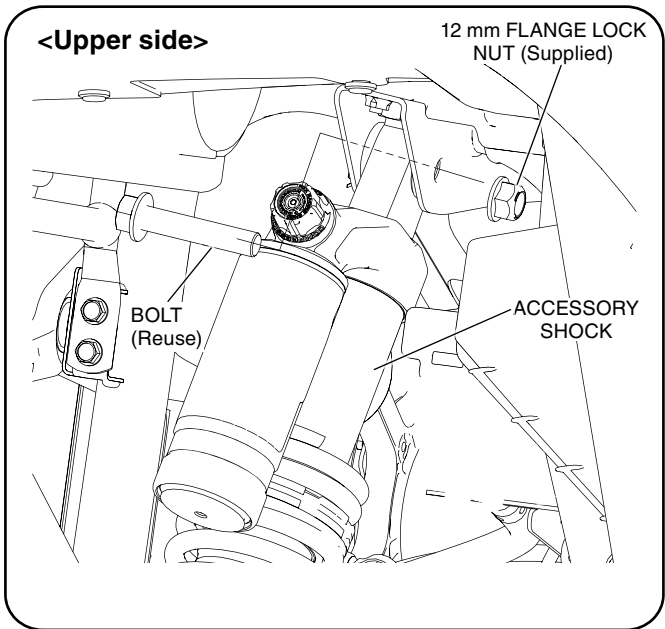

4. Install the front wheel in reverse order of the removal.
Install the wheel nuts with the tapered side facing inward and tighten them.
TORQUE: 108 N·m (11.0 kgf·m, 80 lbf·ft)
5. Repeat Steps 1 through 4 on the right side.