

# **INSTALLATION INSTRUCTIONS**

Accessory

**DRINK HOLDER**  
**P/N 08U70-HL3-A40**

Application

**SXS700M4**  
**SXS1000M3/M5/M6**

Publication No.

**MII 15753**

Issue Date

**Revised: August 2022**

## **PARTS LIST**

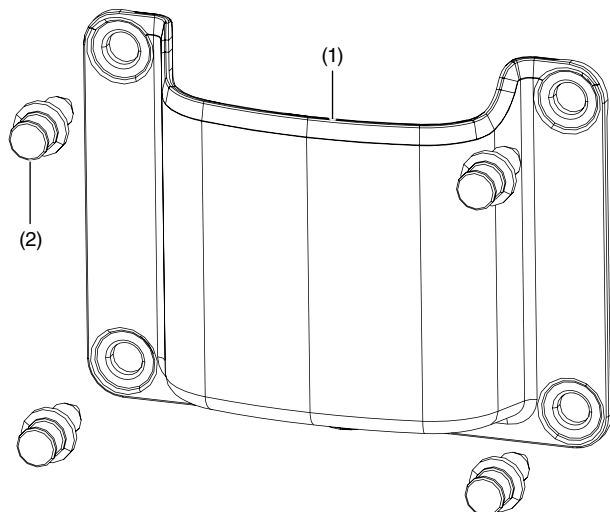

No.	Description	Qty
(1)	Drink holder	2
(2)	Trim clip	8

## **TOOLS AND SUPPLIES REQUIRED**

Power drill

Drill bit (8 mm)

## **INSTALLATION**

### **SXS700M4/M4D REAR DOOR**

1. Drill through the four dimpled areas in the rear door using an 8 mm drill bit as shown.

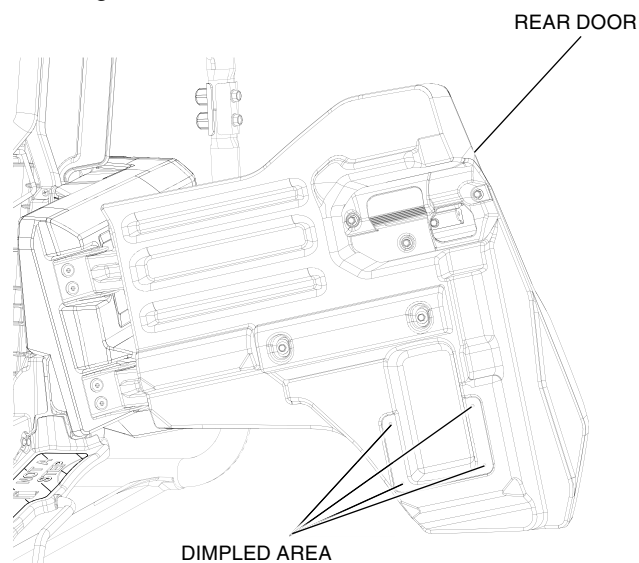

2. Install the drink holder with four trim clips through the holes drilled in Step 1 as shown.

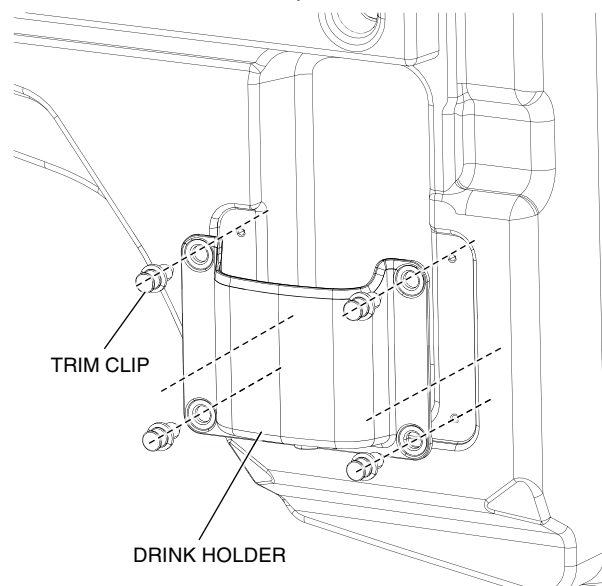

### SXS1000 FRONT DOOR

1. Drill through the four dimpled areas in the front door using an 8 mm drill bit as shown.

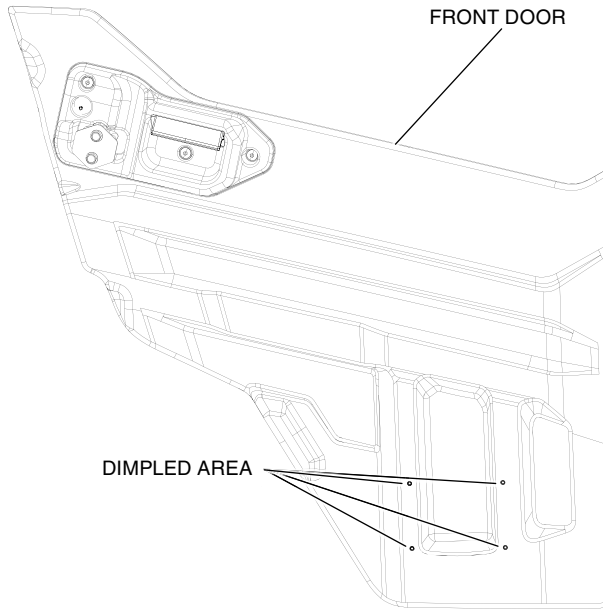

2. Install the drink holder with four trim clips through the holes drilled in Step 1 as shown.

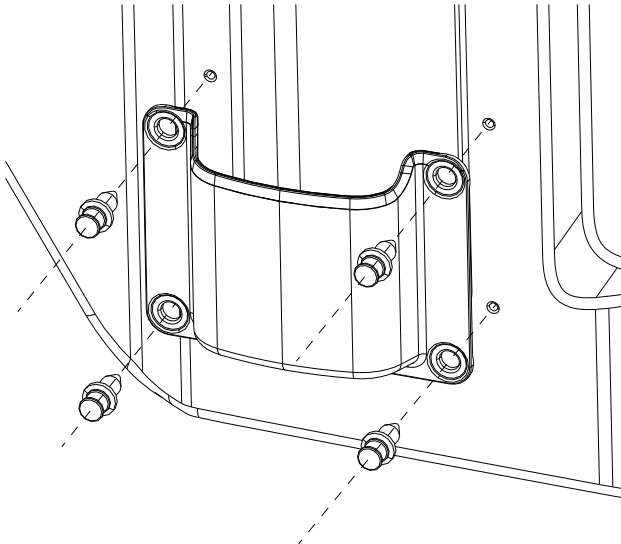

### SXS1000 REAR DOOR

1. Drill through the four dimpled areas in the rear door using an 8 mm drill bit as shown.

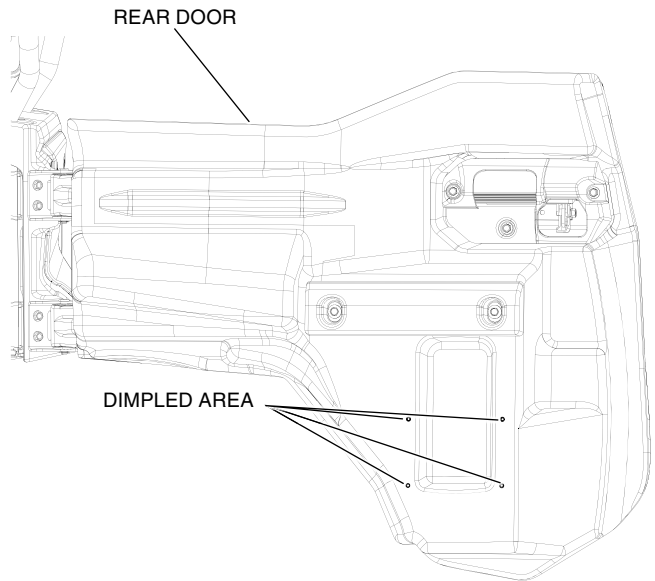

2. Install the drink holder with four trim clips through the holes drilled in Step 1 as shown.

