

HONDA

INSTALLATION INSTRUCTIONS

Accessory

HEATED GRIPS
P/N 08T72-MKS-E00

Application

CRF1100A/D

Publication No.

MII 17351

Issue Date

February 2020

Honda Dealer: Please give a copy of these instructions to your customer.

PARTS LIST

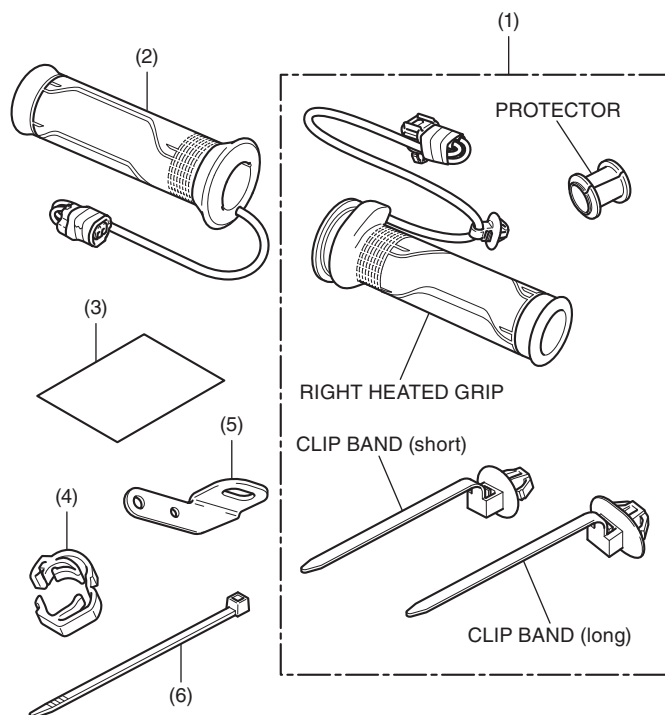

No.	Description	Qty
(1)	Right heated grip unit	1
(2)	Left heated grip	1
(3)	Installation Instruction URL	1
(4)	Harness clamp	1
(5)	Stay	1
(6)	Wire tie	2

TOOLS AND SUPPLIES REQUIRED

Flat-tip screwdriver
 Snips
 Marker
 Ruler
 Electrical tape
 Pro Honda Handgrip Cement
 Thread lock
 Grease
 Isopropyl alcohol
 Shop towel
 Torque wrench

INSTALLATION

▲ CAUTION

- To prevent burns, allow the engine, exhaust system, radiator, etc., to cool before installing the accessory.
- Be sure to observe all safety messages and precautions described in the Service Manual while removing and installing the fuel tank.

NOTE:

- Remove the right grip as instructed in the motorcycle's Service Manual.
- For secure adhesion of the heated grips use the recommended adhesive agent (Pro Honda Handgrip Cement) or equivalent.
- Be sure to open and close the throttle to check for smooth operation after installation of the right heated grip.
- Disconnect the negative (-) cable from the battery before installing this accessory.
- The memory of the clock will be erased when you disconnect the battery. Reset the clock after reconnecting the battery.
- Reinstall the removed parts on the motorcycle and make sure that the wires and harnesses are not pinched.
- Cut the wire tie and clip band at 5 mm from the lock part after attaching them to the wire harnesses. Do not allow the cut part of the wire tie to interfere with another harness or brake hose.
- After heated grip installation, check the lights (e.g. right / left turn signal lights and brake lights) for proper operation.
- Although the illustration is of CRF1100A, use the same procedures for CRF1100D model.

1. Remove the rear seat as shown.

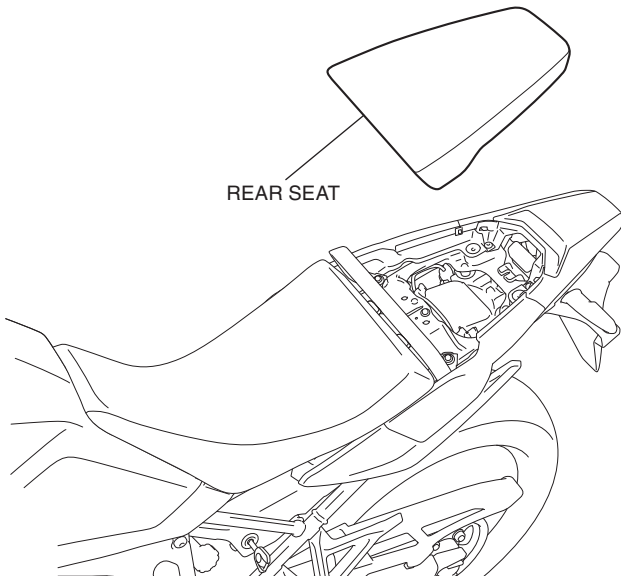

2. Remove the main seat as shown.

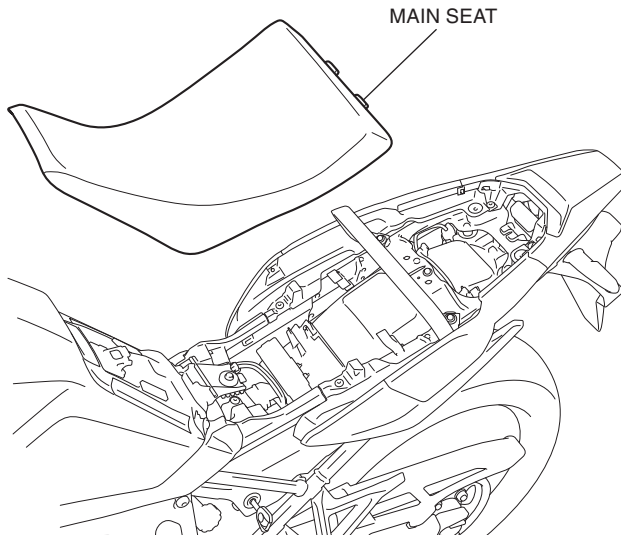

3. Remove the tool box and disconnect the negative (-) cable of the battery.

<Left side>

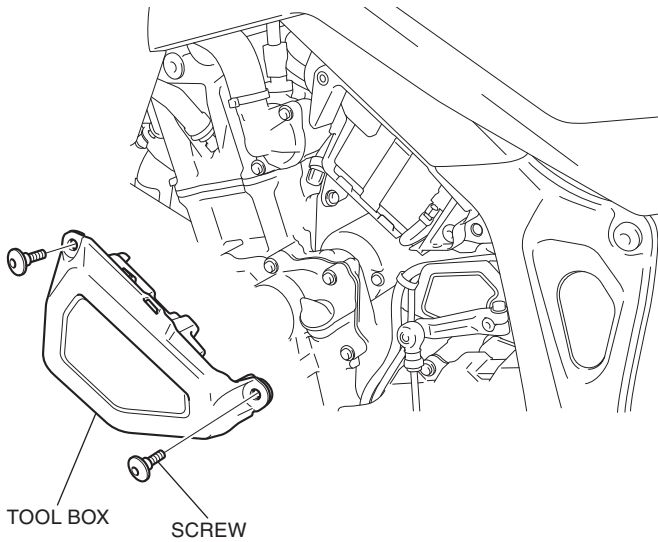

4. Remove the screw as shown.

- Repeat on the right side.

<Left side>

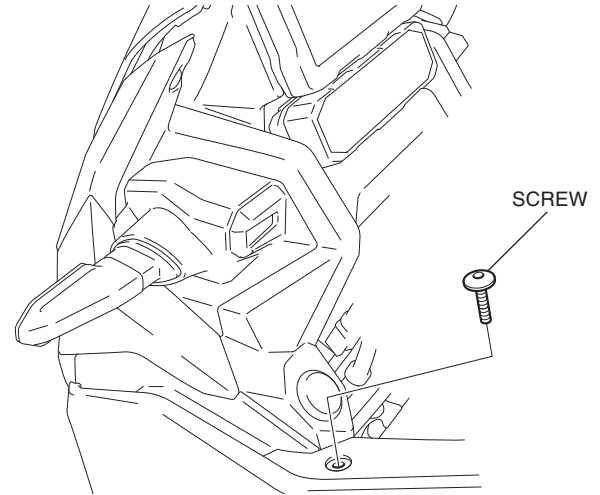

5. Remove the clips as shown.

- Repeat on the right side.

<Left side>

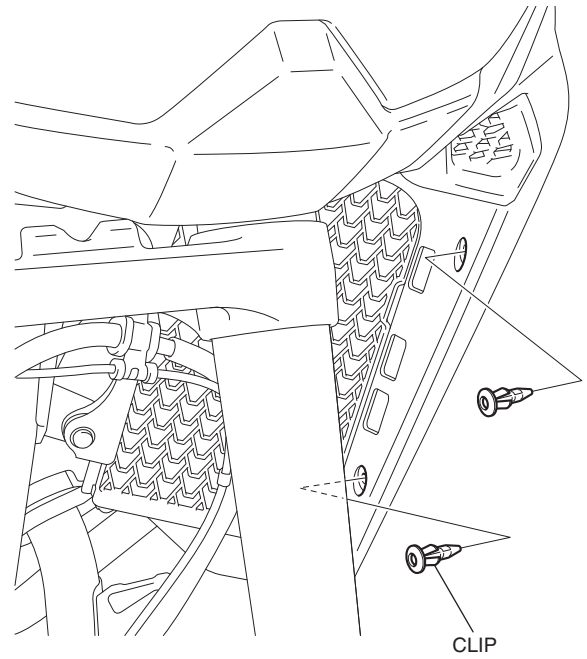

6. Remove the front tank cover as shown.

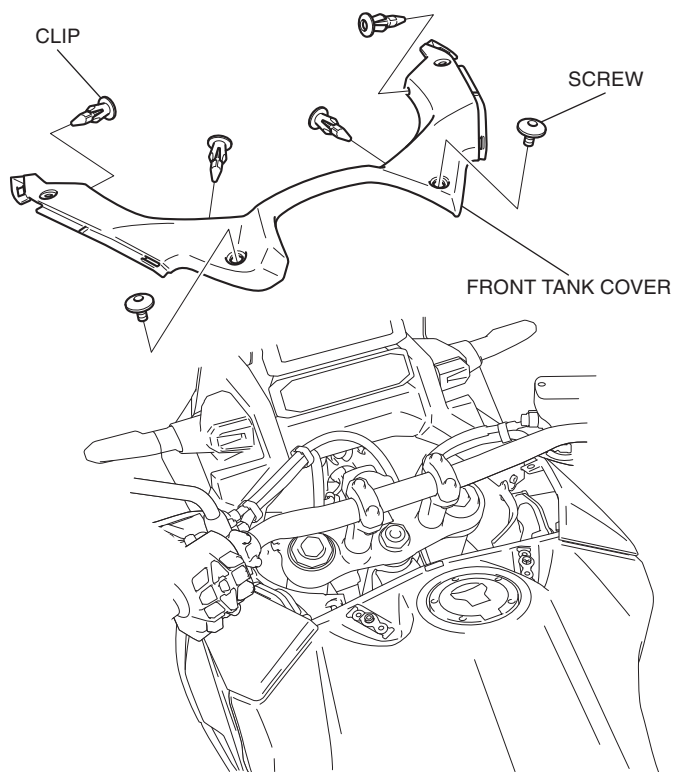

7. Remove the left middle cowl as shown.

<Left side>

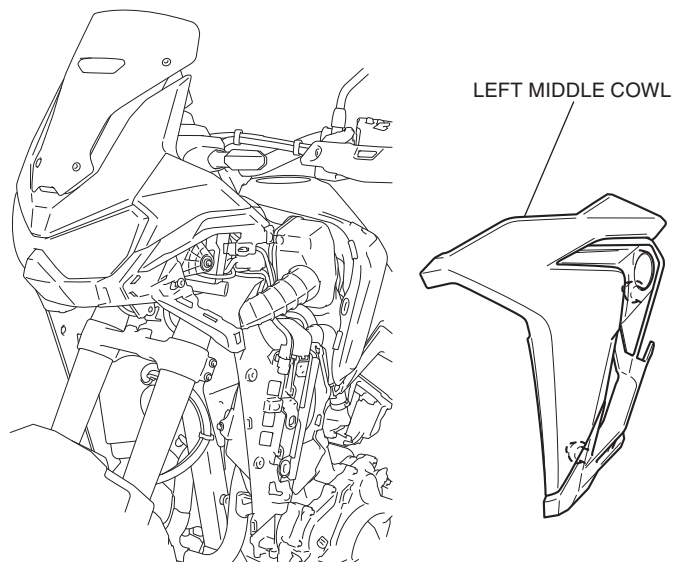

8. Remove the right middle cowl in the same manner as the left side.

9. Remove the right tank side cover as shown.

<Right side>

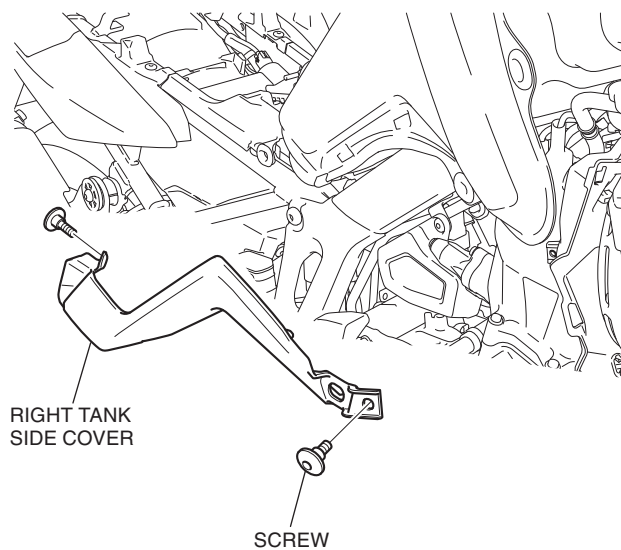

10. Remove the right side inner cover as shown.

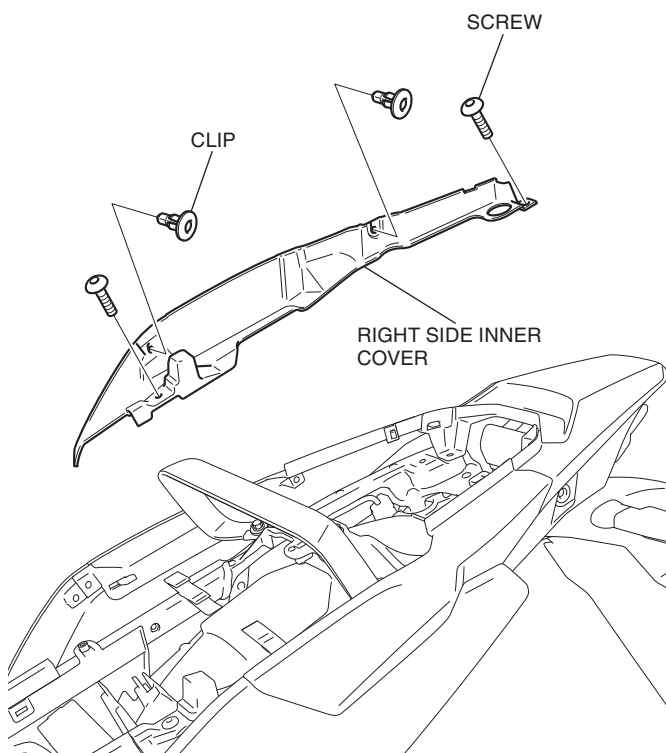

11. Remove the left tank side cover and left side inner cover in the same manner as the right side.
12. Remove the right and left seat under covers as shown.

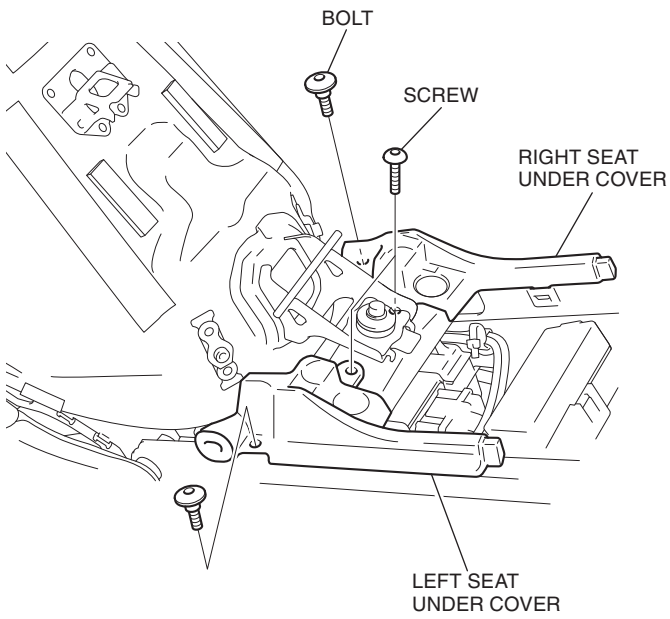

13. Remove the parts as shown.

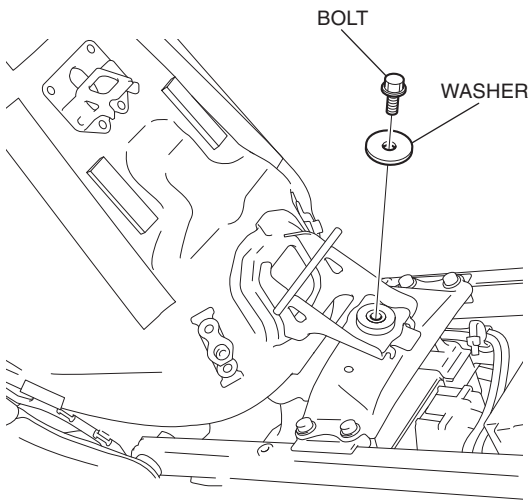

14. Raise the fuel tank as shown.

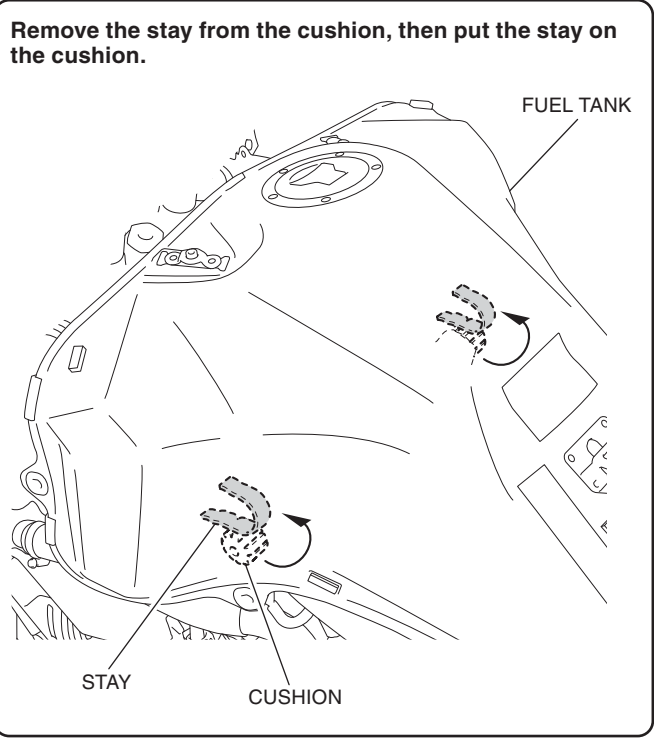
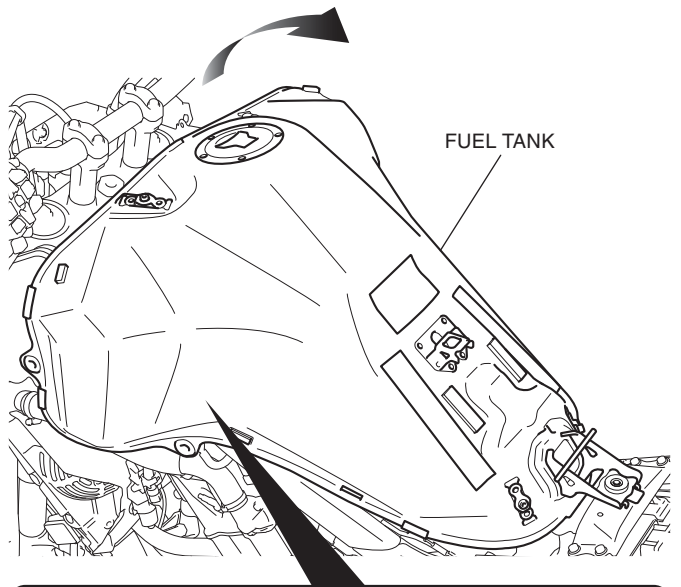

15. Loosely install the fuel tank as shown.
- Use the bolt and washer to loosely install.

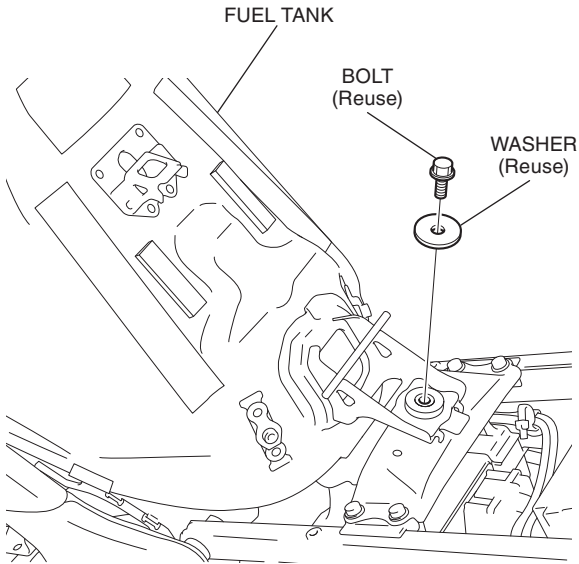

16. Remove the screw as shown.
- <Left side>

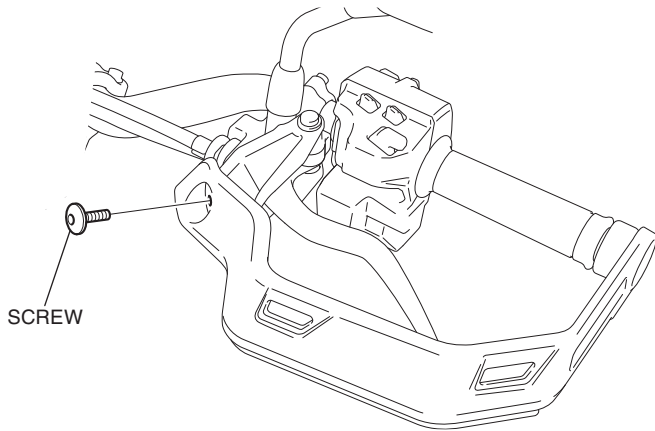

17. Remove the parts as shown.
- Repeat on the right side.

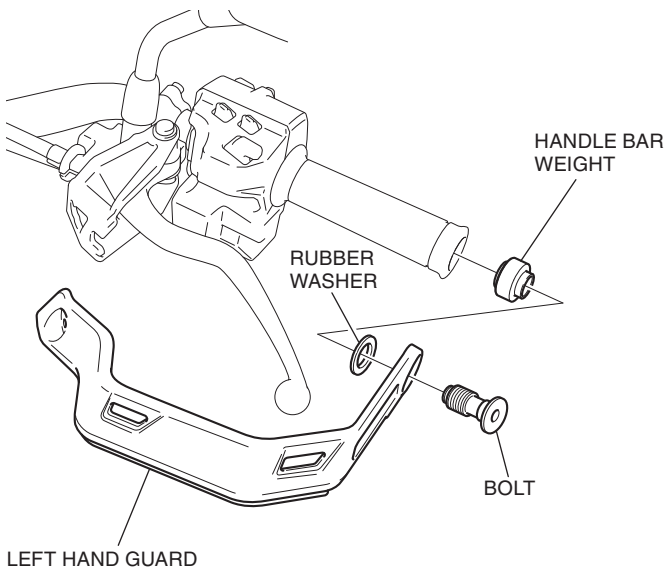

18. Remove the left grip as shown.

<Left side>

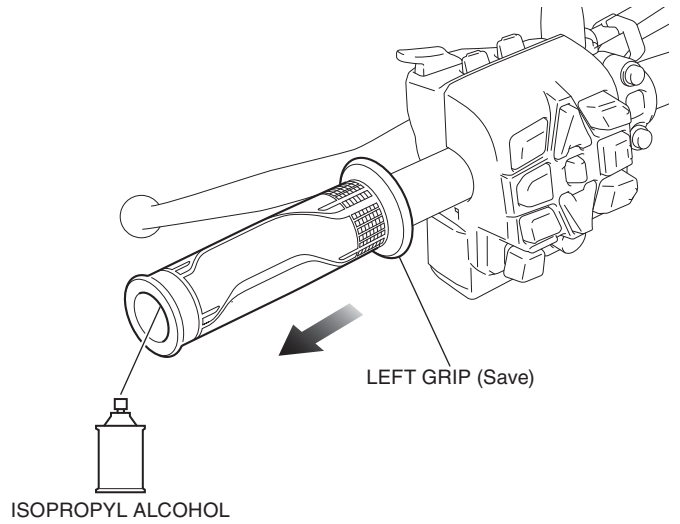

19. Using isopropyl alcohol, remove all traces of adhesive from the left handlebar.

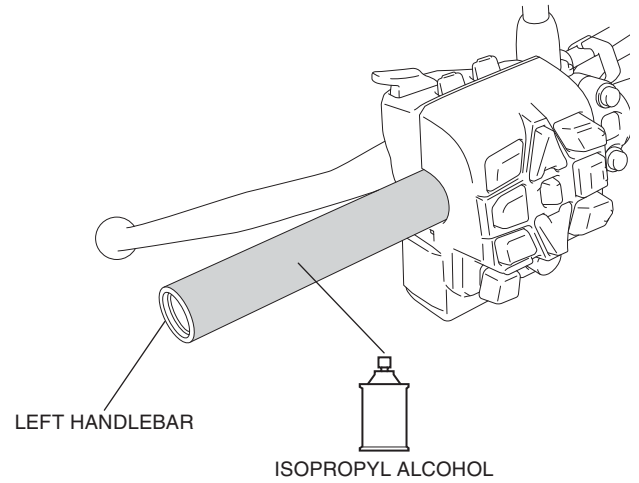

20. Loosen the bolts and move the lever bracket as shown.

<Left side>

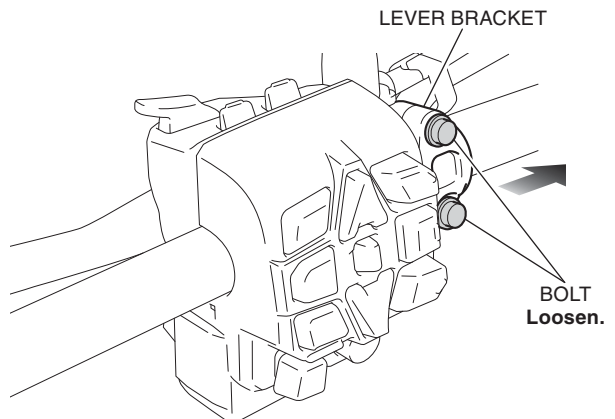

21. Remove the turn signal switch rear housing as shown.

<Left side>

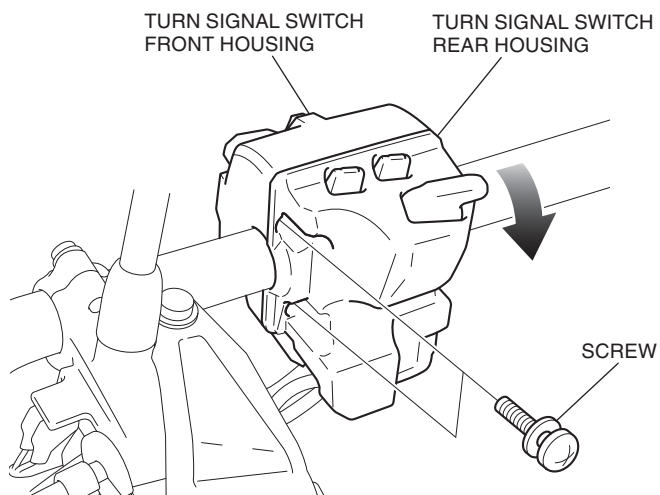

22. Liberally apply Pro Honda Handgrip Cement to the inside of the left heated grip from the kit as shown.

NOTE

Read the Instructions of the steps 22 through 25 carefully before operation and complete the installation quickly before the adhesive agent cures. Use an assistant to steady the motorcycle while installing the grips.

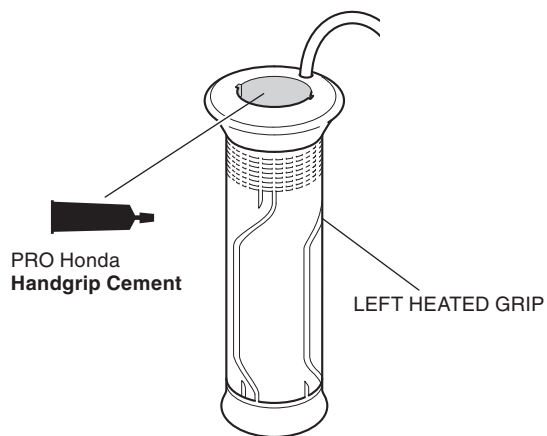

23. Apply the Pro Honda Handgrip Cement to the left handlebar as shown.

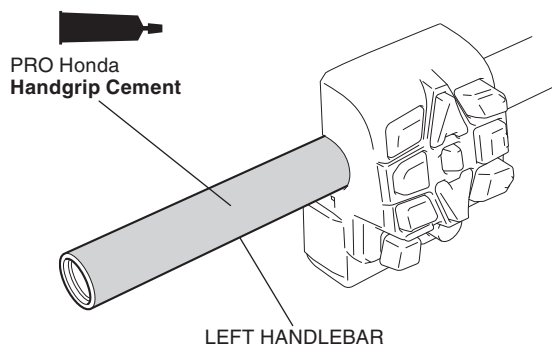

24. Spray isopropyl alcohol over the inside of the heated grip and outside of the left handlebar.

- This is done to ease alignment between the heated grip and the handlebar.

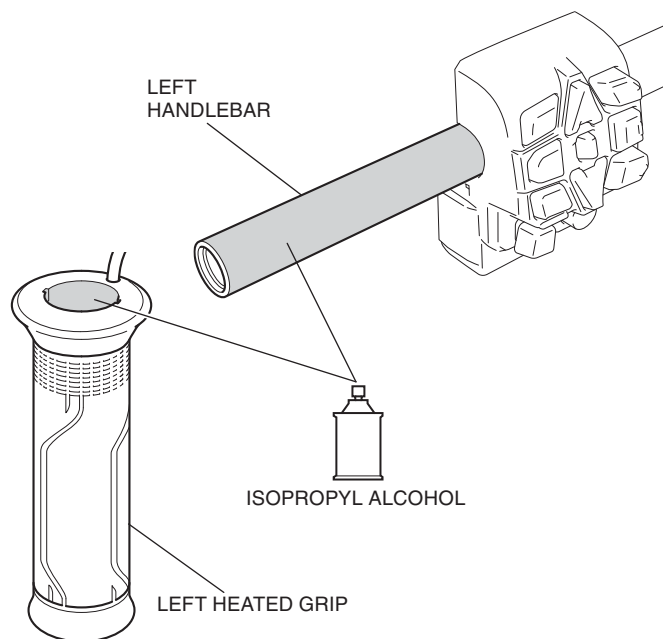

25. Slide the left heated grip onto the left handlebar and route the left heated grip harness as shown.

- Use an assistant to steady the motorcycle while installing the grips.
- Wipe up excess adhesive at once.

NOTICE

- Do not tap on the grip end with a hammer and do not twist the grip to install the heated grip onto the handlebar, as it can damage the element.

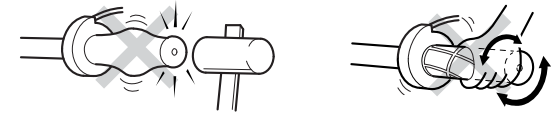

- Install so that there is no gap with the housing.

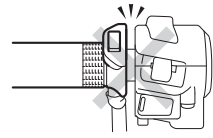

- If the grip gets stuck halfway during installation, apply isopropyl alcohol to the gap between the heated grip. Do not try to remove the heated grip using force or a screwdriver, etc. Damage to the heated grip wire can result.

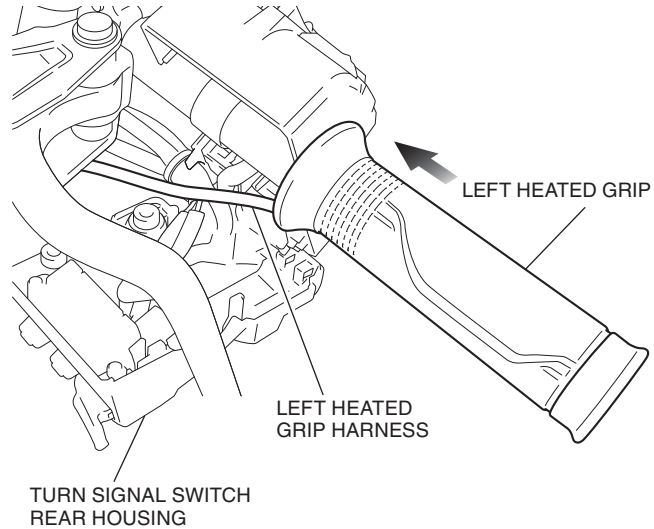

26. Insert until there is contact with the turn signal switch front housing, then align the indicated position.

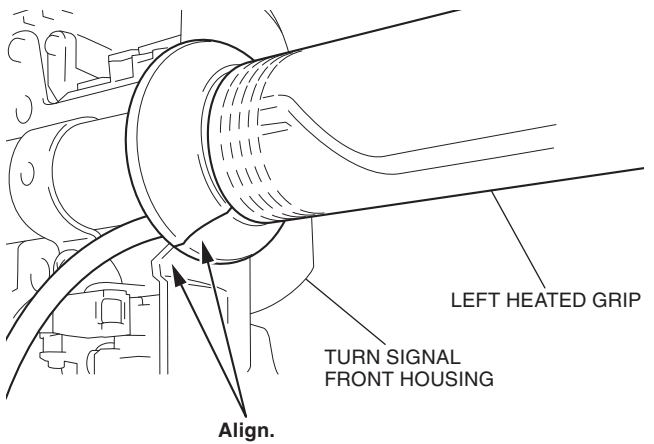

27. Secure the left heated grip harness with the wire tie as shown.

<Left side>

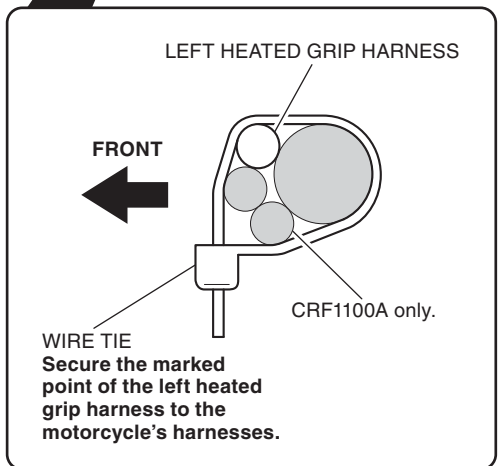
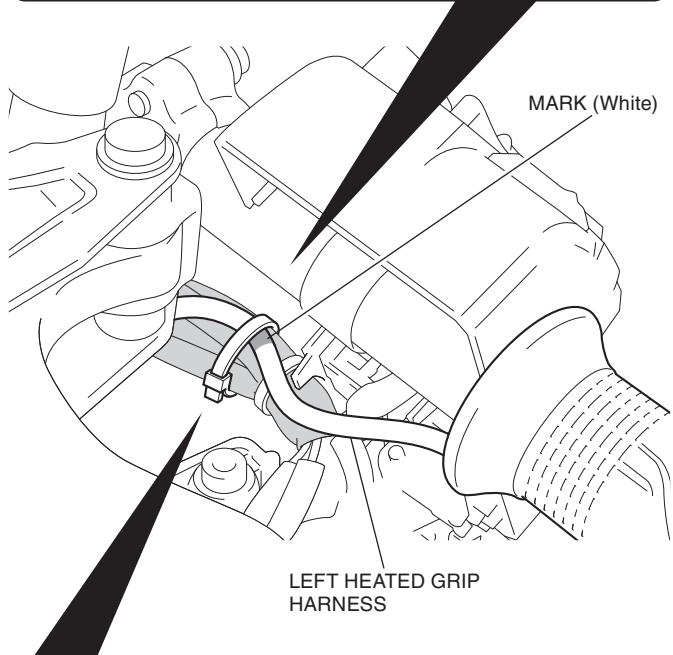
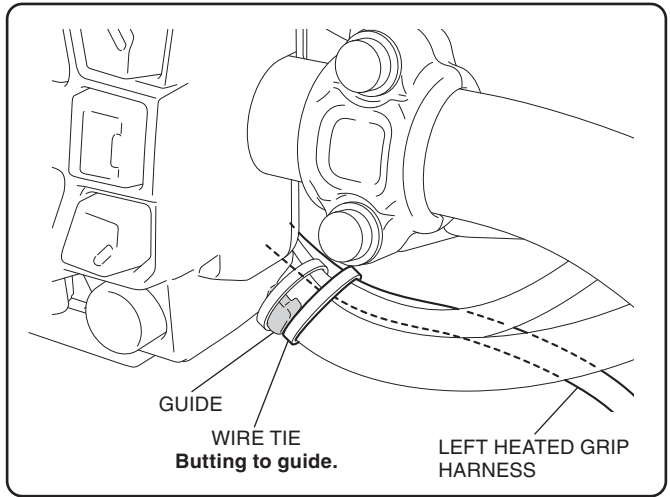

28. Install the turn signal switch rear housing and lever bracket in the reverse order of removal.

- **Confirm that any wire harness is not caught or too tight.**

29. Remove the dummy connector as shown.

<Left side>

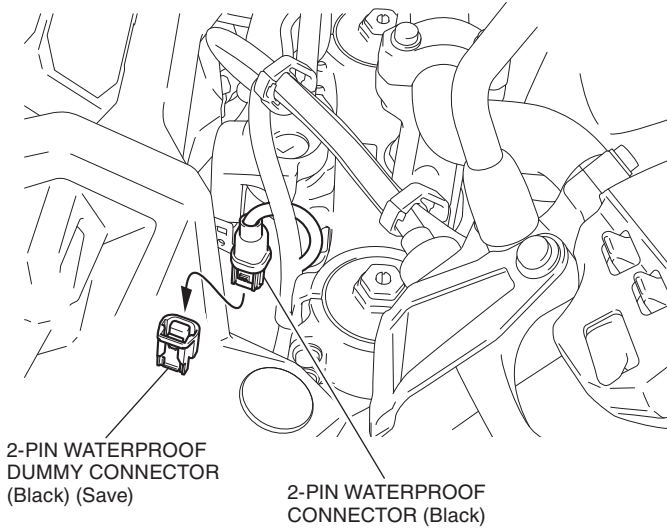

30. Route and connect the left heated grip harness as shown.

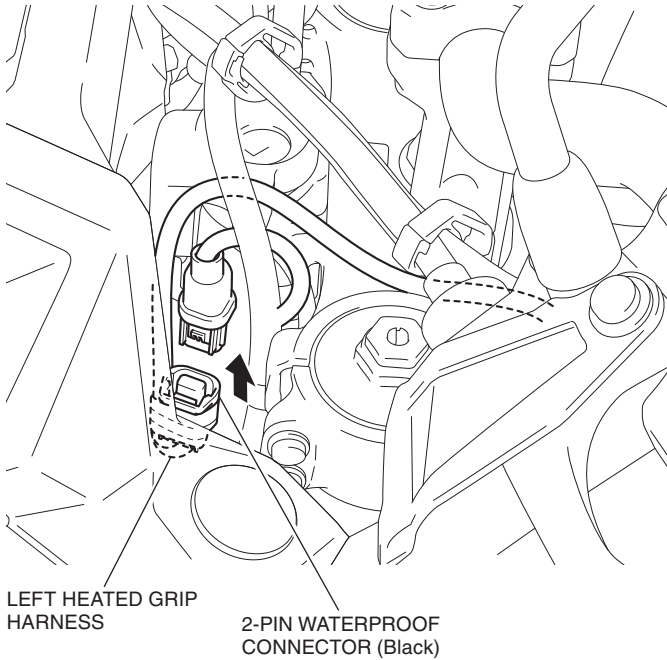

31. Secure the left heated grip harness with the harness clamp as shown.

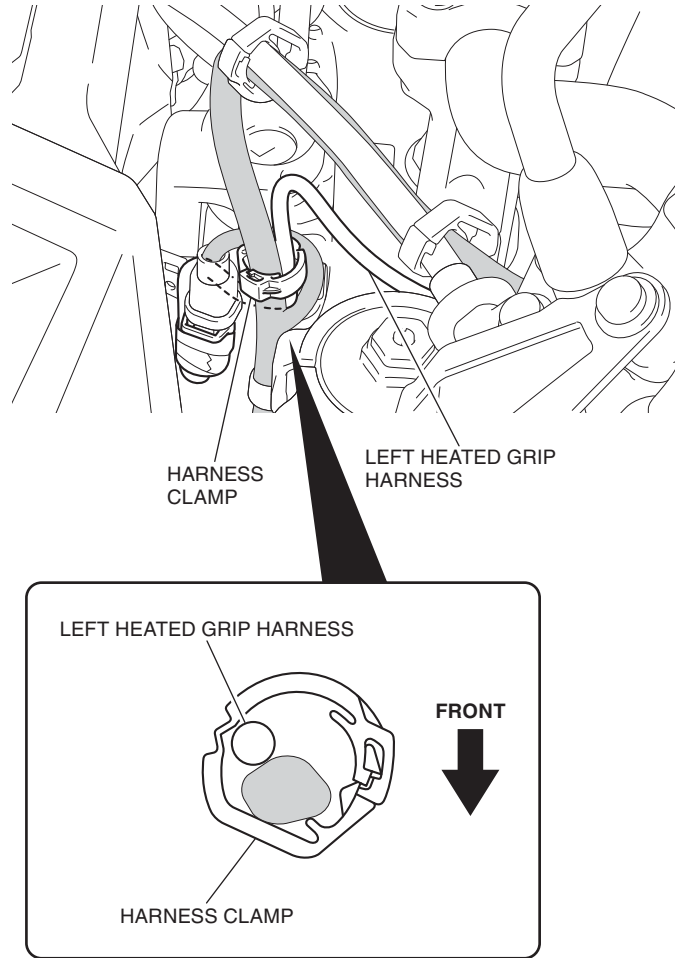

32. Secure the left heated grip harness with the clamps as shown.

<Left side>

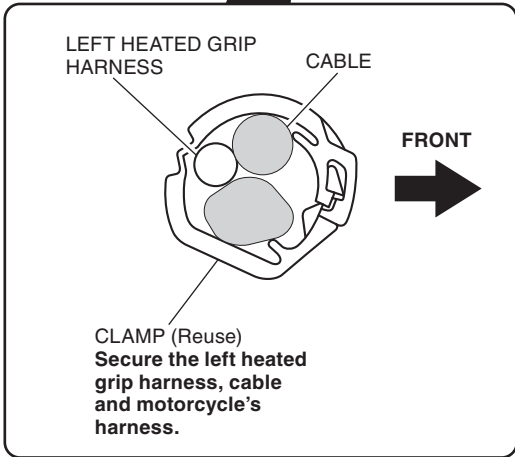
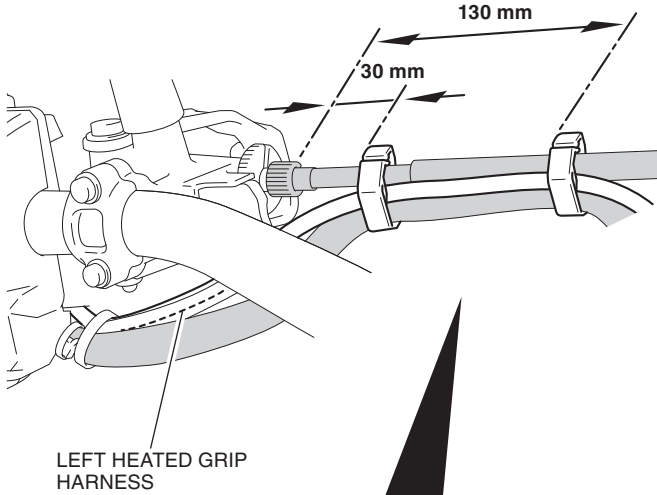

33. Loosen the bolts and move the brake master cylinder as shown.

<Right side>

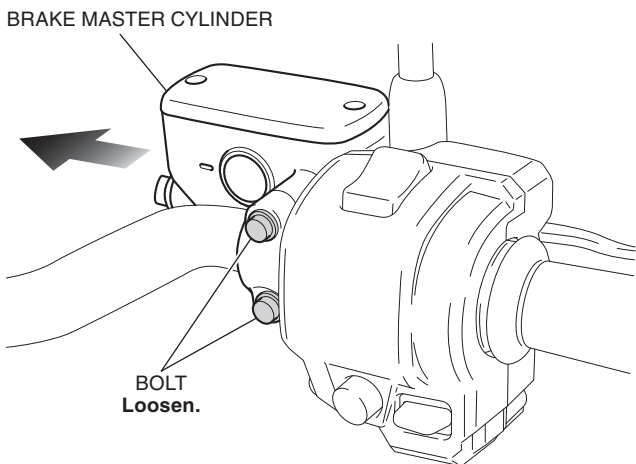

34. Remove the front case as shown.

<Right side>

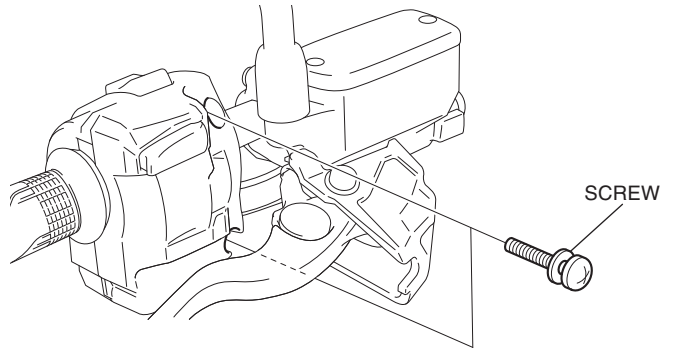

35. Remove the right front housing as shown and remove the screw.

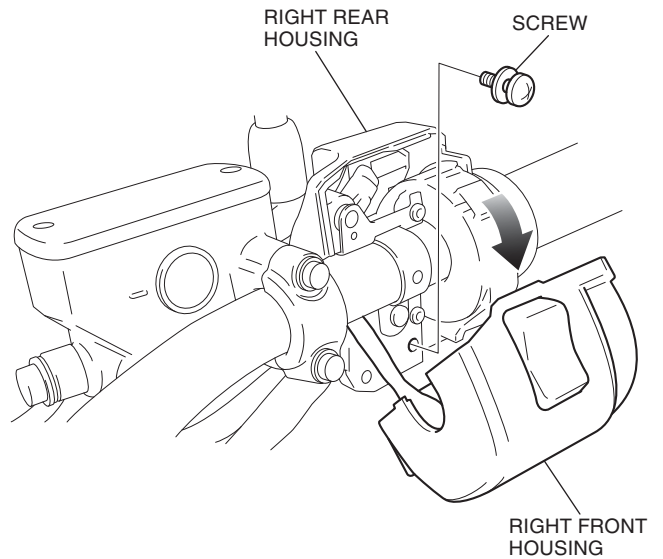

36. Remove the right grip as shown.

NOTE
Remove the right grip as instructed in the motorcycle's Service Manual.

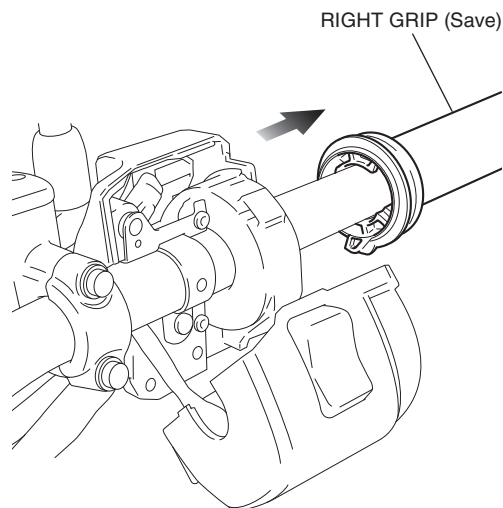

37. Mark the right heated grip harness in the position shown.

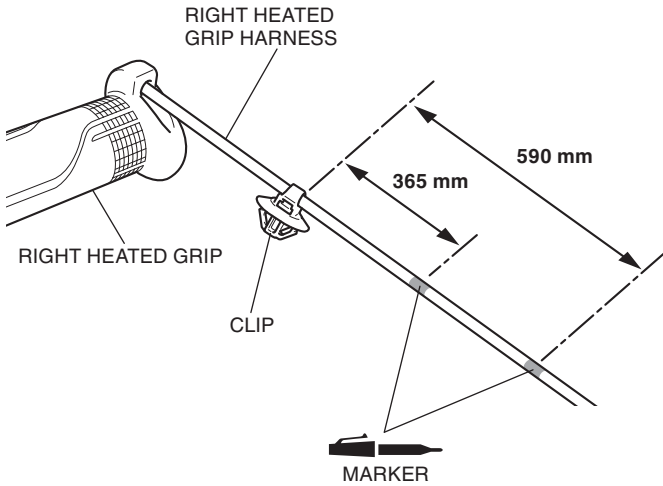

38. Apply grease to the gray part as shown.

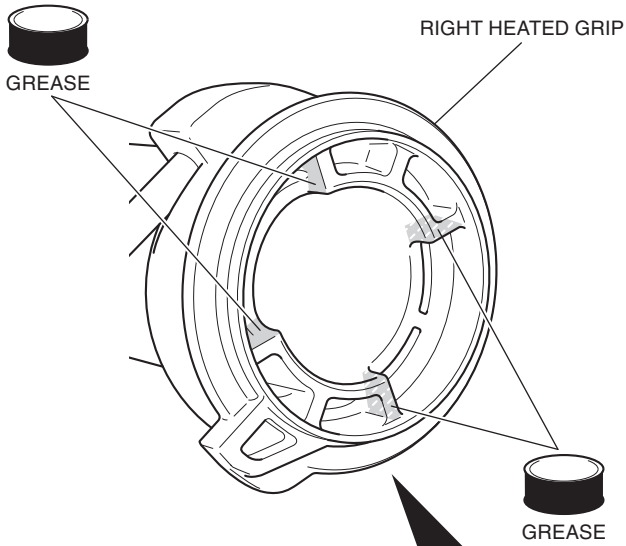

Be careful not to apply grease to the outside of the dimensions shown.

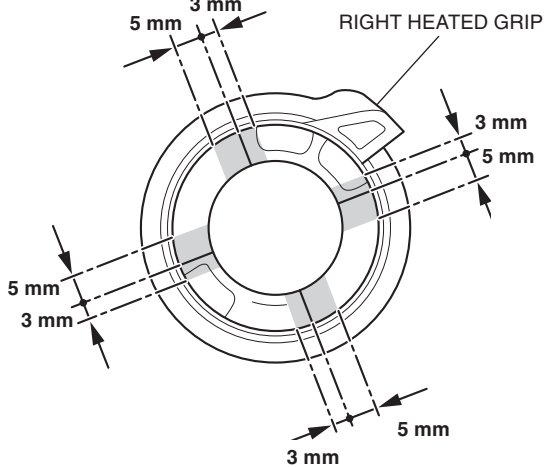

39. Apply grease to the gray part as shown.

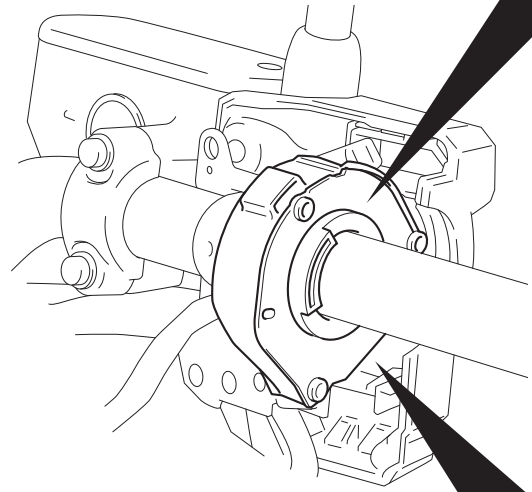
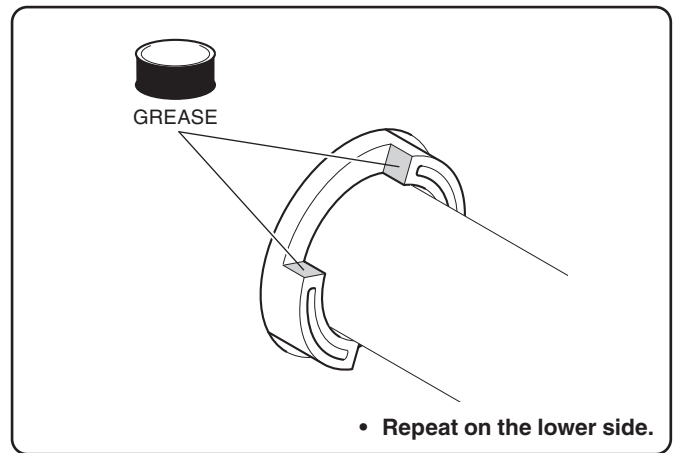

Be careful not to apply grease to the outside of the dimensions shown.

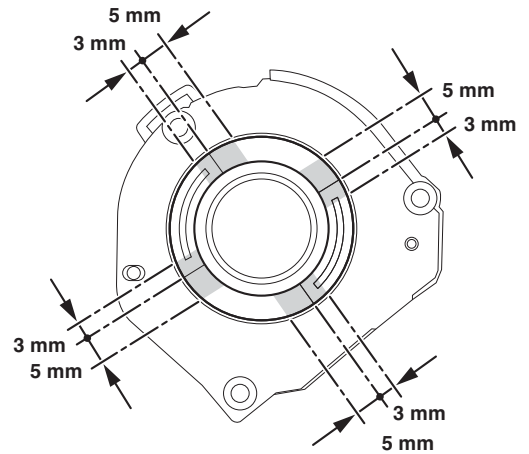

40. Install the right heated grip as shown.

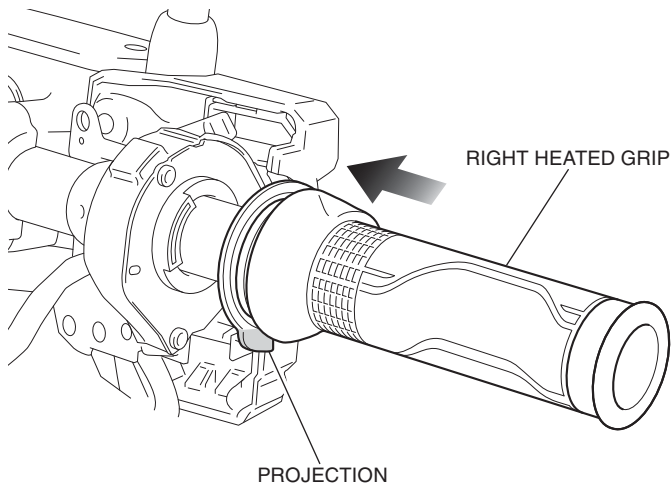

41. Install the front and rear right housing and brake master cylinder in the reverse order of removal.

42. Twist the throttle grip as shown.

- **Check for smooth opening of the throttle and that it automatically snaps closed from any opening, in all steering positions.**

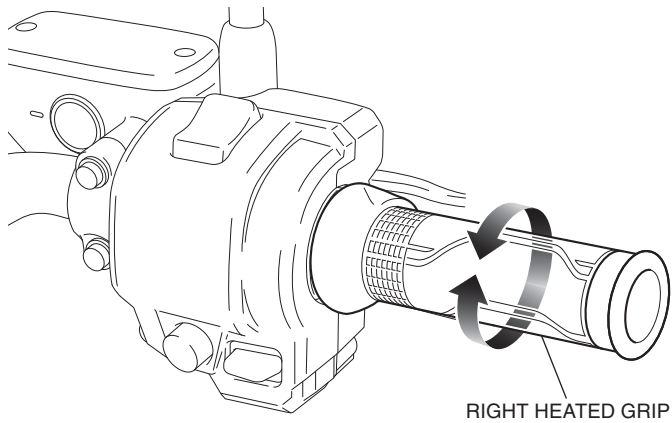

43. Remove the screw as shown.

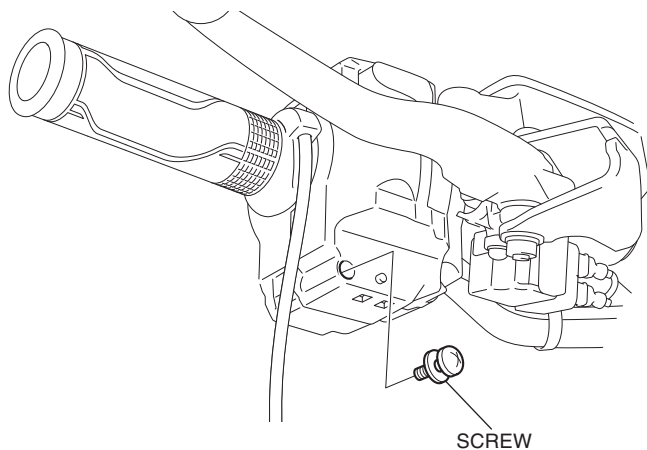

44. Install the stay as shown.

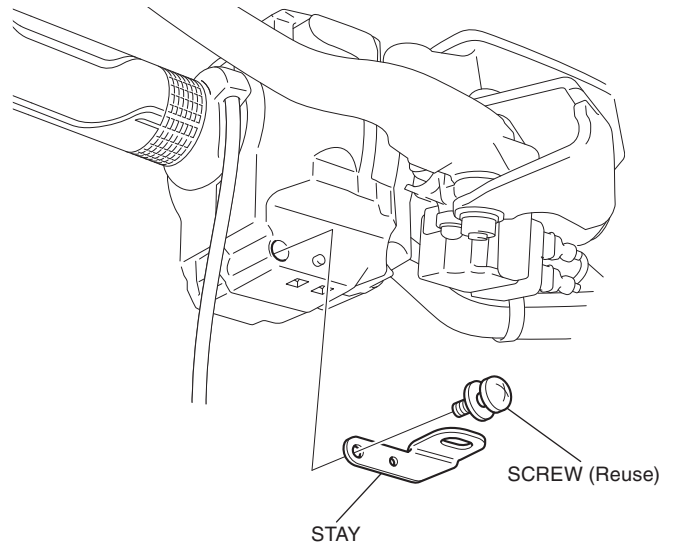

45. Secure the right heated grip harness as shown.

- **Open and close the throttle and confirm that there is no tightness of the heated grip harness.**

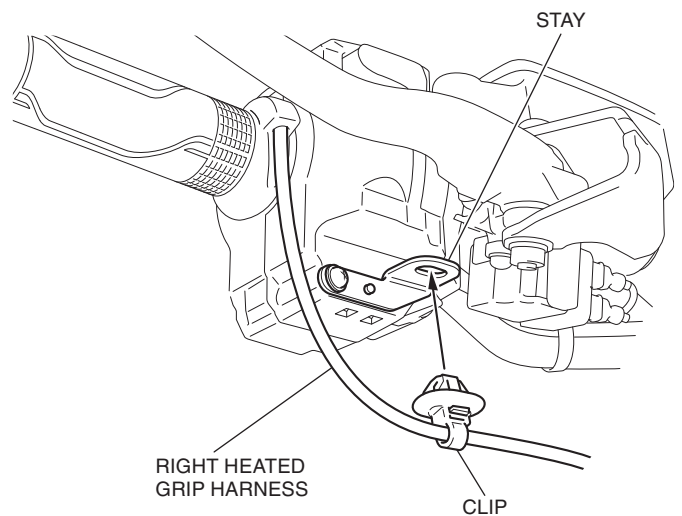

46. Secure the right heated grip harness with the wire tie as shown.

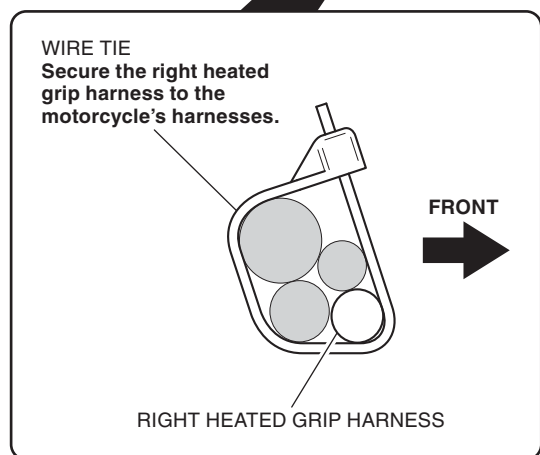
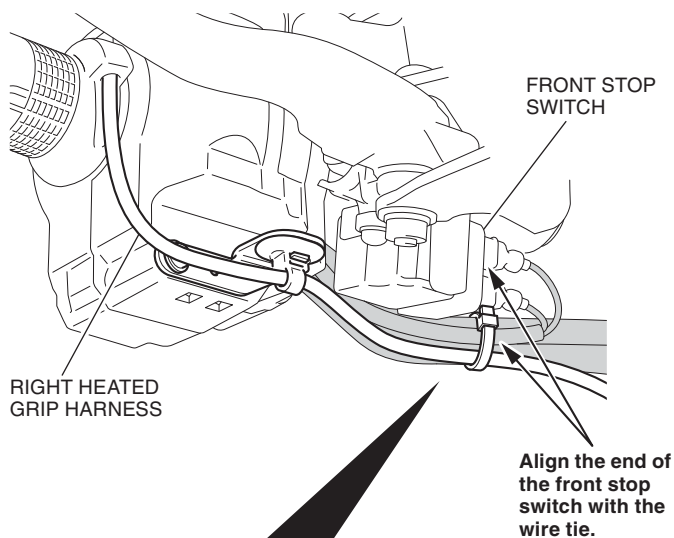

47. Remove the clip as shown.

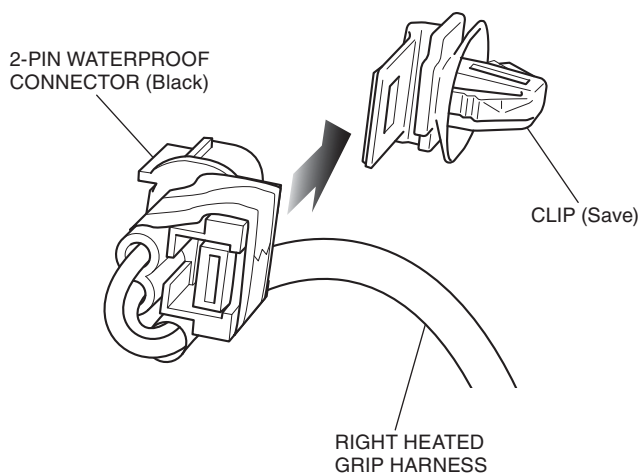

48. Route the right heated grip harness as shown.
<Right side>

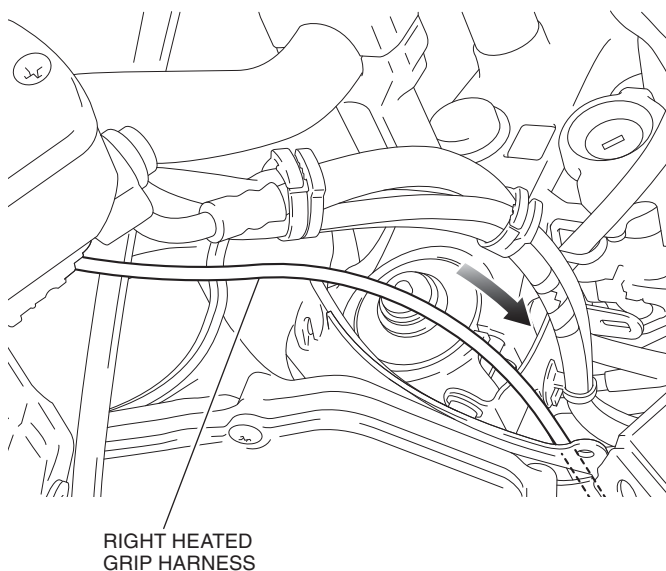

49. Remove the harness boots as shown.
<Right side>

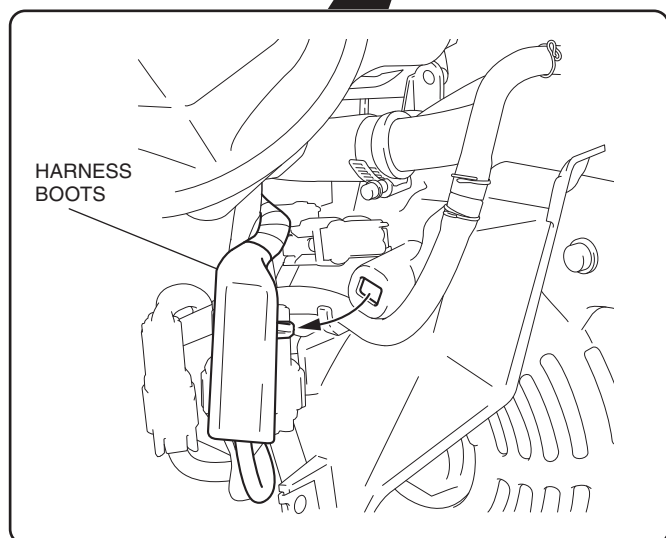
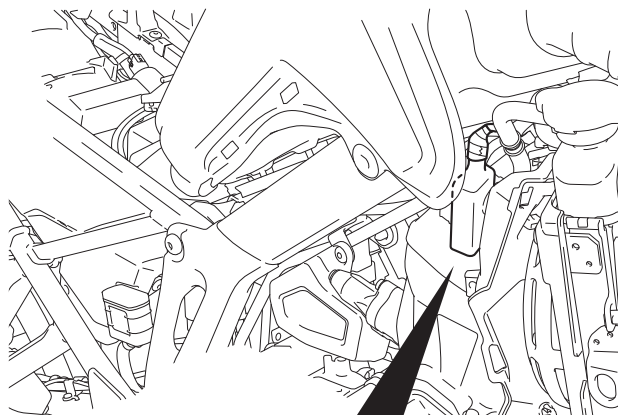

50. Remove the dummy connector as shown.

<Right side>

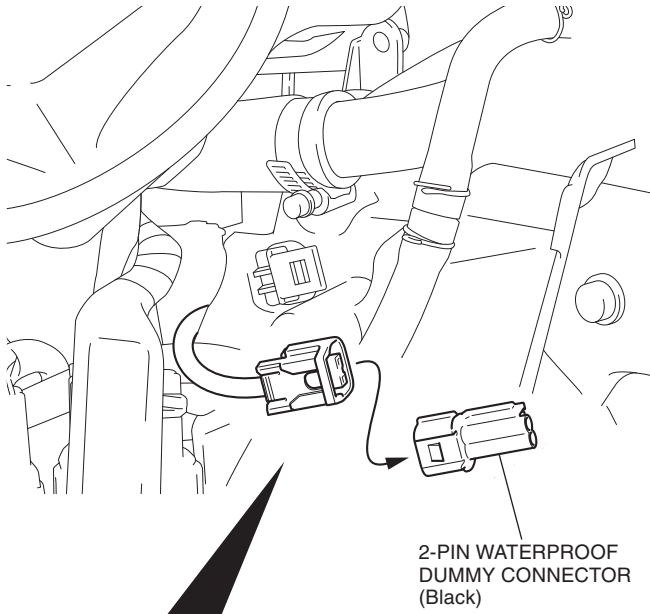

Remove the connector from the clip as shown.

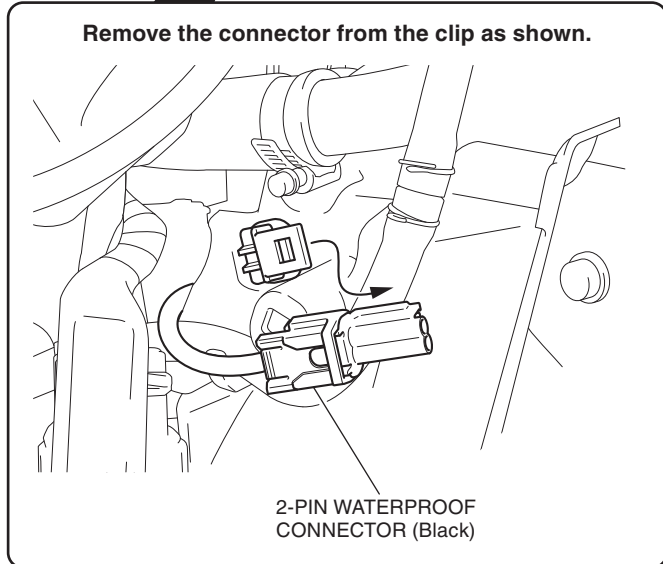

51. Remove the clip as shown.

<Right side>

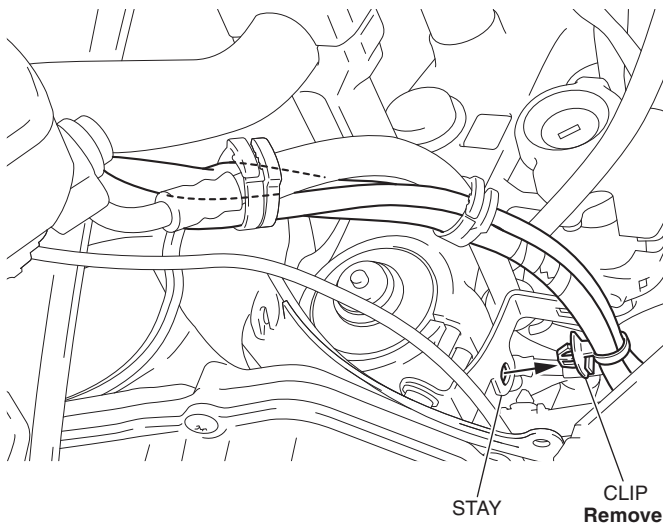

52. Mark the harnesses in the position shown.

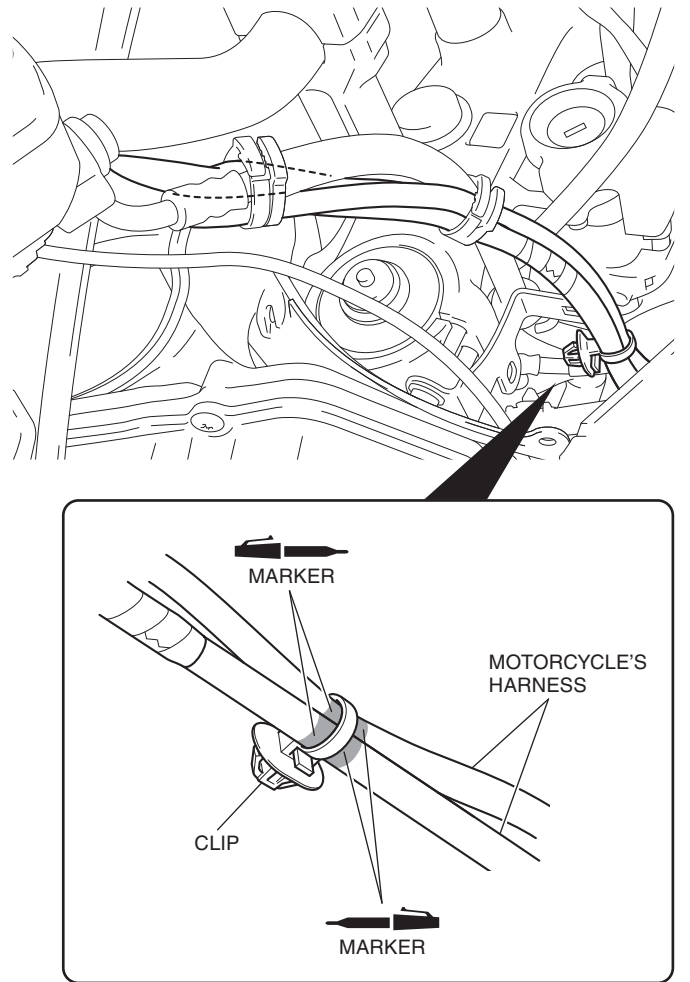

53. Remove the clip as shown.

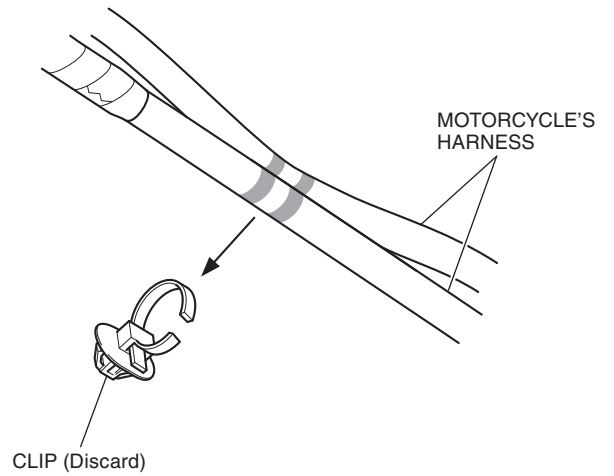

54. Install the clip band as shown.

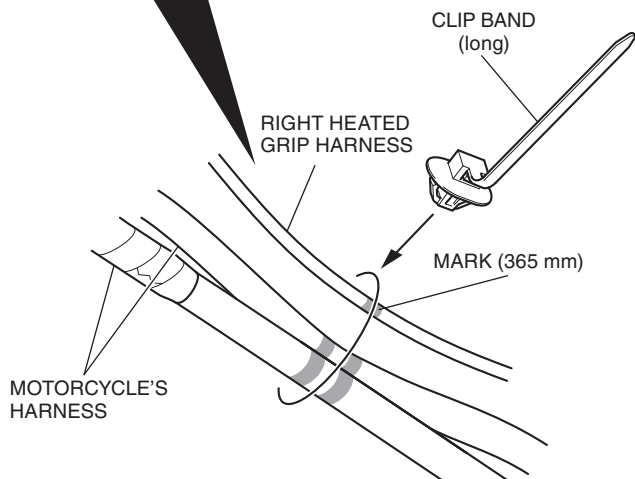
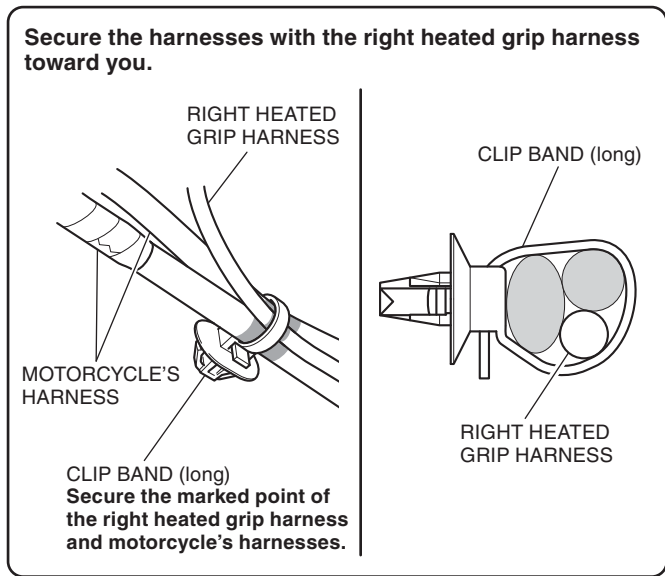

55. Remove the clip as shown.

<Right side>

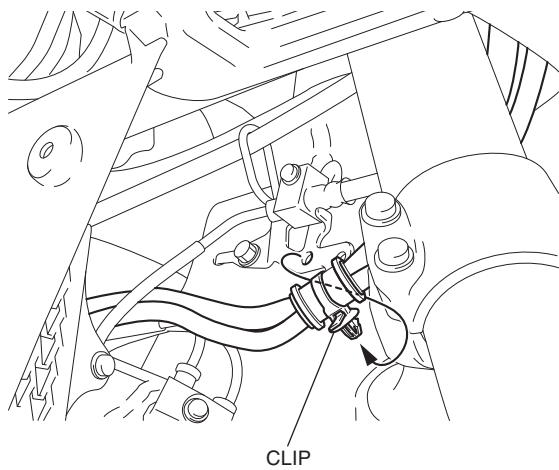

56. Remove the bolt as shown.

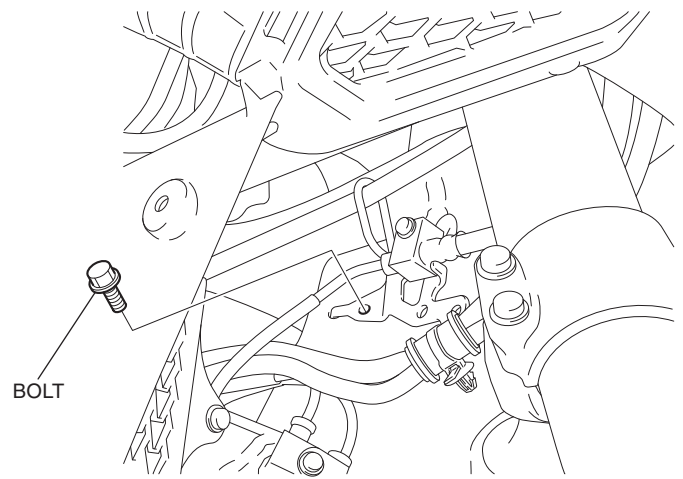

57. Mark the harnesses in the position shown.

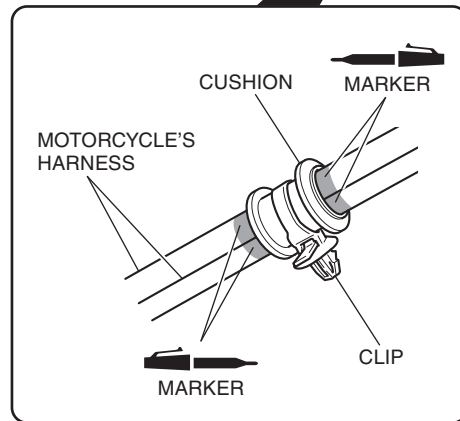
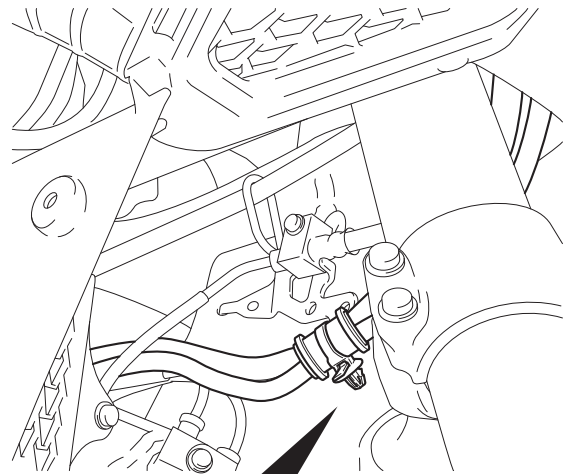

58. Remove the clip as shown.

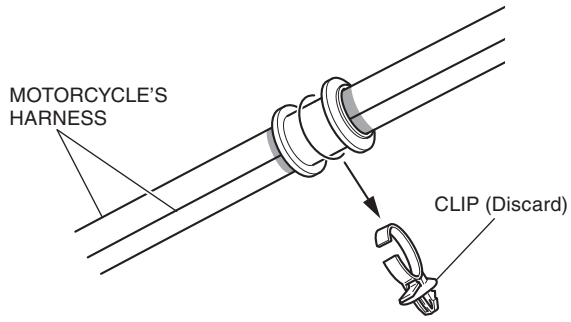

59. Remove the rubber cushion as shown.

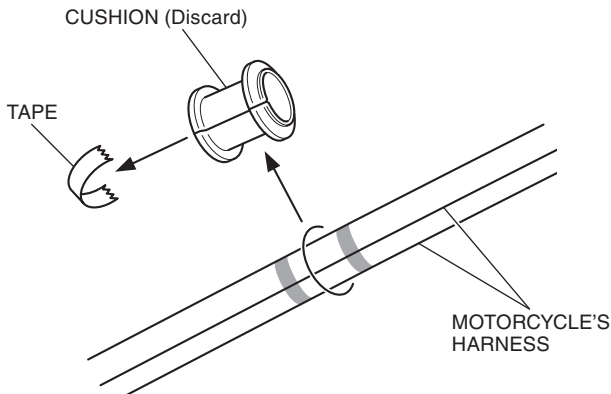

60. Match each harness as shown.

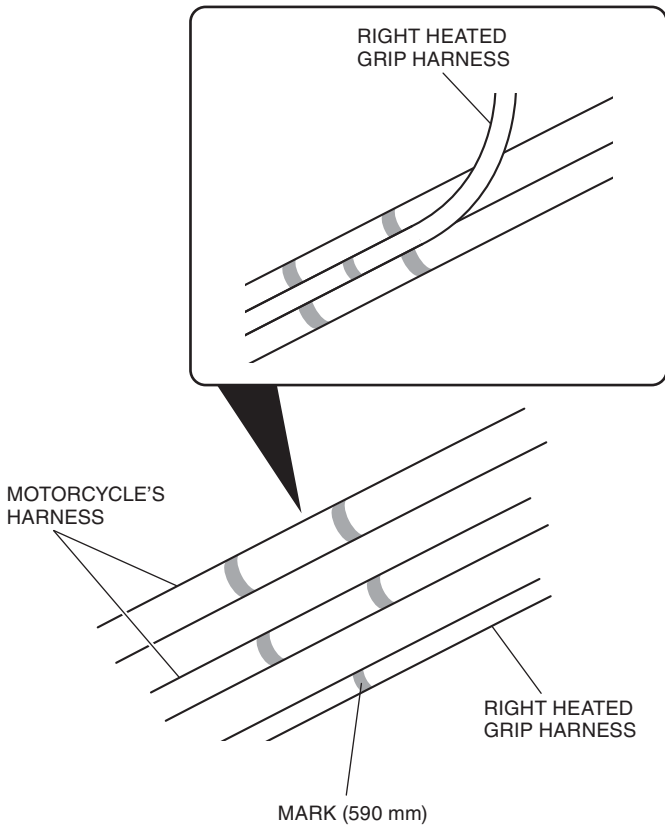

61. Wind the electrical tape as shown.

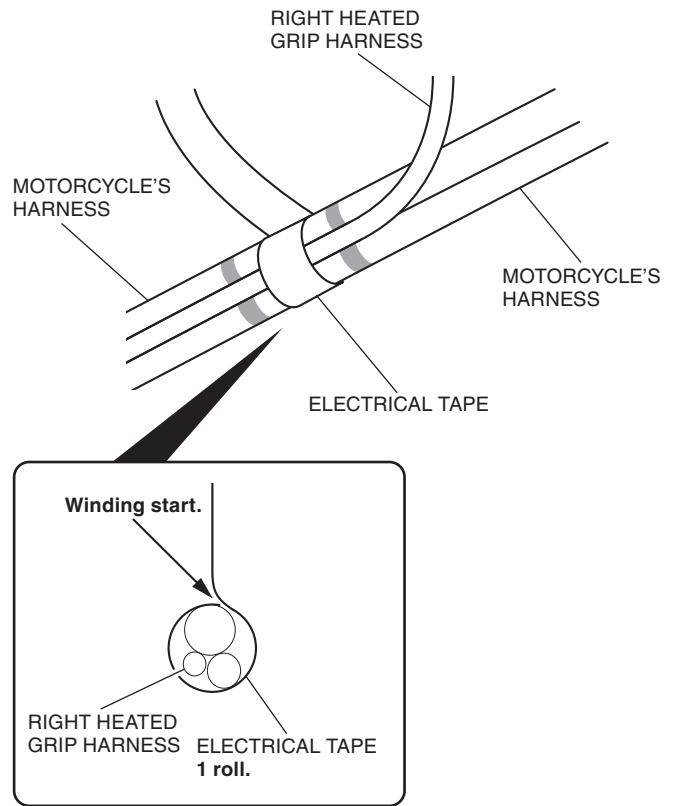

62. Install the protector as shown.

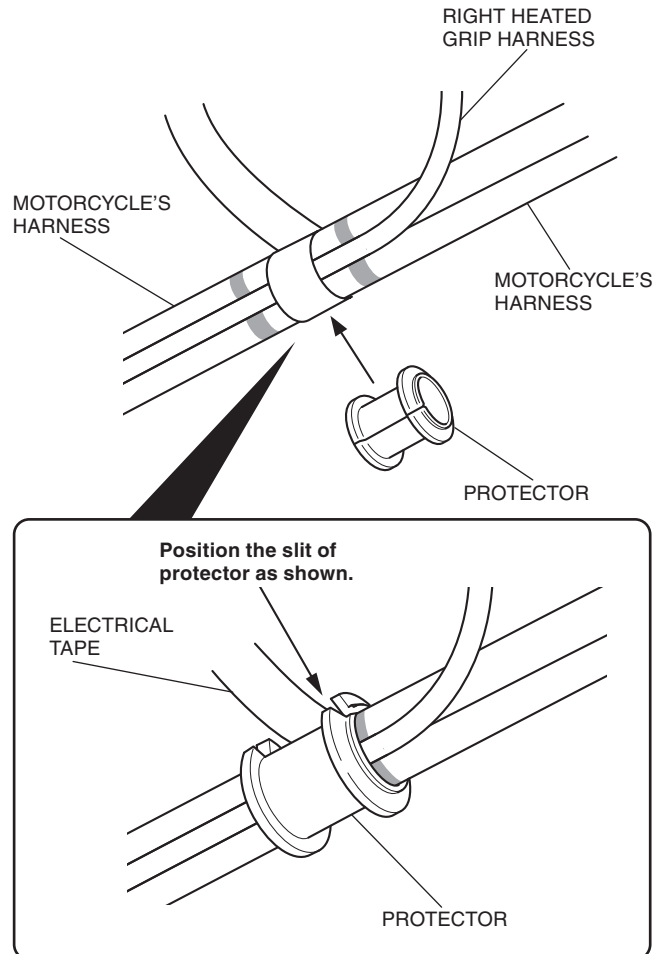

63. Secure the protector with electrical tape as shown.

- **Confirm that the secured protector is not off to side.**

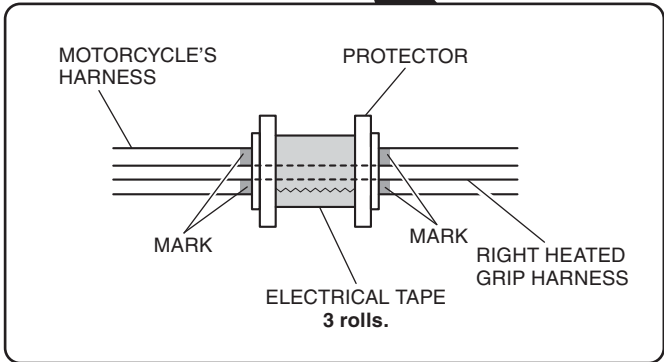
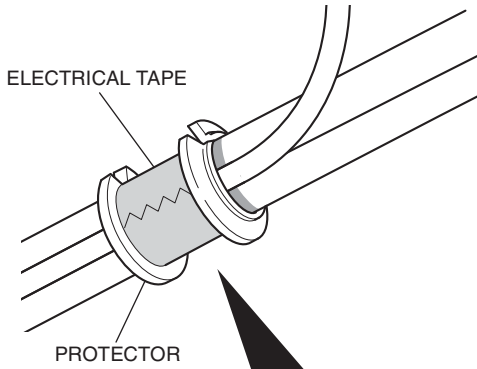

64. Install the clip band as shown.

Secure with the hook part of the clip band toward the opposite side of right heated grip harness as shown.

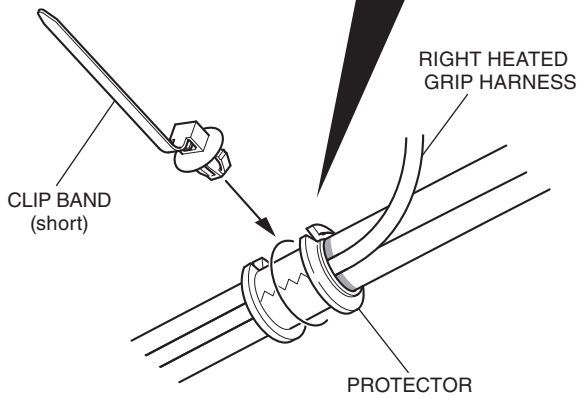
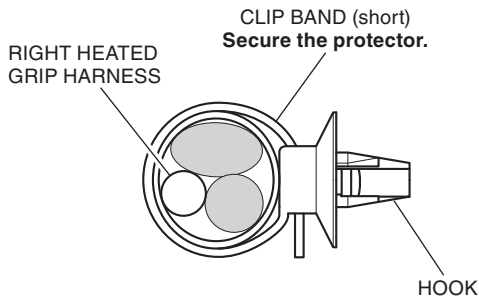

65. Route the right heated grip harness as shown.

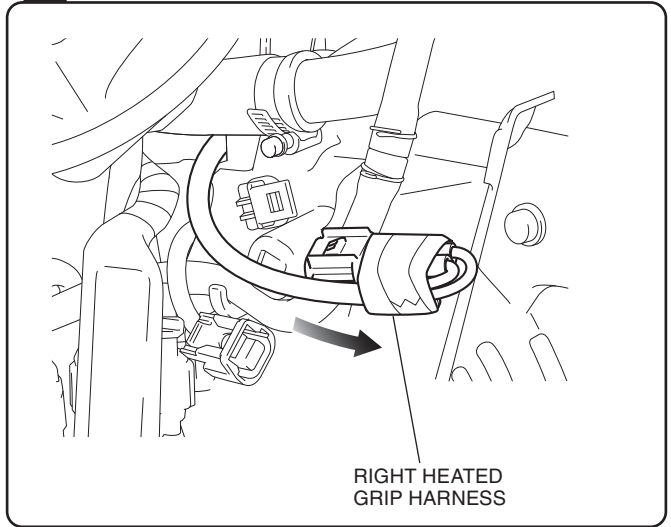
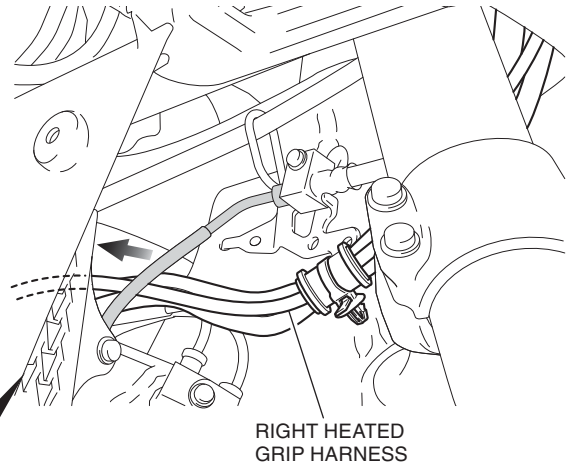

66. Connect the right heated grip harness as shown.

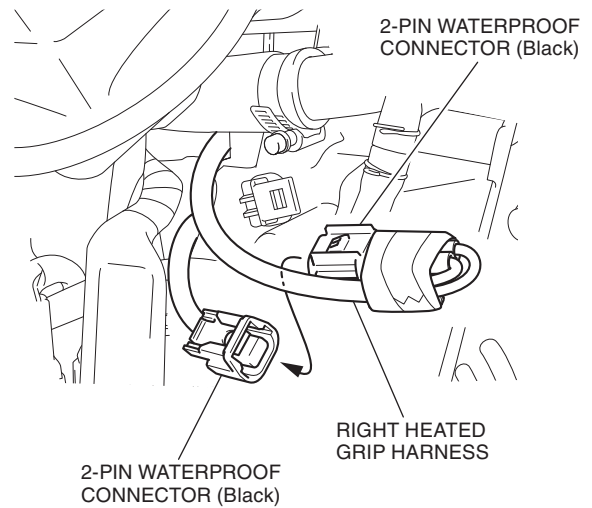

67. Secure the right heated grip harness as shown.

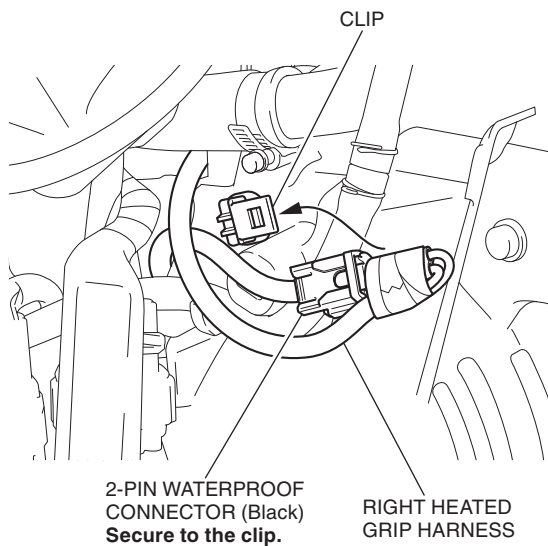

68. Secure the clip band as shown.

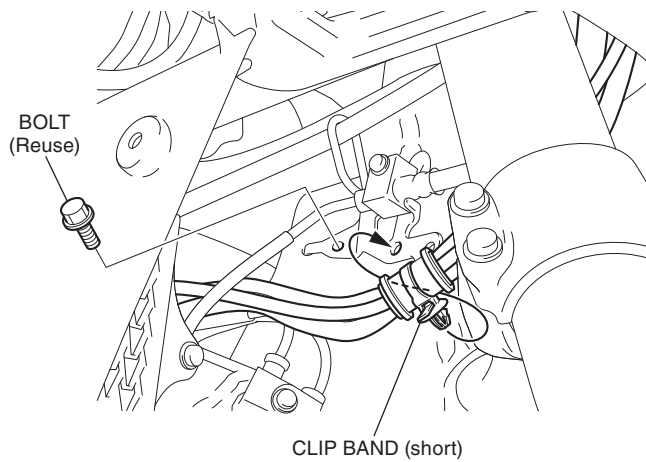

69. Secure the clip band as shown.

<Right side>

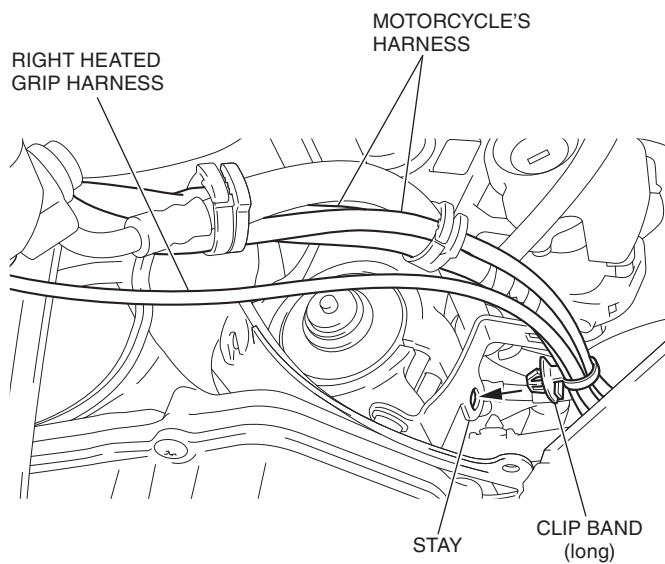

70. Secure the right heated grip harness with the clamps as shown.

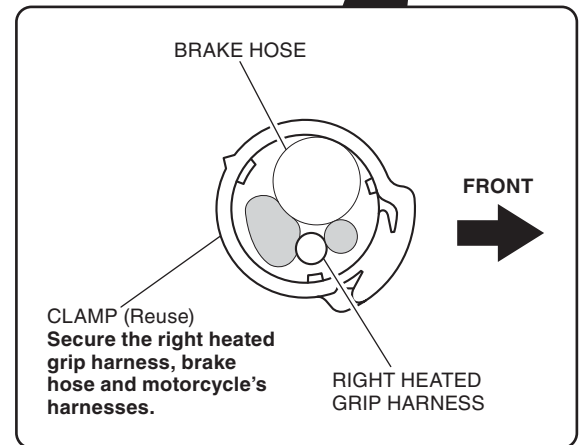
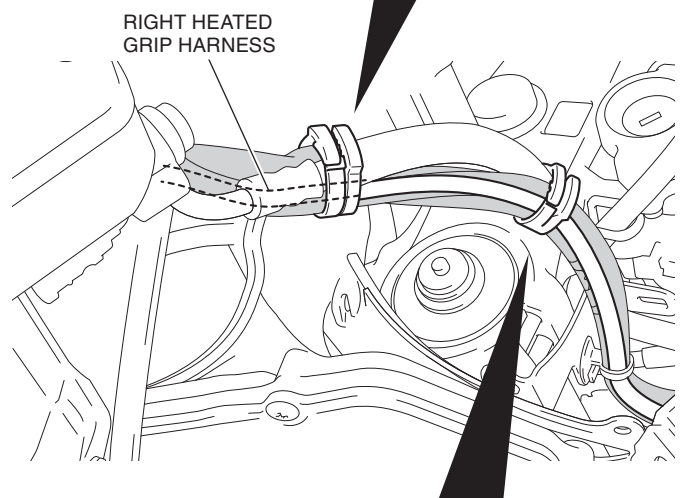
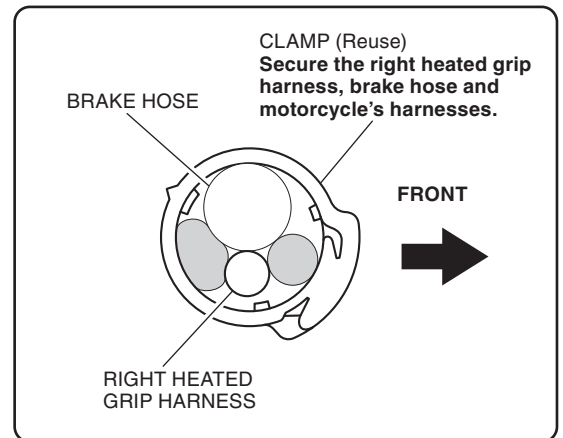

71. Check each harness for sufficient play.
- **Move the handlebar right and left and check that the harnesses are not pinched by neighboring components and that they are not pulled taut.**
72. Reinstall the parts as shown.
- **Clean up with isopropyl alcohol before applying thread lock.**
 - **Be sure to apply thread lock to the threads of the bolt.**
 - **Repeat on the right side.**

<Left side>

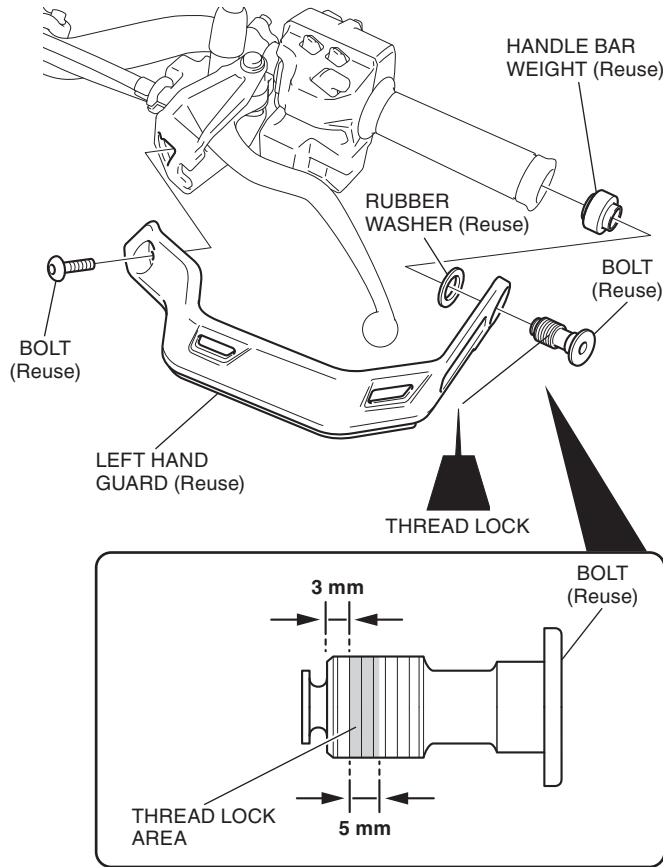

73. Install the motorcycle's parts in the reverse order of removal.
- **Confirm that any wire harness is not caught or too tight.**
 - **After installing the heated grip, perform the SETTING.**
74. Check the heated grip, throttle, headlight and the other lights for proper operation.

SETTING

1. Connect the SCS short connector (070MZ-001A3Z0) to the DLC.
2. Turn the ignition switch ON and engine stop switch "⏻".
 - **Do not start the engine.**
3. Pull backward and hold the PAGE switch or touch the clock area of the multi-information display.

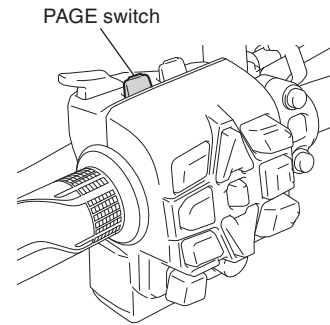

4. Select the "Settings", and then press the ENT option.

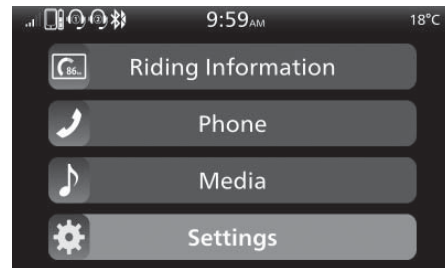

5. Select the "Service", and then press the ENT option.

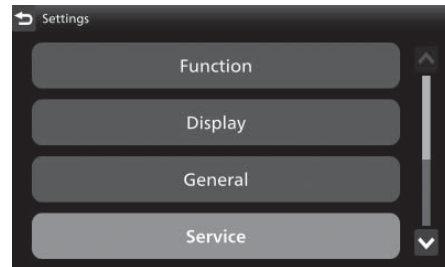

6. Select the "Equipment", and then press the ENT option.

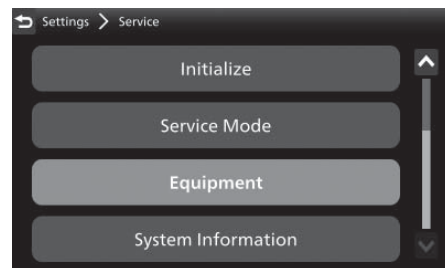

7. Select the “Grip Heater”, and then press the ENT option to the “ON” function.

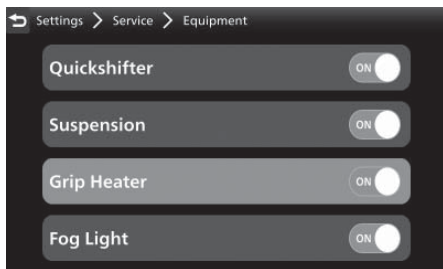

8. Turn the ignition switch OFF and remove the SCS short connector.

SYSTEM DIAGRAM

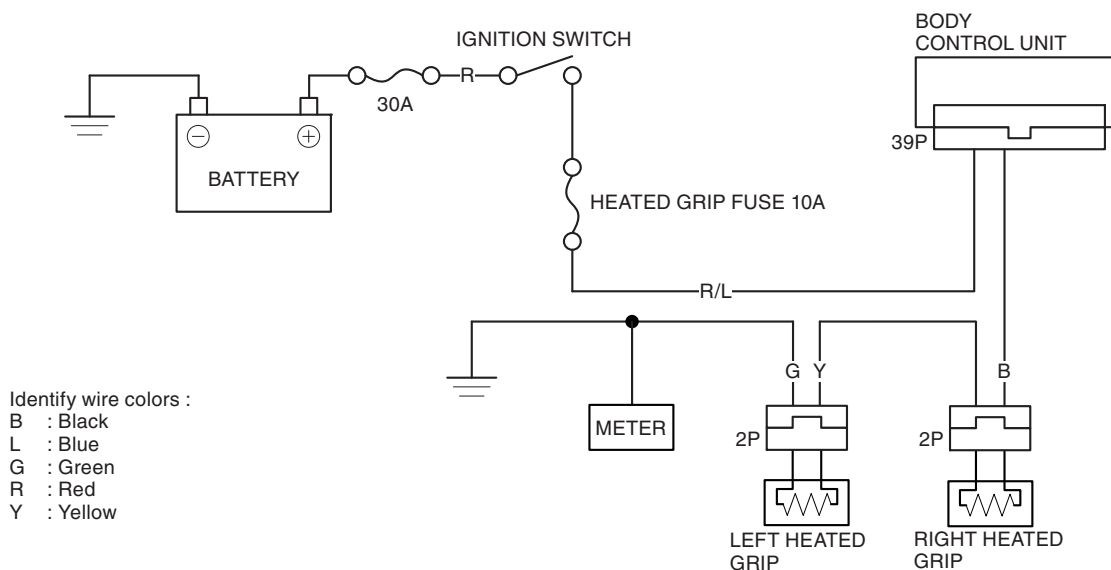

DEALER TROUBLESHOOTING

- Stop the engine and turn the main switch OFF when you check the parts and circuits other than those of the grip heaters.

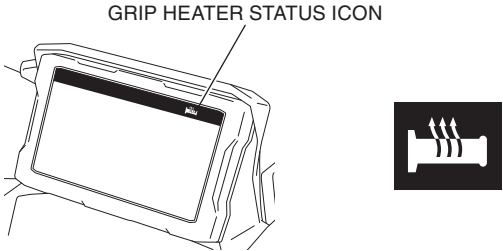
Symptom	Check
<p>Grip heater status icon blinks.</p> 	<p>Refer to the service manual for the motorcycle.</p>