



# INSTALLATION INSTRUCTIONS

Accessory

HEATED GRIPS  
P/N 08T70-MKW-D00

Application

NC750XA/XD

Publication No.

MII 17714

Issue Date

April 2021

**Honda Dealer: Please give a copy of these instructions to your customer.**

## PARTS LIST

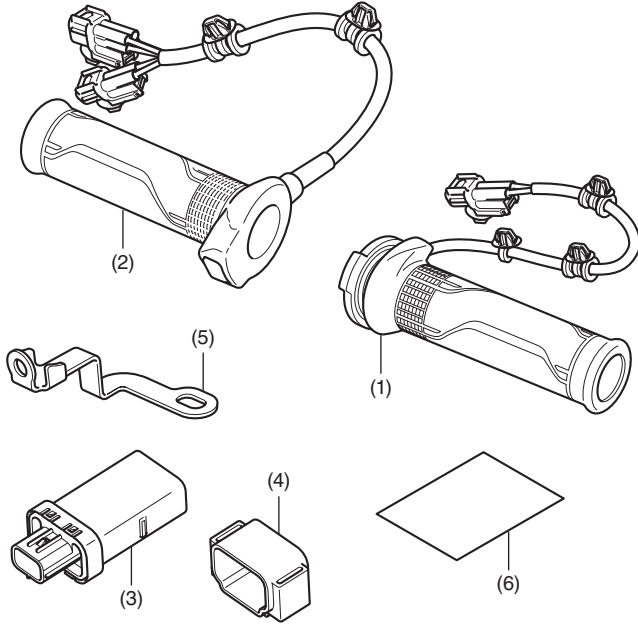

No.	Description	Qty
(1)	Right heated grip	1
(2)	Left heated grip	1
(3)	Heater controller	1
(4)	Suspension	1
(5)	Clamp	1
(6)	Installation instructions	1

## TOOL AND SUPPLIES REQUIRED

Flat-tip screwdriver

Ruler

Honda Bond A

Thread lock

Grease

Isopropyl alcohol

Shop towel

Torque wrench

## TORQUE CHART

Refer to the Service Manual for the torque values of the removed parts.

## INSTALLATION

### ▲ CAUTION

- To prevent burns, allow the engine, exhaust system, radiator, etc., to cool before installing the accessory.

### NOTE:

- Remove the right grip as instructed in the motorcycle's Service Manual.
- For secure adhesion of the heated grips use the recommended adhesive agent (Honda Bond A) or equivalent.
- Be sure to open and close the throttle to check for smooth operation after installation of the right heated grip.
- Disconnect the negative (-) cable from the battery before installing this accessory.
- The clock memory will be erased when you disconnect the battery. Reset the clock after reconnecting the battery.
- Reinstall the removed parts on the motorcycle and make sure that the wires and harnesses are not pinched.
- After heated grip installation, check the lights (e.g. right / left turn signal lights and brake lights) for proper operation.

- Open the passenger seat, and remove the single seat as shown.

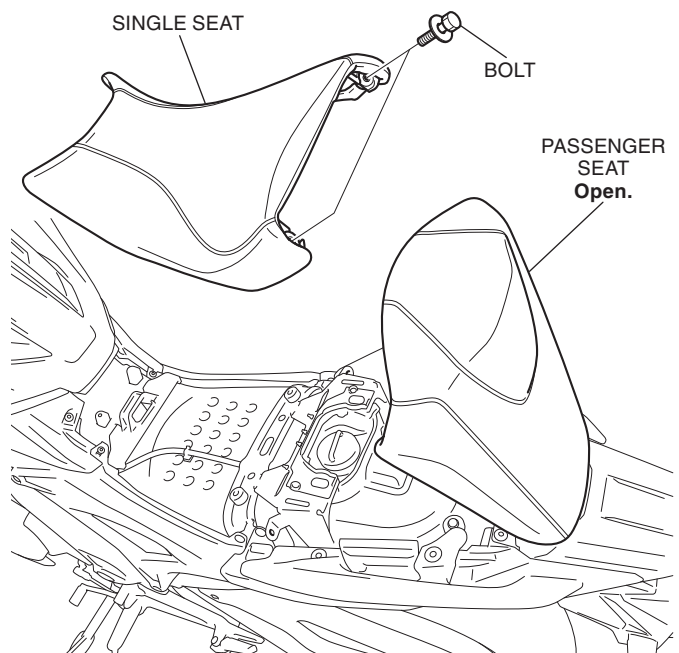

2. Remove the maintenance lid and disconnect the negative (-) cable of the battery.

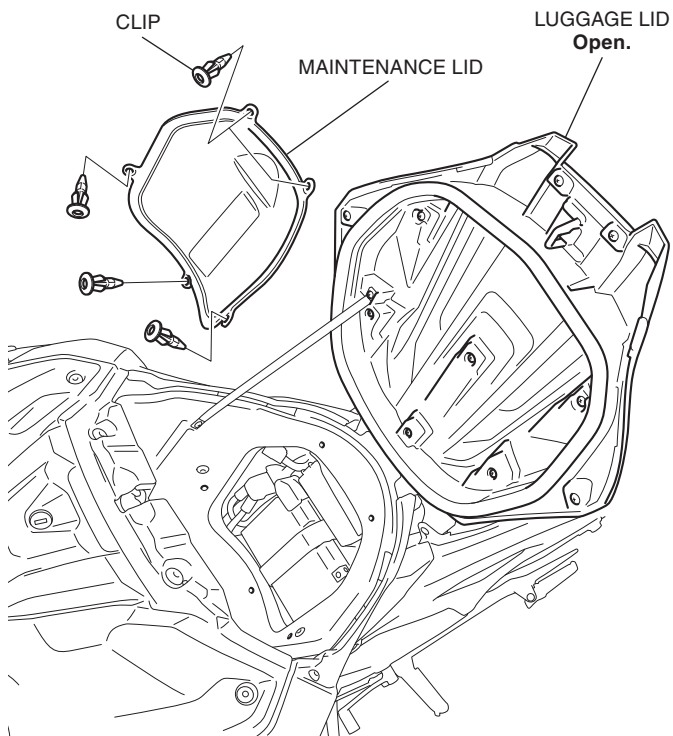

3. Remove the center cover as shown.

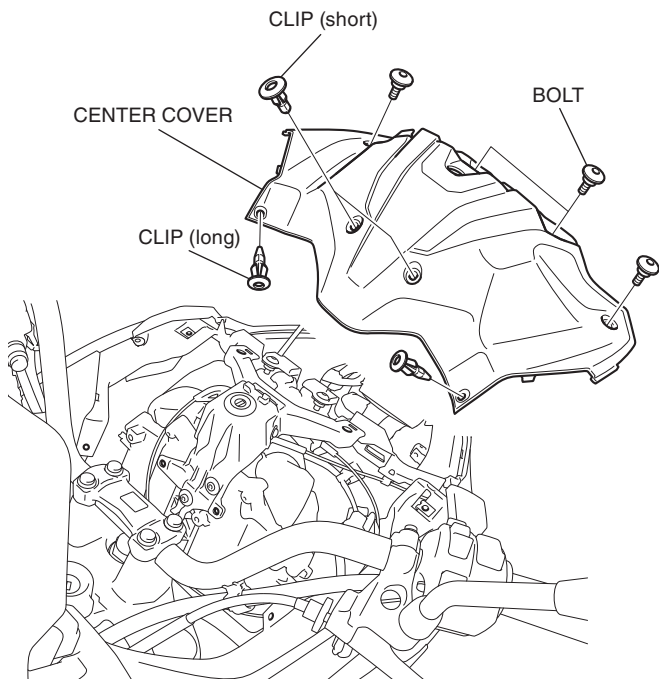

4. Remove the clip as shown.  
• Repeat on the right side.

<Left side>

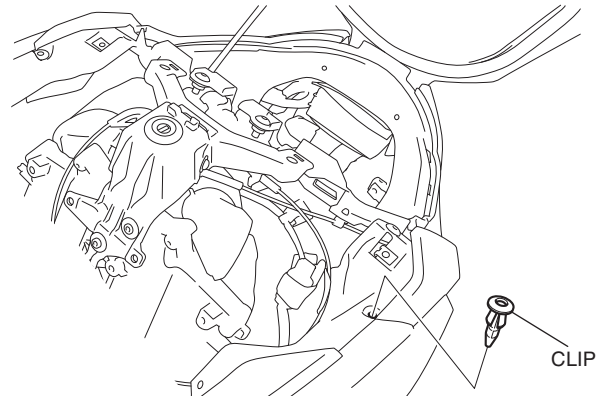

5. Remove the left side panel as shown.

<Left side>

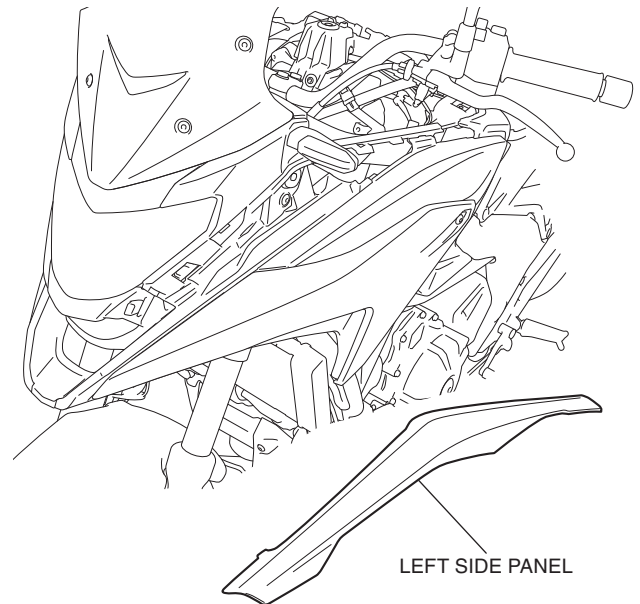

6. Remove the left middle cowl as shown.

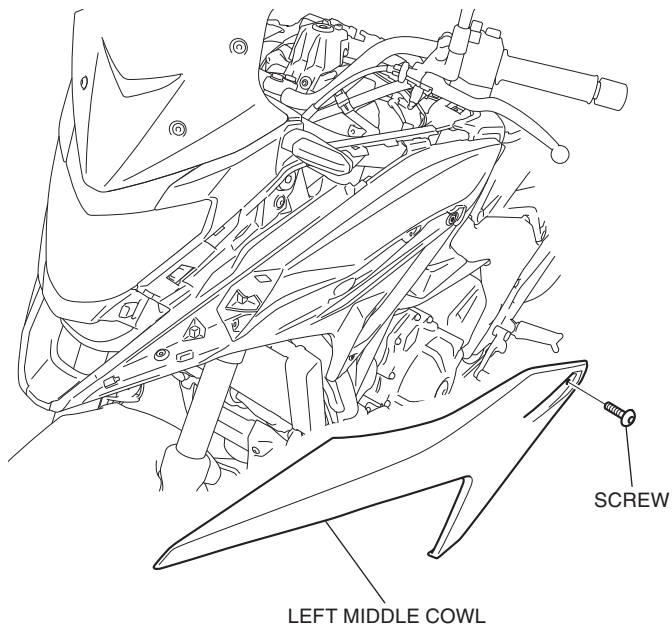

7. Remove the left front side cowl as shown.

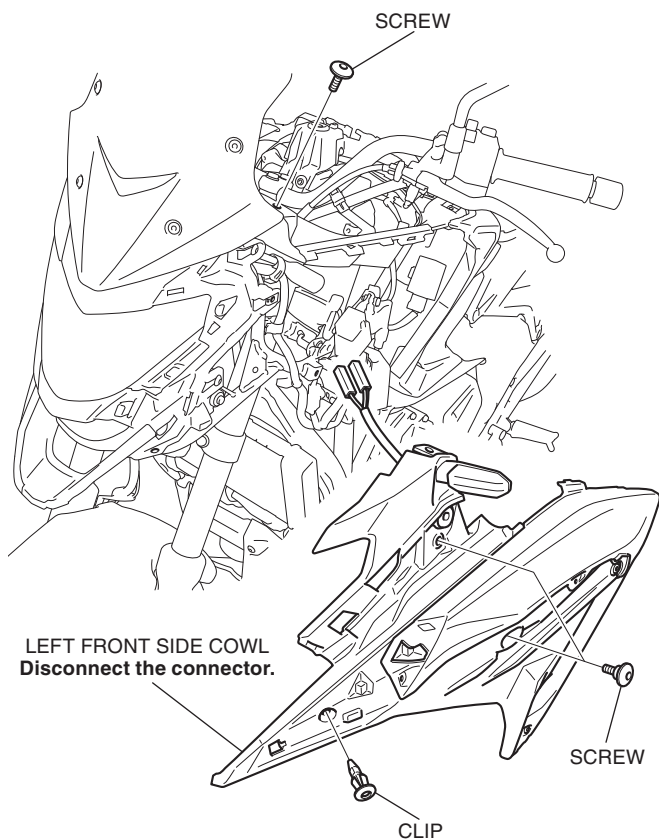

8. Remove the right side panel, right middle cowl and right front side cowl in the same manner as the left side.

9. Remove the left side cover as shown.

<Left side>

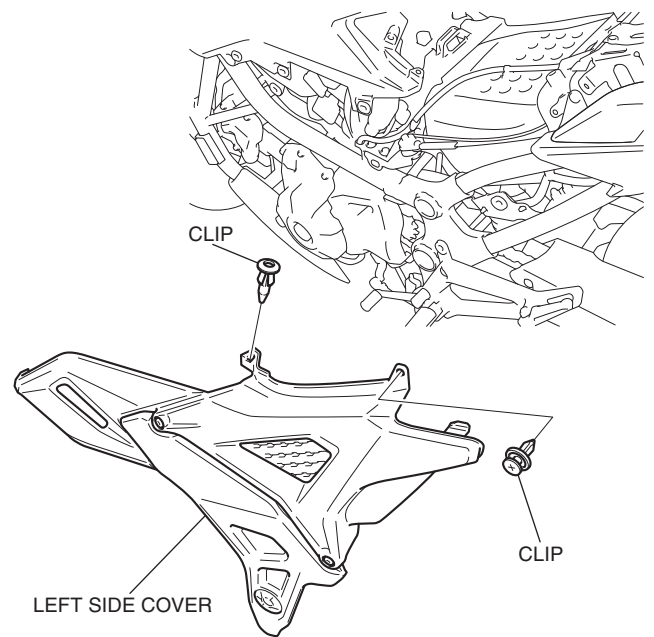

10. Remove the left shroud as shown.

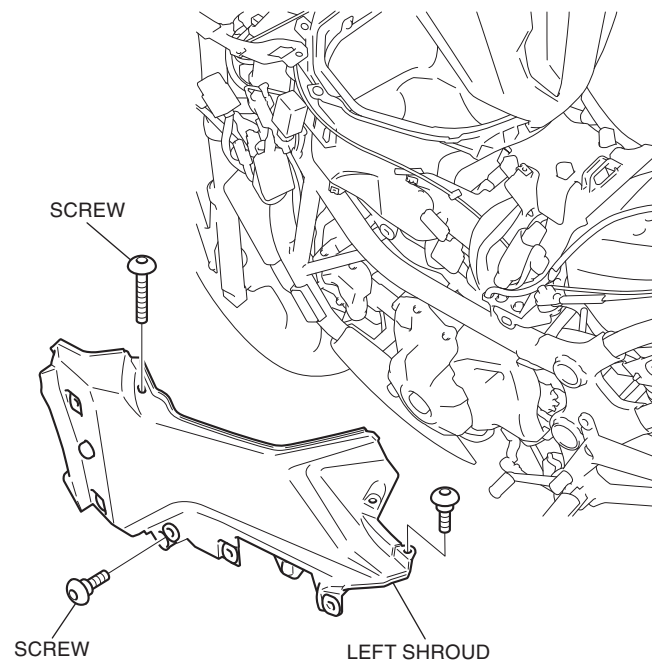

11. Remove the handlebar weight as shown.

- Repeat on the right side.

<Left side>

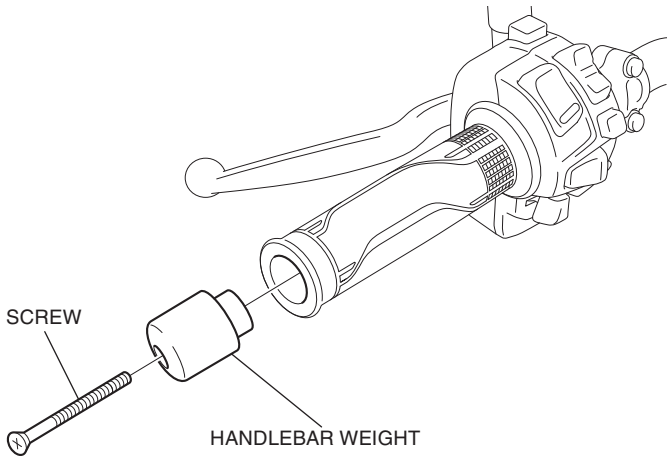

12. Remove the left grip as shown.

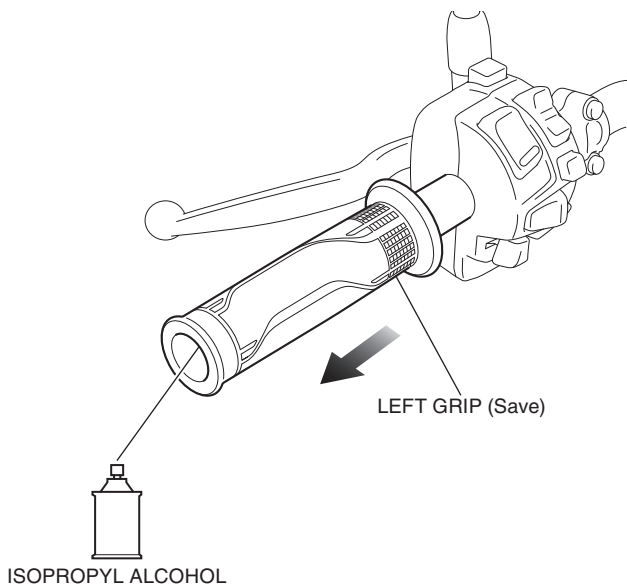

13. Using a isopropyl alcohol, remove all traces of adhesive from the left handlebar.

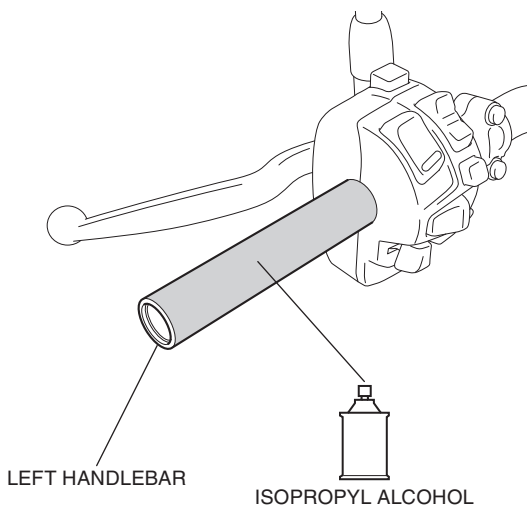

14. Remove the clip as shown.

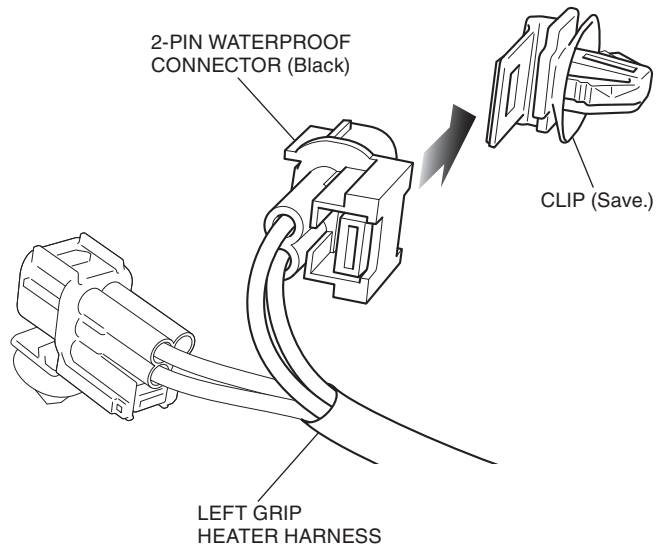

15. Liberally apply the Honda Bond A to the inside of the left heated grip from the kit as shown.

**NOTE**

Read steps 15 through 18 carefully before operation and complete the installation quickly before the adhesive agent cures. Use an assistant to steady the motorcycle while installing the grips.

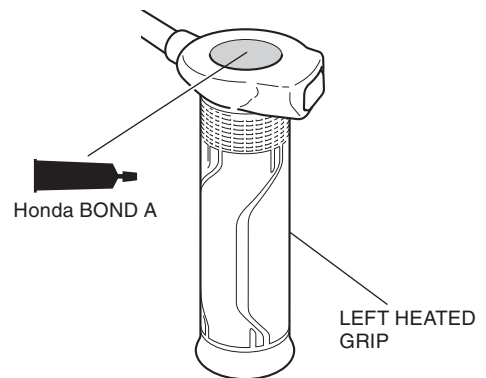

16. Apply the Honda bond A to the left handlebar as shown.

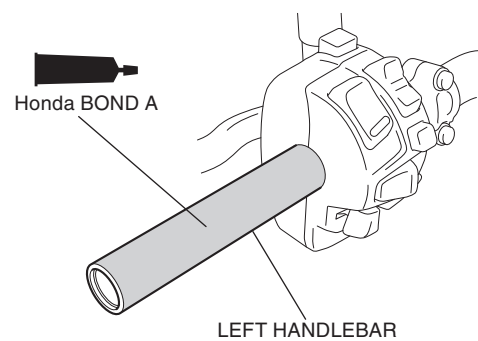

17. Spray isopropyl alcohol over the inside of the heated grip and outside of the left handlebar.

- This is done to ease alignment between the heated grip and the handlebar.

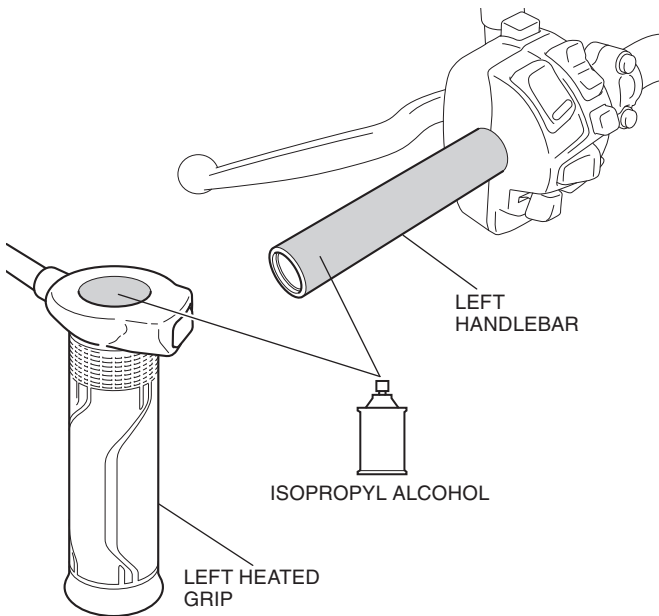

18. Slide the left heated grip onto the left handlebar as indicated.

- Use an assistant to steady the motorcycle while installing the grips.
- Wipe up excess adhesive at once.

#### NOTICE

- Do not tap on the grip end with a hammer and do not twist the grip to install the heated grip onto the handlebar, as it can damage the element.

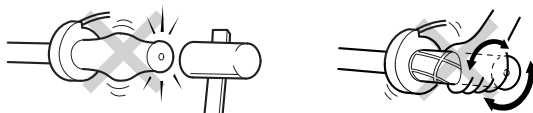

- Avoid putting pressure on the switch part when inserting the left heated grip. There is a possibility that the switch part will break. Also, install so that there is no gap with the switch holder.

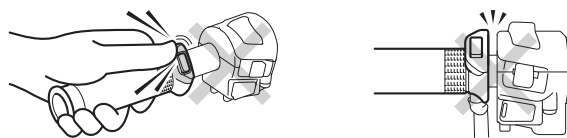

- If the grip gets stuck halfway during installation, apply isopropyl alcohol to the gap between the grip heater. Do not try to remove the heated grip using force or a screwdriver, etc. Damage to the heated grip wire can result.

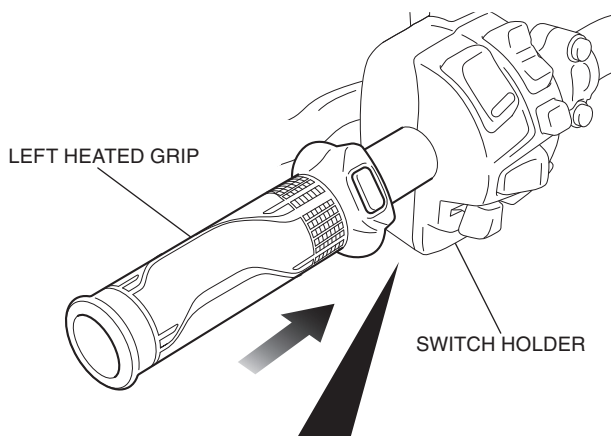

Align the indicated position.

LEFT HEATED GRIP

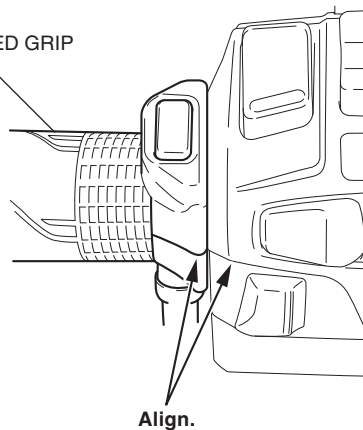

Align.



19. Route the left heated grip harness as shown.

<Left side>

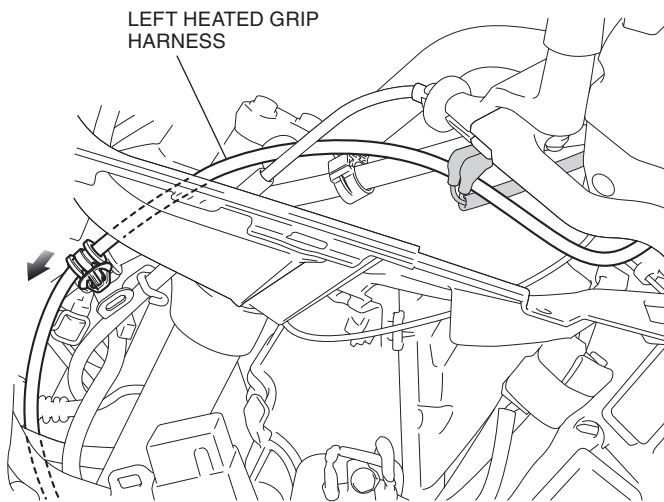

20. Secure the left heated grip harness as shown.

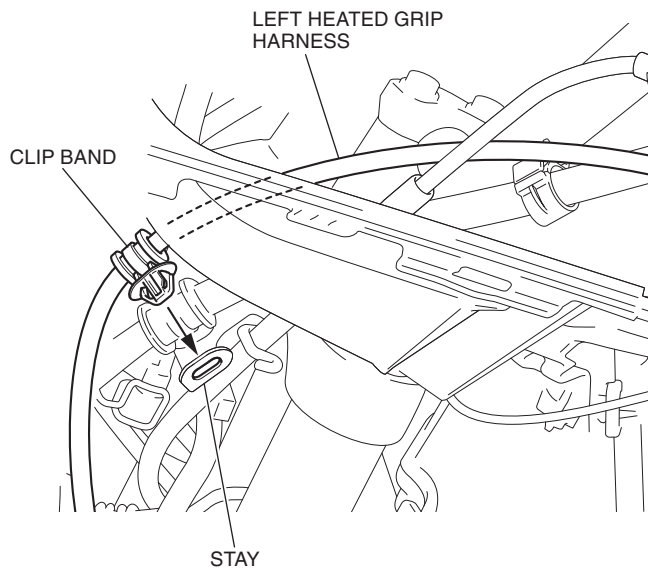

21. Secure the left heated grip harness with the cable clip as shown.

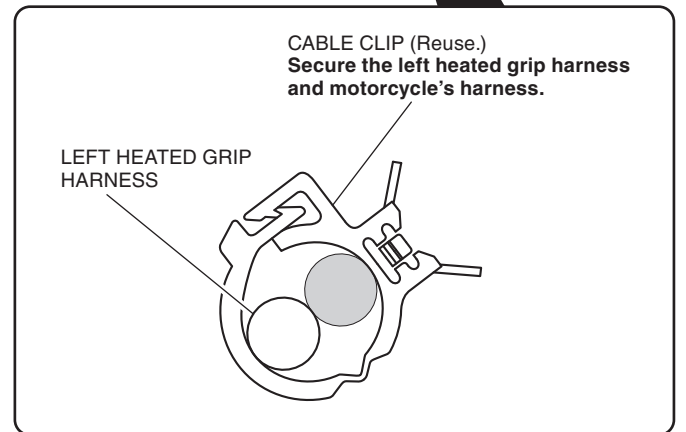
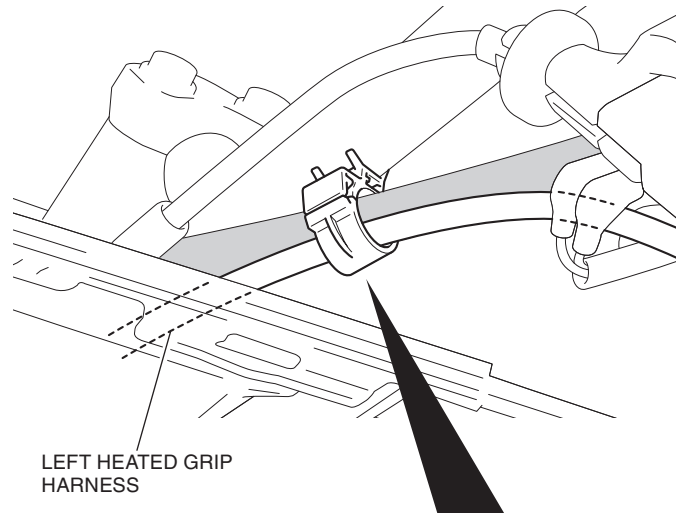

22. Route the left heated grip harness as shown.

<Left side>

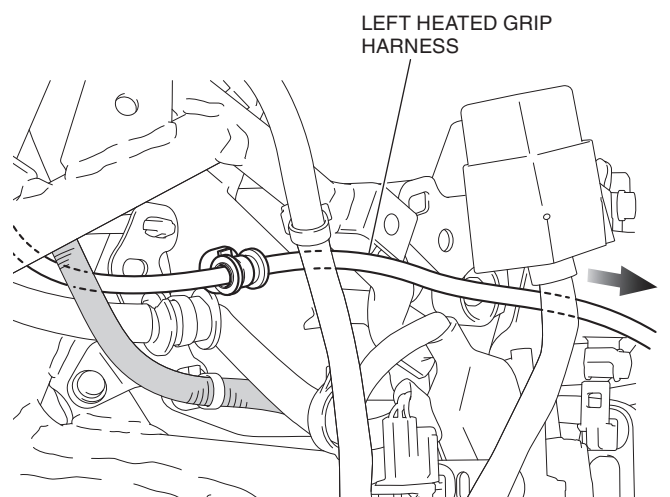

23. Secure the left grip heater harness as shown.

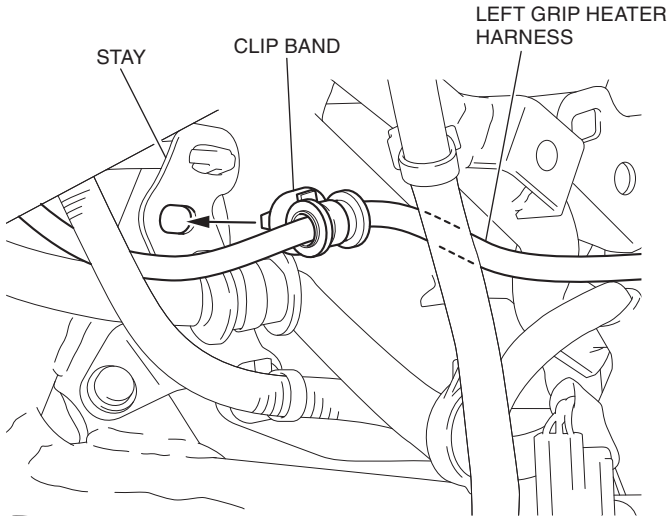

24. Secure the left grip heater harness as shown.

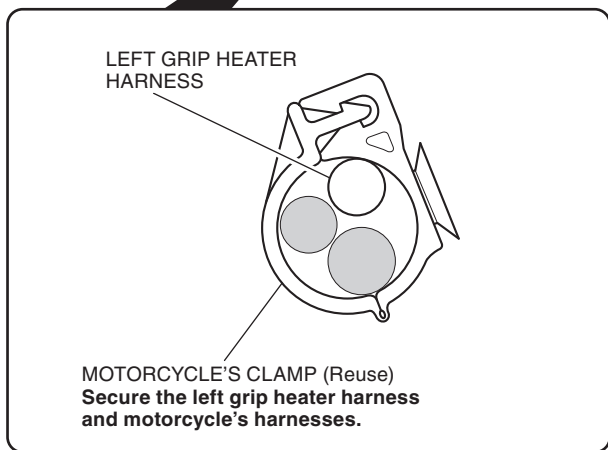
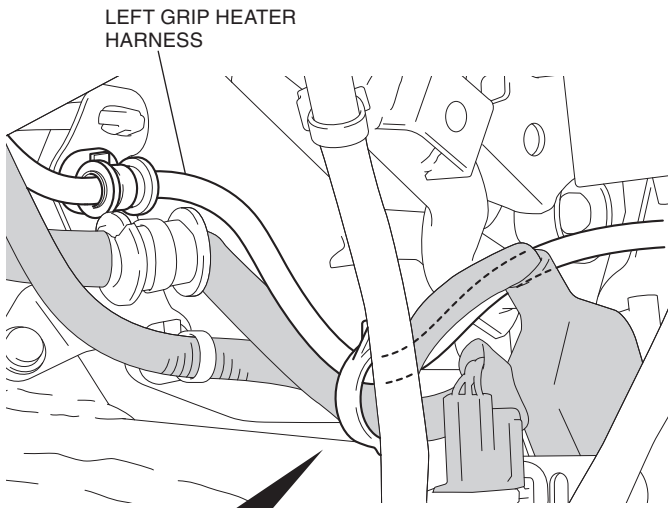

25. Remove the connectors as shown.

<Left side>

2-PIN WATERPROOF CONNECTOR (Black)  
Remove from the clip.

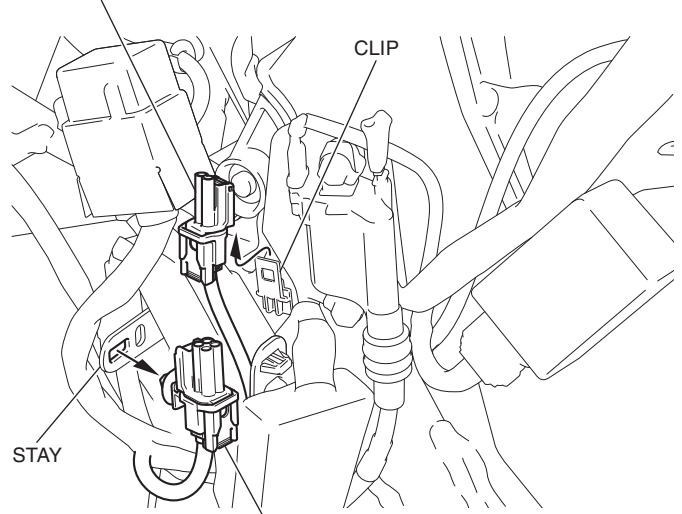

4-PIN WATERPROOF CONNECTOR (Black)  
Remove from the stay.

26. Remove the dummy connectors as shown.

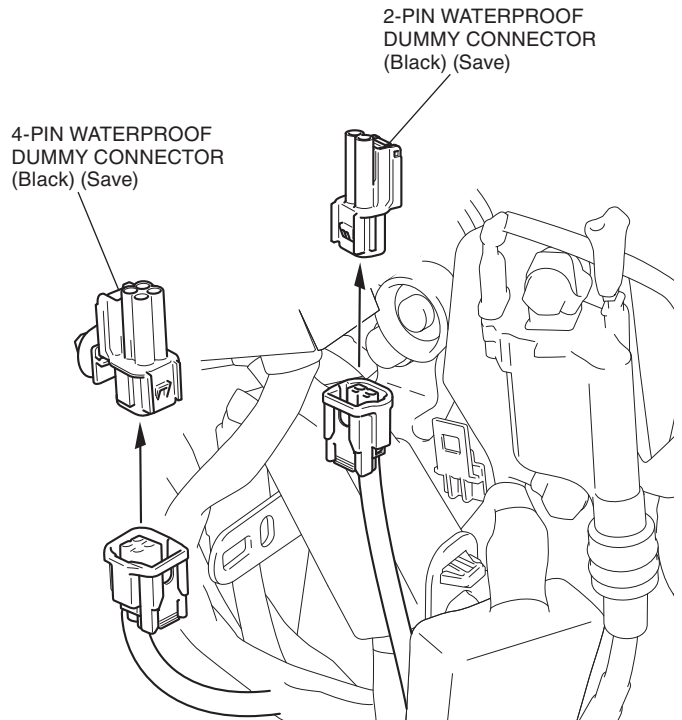

27. Connect the left heated grip harness as shown.

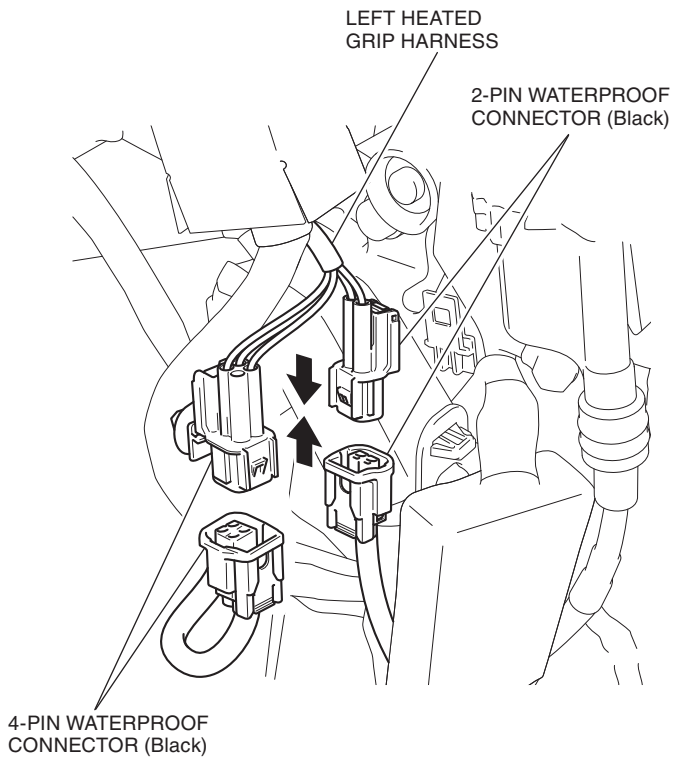

28. Secure the left heated grip harness as shown.

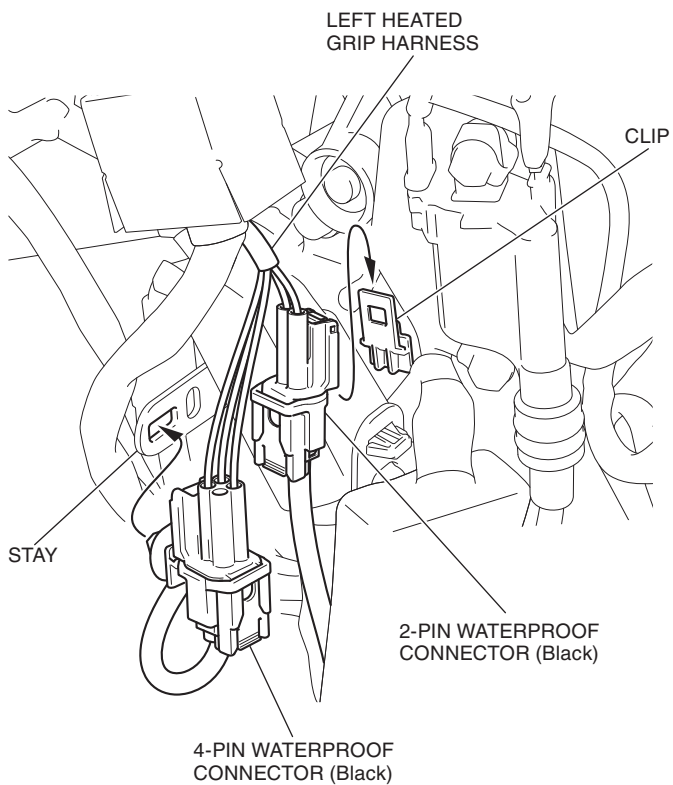

29. Install the suspension as shown.

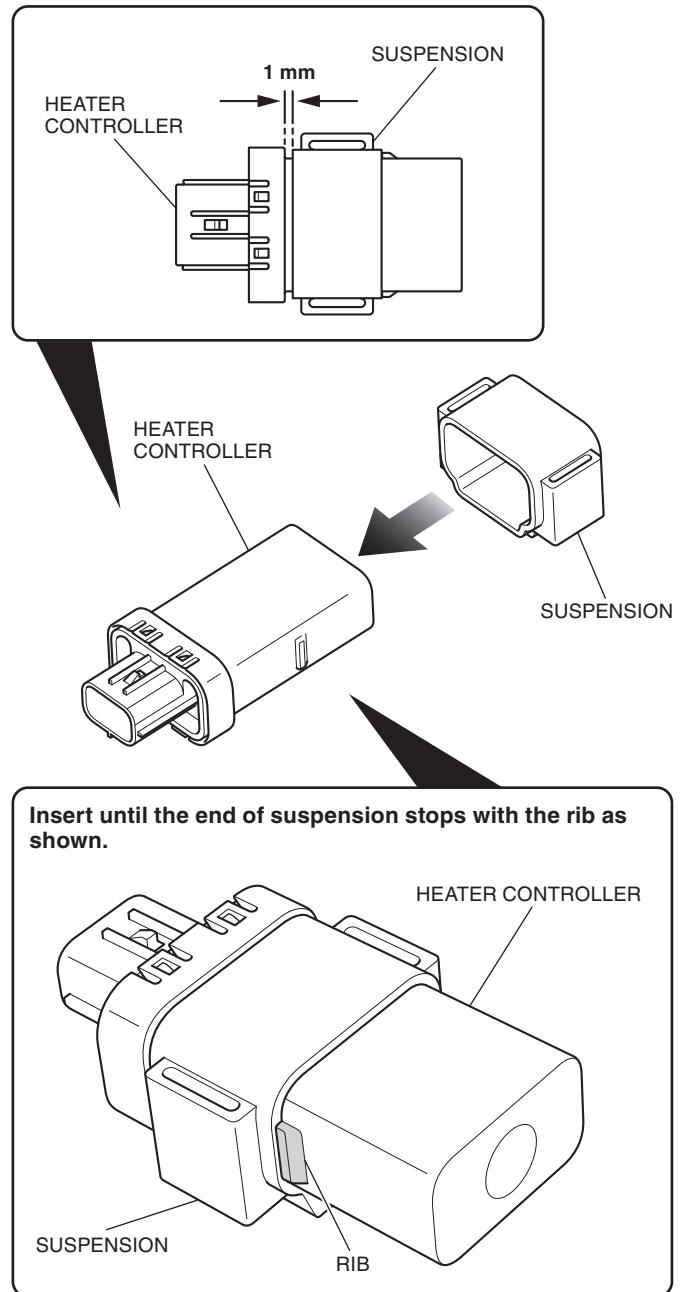



30. Remove the dummy connector as shown.

<Left side>

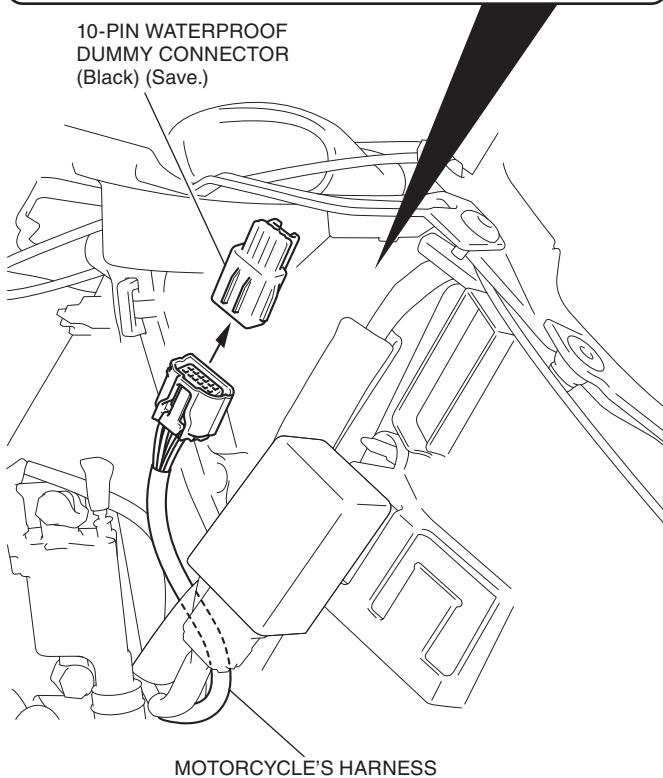
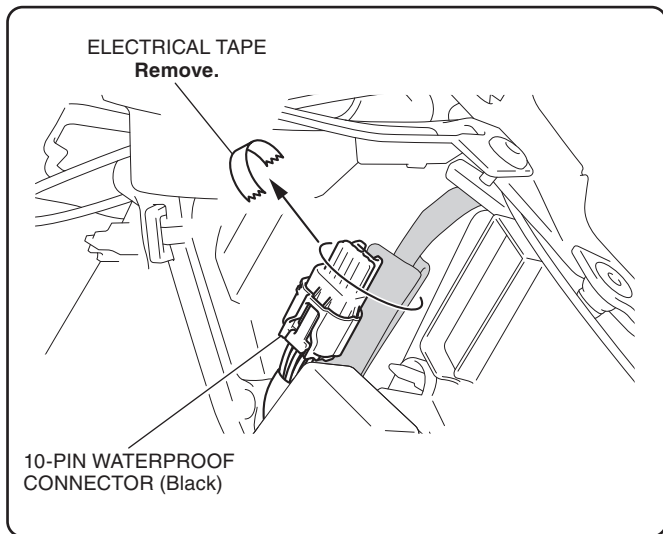

31. Route the motorcycle's harness as shown.

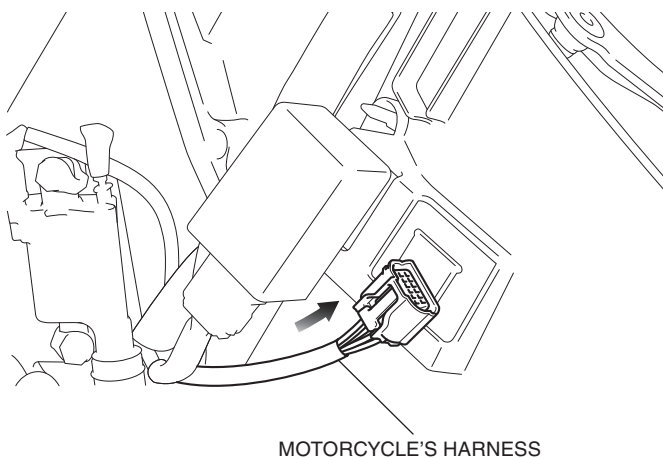

32. Connect the heater controller as shown.

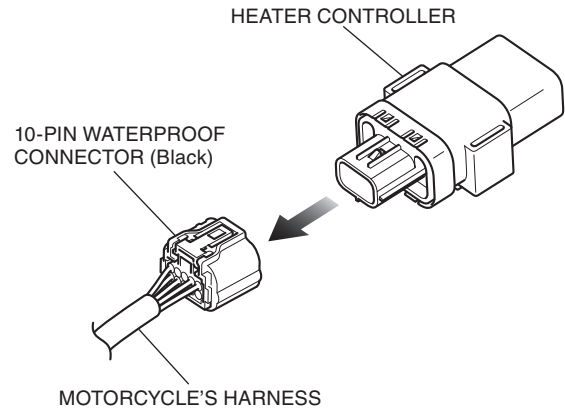

33. Secure the heater controller as shown.

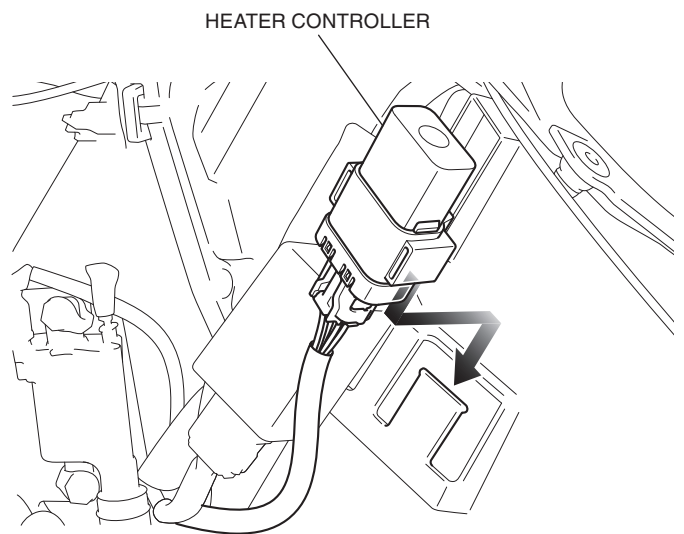

34. Loosen the bolts and move the brake master cylinder as shown.

<Right side>

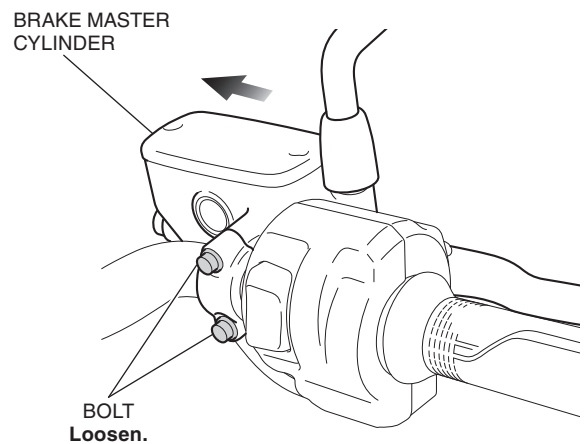

35. Remove the front case as shown.

<Right side>

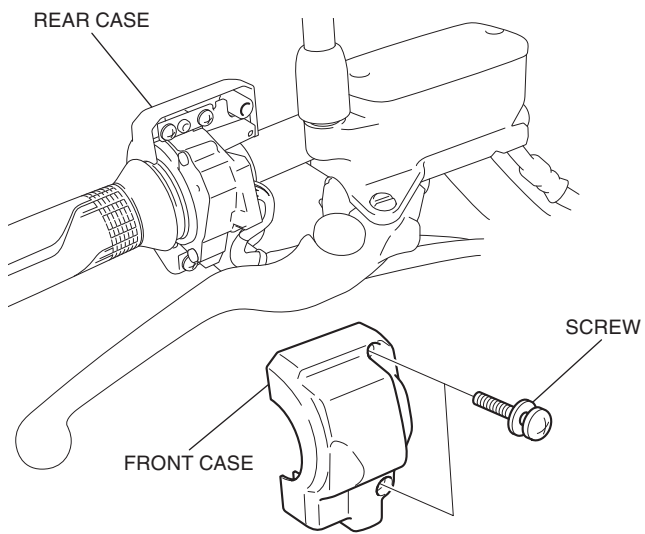

36. Remove the screws as shown.

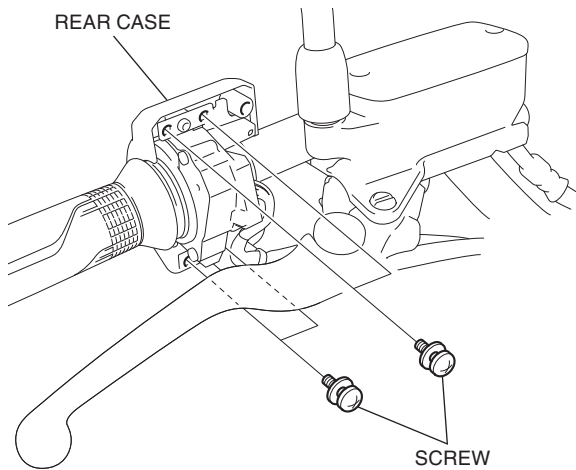

37. Remove the right grip as shown.

**NOTE**

Remove the right grip as instructed in the motorcycle's Service Manual.

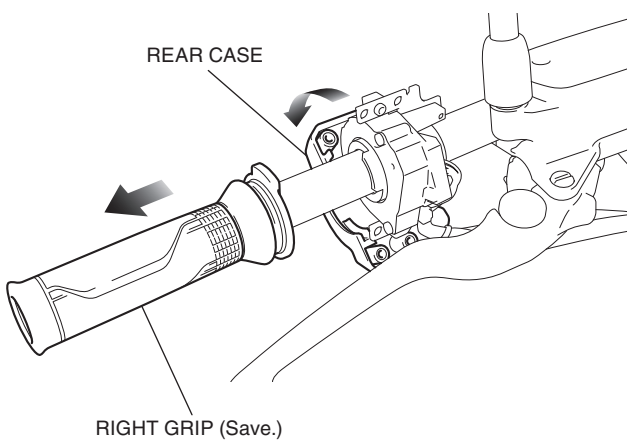

38. Apply grease to the hatched part as shown.

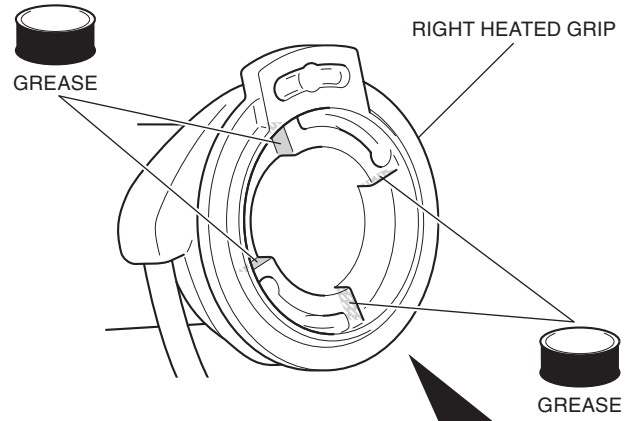

Be careful not to adhere grease to the outside of dimensions shown.

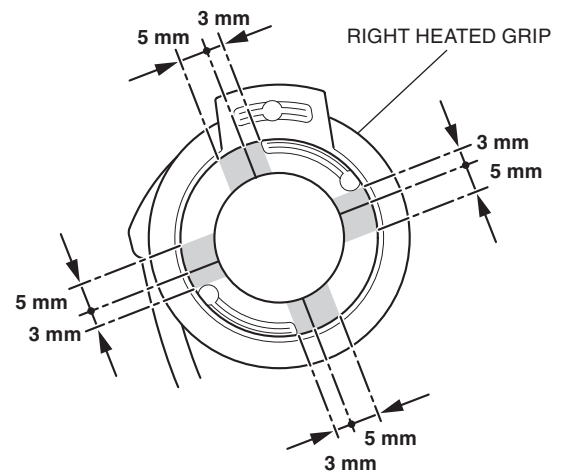

39. Apply grease to the hatched part as shown.

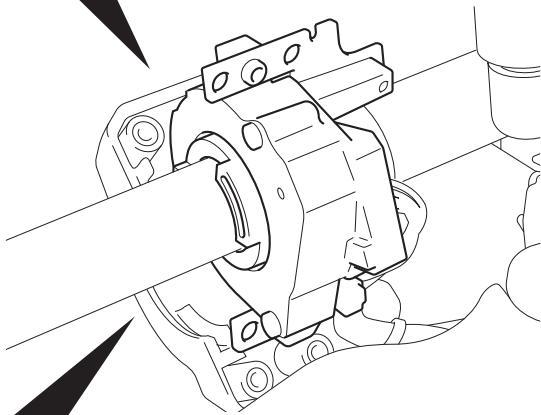
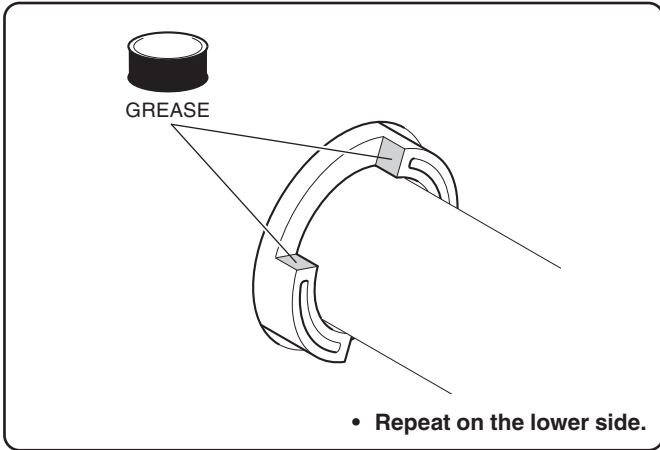

Be careful not to adhere grease to the outside of dimensions shown.

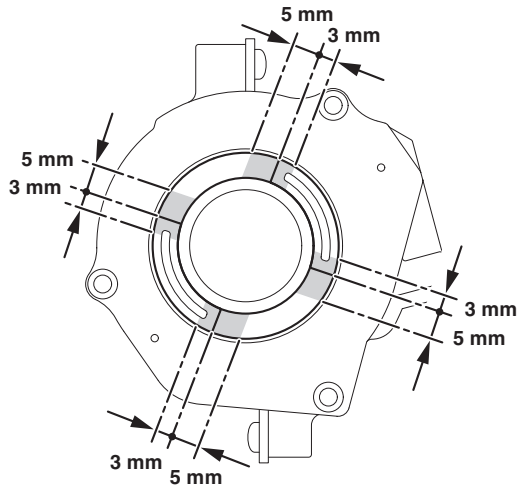

40. Install the right heated grip as shown.

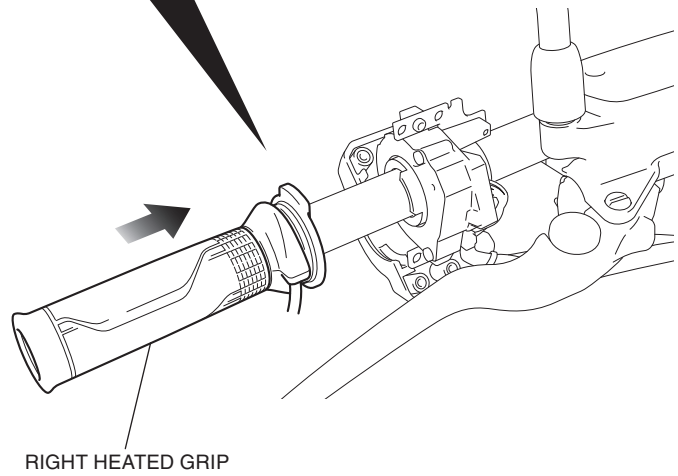
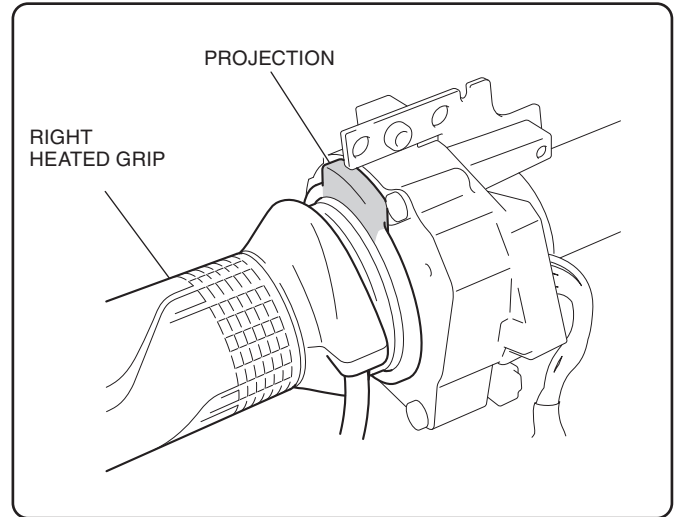

41. Install the front and rear case in the reverse order of removal.

42. Twist the throttle grip as shown.

- Check for smooth opening of the throttle and that it automatically snaps closed from any opening, in all steering positions.

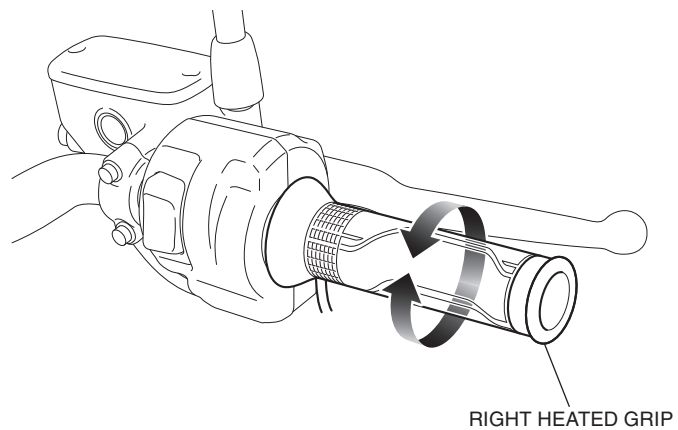

43. Remove the bolt as shown.

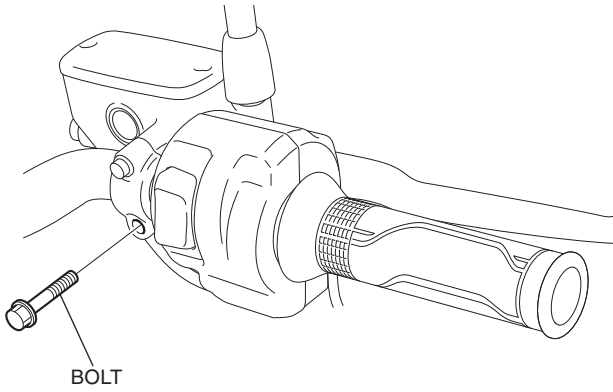

44. Install the clamp as shown.

- Tighten the upper bolt first, then tighten the lower bolt.

Align the brake master cylinder matching surface with the punch mark.

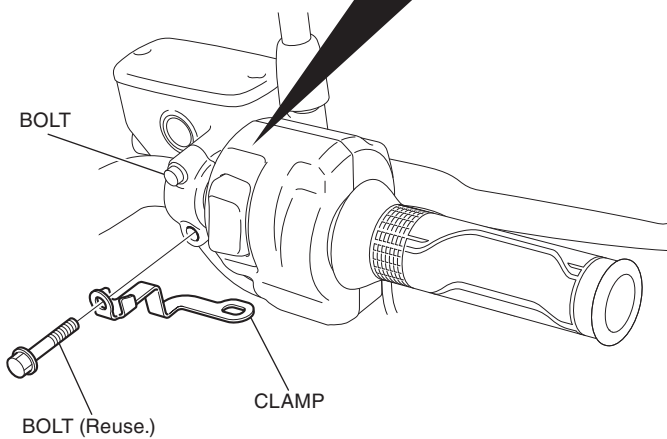
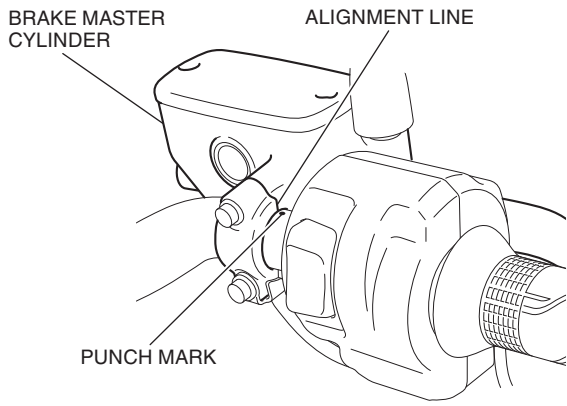

45. Secure the right heated grip harness as shown.

- Open and close the throttle and confirm that there is no tightness of the heated grip harness.

<Right side>

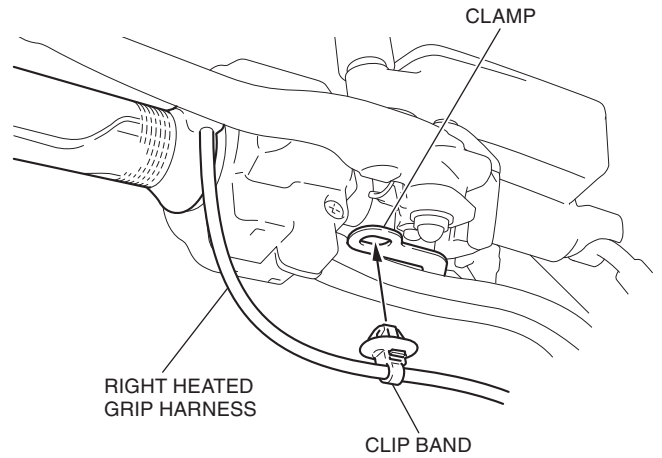

46. Route the right heated grip harness as shown.

<Right side>

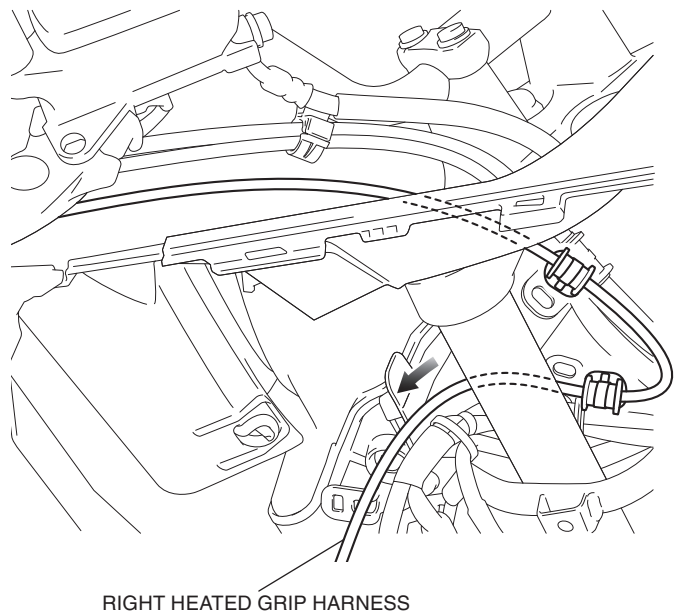

47. Secure the right heated grip harness as shown.

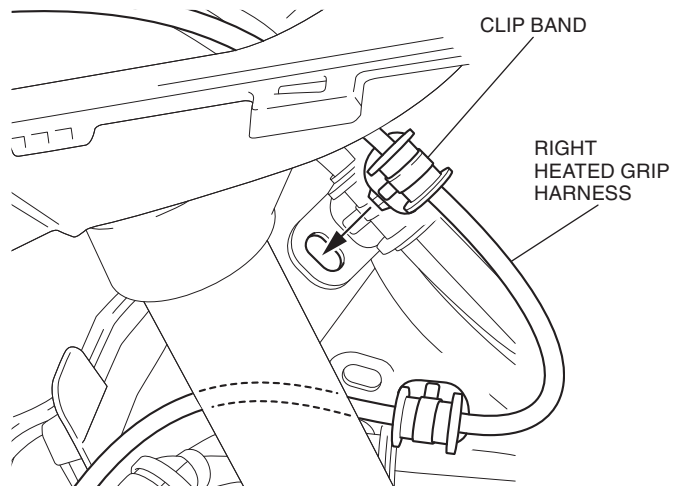

48. Secure the right heated grip harness with the clamps as shown.

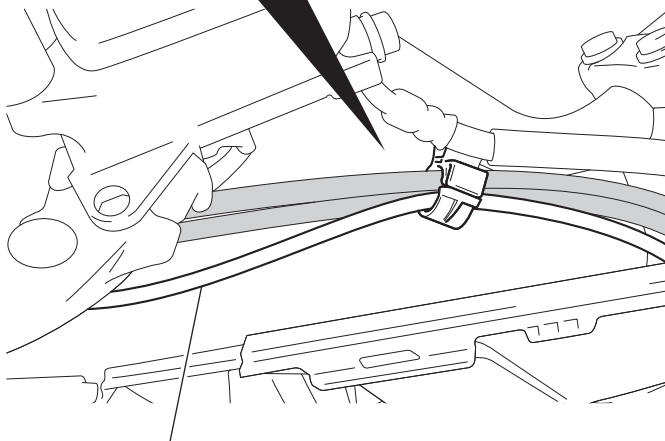
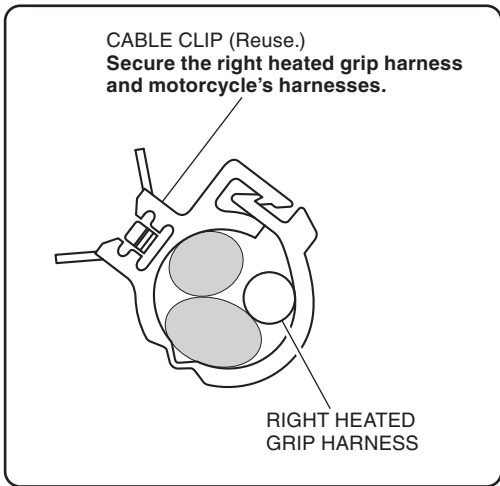

RIGHT HEATED GRIP HARNESS

49. Remove the connector as shown.  
<Right side>

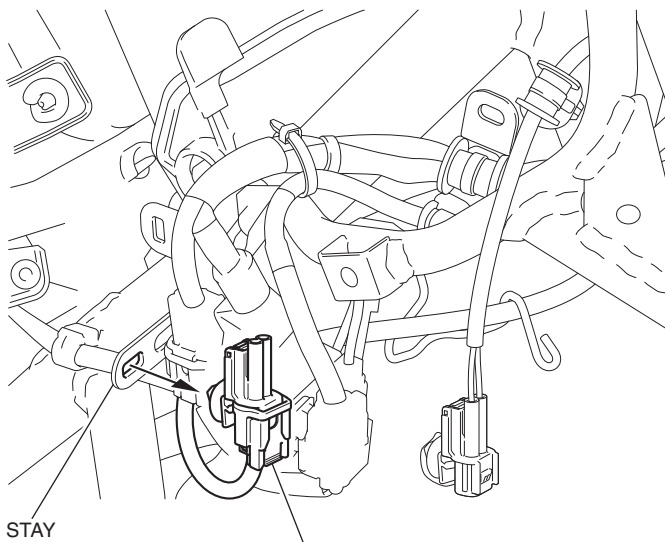

STAY

2-PIN WATERPROOF CONNECTOR (Black)  
Remove from the stay.

50. Remove the dummy connector as shown.

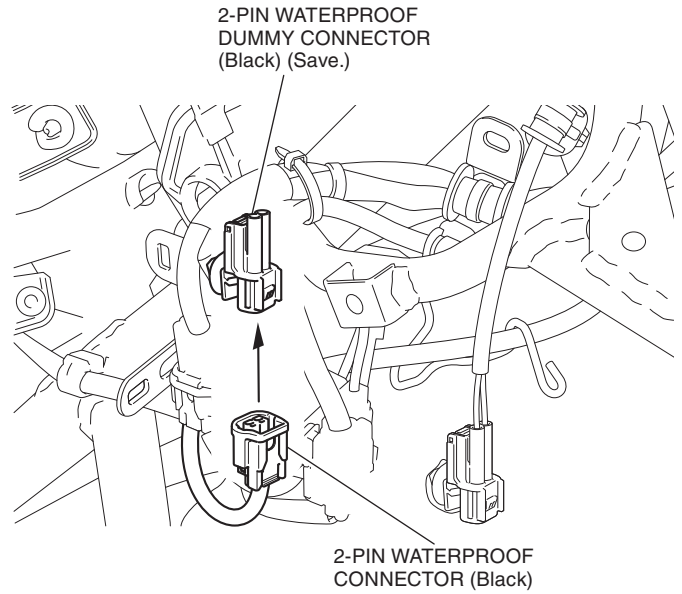

51. Secure the right heated grip harness as shown.

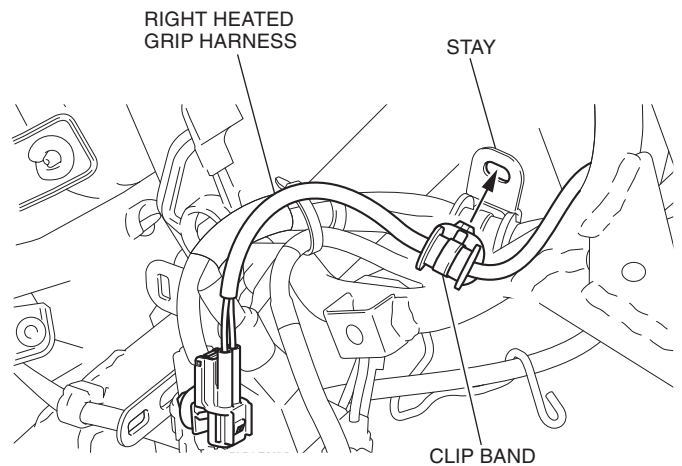

52. Connect the right heated grip harness as shown.

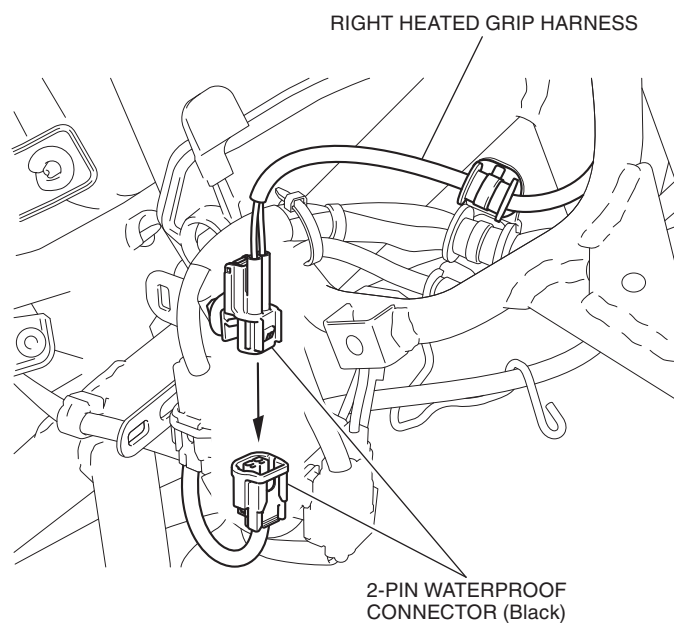

53. Secure the right heated grip harness as shown.

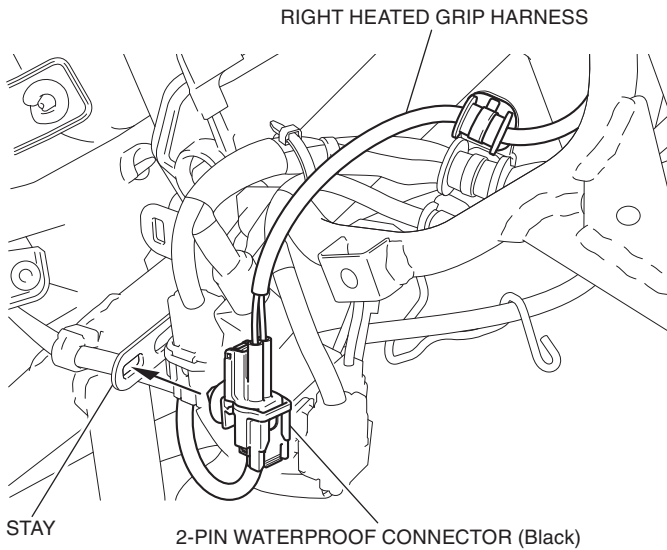

54. Secure the right heated grip harness as shown.

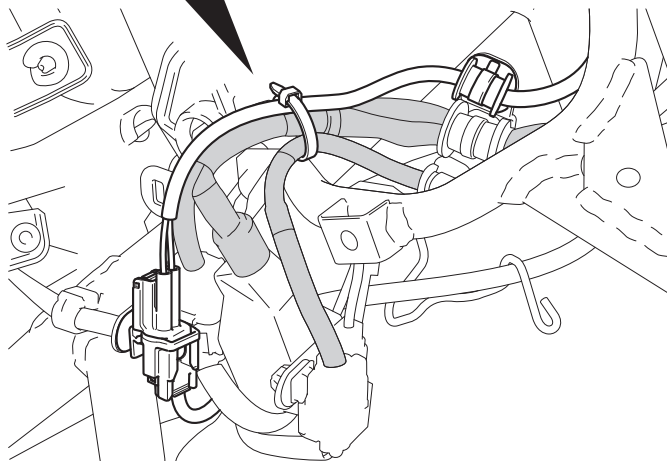
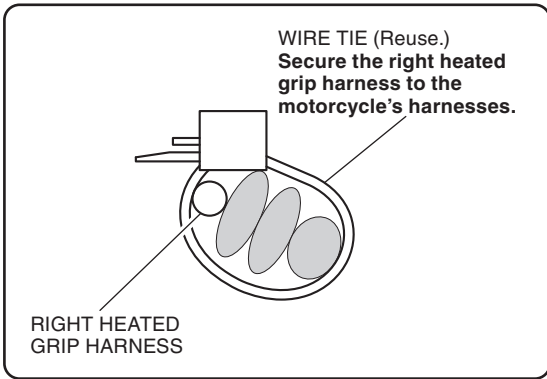

55. Check each harness for sufficient play.

- Move the handlebar right and left and check that the harnesses are not pinched by neighboring components and that they are not pulled taut.

56. Reinstall the parts as shown.

- Clean up with isopropyl alcohol before applying thread lock.
- Be sure to apply to the threads of the screw.
- Repeat on the right side.

<Left side>

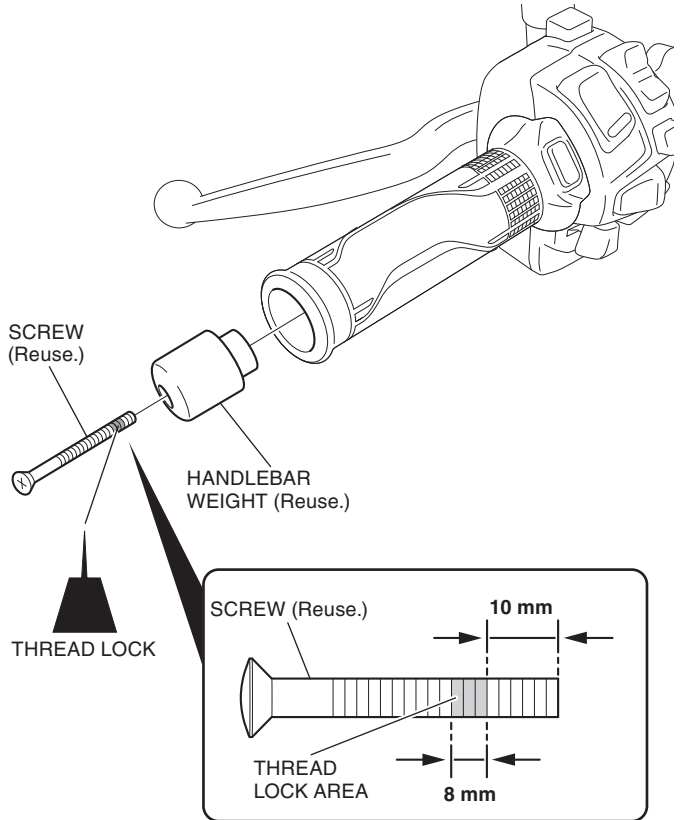

57. Install the motorcycle's parts in the reverse order of removal.







- Confirm that the wire harness is not caught or too tight.

58. Check the heated grip, throttle, headlight and the other lights for proper operation.



## DEALER TROUBLESHOOTING

- When the grip heater has abnormalities, the grip heater status icon on the combination meter and the grip heater switch indicator show following displays. Follow each instruction to perform inspection.

Grip heater status icon (On the combination meter)	Grip heater switch indicator	Check
Blink. 	Blink once. 	1
Blink. 	Blink twice. 	2, 3, 4, 5
Blink. 	Blink 3 times. 	
-	Indicator does not light on.	6
Status icon does not light on.	-	

- Battery inspection:  
Refer to the Service Manual and inspect the battery.
- Check whether wires and cables (terminals and connectors) are connected securely.
- Grip heater inspection:  
Check for resistance between the terminals.  
➔ Standard:  
Right : 1.9 ohms +/- 10%  
Left : 1.9 ohms +/- 10%
- Heater harness inspection:  
Check for continuity.
- If no abnormality is found after the above checks 2, 3, and 4, but the grip heater still does not operate properly, replace the grip heater with a new one.
  - It is hard to check the switch with ordinary inspection methods (for continuity, voltage, etc.) because it contains an integrated circuit.
- Circuit of status icon inspection:  
Refer to the Service Manual and inspect the circuit of status icon.

# SYSTEM DIAGRAM

