

# HONDA

## INSTALLATION INSTRUCTIONS

Accessory  
**HEATED GRIP ATTACHMENT**  
**P/N 08T70-MGZ-D80**

Application  
**CB500X/XA**

Publication No.  
**MII 14565**  
 Issue Date  
**May 2013**

### PARTS LIST

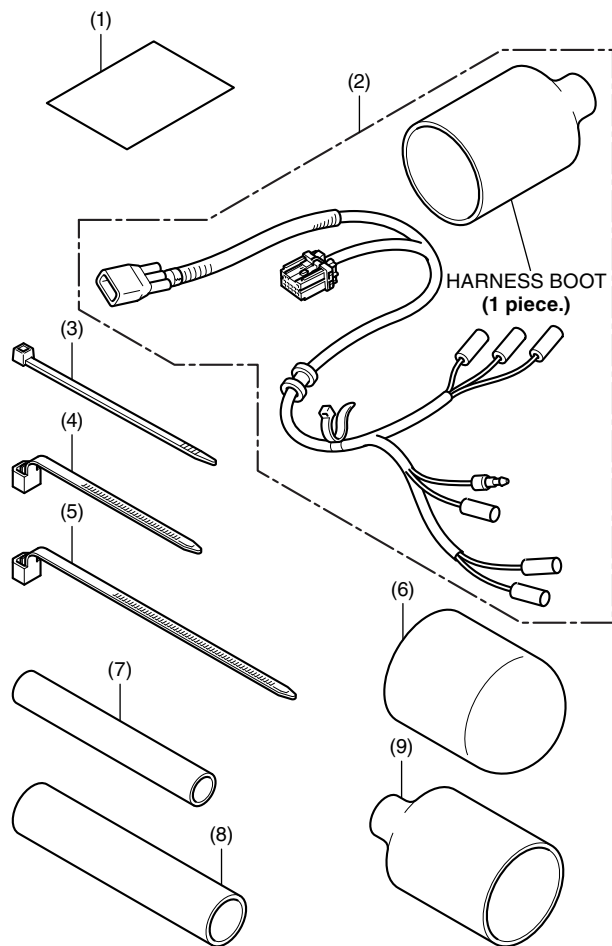

No.	Description	Qty
(1)	Installation Instruction URL	1
(2)	Heated grip harness	1
(3)	Wire tie (narrow)	7
(4)	Wire tie (short)	3
(5)	Wire tie (long)	3
(6)	Boot cover	1
(7)	Tube A (Length: 110 mm)	2
(8)	Tube B (Length: 120 mm)	1
(9)	Harness boot	1

### HEATED GRIP KIT

Sold separately

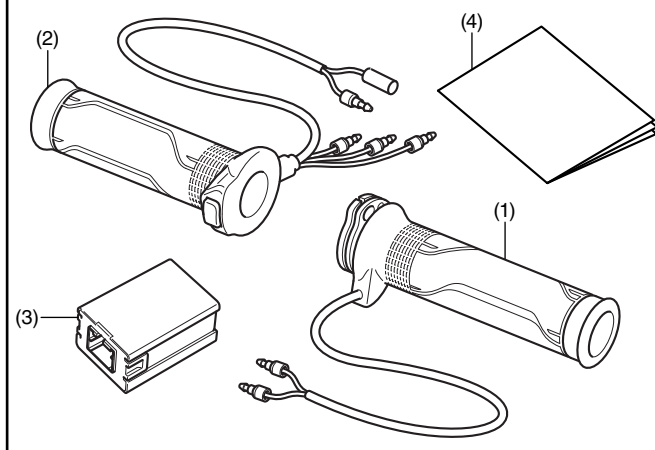

No.	Description	Qty
(1)	Right heated grip	1
(2)	Left heated grip	1
(3)	Controller	1
(4)	Owner's Manual	1

### TOOLS AND SUPPLIES REQUIRED

Side cutters  
 Ruler  
 Marker  
 Electrical tape  
 ProHonda Handgrip Cement  
 Grease  
 Thread lock  
 Isopropyl alcohol  
 Shop towel

### TORQUE INFORMATION

Refer to the Service Manual for the torque values of the removed parts.

## INSTALLATION

### ▲ CAUTION

- To prevent burns, allow the engine, exhaust system, radiator, etc., to cool before installing the accessory.

#### NOTE:

- Disconnect the throttle cables from the right grip as instructed in the motorcycle's Service Manual.
  - For secure adhesion of the left heated grip to the handlebar, use the recommended adhesive agent (Pro Honda Handgrip Cement) and wait until it cures fully before use.
  - Be sure to open and close the throttle to check for smooth operation after installation of the right heated grip.
  - Take care not to damage the painted surfaces of the motorcycle.
  - Reinstall the removed parts on the motorcycle and make sure that wires and harnesses are not pinched.
  - Disconnect the negative (-) cable from the battery before installing this accessory.
  - The memory of the trip meter will be erased and the clock will stop when the battery is disconnected. After reconnecting the battery, refer to the motorcycle Owner's Manual and reset the clock.
  - Trim the excess ends off the wire ties after attaching them to the wire harnesses. Do not allow the cut part of the wire tie to interfere with any harness or brake hose.
  - After heated grip installation, check the lights (e.g. right / left turn signal lights and brake lights) for proper operation.
  - HISS: Some markets have motorcycles equipped with the Honda Integrated Security System (HISS) and can be identified by the HISS mark near the ignition switch.
1. Refer to the Service Manual for the motorcycle, remove the seat.

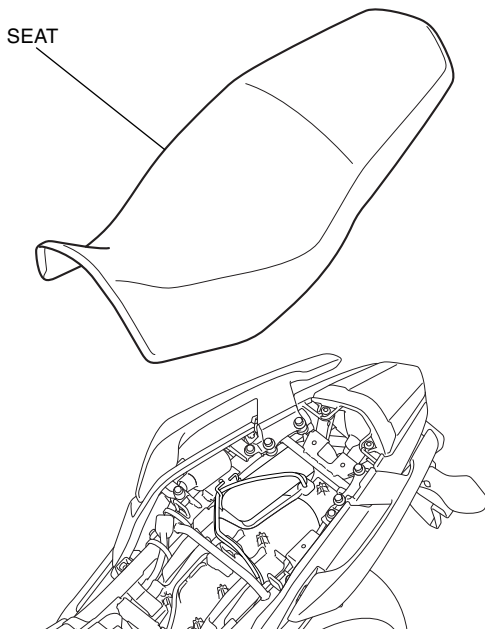

2. Disconnect the negative (-) cable from the battery as shown.

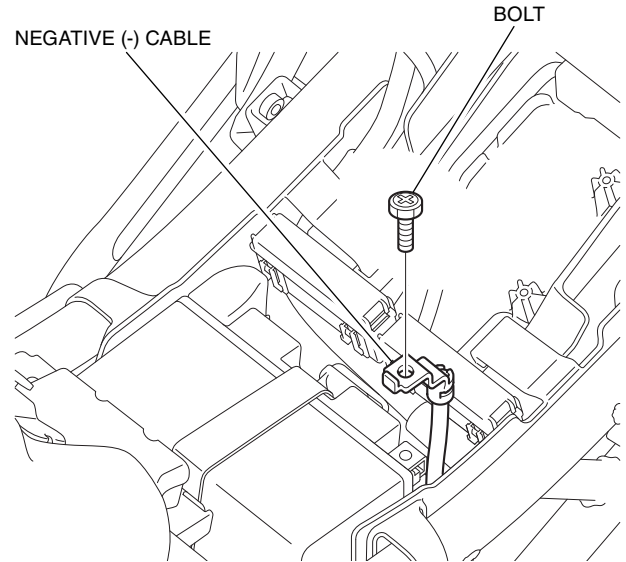

3. Refer to the Service Manual for the motorcycle, remove the left and right side covers.
  - Repeat on the right side.

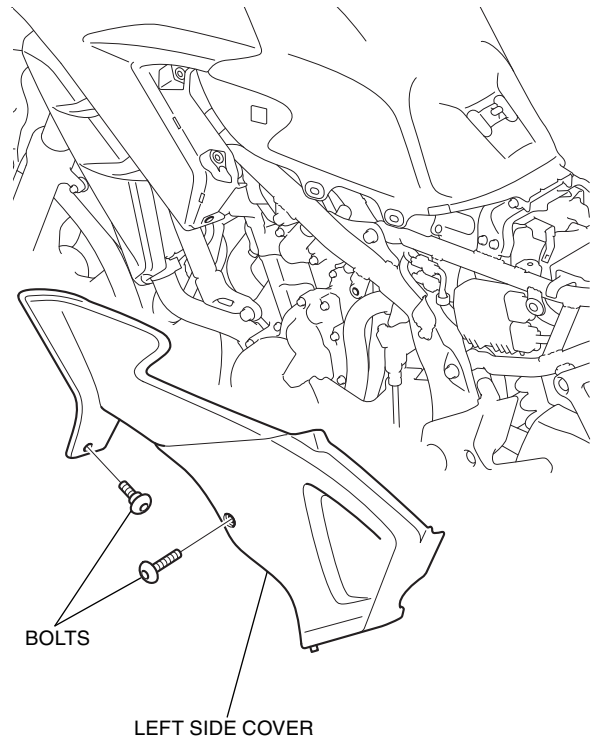

4. Refer to the Service Manual for the motorcycle, remove the left and right shrouds.

- Repeat on the right side.

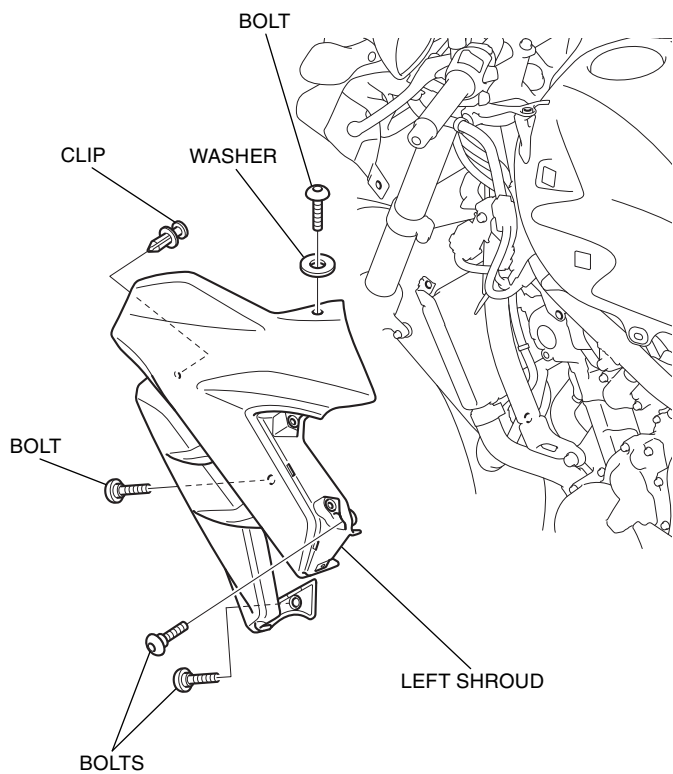

5. Refer to the Service Manual for the motorcycle, remove the inner cowls.

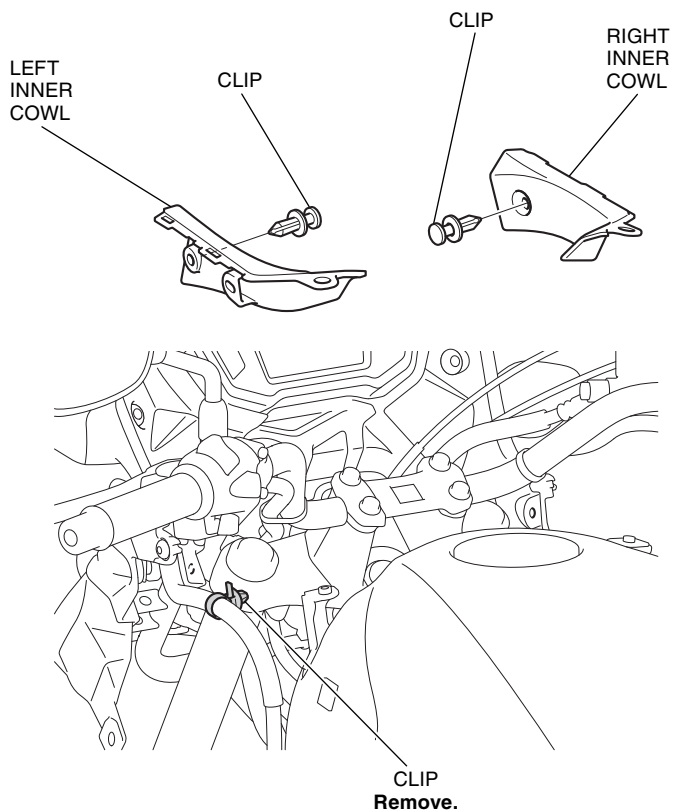

6. Refer to the Service Manual for the motorcycle, remove the meter panel.

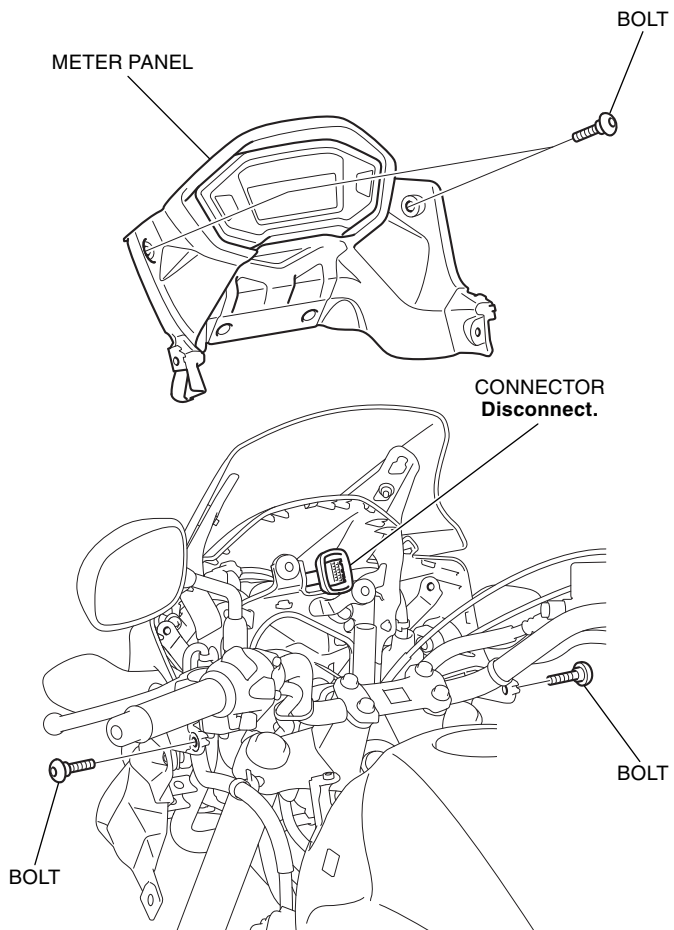

7. Remove the handlebar weights from the motorcycle as shown.

- Repeat on the left side.

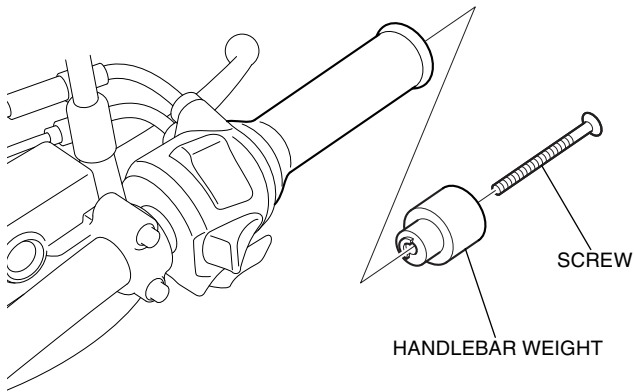

8. Remove the right handlebar switch as shown.

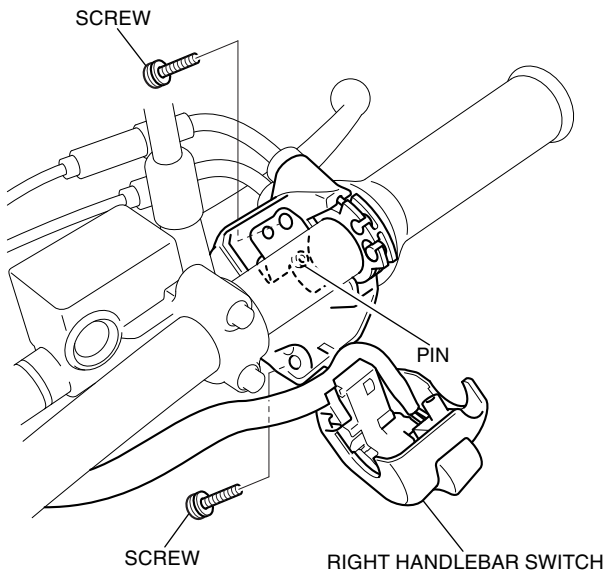

9. Remove the right grip as shown.

**NOTE**

Refer to the motorcycle's Service Manual and disconnect the throttle cable from the right grip as instructed. Do not try to disconnect the cable with force using pliers, etc.

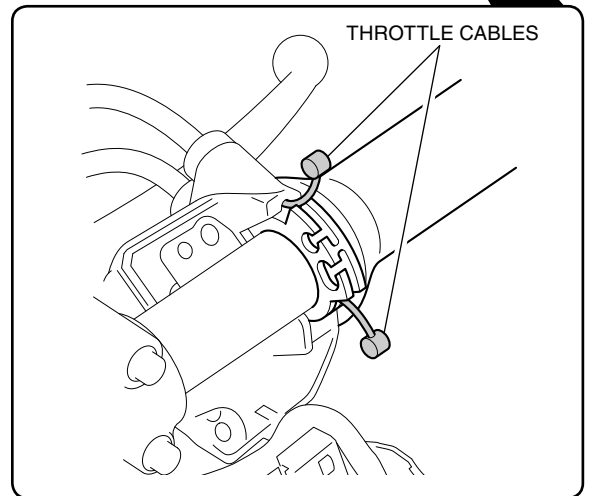
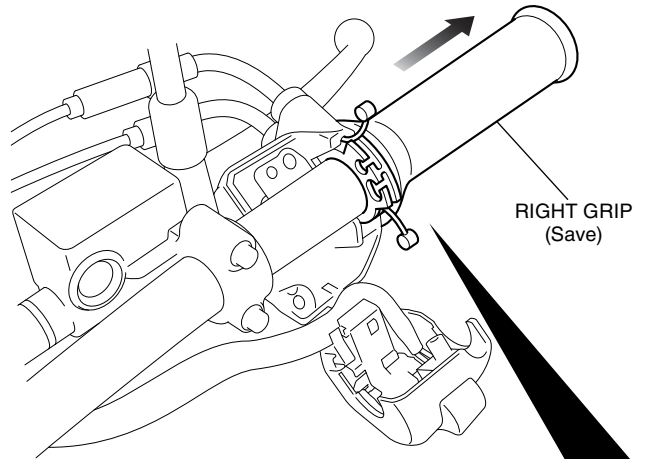

10. Mark the right heated grip harness in the position shown.

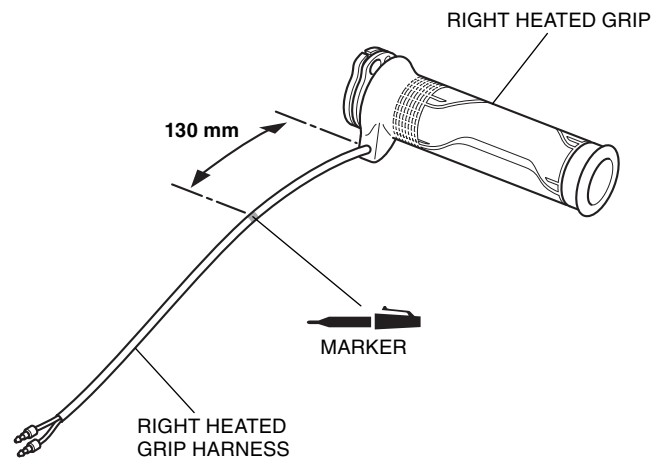

11. Apply grease to the  parts of the throttle cables and throttle pipe as shown.

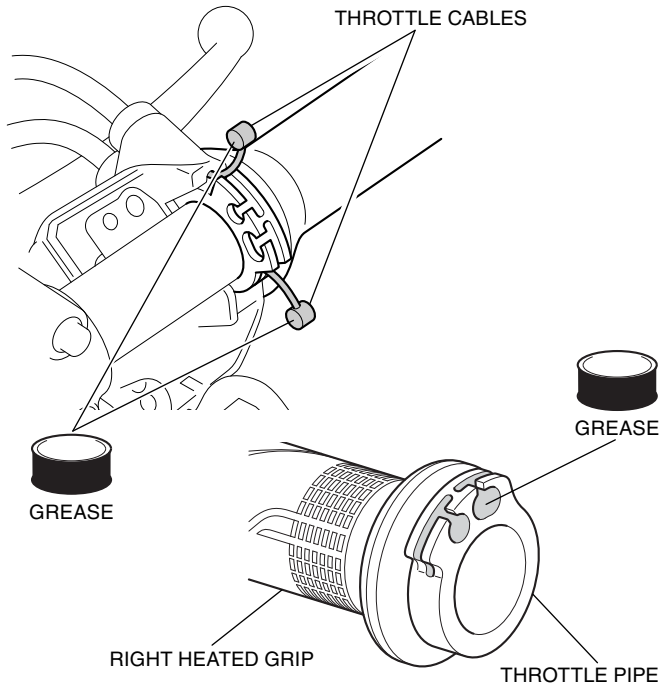

12. Install the right heated grip in the reverse order of the motorcycle's grip removal.

- **After installation, refer to the Service Manual and adjust the throttle freeplay.**

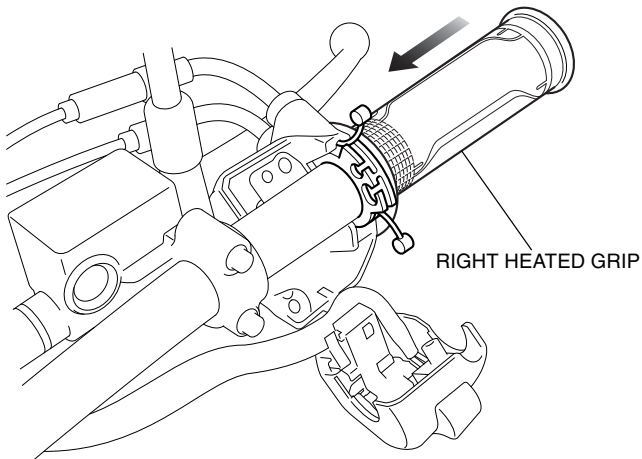

13. Reinstall the handlebar weight as shown.

- **Before applying thread lock, thoroughly clean the screw.**

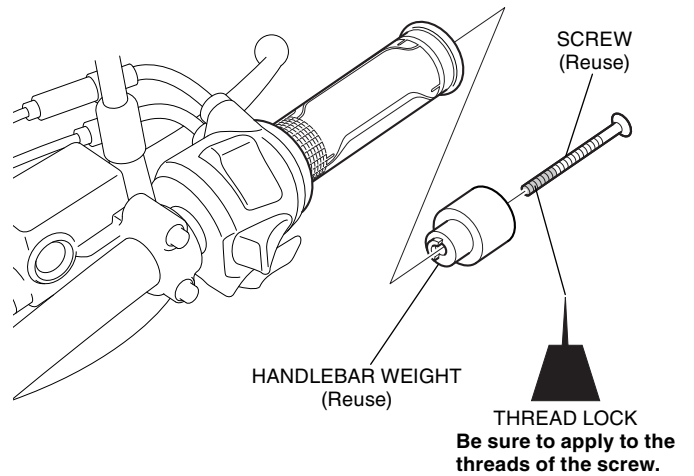

14. Open and close the throttle grip as shown.

- **Check that the throttle opens and automatically closes smoothly from all steering positions.**

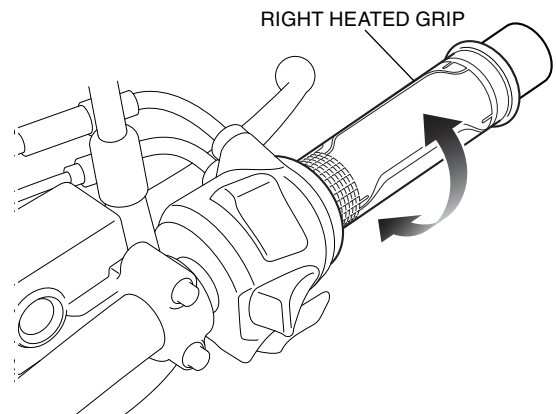

15. Secure the right heated grip harness as shown.

- **Open and close the throttle and confirm that there is no tightness of the heated grip harness.**

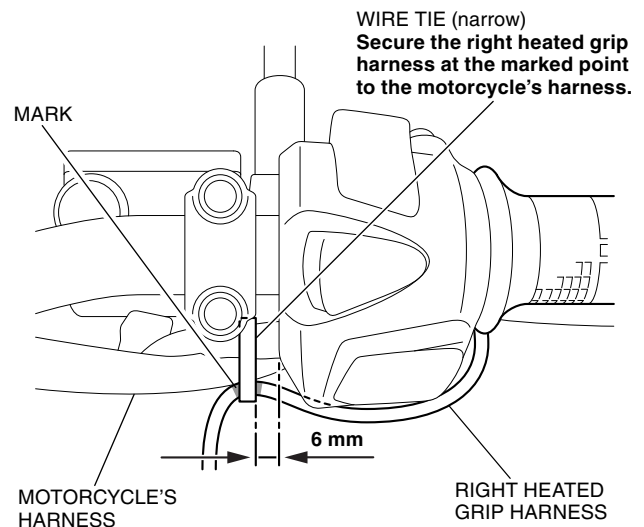

16. Remove the left grip as shown.

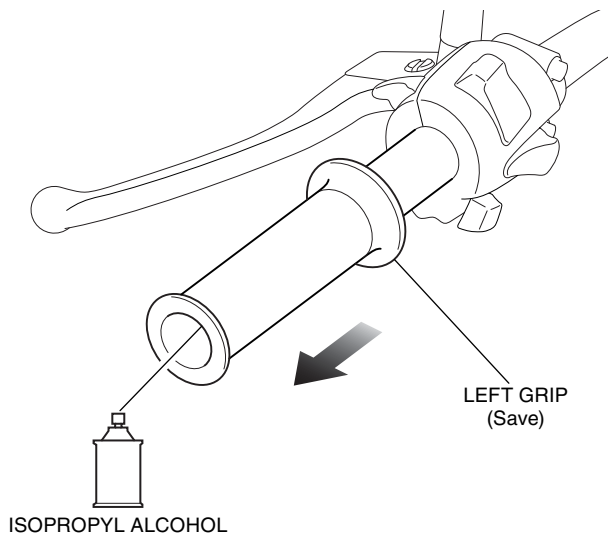

17. Using isopropyl alcohol, remove all traces of adhesive from the left handlebar.

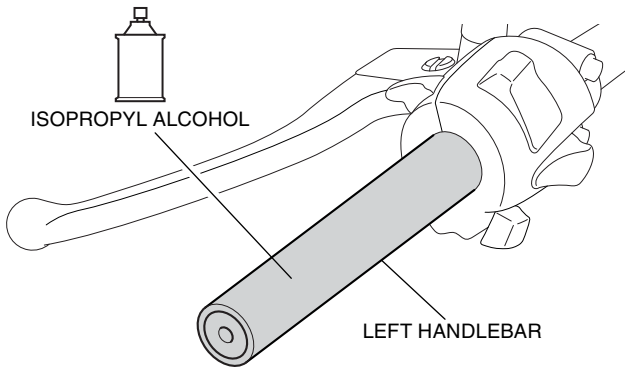

18. Liberally apply Pro Honda Handgrip Cement to the inside of the left heated grip as shown.

**NOTE**  
Read the Instructions of steps 18 through 21 carefully before installation and complete the operation quickly before the adhesive cures. Use an assistant to steady the motorcycle while installing the grip.

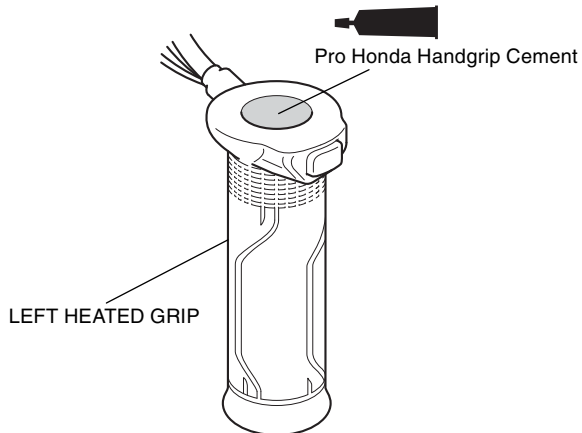

19. Apply Pro Honda Handgrip Cement to the left handlebar as shown.

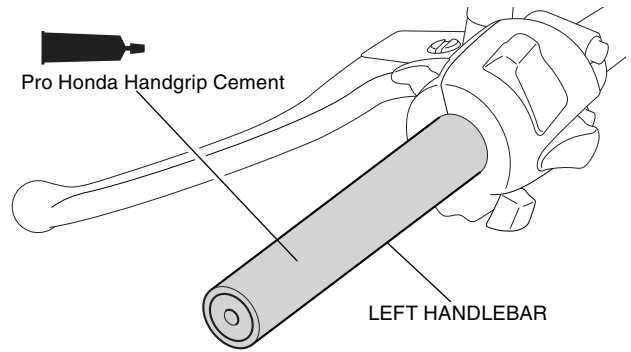

20. Spray isopropyl alcohol over the inside of the left heated grip and outside of the left handlebar.

- This is done to ease alignment between the heated grip and handlebar.

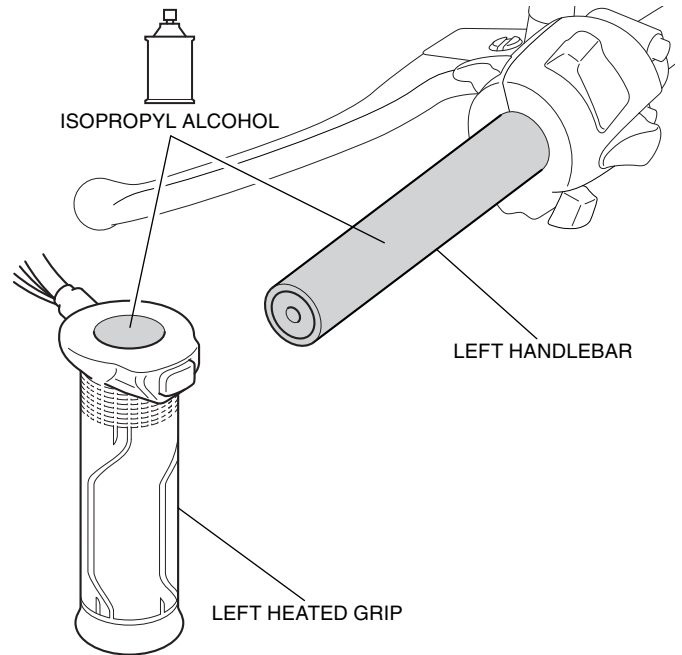

21. Slide the left heated grip onto the left handlebar as indicated.

- Wipe up excess adhesive at once.

**NOTICE**

- Do not tap on the grip end with a hammer and do not twist the grip with force to insert the left heated grip onto the handlebar, as it can damage the heated grip element.

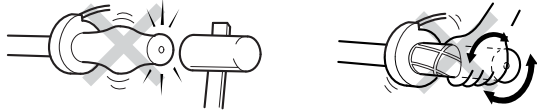

- Avoid putting pressure on the switch part when inserting the left heated grip. There is a possibility that the switch part will break. Also, install so that there is no gap with the left handlebar switch.



- If the grip gets stuck halfway during installation, apply isopropyl alcohol between the heated grip and handlebar. Do not try to remove the left heated grip using force or tools as the heated grip element can be damaged.

Insert until there is contact with the left handlebar switch, then align with the indicated position.

Push in tight against the left handlebar switch.

LEFT HEATED GRIP

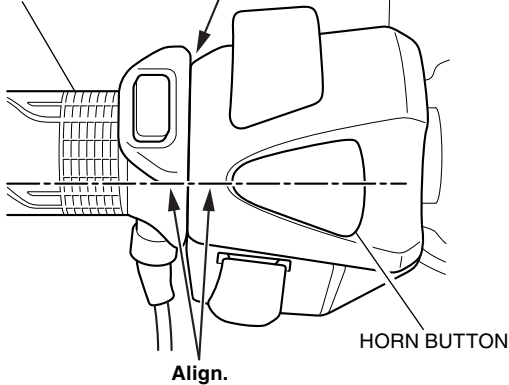

HORN BUTTON

Align.

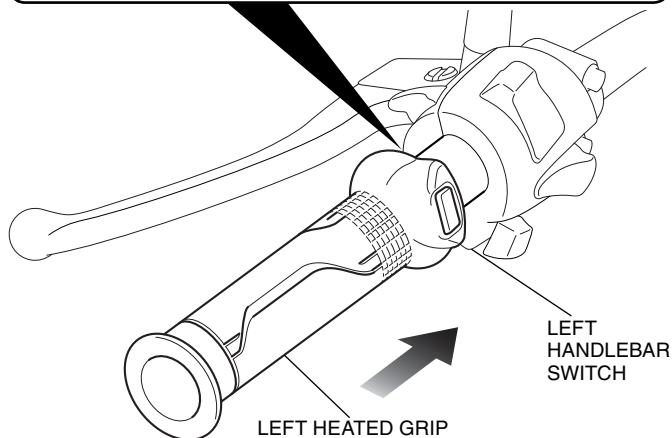

LEFT HANDLEBAR SWITCH

LEFT HEATED GRIP

22. Reinstall the handlebar weight as shown.

- Before applying thread lock, thoroughly clean the screw.

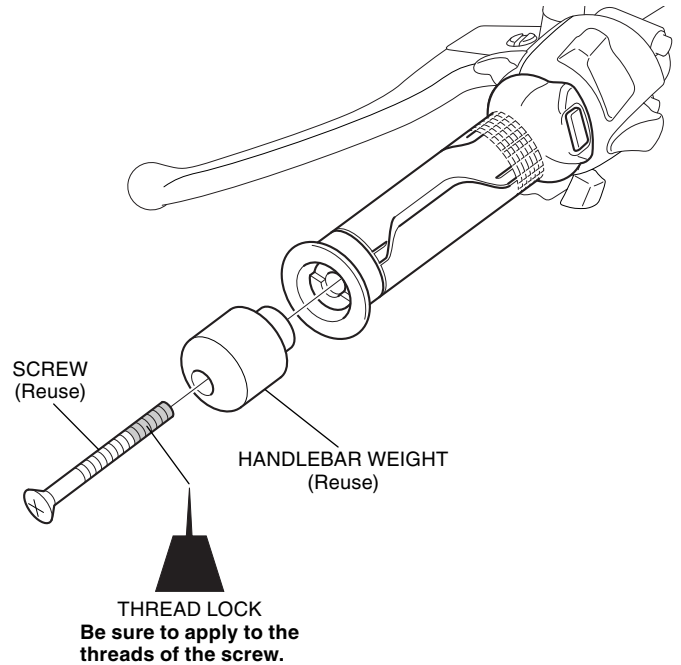

SCREW (Reuse)

HANDLEBAR WEIGHT (Reuse)

THREAD LOCK  
Be sure to apply to the threads of the screw.

23. Move the front upper cowl as shown.

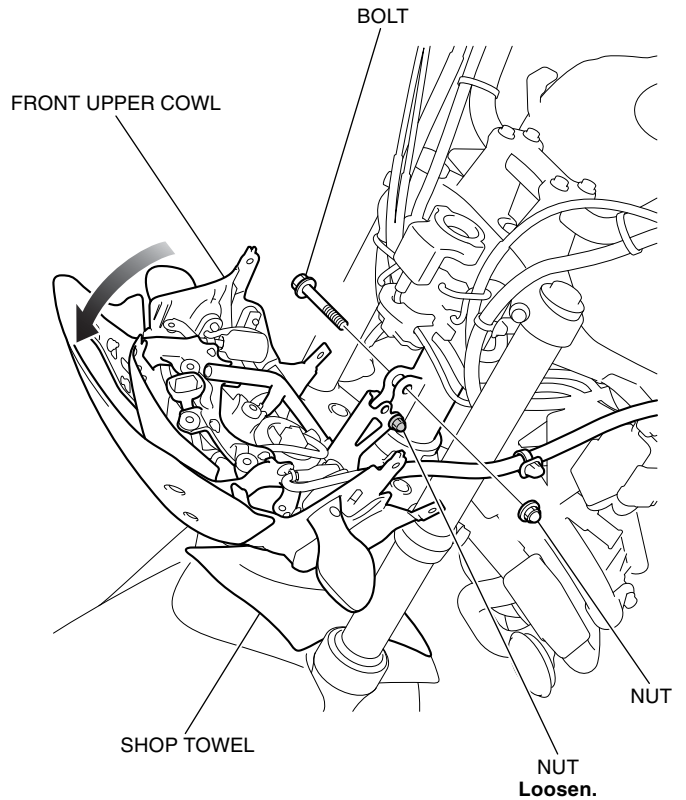

BOLT

FRONT UPPER COWL

SHOP TOWEL

NUT

NUT Loosen.

24. Pass the boot over the harness as shown.

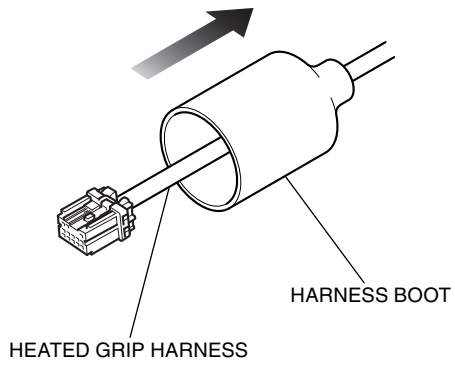

25. Connect the controller as shown.

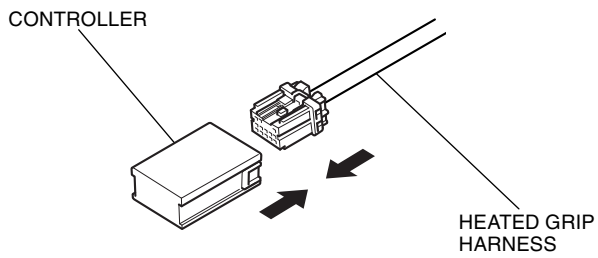

26. Fit the boot over the controller as shown.

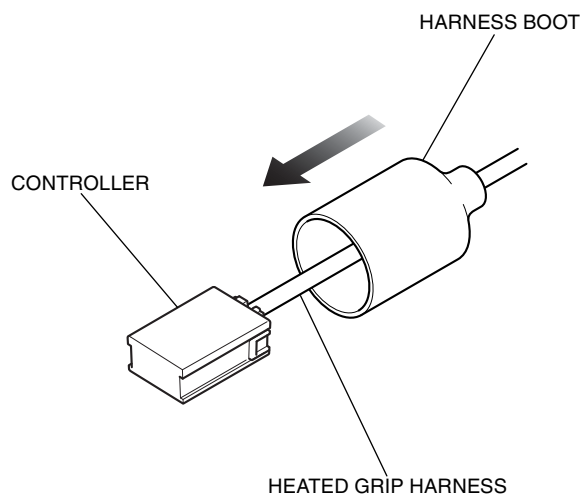

27. Fit the boot cover over the boot as shown.

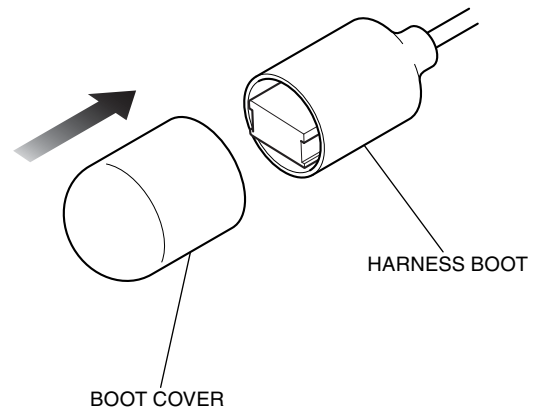

28. Secure the boot cover with electrical tape as shown.

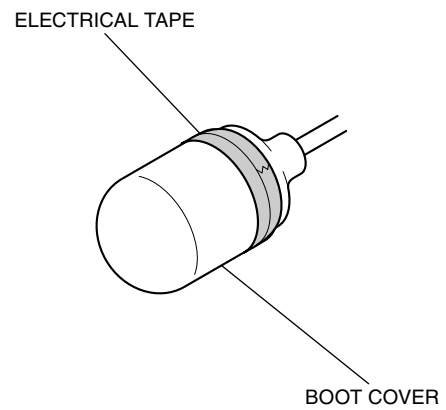

29. Cut a 2 x 2 mm drain hole at the shaded area of the tube as shown.

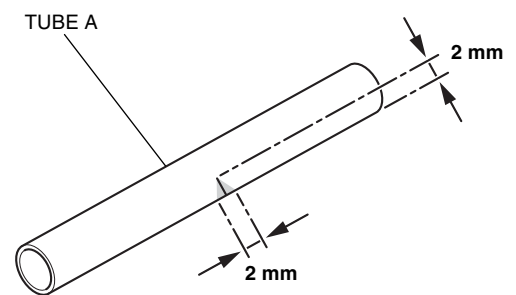



30. Pass the tube over the heated grip harness as shown.

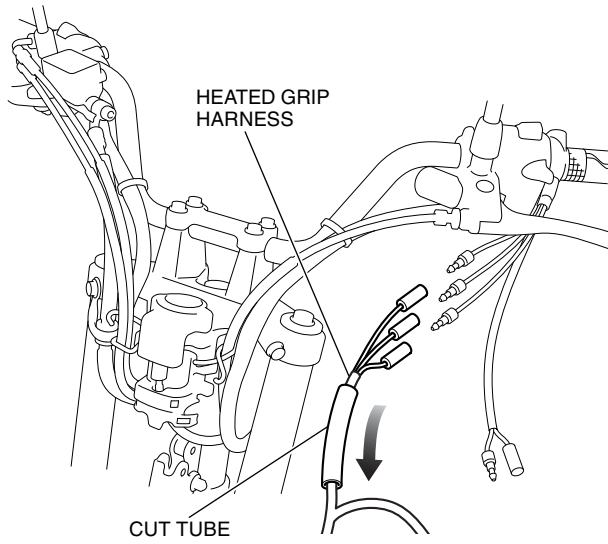

31. Connect the heated grip harness as shown.

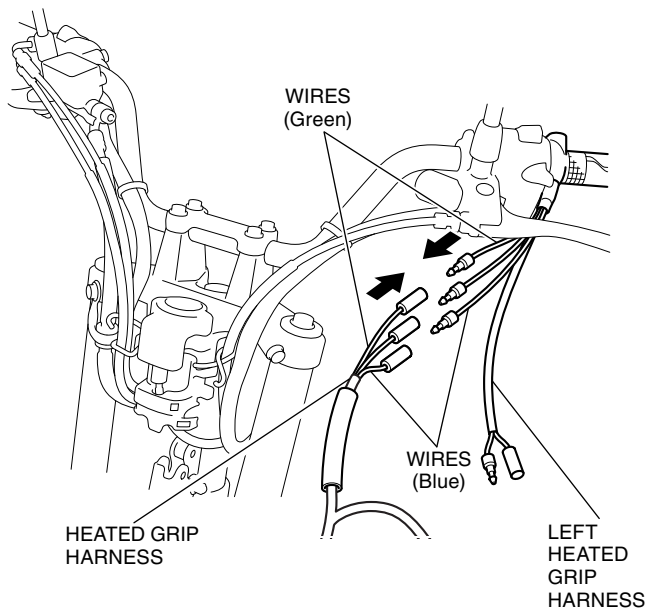

32. Slide the tube as shown.

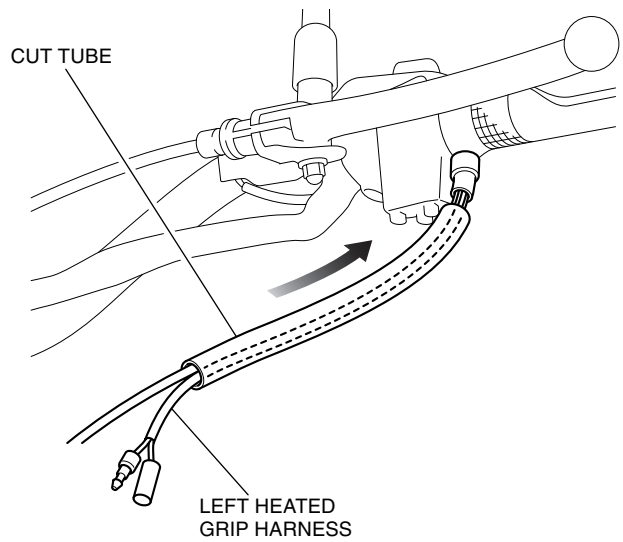

33. Secure the tube with electrical tape as shown.

- **Secure the tube with its cutout facing down as shown.**

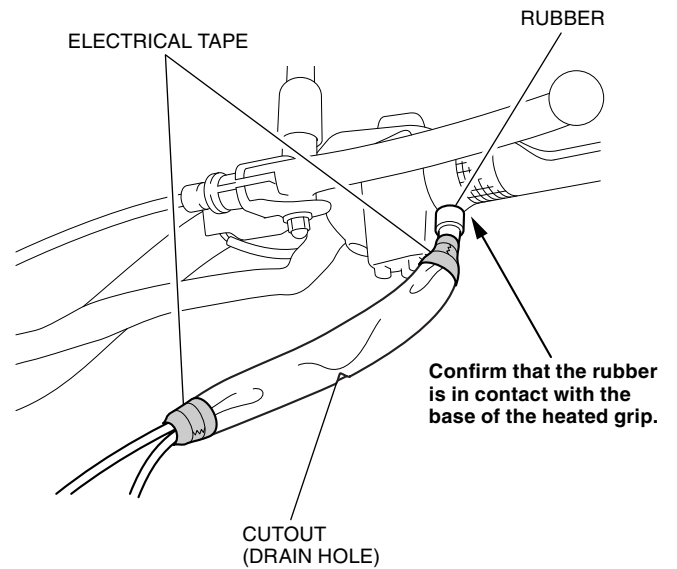

34. Secure the heated grip harness with the wire tie as shown.

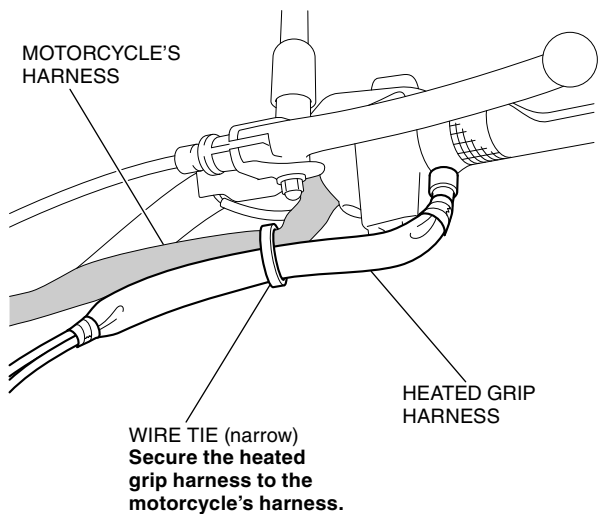

35. Route the heated grip harness as shown.

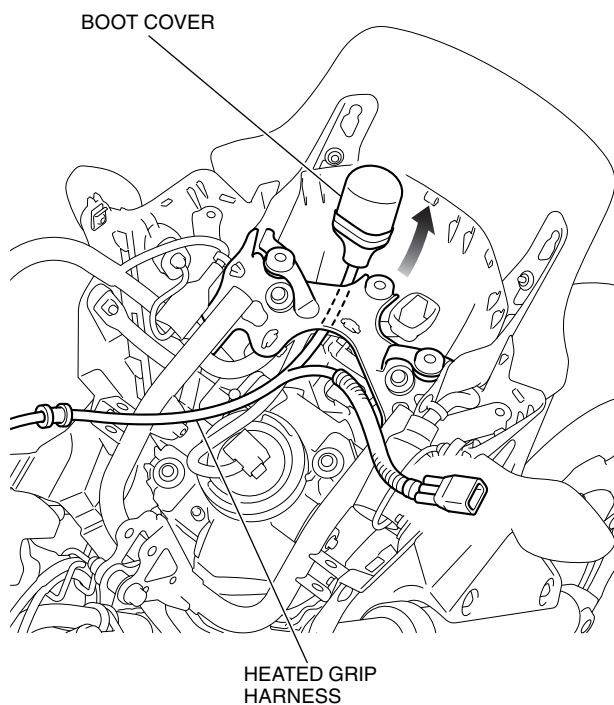

36. Secure the heated grip harness with wire tie as shown.

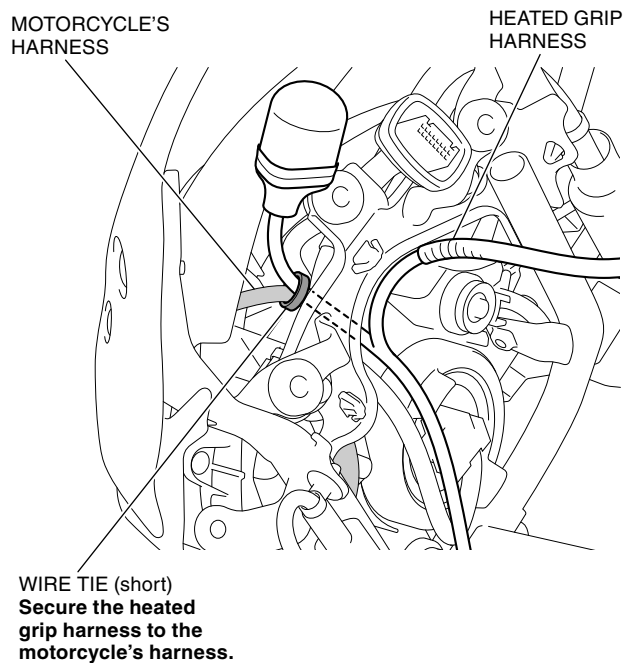

37. Place the boot cover as shown.



38. Route the heated grip harness as shown.

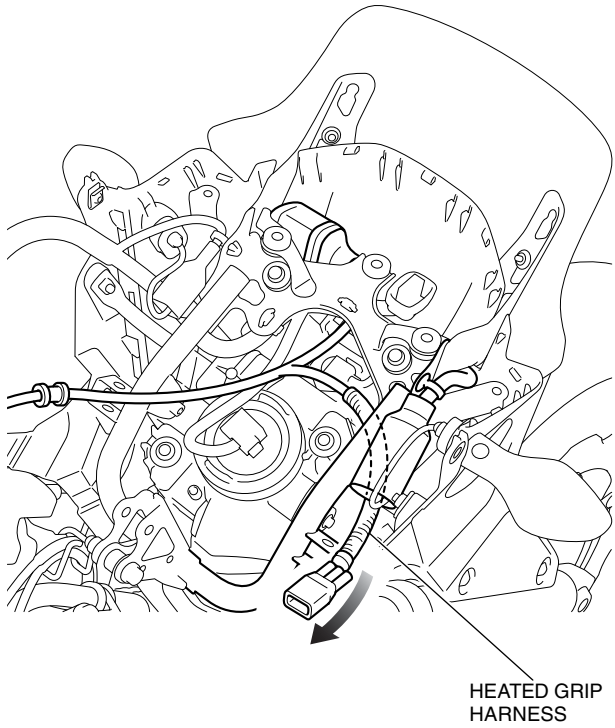

39. Remove the dummy connector as shown.

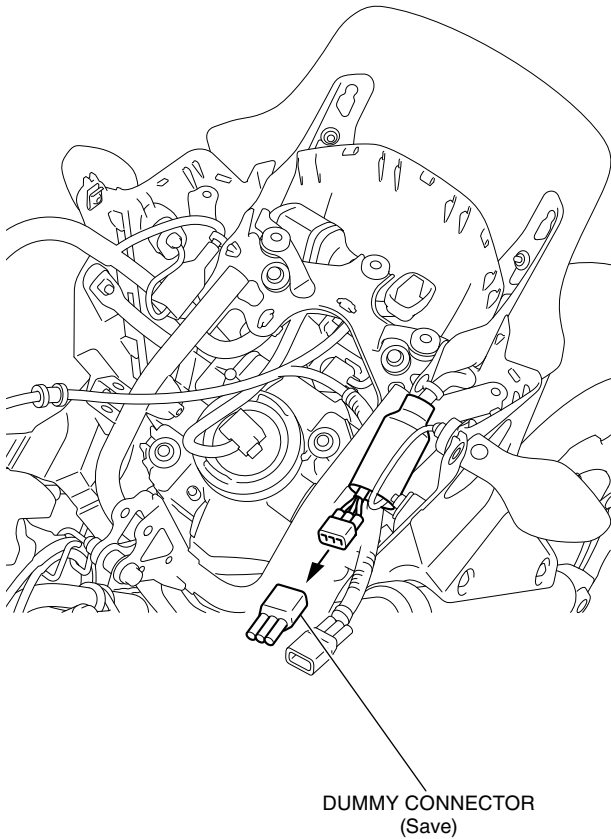

40. Connect the heated grip harness as shown.

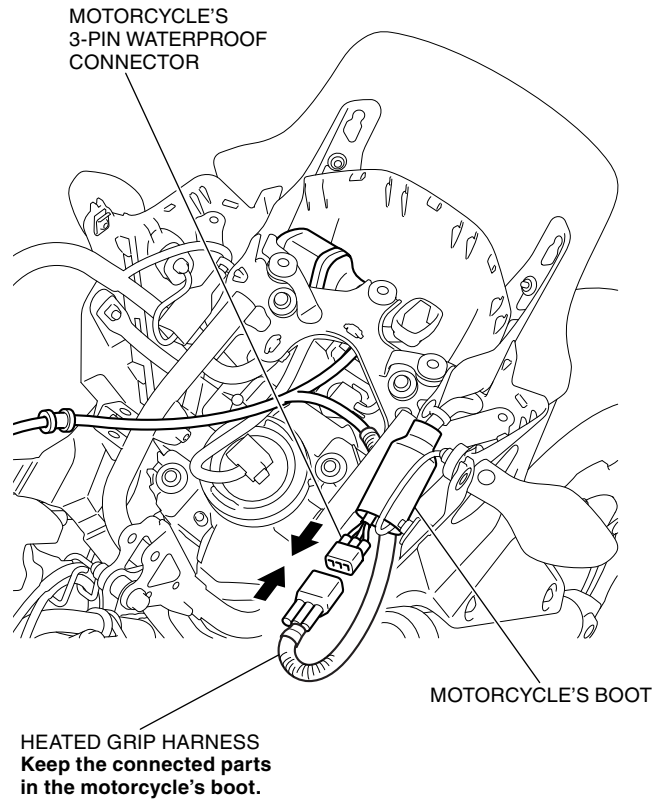

41. Secure the heated grip harness with the wire ties as shown.

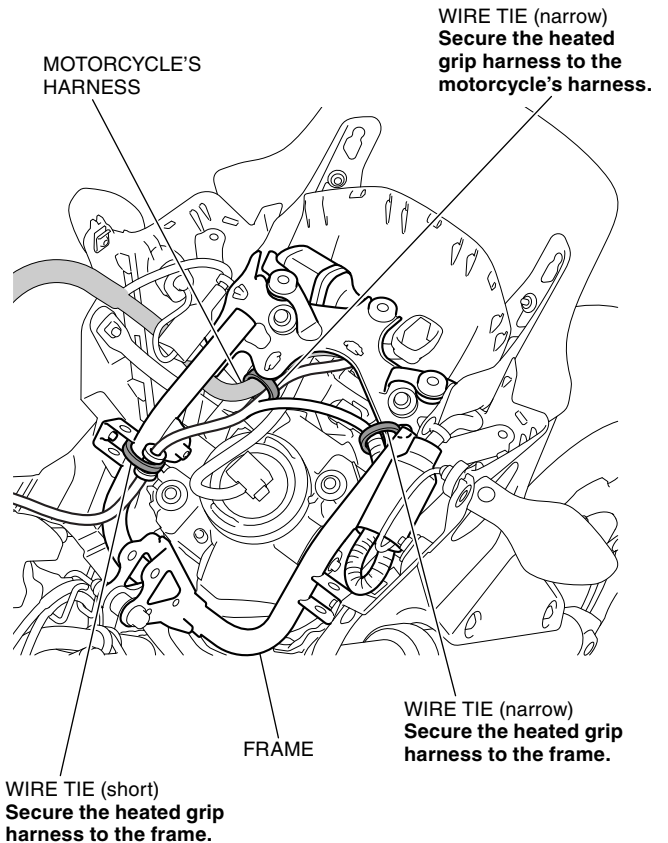

42. Pass the tube over each heated grip harness as shown.

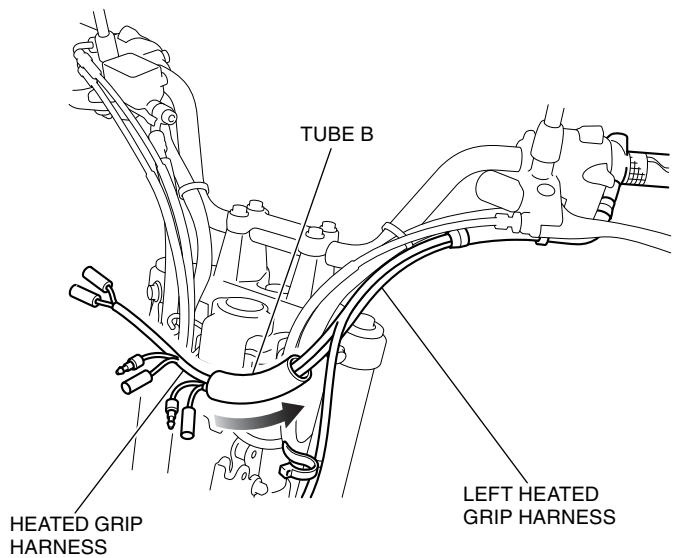

43. Connect the heated grip harness as shown.

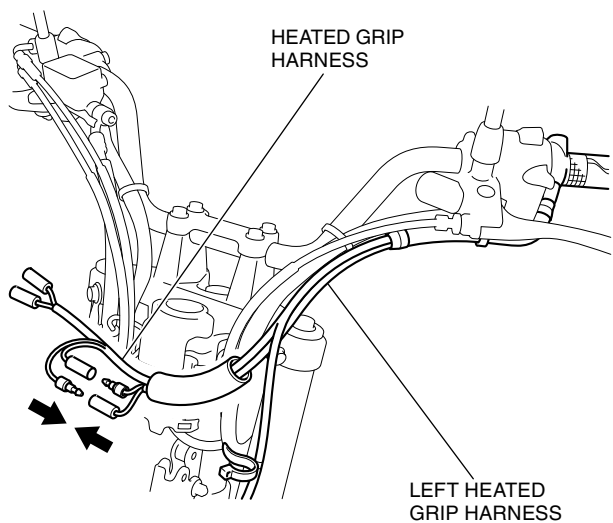

44. Slide the tube as shown.

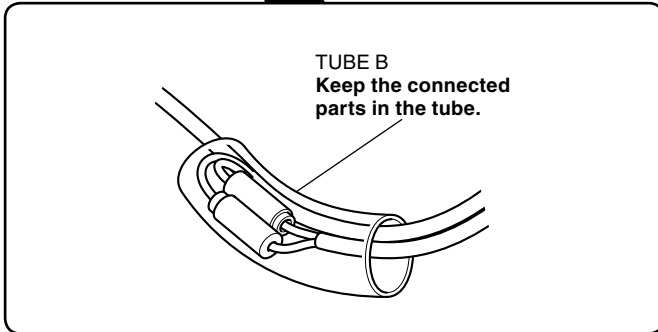
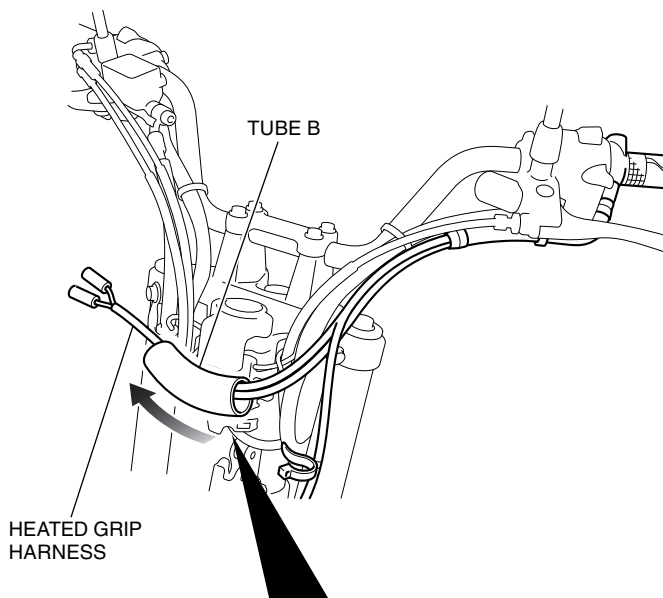

45. Route the heated grip harness as shown.

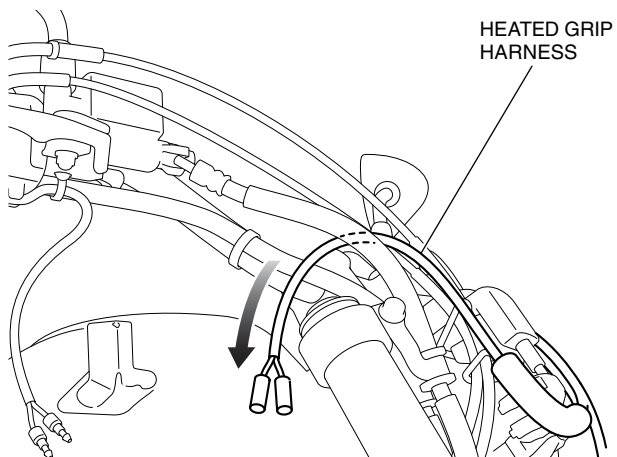

46. Bundle the right heated grip harness with electrical tape as shown.

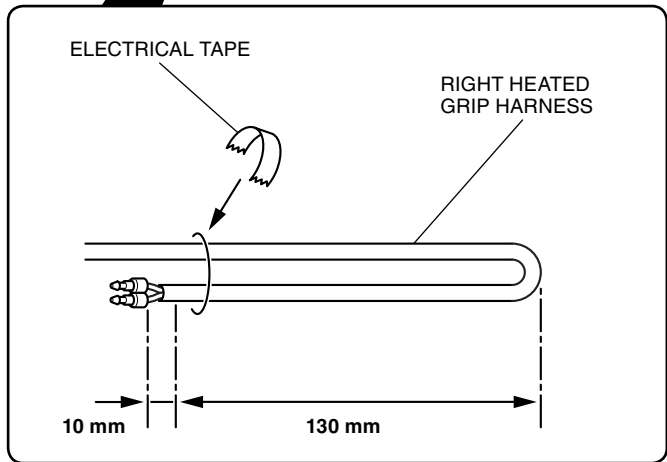
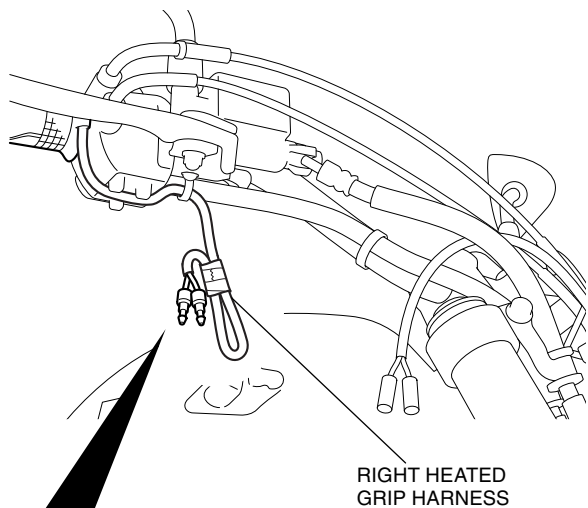

47. Pass the tube over the heated grip harness as shown.

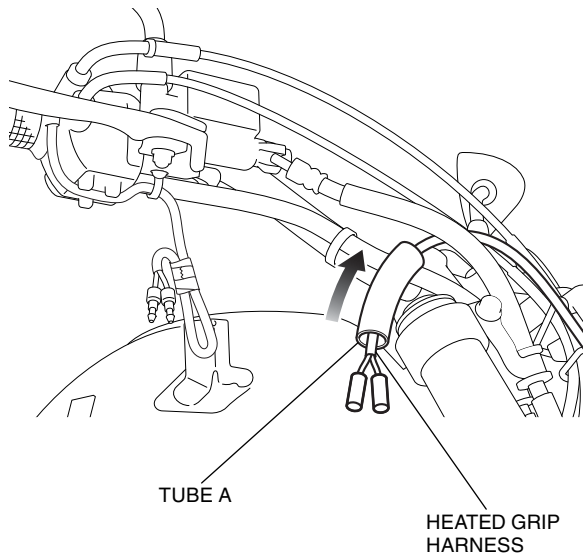

48. Connect the right heated grip harness as shown.

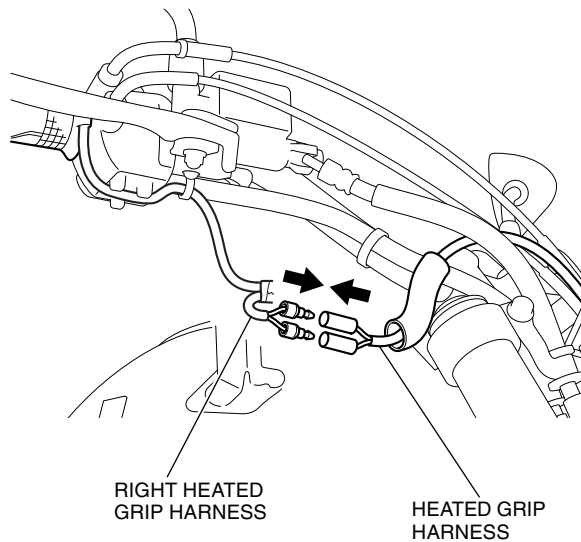

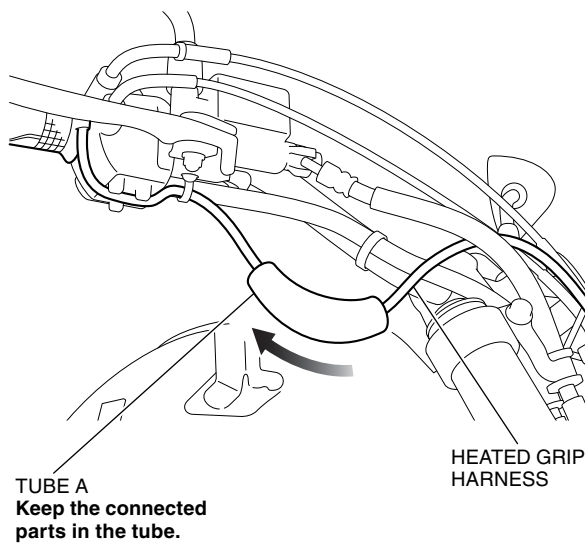

49. Slide the tube as shown.

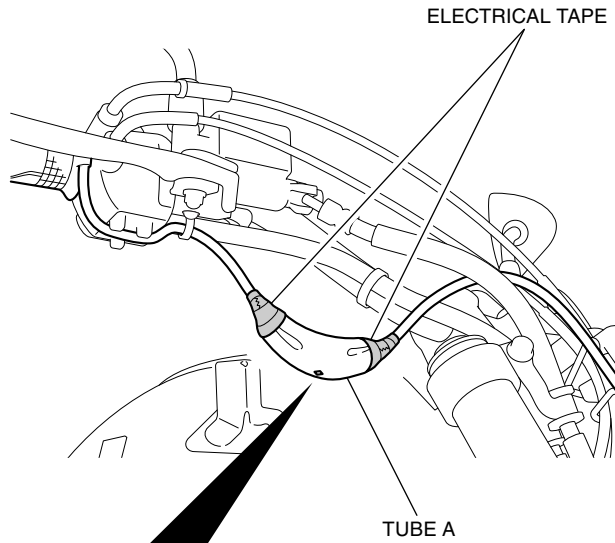

50. Secure the tube with electrical tape as shown.

- Be careful not to damage harnesses.



Cut a 2 x 2 mm drain hole at the shaded  area of the tube as shown.

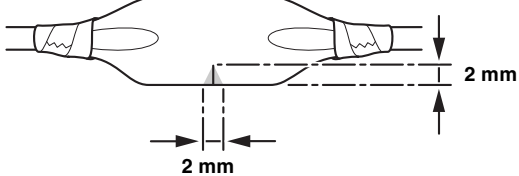

51. Secure the heated grip harness with the wire tie as shown.

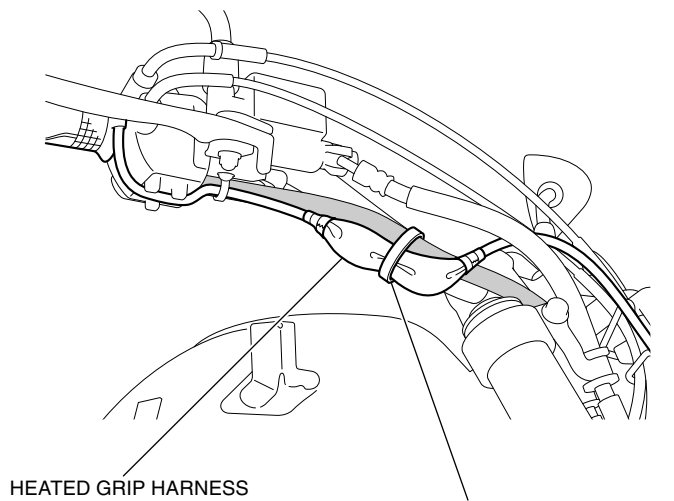

**MOTORCYCLE'S WIRE TIE (Reuse)**  
Secure the heated grip harness together with the motorcycle's harness.

52. Secure the tube with electrical tape as shown.

- Be careful not to damage the harnesses.

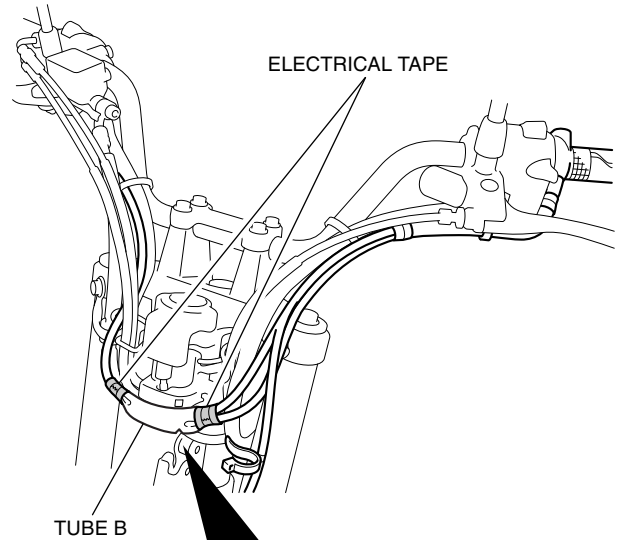

Cut a 2 x 2 mm drain hole at the shaded  area of the tube as shown.

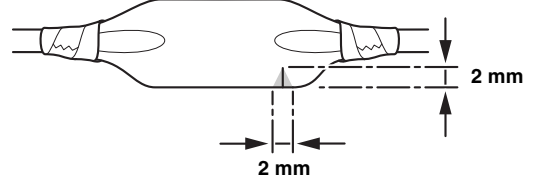

53. Secure the heated grip harness with the wire ties as shown.

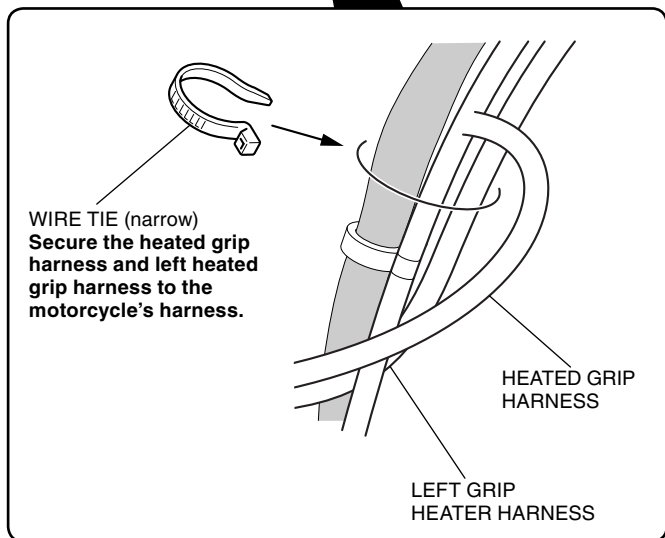
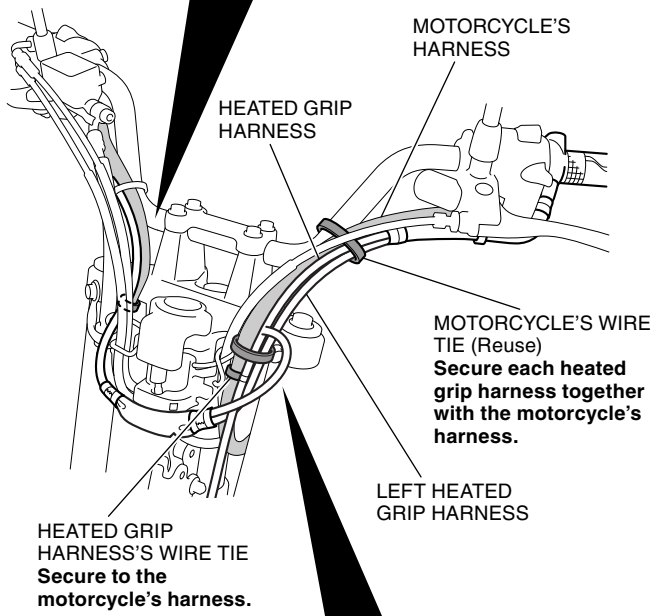
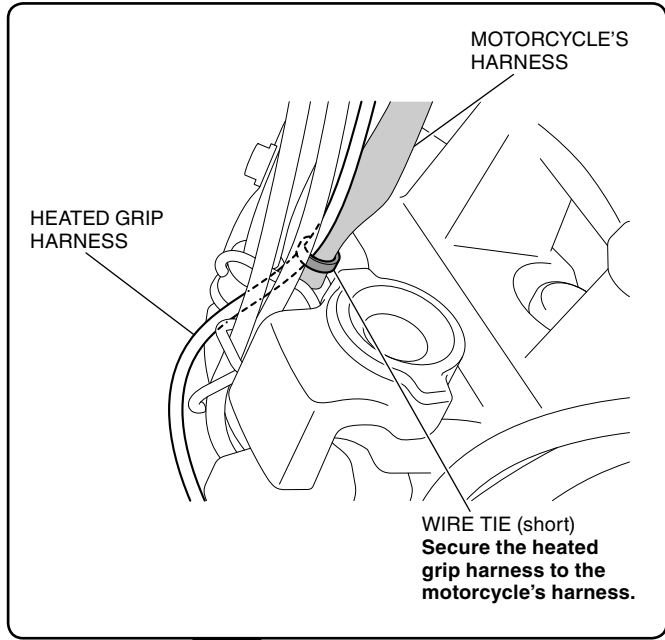

### < Models with HISS >

1. Secure each harness with the wire ties as shown.

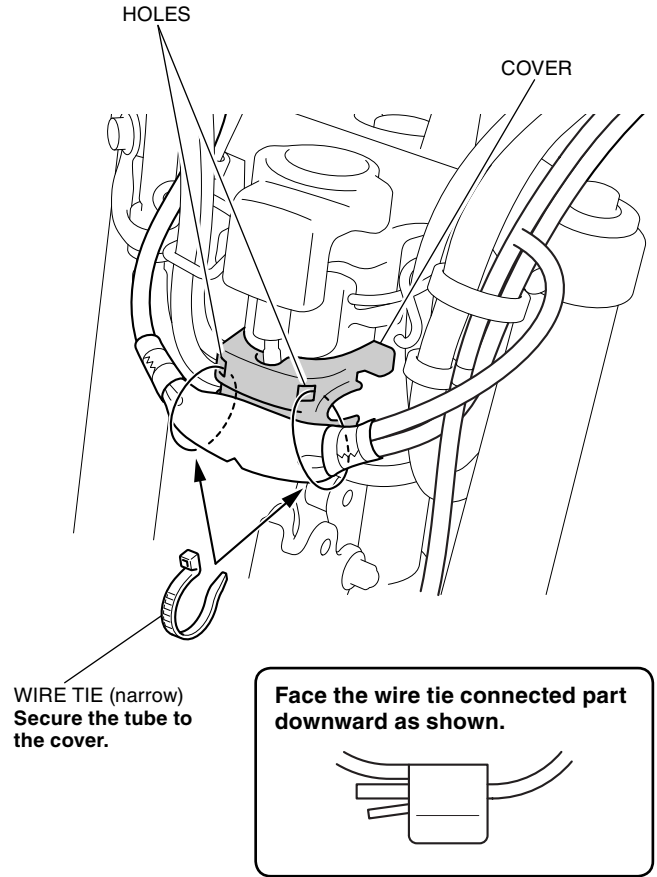

### < Models without HISS >

1. Loosely install the wire tie as shown.

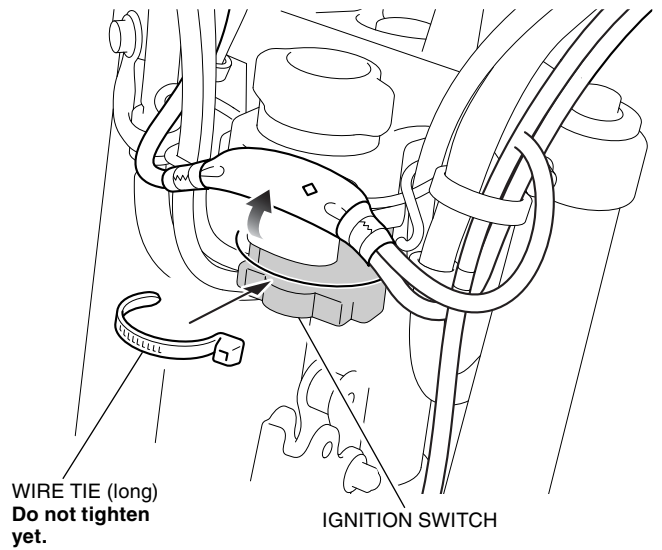

2. Secure each harness with the wire ties as shown.

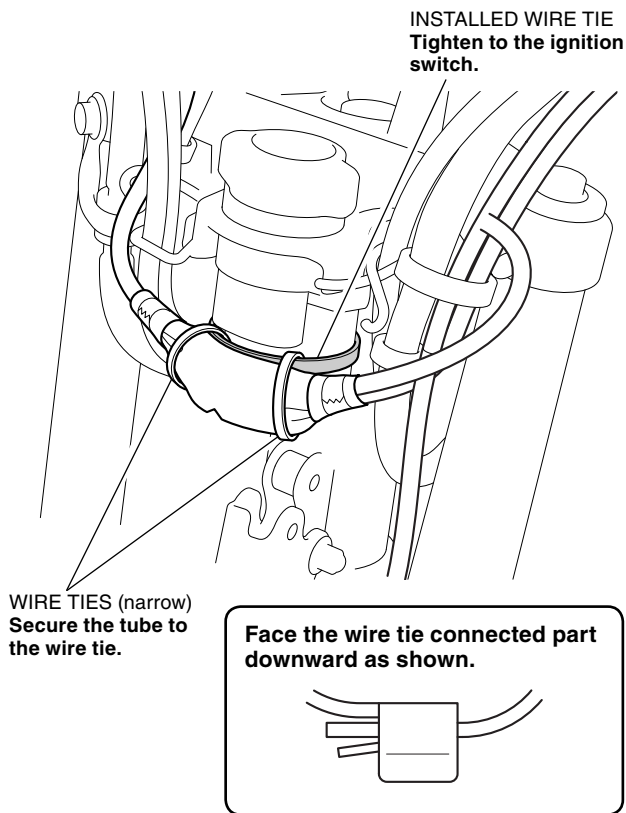

### < Common procedures >

54. Check each harness for sufficient freeplay.
  - Move the handlebar right and left and check that the harnesses are not pinched by the neighboring components and that they are not pulled taut.
55. Install the motorcycle's parts in the reverse order of removal.
  - Confirm that any harness is not caught or too tight.
56. Move the handlebar right and left and check that this accessory does not interfere with the motorcycle controls.

## DEALER TROUBLESHOOTING

- Stop the engine and turn the ignition switch OFF when you check the parts and circuits other than those of the heated grips.

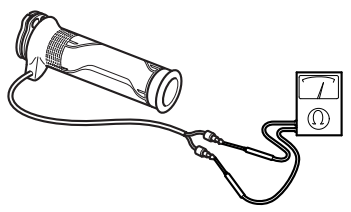
Symptom	Check
Heated grip does not operate; <ul style="list-style-type: none"> <li>• Faulty heated grip</li> <li>• Faulty heated grip coil</li> <li>• Open or short circuit in heater harness</li> <li>• Faulty heater switch</li> </ul>	<ol style="list-style-type: none"> <li>1. Check whether wires and cables (terminals and connectors) are connected securely.</li> <li>2. Heated grip inspection Check for resistance between the terminals.               <ul style="list-style-type: none"> <li>➔ Standard:                   <ul style="list-style-type: none"> <li>Right : 2.2 ohms +/- 10%</li> <li>Left : 2.2 ohms +/- 10%</li> </ul> </li> </ul> </li> </ol>  <ol style="list-style-type: none"> <li>3. Heater harness inspection: Check for continuity.</li> <li>4. If no abnormality is found after the above checks 1, 2, and 3, but the heated grip still does not operate properly, replace the heater switch with a new one.               <ul style="list-style-type: none"> <li>• It is hard to check the switch with ordinary inspection methods (for continuity, voltage, etc.) because it contains an integrated circuit.</li> </ul> </li> </ol>