



INSTALLATION INSTRUCTIONS

Accessory

TALL WINDSCREEN
P/N 08R70-MKW-D00

Application

NC750XA/XD

Publication No.

MII 17714

Issue Date

April 2021

Honda Dealer: Please give a copy of these instructions to your customer.

PARTS LIST

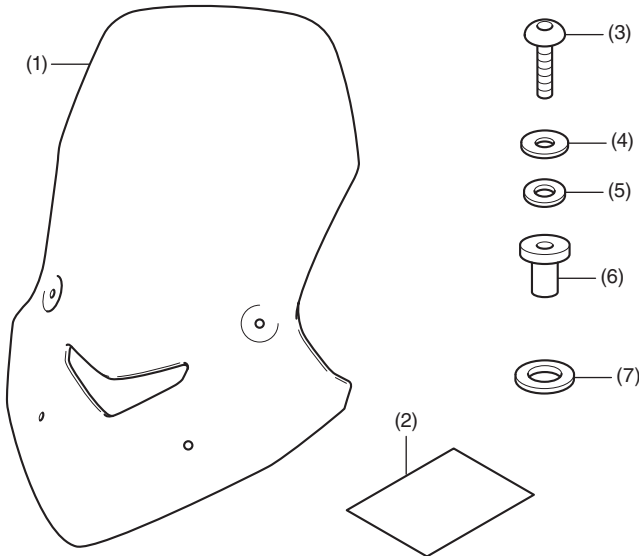

No.	Description	Qty
(1)	Tall windscreen	1
(2)	Installation instructions	1
(3)	5 mm screw	4
(4)	Washer (small)	6
(5)	Rubber washer	6
(6)	Well nut	4
(7)	Washer (large)	4

TOOLS REQUIRED

Hex wrench (5 mm)

Torque wrench

TORQUE CHART

Tighten all screws, bolts, and nuts to their specified torque values. Refer to the Service Manual for the torque values of the removed parts.

Item	N·m	kgf·m	lbf·ft
5 mm screw	0.8	0.08	0.6

INSTALLATION

1. Remove the windscreen as shown.

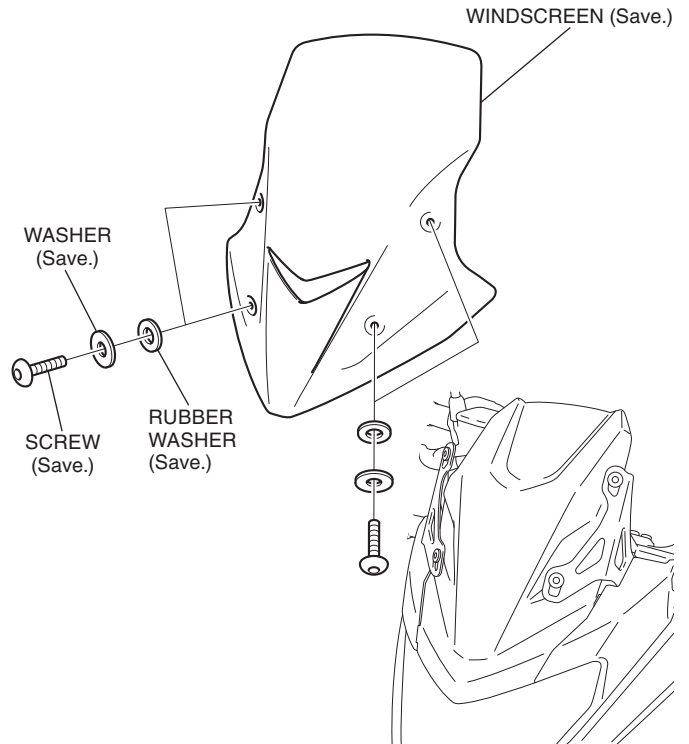

2. Remove the well nuts and washers as shown.

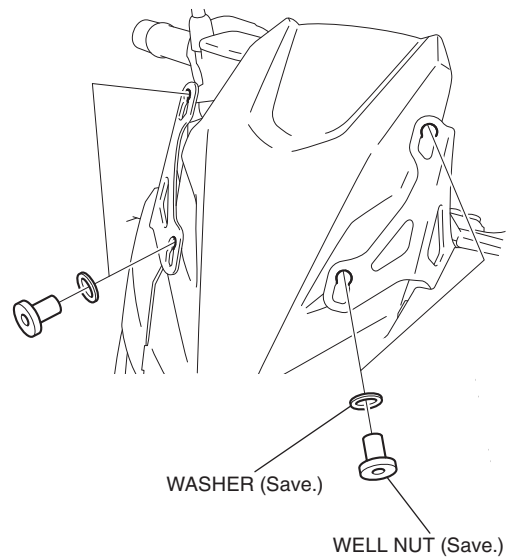

3. Install the well nuts and washers as shown.

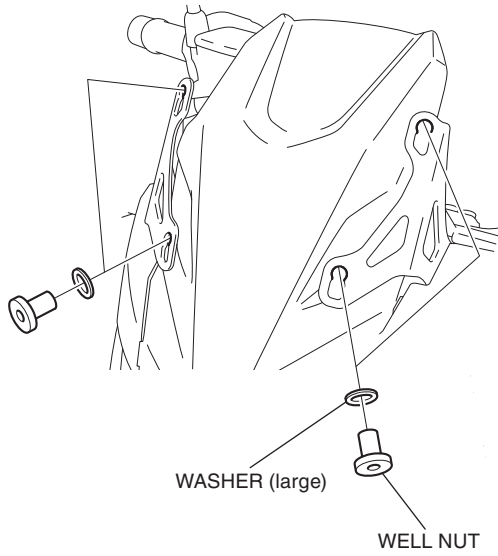

4. Loosely install the tall windscreen as shown.

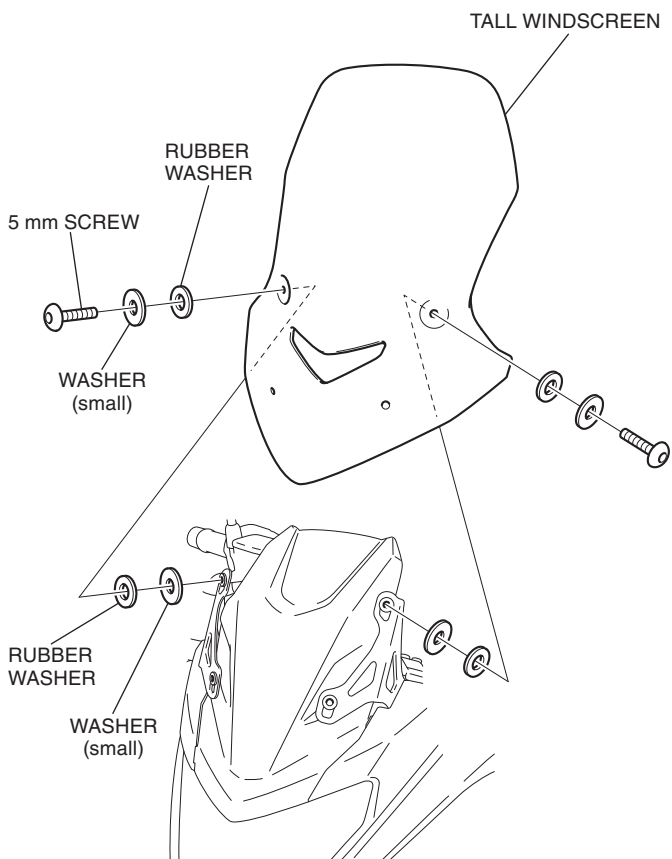

5. Loosely install the 5 mm screws as shown.

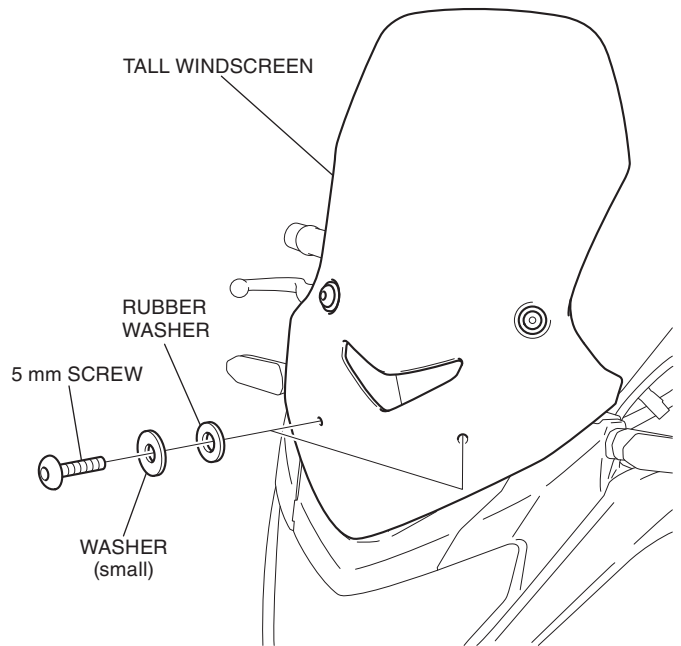

6. Tighten all loosely installed parts securely.