



# HONDA

## INSTALLATION INSTRUCTIONS

Accessory	Application	Publication No.
SKID PLATE P/N 08P74-HR3-A20	After '13 TRX420 (all) After '13 TRX500 (all)	MII 14766
		Issue Date
		October 2013

### PARTS LIST

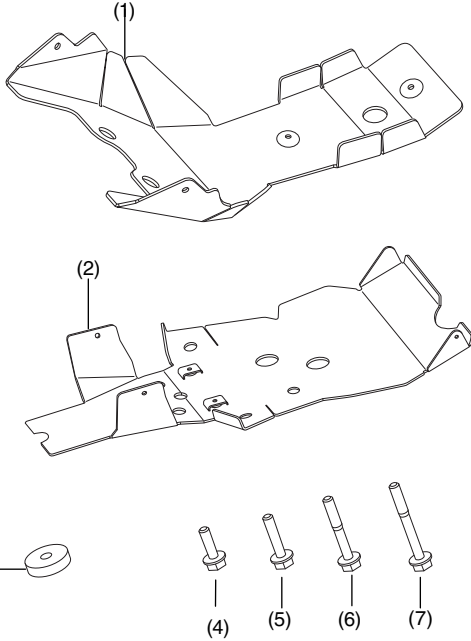

No.	Description	Qty
(1)	Front bash plate	1
(2)	Main frame skid plate	1
(3)	Spacer	6
(4)	Flange bolt, 6 x 12 mm	2
(5)	Flange bolt, 6 x 16 mm	2
(6)	Flange bolt, 6 x 28 mm	1
(7)	Flange bolt, 6 x 40 mm	1

### TOOLS REQUIRED

Torque wrench  
10 mm socket

### TORQUE CHART

Tighten all screws, bolts, and nuts to their specified torque values. Refer to the Service Manual for the torque values of the removed parts.

Item	N-m	kgf-m	lbf-ft
6 mm bolt	12	1.2	9

### USE AND CARE INFORMATION

- Check the accessory mounts frequently and retighten if necessary.
- Replace this accessory with a new one if it is damaged or discolored excessively.

## INSTALLATION

1. Using the procedure in the Service Manual, remove the engine guard.
2. Install the main frame skid plate in the location shown with two 6 x 12 mm bolts. Tighten the hardware to the specification in the Torque Chart.

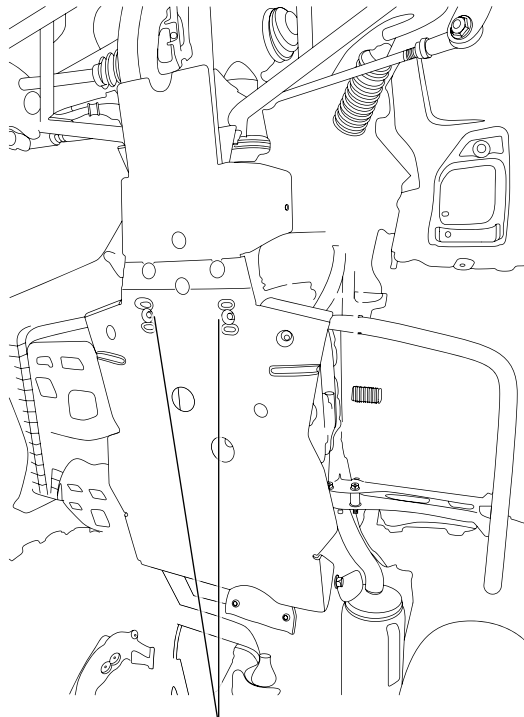

6 x 12 mm BOLTS

3. Install the 6 x 16 mm bolts on both sides of the main frame skid plate. Tighten the hardware to the specification in the Torque Chart.

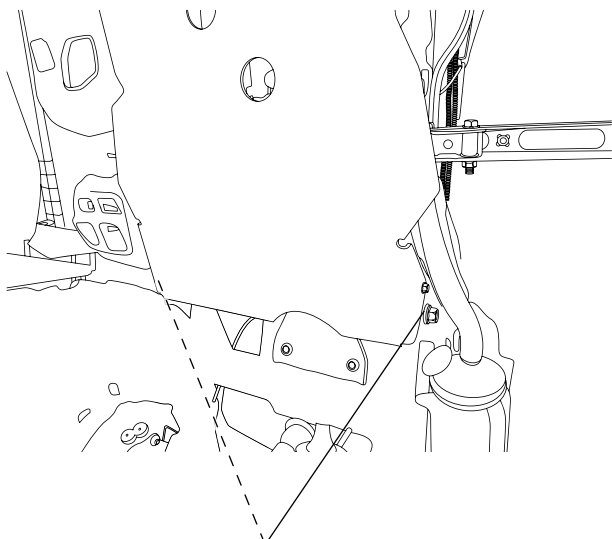

6 x 16 mm BOLTS

4. Pre-assemble the front skid plate as shown using six spacers (four at the rear, two at the front) and two bolts (6 x 40 mm at the rear, 6 x 28 mm at the front).

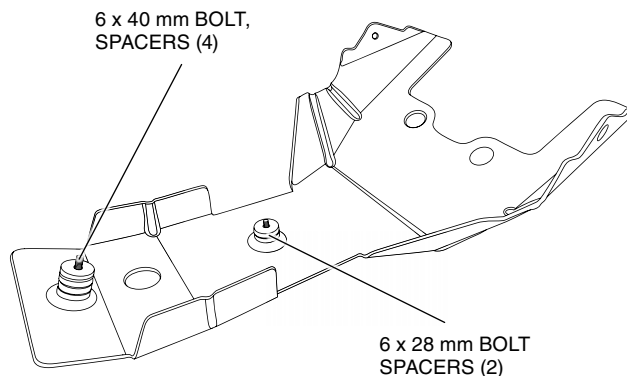

6 x 40 mm BOLT,  
SPACERS (4)

6 x 28 mm BOLT  
SPACERS (2)

5. Install the front skid plate as shown using the two new bolts and the original hardware in the upper bolt holes. Tighten the hardware to the specification in the Torque Chart.

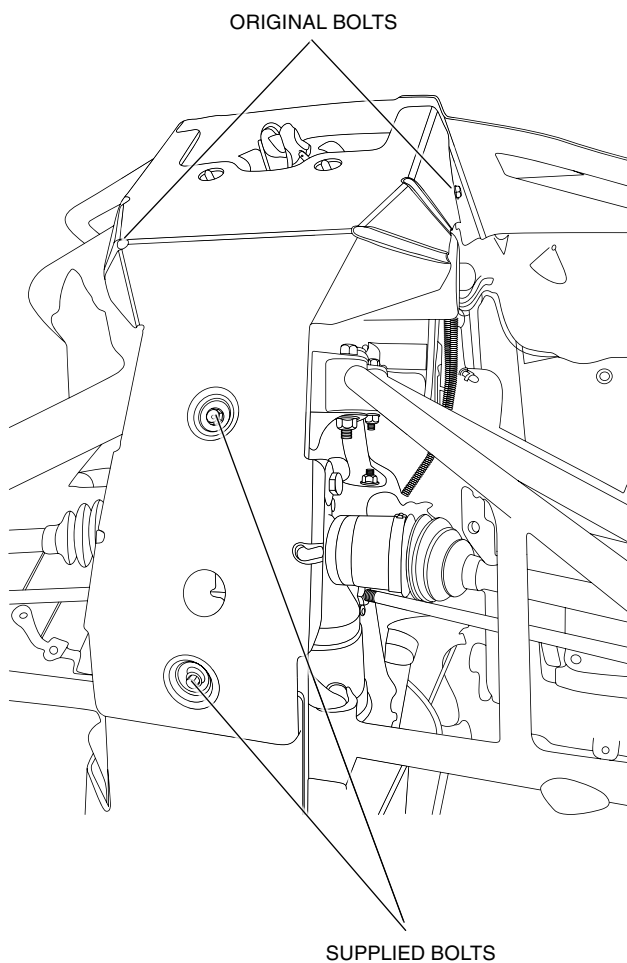

ORIGINAL BOLTS

SUPPLIED BOLTS