

HONDA

INSTALLATION INSTRUCTIONS

Accessory

REAR BUMPER (5P)
P/N 08P73-HL4-A00

Application

SXS1000M5D/M5P

Publication No.

MII 15262

Issue Date

August 2015

Honda Dealer: Please give a copy of these instructions to your customer.

PARTS LIST

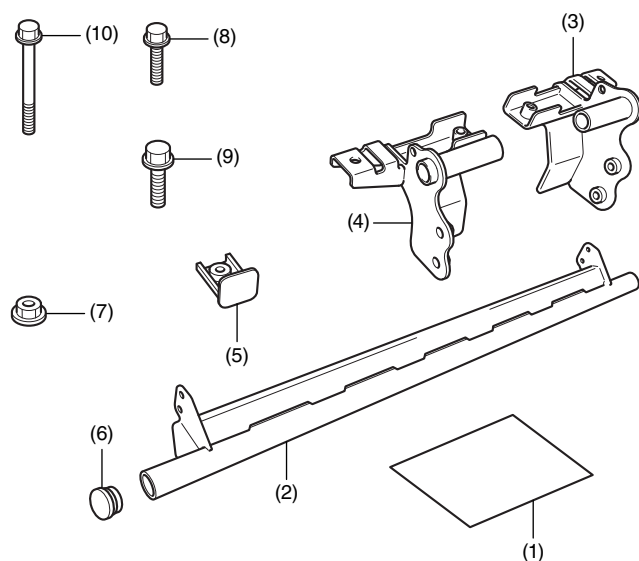

No.	Description	Qty
(1)	Installation Instructions URL	1
(2)	Rear bumper	1
(3)	Right hinge bracket	1
(4)	Left hinge bracket	1
(5)	Plate nut	2
(6)	Pipe end cap	2
(7)	6 mm flange nut	2
(8)	6 mm flange bolt (short)	4
(9)	8 mm flange bolt	4
(10)	6 mm flange bolt (long)	2

TOOLS AND SUPPLIES REQUIRED

Socket (10 and 12 mm)

Ratchet

Box-end wrench (10 mm)

Hondalock 2 or equivalent thread lock

Isopropyl alcohol

Shop towel

Torque wrench

TORQUE CHART

Tighten all screws, bolts, and nuts to their specified torque values. Refer to the Service Manual for the torque values of the removed parts.

Item	N·m	kgf·m	lbf·ft
6 mm flange bolt and nut	12	1.2	9
8 mm flange bolt	27	2.8	20

INSTALLATION

▲ CAUTION

- To prevent burns, allow the engine, exhaust system, radiator, etc., to cool before installing the accessory.

1. Fold down the rear gate as shown.

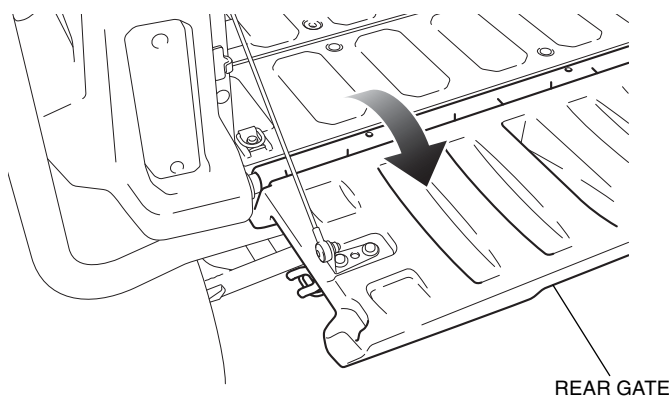

2. Remove the tie down hook as shown.

<Left side>

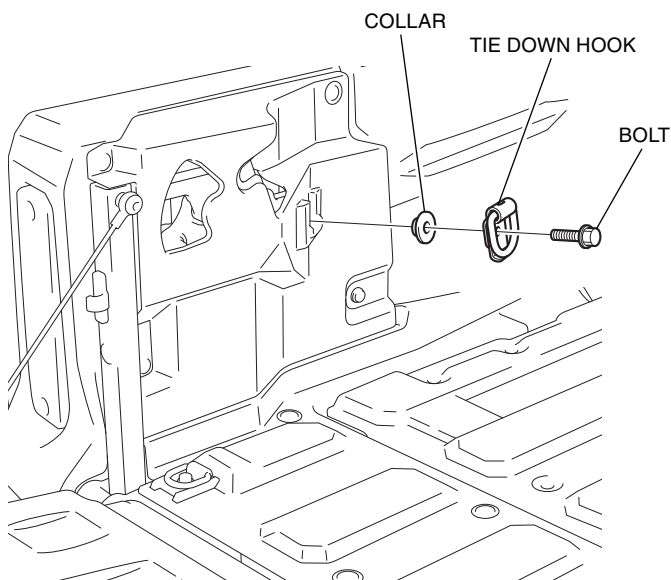

3. Remove the left seat latch cover as shown.

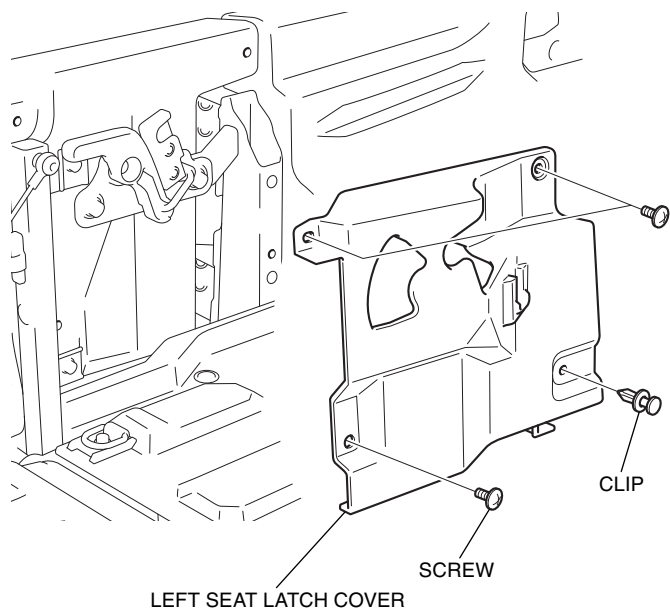

4. Remove the bolts as shown.

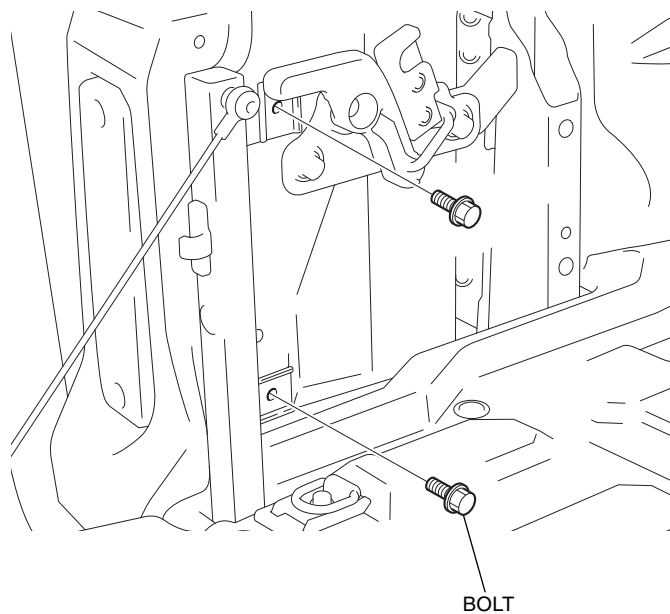

5. Remove the tie down hook as shown.

<Left side>

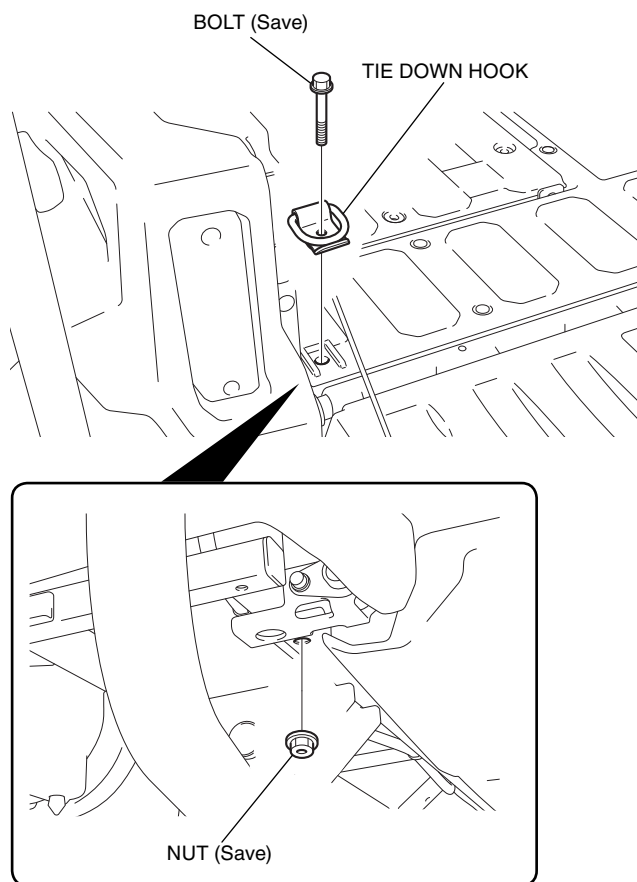

6. Remove the cap as shown.

<Left side>

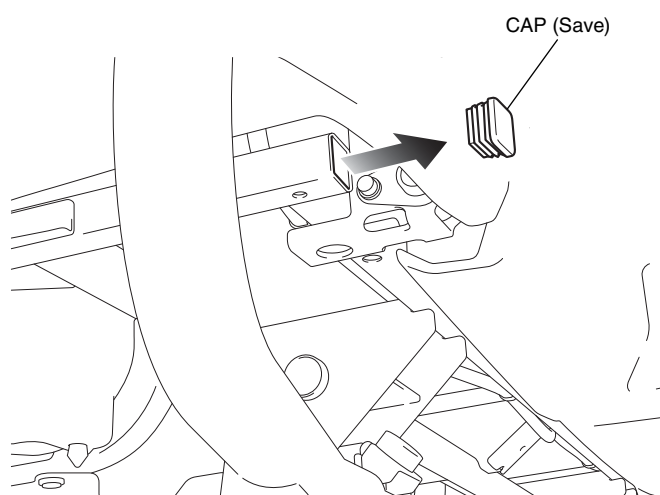

7. Remove the hinge bracket as shown.

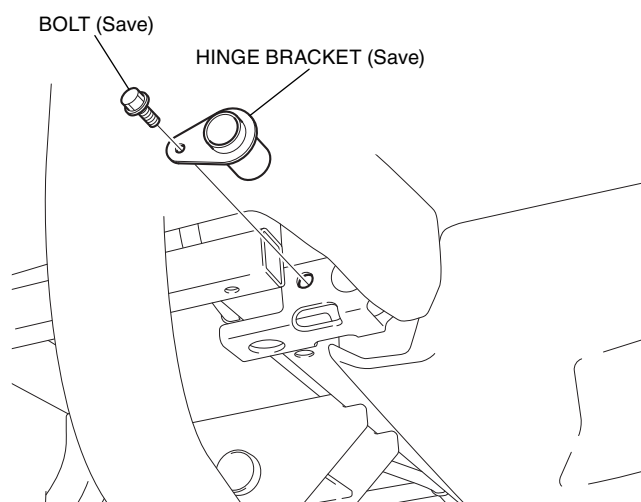

8. Loosely install the left hinge bracket as shown.

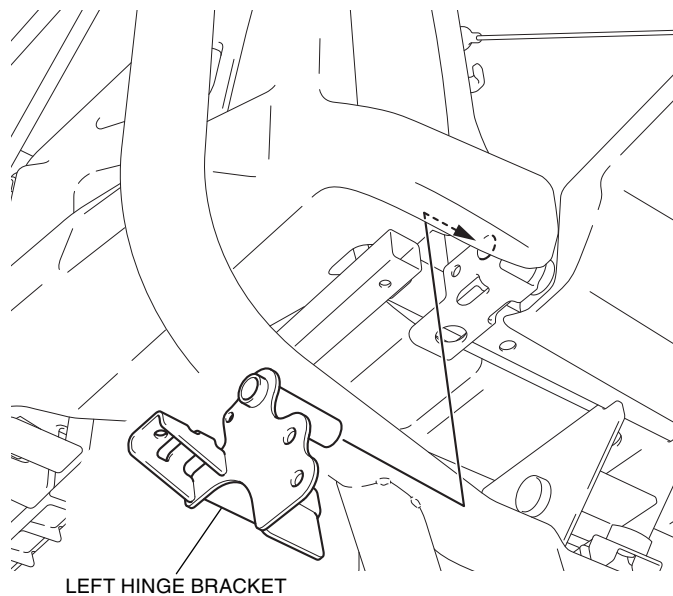

9. Loosely install the tie down hook as shown.

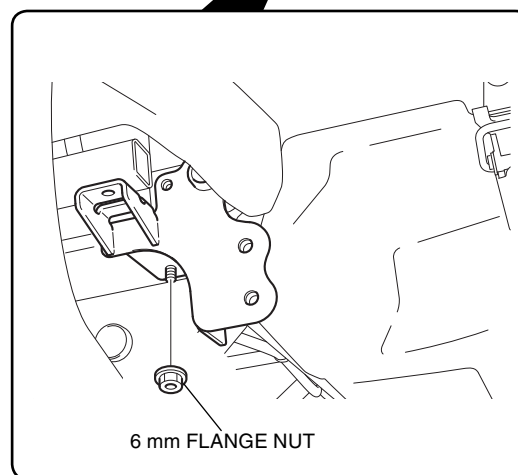
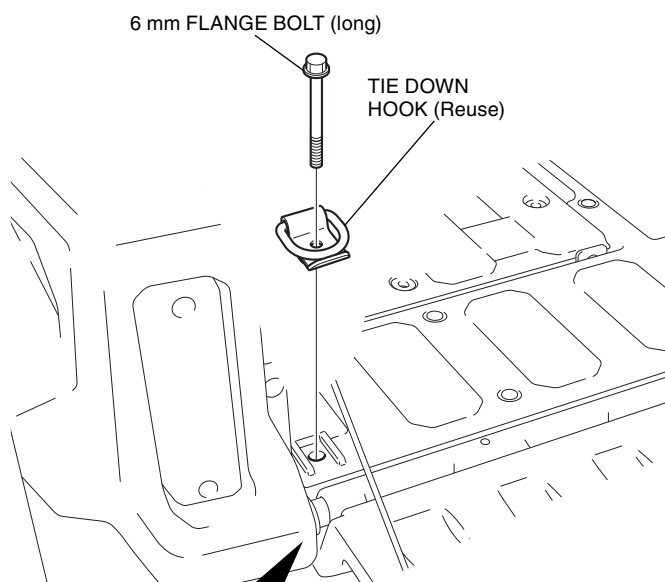

10. Loosely install the plate nut as shown.

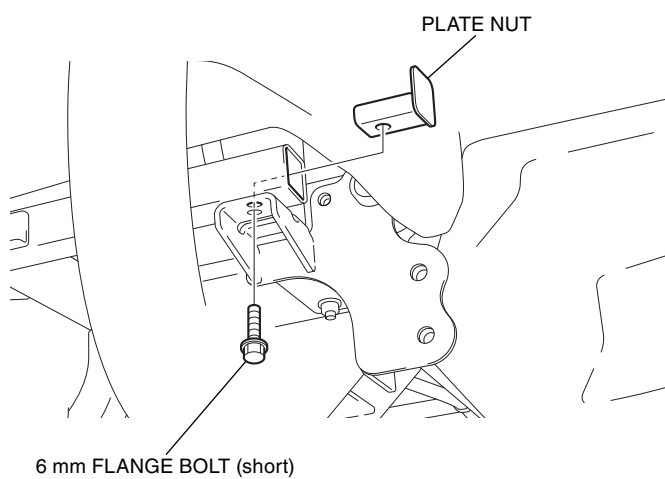

11. Loosely install the 6 mm flange bolt as shown.
- **Clean the bolt with isopropyl alcohol before applying thread lock.**
 - **Be sure to apply to the threads of the bolt.**

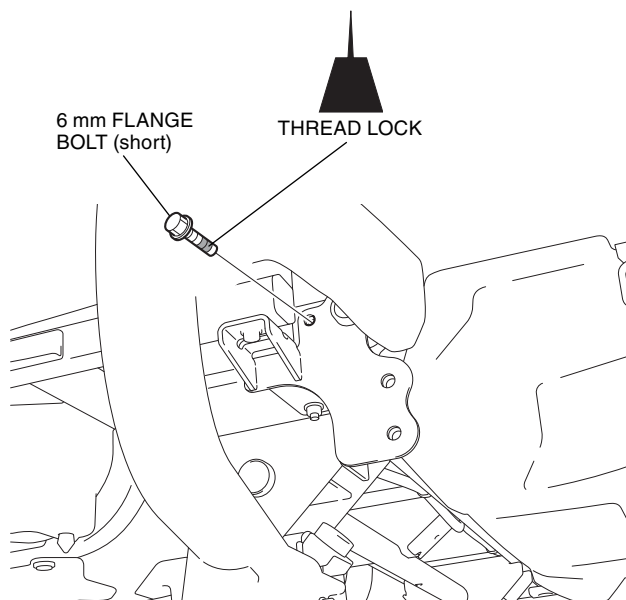

12. Repeat Steps 2 through 11 on the right side.
13. Attach the pipe end cap to the rear bumper as shown.
- **Repeat on the right side.**

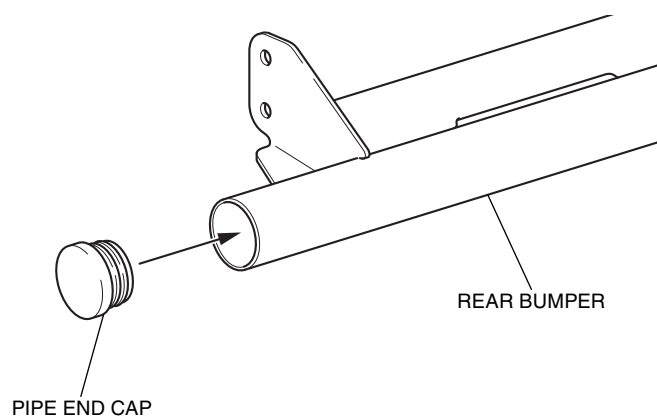

14. Loosely install the rear bumper as shown.
- **Repeat on the right side.**

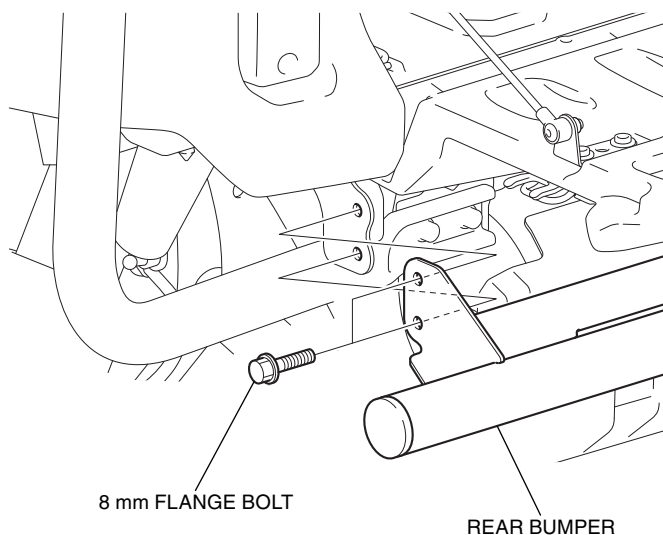

15. Tighten the loosely installed parts to the values specified in the Torque Chart.
16. Install the removed vehicle parts in the reverse order of removal.