

INSTALLATION INSTRUCTIONS

Accessory
ALUMINUM A-ARM GUARDS (FRONT)
 P/N 08P72-HL4-F00

Application
SXS1000M3/M3P/M5D/M5P

Publication No.
MII 16083
 Issue Date
January 2017

Honda Dealer: Please give a copy of these instructions to your customer.

PARTS LIST

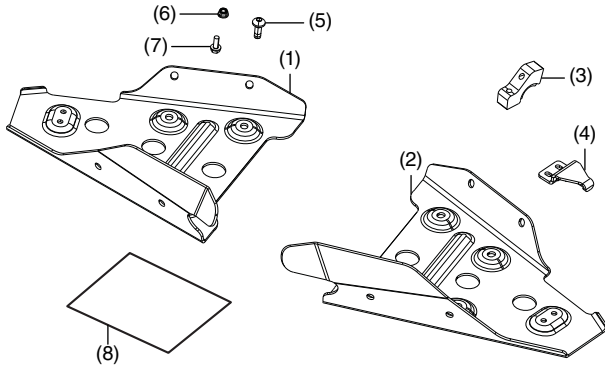

No.	Description	Qty
(1)	Right front guard	1
(2)	Left front guard	1
(3)	Front guard bracket	8
(4)	Front guard holder	2
(5)	8 mm socket bolt	16
(6)	6 mm flange nut	4
(7)	6 mm flange bolt	4
(8)	Installation Instructions URL	1

TOOLS REQUIRED

- Socket (10 mm)
- Ratchet
- Box-end wrench (10 mm)
- Hex wrench (6 mm)
- Torque wrench

TORQUE CHART

Tighten all screws, bolts, and nuts to their specified torque values. Refer to the Service Manual for the torque values of the removed parts.

Item	N·m	kgf·m	lbf·ft
6 mm flange nut	12	1.2	9
8 mm socket bolt	26	2.6	19

INSTALLATION

▲ CAUTION

- To prevent burns, allow the engine, exhaust system, radiator, etc., to cool before installing the accessory.

1. Loosely install the left front guard holder and left front guard as shown.

<Left side>

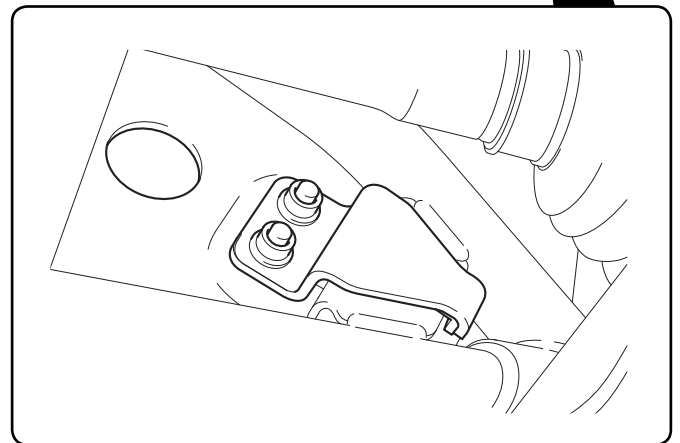
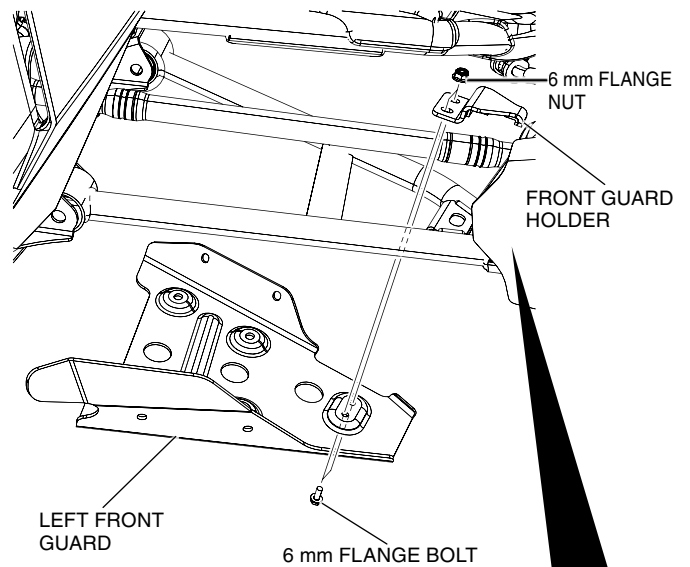

- Loosely install the four front guard brackets and four 8 mm socket bolts as shown.

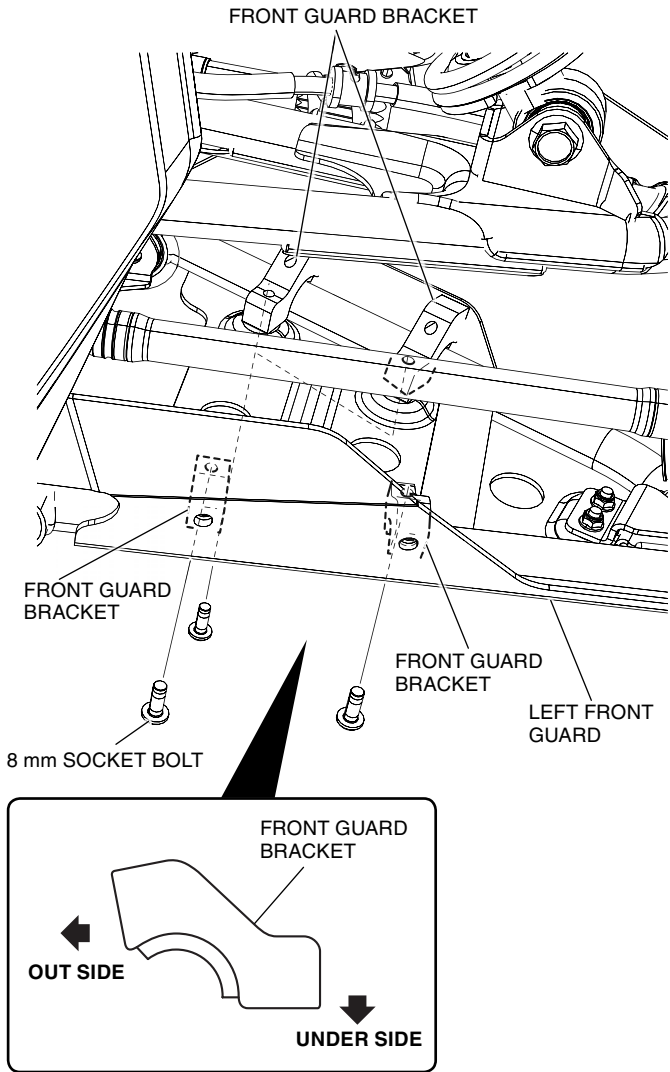

- Loosely install the four 8 mm socket bolts as shown.

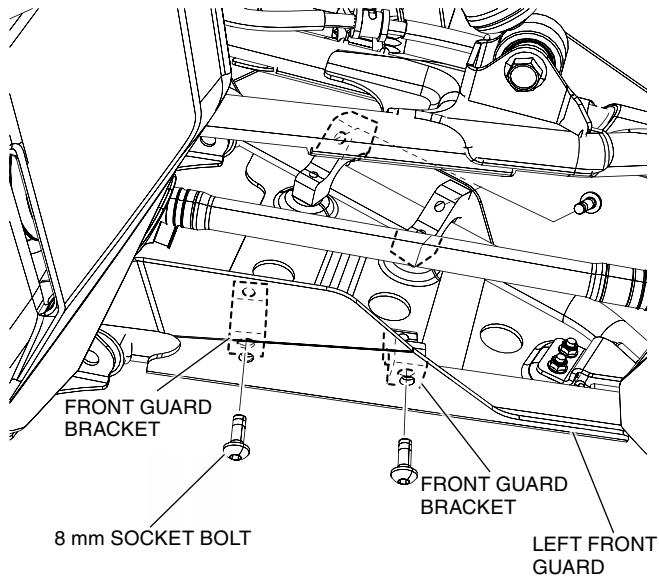

- Tighten the loosely installed 6 mm flange bolts and 6 mm flange nuts securely.
- Tighten the assembled 8 mm socket bolts while moving the left front guard inboard as shown.
 - Make sure to move the guard in the direction shown until it stops and then tighten the bolts.

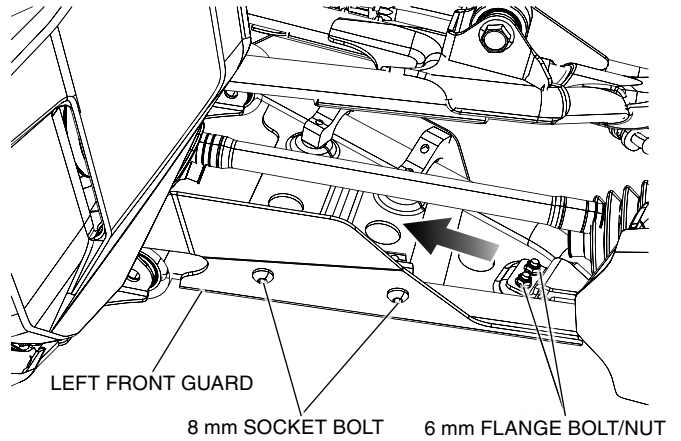

- Repeat Steps 1 through 5 on the right side.