

# HONDA

## INSTALLATION INSTRUCTIONS

Accessory  
**REAR SWINGARM GUARD**  
 P/N 08P71-HR3-620

Application  
 TRX420FA1/FA2/FE1/FM1/FM2/  
 TE1/TM1  
 TRX500FE1/FE2/FM1/FM2

Publication No.  
**MII 15067**  
 Issue Date  
**September 2014**

### PARTS LIST

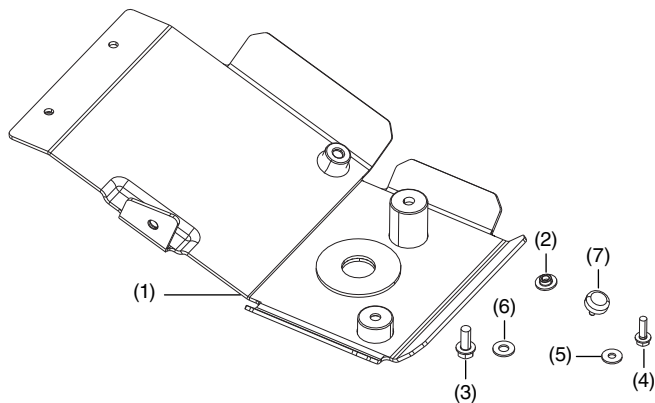

No.	Description	Qty
(1)	Swingarm guard	1
(2)	Steel collar	2
(3)	8 mm flange bolt	3
(4)	6 mm flange bolt	2
(5)	6 mm washer	2
(6)	8 mm washer	2
(7)	Rubber stopper	1

### TOOLS AND SUPPLIES REQUIRED

Torque wrench  
 10 mm socket  
 12 mm socket  
 Ratchet  
 Soapy water

### TORQUE CHART

Tighten all screws, bolts, and nuts to their specified torque values. Refer to the Service Manual for the torque values of the removed parts.

Item	N-m	kgf-m	lbf-ft
6 mm flange bolt	12	1.2	9
8 mm flange bolt	27	2.8	20

### USE AND CARE INFORMATION

Check the accessory mounts frequently and retighten if necessary.

### INSTALLATION

- Remove the universal joint guard and skid plate from the vehicle and save the skid plate.

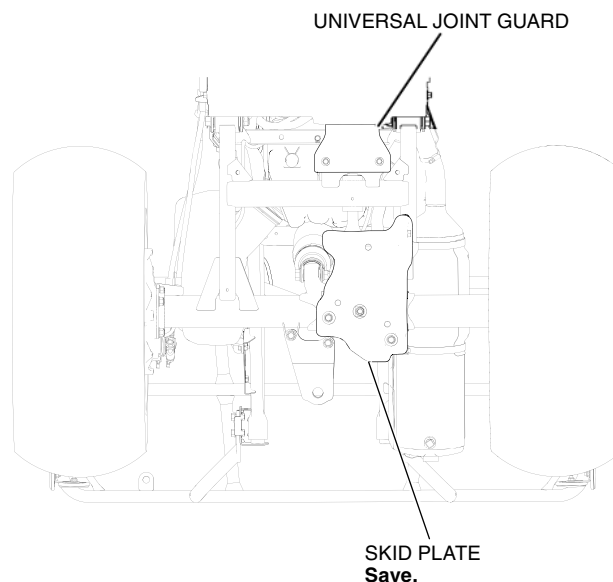

- Install the rubber stopper into the location shown.  
**NOTE:** Apply soapy water to the rubber to aid the installation.

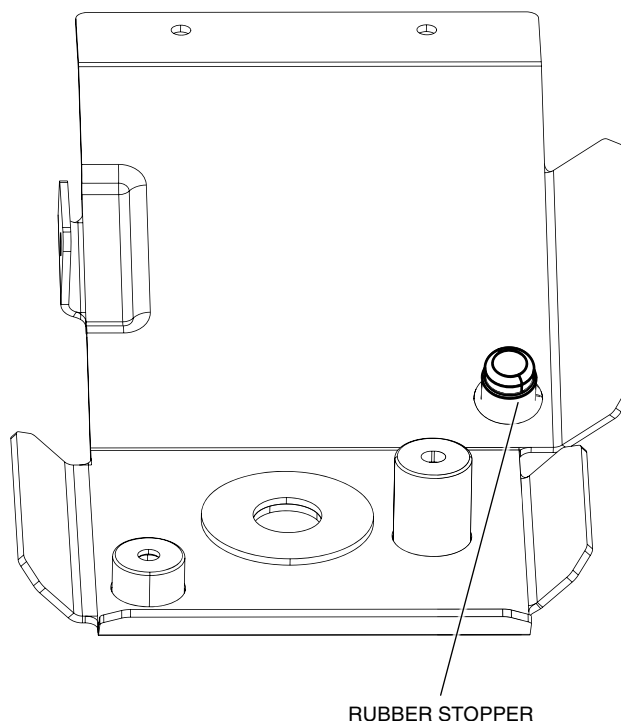

3. Position the swingarm guard as shown.

<BOTTOM VIEW>

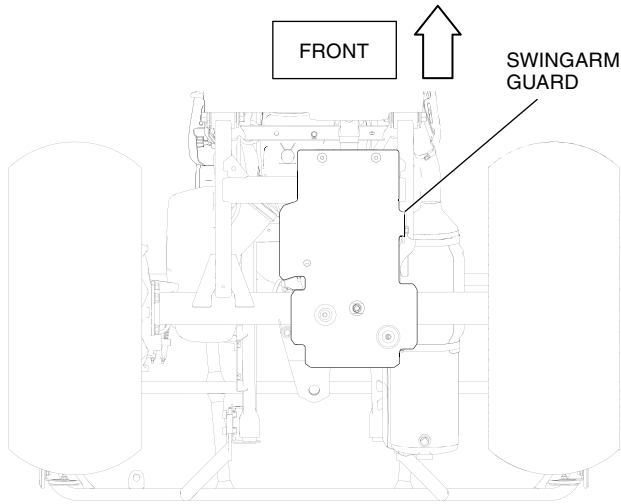

4. Loosely install one 8 mm flange bolt in the position shown.

Tighten the bolt until the guard lightly contacts the swingarm.

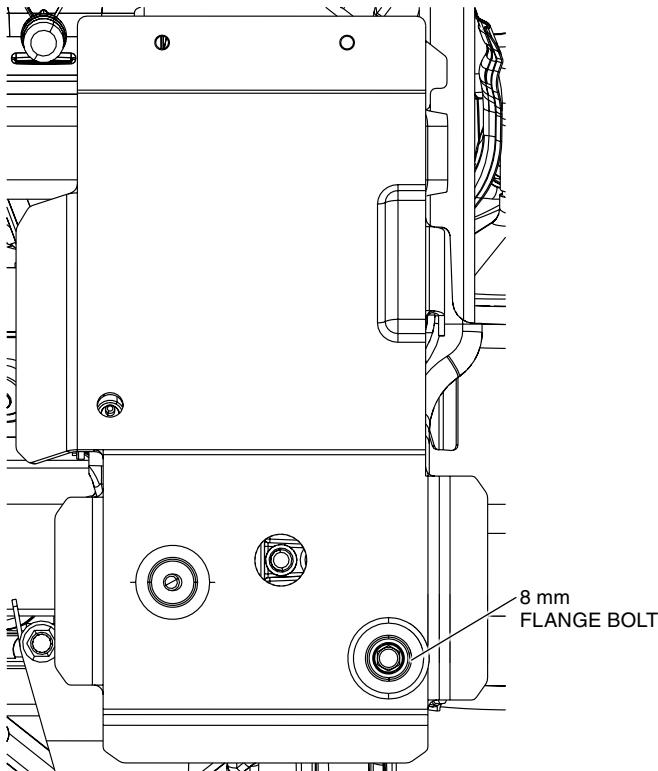

5. Loosely install one 8 mm flange bolt and 8 mm washer in the position shown.

Tighten the bolt until the guard lightly contacts the swingarm.

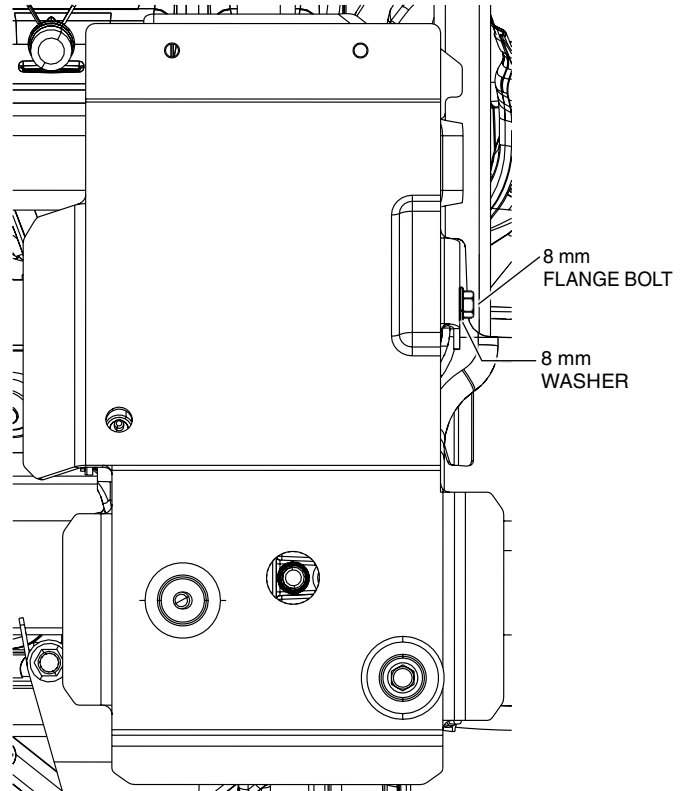

6. Loosely install one 8 mm flange bolt and 8 mm washer in the position shown.

Tighten the bolt until the guard lightly contacts the swingarm.

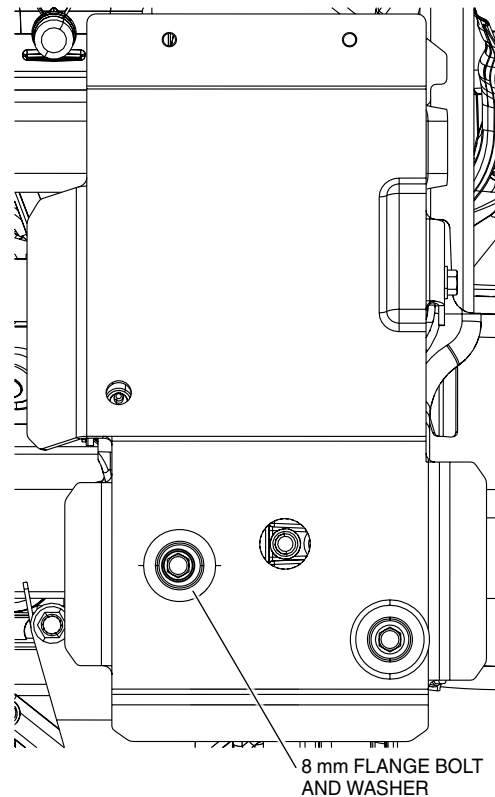

7. Press the steel collars into the universal joint guard as shown.

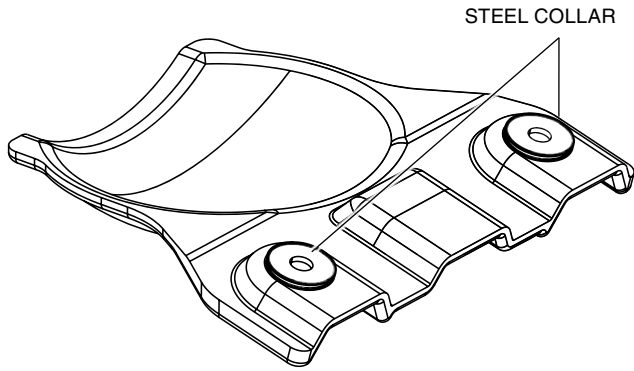

8. Position the universal joint guard such that the steel collar flanges contact the aluminum guard as shown.

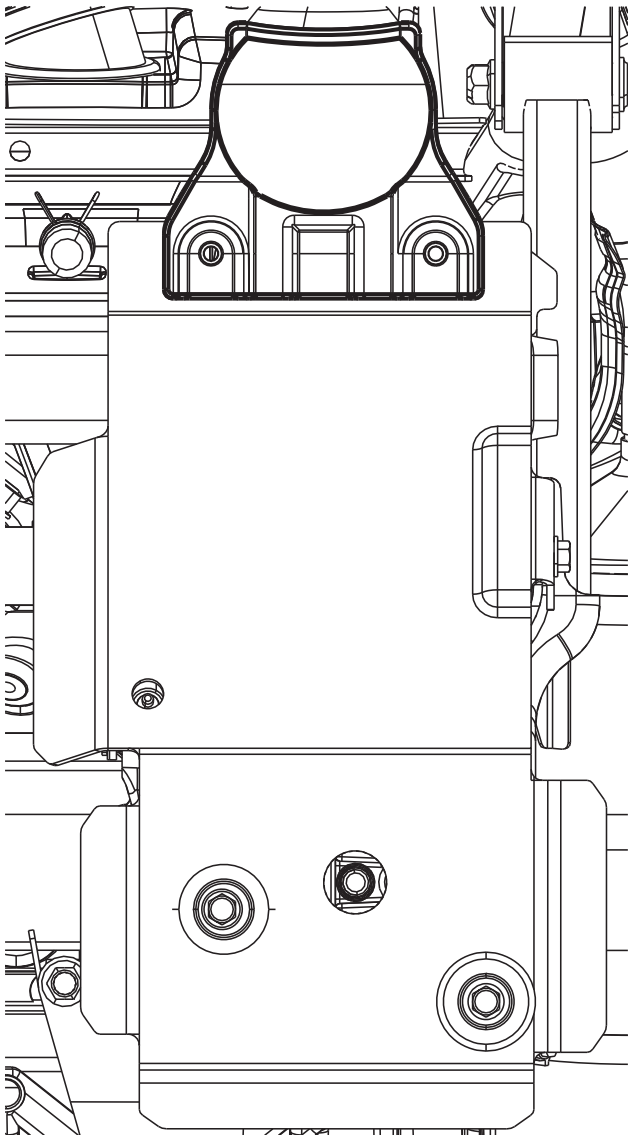

9. Loosely install the 6 mm flange bolts and washers in the locations shown.

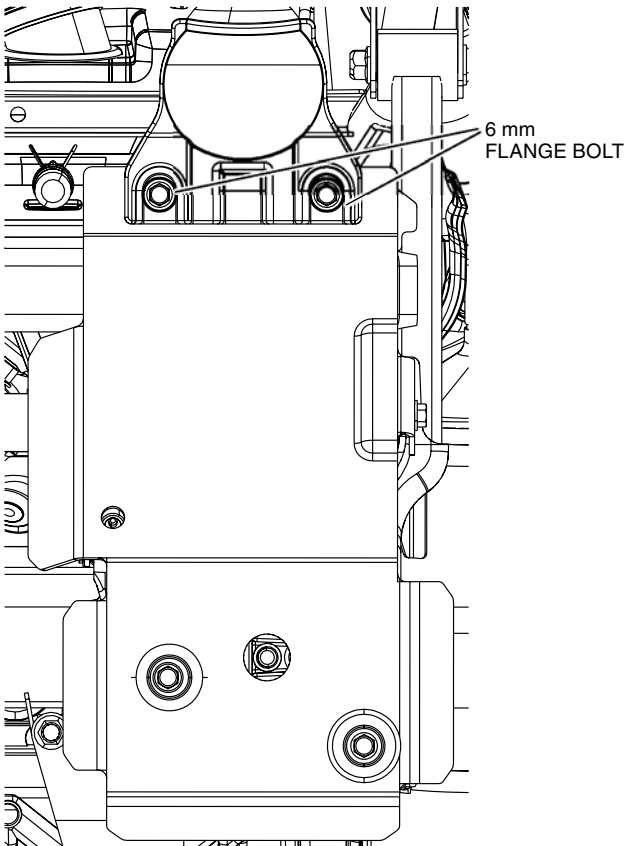

10. Tighten all fasteners to the specifications in the Torque Chart.