

HONDA

INSTALLATION INSTRUCTIONS

Accessory

FRONT A-ARM GUARD
P/N 08P70-HR3-620

Application

After '13 TRX 420 (All except TRX420FA/FPA)

Publication No.

MII 15067

Issue Date

September 2014

PARTS LIST

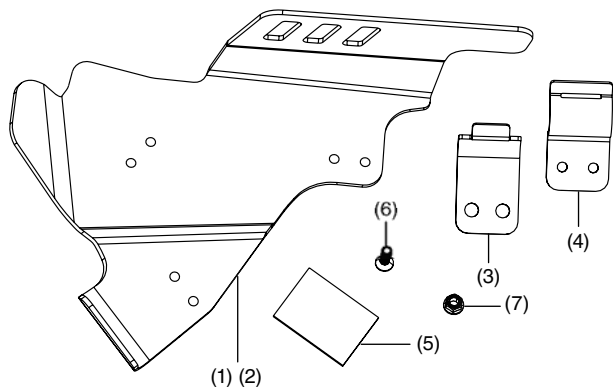

No.	Description	Qty
(1)	Front right arm guard	1
(2)	Front left arm guard	1
(3)	Tabbed bracket	6
(4)	Slotted bracket	6
(5)	Rubber strip	2
(6)	6 x 20 mm flat screw	12
(7)	6 mm U-nut	12

TOOLS AND SUPPLIES REQUIRED

Torque wrench

10 mm socket

Phillips screwdriver

TORQUE CHART

Tighten all screws, bolts, and nuts to their specified torque values. Refer to the Service Manual for the torque values of the removed parts.

Item	N-m	kgf-m	lbf-ft
6 mm U-nut	10	1	7

USE AND CARE INFORMATION

Check the accessory mounts frequently and retighten if necessary.

INSTALLATION

- Assemble the brackets by inserting the tab of the tabbed bracket through the slot in the slotted bracket. Place the assembled brackets around the left A-arm tubes as shown.

<LEFT A-ARM, TOP VIEW>

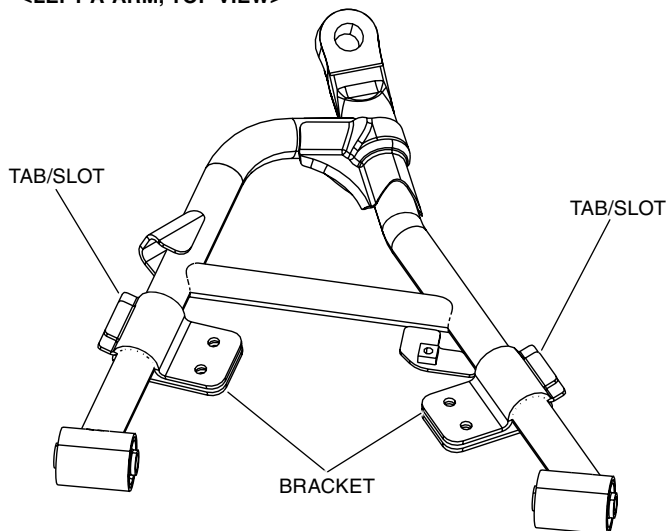

- Place the A-arm guard along front left A-Arm as shown.

<VIEW FROM BOTTOM>

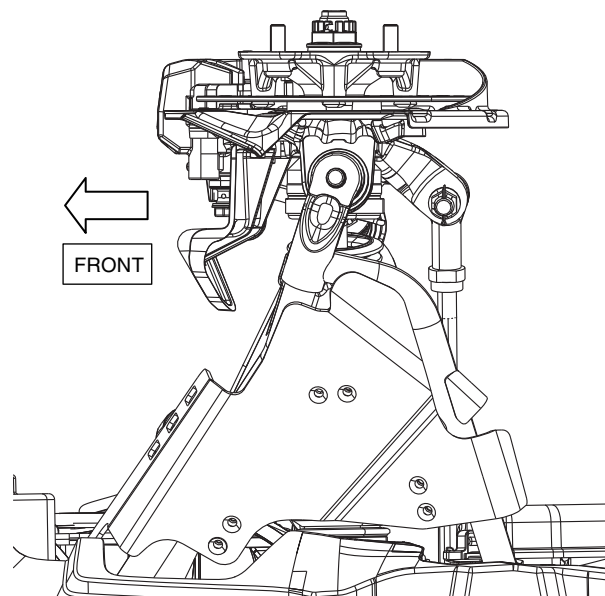

<TOP VIEW>

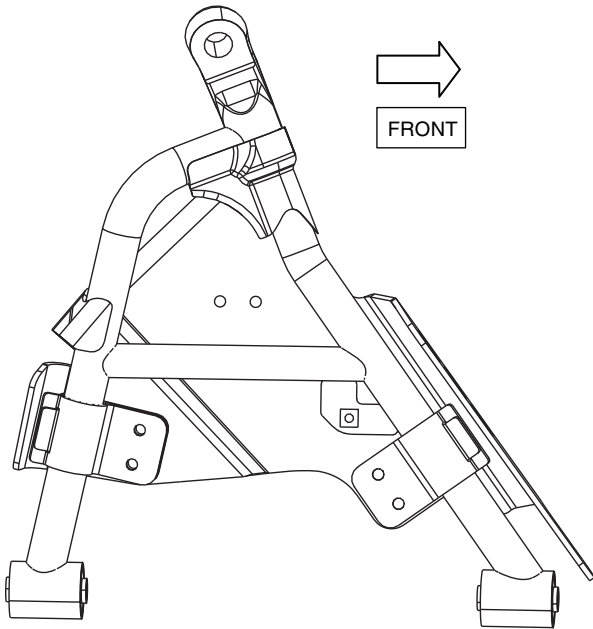

3. Pass two screws through the countersunk holes in the guard and assembled bracket as shown.

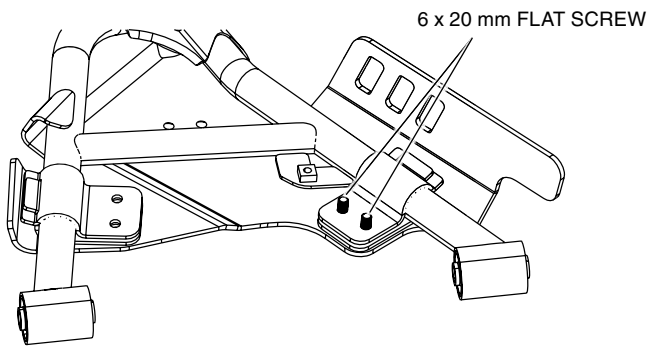

4. Thread a U-nut onto each screw and tighten until the bracket loosely contacts the guard.

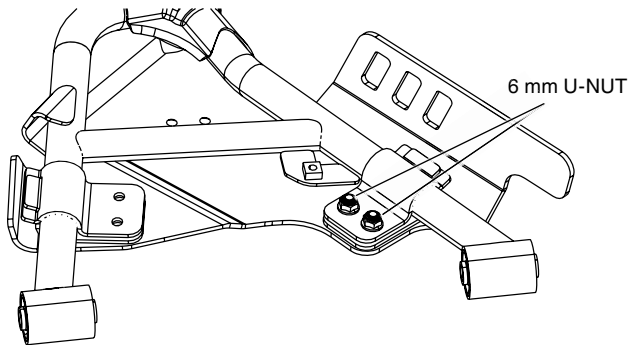

5. Repeat Steps 3 and 4 for the opposite bracket.

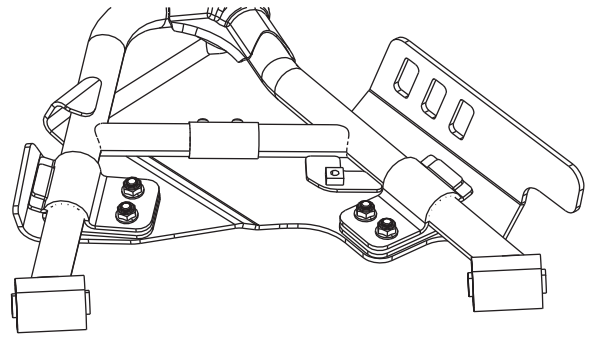

6. Wrap the rubber strip around the cross member as shown.

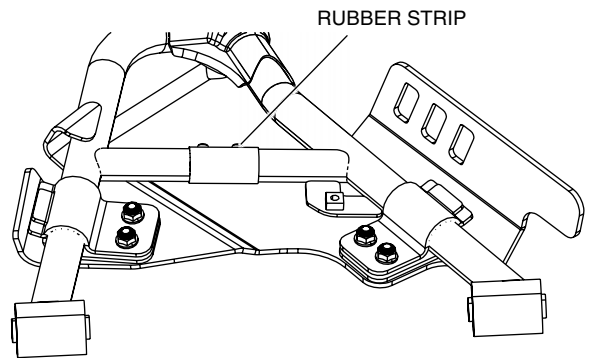

7. Assemble the bracket around the rubber strip as shown.

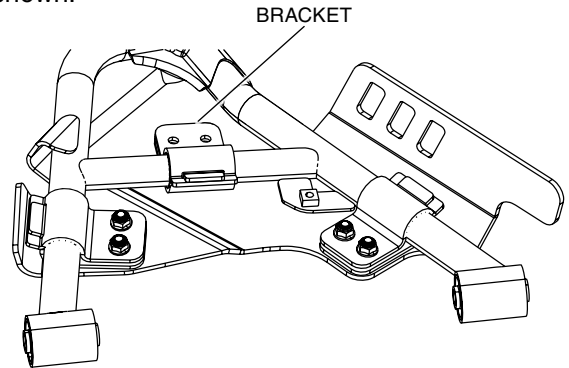

8. Repeat Steps 3 and 4 for the final bracket.

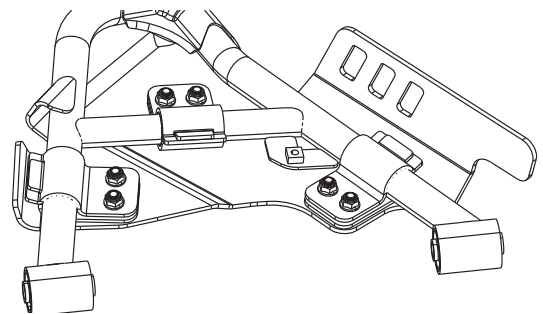

9. Once all brackets are loosely attached, tighten all hardware to the value specified in the Torque Chart.

10. Repeat Steps 1 thru 9 for installing the guard on the right A-arm.