



INSTALLATION INSTRUCTIONS

Accessory TOP CASE PANEL KIT (ALUMINUM) P/N 08L83-MKT-D00	Application NC750XA/XD	Publication No. MII 17714
		Issue Date April 2021

Honda Dealer: Please give a copy of these instructions to your customer.

PARTS LIST

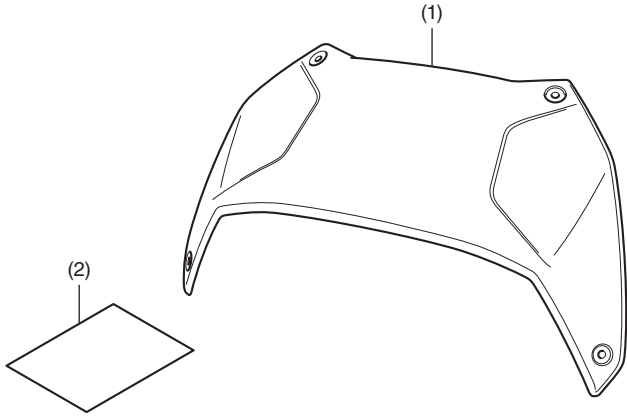

No.	Description	Qty
(1)	Top box lid panel	1
(2)	Installation instructions	1

TOP BOX (MANUAL) Sold separately

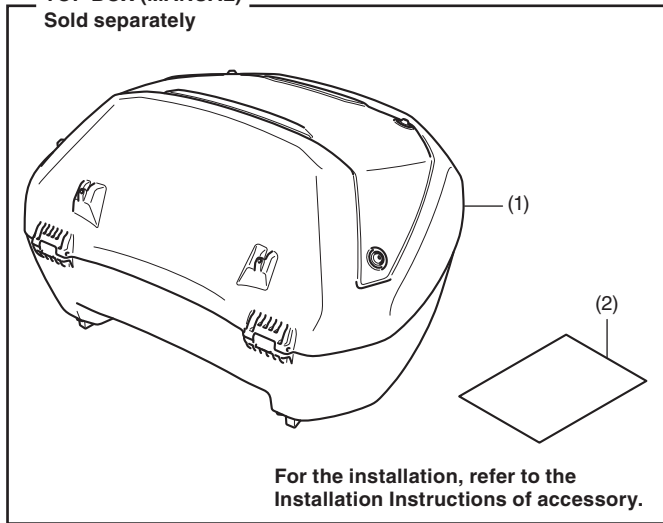

No.	Description	Qty
(1)	Top box	1
(2)	Installation instructions	1

TOP BOX (SMART) Sold separately

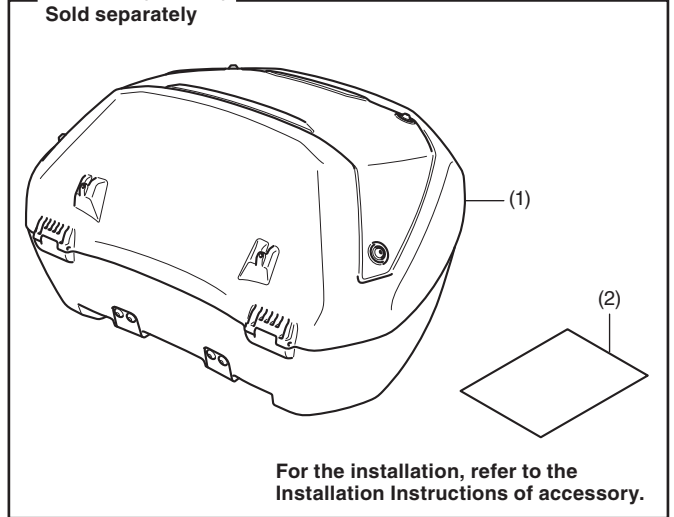

No.	Description	Qty
(1)	Top box	1
(2)	Installation instructions	1

TOOLS AND SUPPLIES REQUIRED

- Hex wrench (3 mm)
- Isopropyl alcohol
- Shop towel
- Torque wrench

TORQUE CHART

Tighten all screws, bolts, and nuts to their specified torque values. Refer to the Service Manual for the torque values of the removed parts.

Item	N·m	kgf·m	lbf·ft
Screw	4.2	0.4	3.1

INSTALLATION

NOTE:

- Heat the bonding surfaces with a hair dryer if the ambient air temperature is below 70°F (21°C).
- The adhesive reaches full strength in 72 hours. Wait at least 24 hours before riding your motorcycle.

1. Open the lid, then remove the parts as shown.

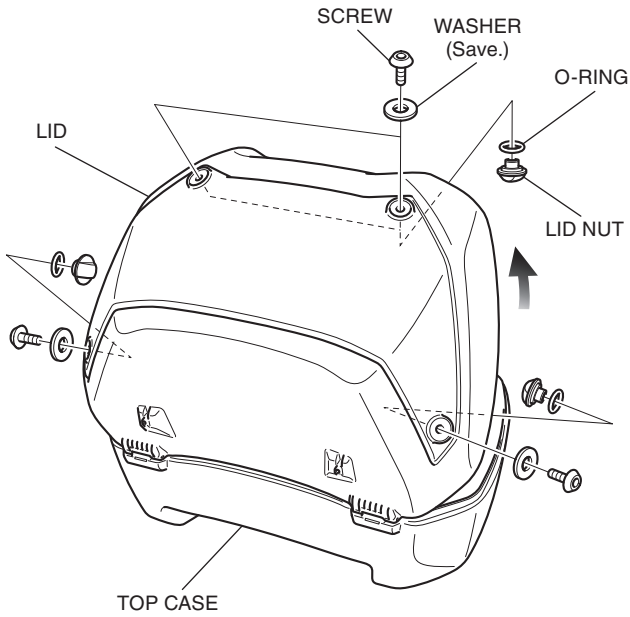

2. To maintain the adhesive strength of the double-sided tape, be sure to clean the surface of the indicated area with isopropyl alcohol.

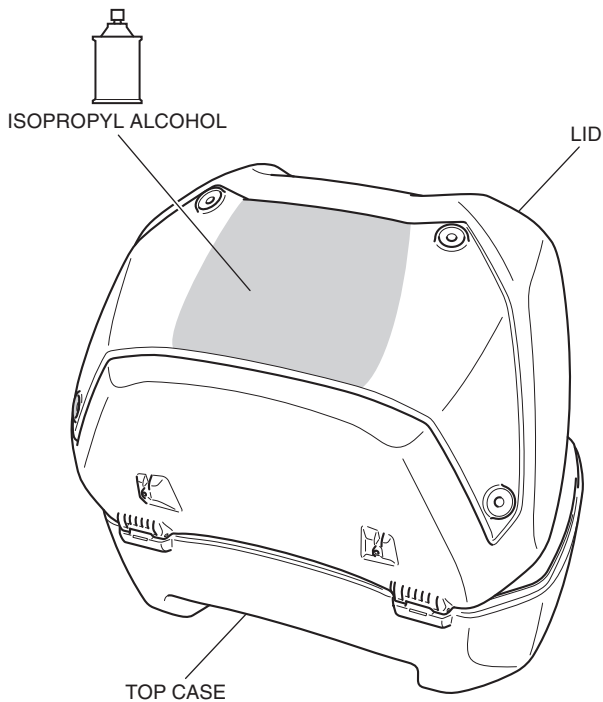

3. Peel off the adhesive backings on the rear of the top case lid panel as shown.

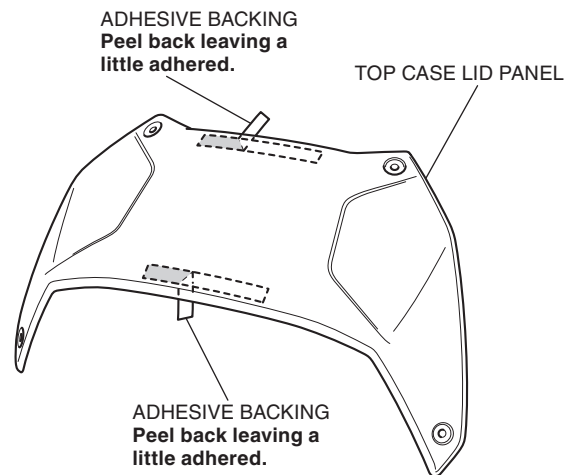

4. Attach the top case lid panel as shown.
 - Align the top case lid panel with the shape of the lid.

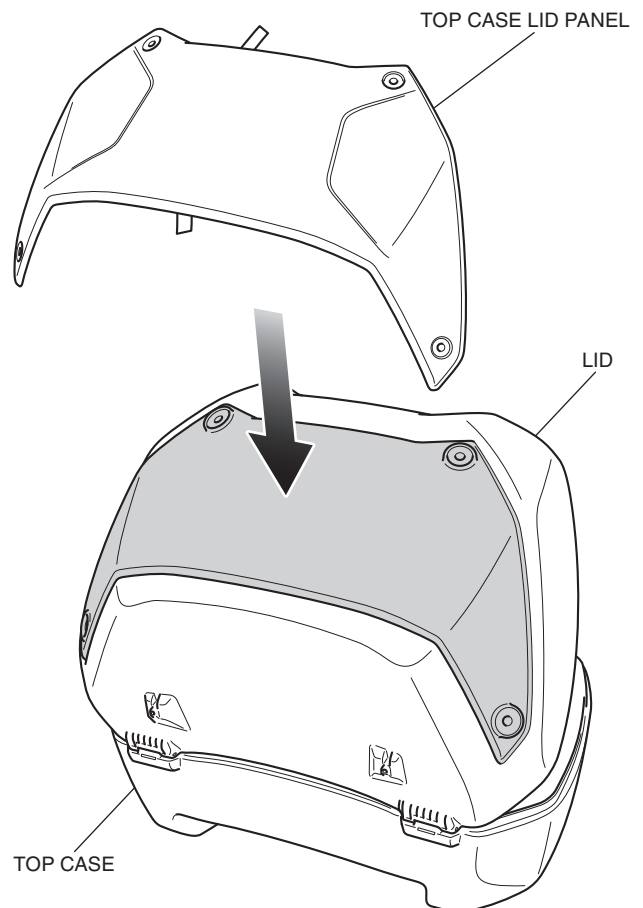

5. Temporarily set the screw and check that there is no misalignment.
 - If there is a misalignment, start over from step 4.

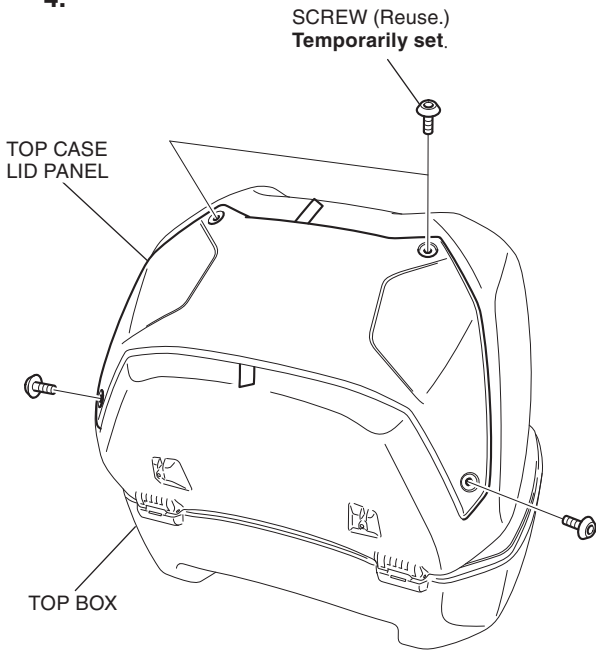

6. Remove the adhesive backings while pressing on the top case lid panel firmly with the palm.

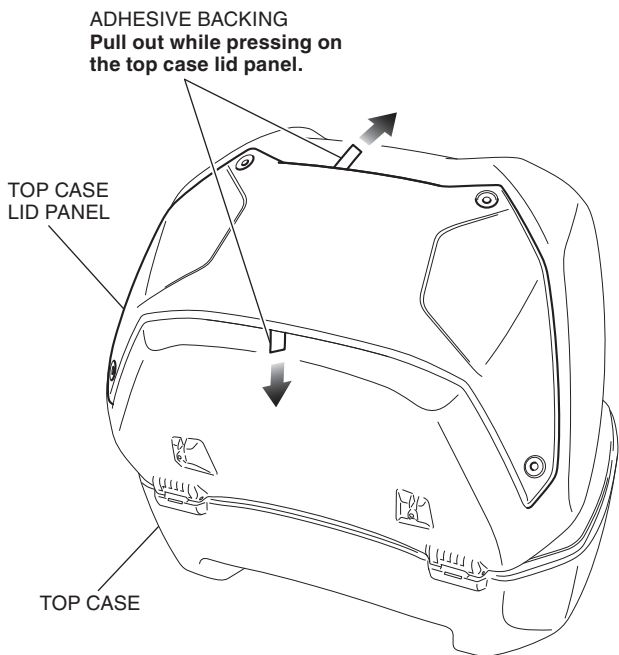

7. Applying adequate pressure of 5kgf (50N) to the attached top case lid panel.
 - Make sure to crimp with a force of 5 kgf (50 N).

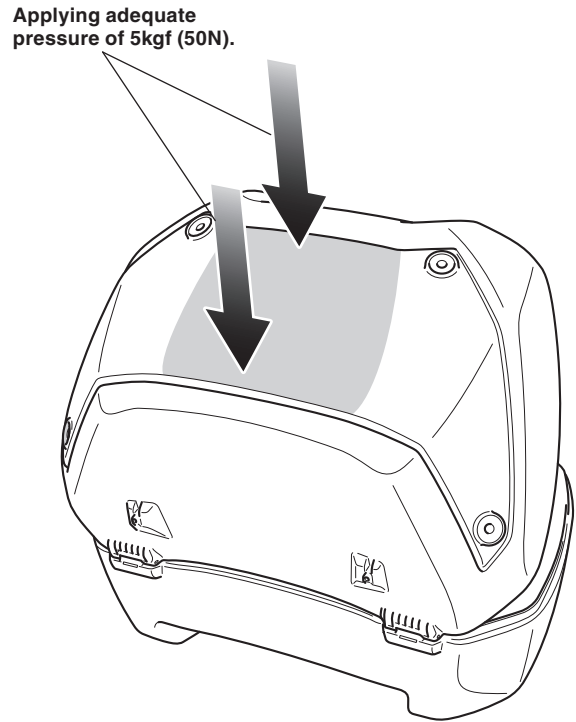

8. Leave the top case lid panels for 10 minutes to stabilize the fitting of the adhesive surface.

9. Install the parts as shown.

