



INSTALLATION INSTRUCTIONS

ProVantage Plow Pulley

Part Number: 84526

GENERAL SAFETY PRECAUTIONS

Your safety, and the safety of others, is very important. To help you make informed decisions about safety, we have provided installation and operating instructions and other information on labels and in this guide. This information alerts you to potential hazards that could hurt you or others. It is not possible to warn you about all potential hazards associated with this product, you must use your own good judgment.

CARELESS INSTALLATION AND OPERATION CAN RESULT IN SERIOUS INJURY OR EQUIPMENT DAMAGE. READ AND UNDERSTAND ALL SAFETY PRECAUTIONS AND OPERATING INSTRUCTIONS BEFORE INSTALLING AND OPERATING THIS PRODUCT.

This guide identifies potential hazards and has important safety messages that help you and others avoid personal injury or death. **WARNING** and **CAUTION** are signal words that identify the level of hazard. These signal words mean:

▲WARNING signals a hazard that could cause serious injury or death, if you do not follow recommendations. **▲CAUTION** signals a hazard that may cause minor to moderate injury, if you do not follow recommendations.

This guide uses **NOTICE** to call attention to important mechanical information, and **Note:** to emphasize general information worthy of special attention.

▲ WARNING

IMPACT AND MOVING PARTS ENTANGLEMENT HAZARD

Failure to observe these instructions could lead to severe injury or death

- Always Read the Plow Operator's Manual, the Winch Operator's Manual and all warning labels before operating.
- Always remove jewelry and wear eye protection.
- Always use appropriate and adequate care in lifting components into place.
- Always insure components will remain secure during installation and operation.
- Always tighten all nuts and bolts securely, per the installation instructions.
- Always operate the vehicle at a walking speed with the blade installed. Never exceed 5 mph (8 km/h), even with blade up.
- Always plow cautiously, impact with hidden or stationary object may cause the vehicle to stop suddenly or go out of control.
- Never operate the vehicle on slopes greater than 10 degrees with the plow installed.
- Never stand or ride on the plow.
- Always stay clear of moving parts and joints. Always keep others away when operating or adjusting plow.
- Always perform regular inspections and maintenance on the plow mechanism, fasteners, cable and related hardware.
- Always replace all worn or damaged parts before operating.
- Never operate this WARN product with damaged or missing parts.
- Always drive slowly over bumpy and rough terrain. Driving at speeds that cause the plow to bounce while in the up position can cause the winch to back-drive, causing the plow to work its way down. This may result in the plow impacting a stationary object and cause damage to the vehicle and operator injury or death.
- Always drive at speeds such that the plow does not bounce and be aware of the plow position while driving at all times.
- Never raise the top of the plow above the headlights of the ATV, as it may damage the vehicle and plow.

Read installation and operating instructions thoroughly.

WARN INDUSTRIES, INC. 12900 S.E. Capps Road,
 Clackamas, OR USA 97015-8903, 1-503-722-1200, FAX: 1-503-722-3000
Customer Service: 1-800-543-9276
Dealer Locator Service: 1-800-910-1122
International Sales/ Customer Service: 1-503-722-3008
International Fax: 1-503-722-3005

⚠ CAUTION

MOVING PARTS ENTANGLEMENT HAZARD

Failure to observe these instructions could lead to minor or moderate injury

- Always take time to fully read and understand the installation and Operations Guide included with this product.
- Never operate this product if you are under 16 years of age.
- Never operate this product when under the influence of drugs, alcohol or medications.

Read installation and operating instructions thoroughly.

NOTICE

EQUIPMENT DAMAGE

- Always refer to the Installation and Specification Guide, supplied in the winch kit, for all wiring schematics and specific details on how to wire this WARN product to your vehicle.

Read installation and operating instructions thoroughly.

NOTES

BEFORE YOU BEGIN

TABLE OF CONTENTS

Parts List..... page 3
 Tools Required..... page 3
 Torque Specifications..... page 3
 Installation..... page 4-5
 Maintenance/Care..... page 5

PARTS LIST

Item	Part Number	Qty	Description
1	84120	1	Pulley Mount Bracket RH
2	84119	1	Pulley Mount Bracket LH
3	84126	1	Pulley
4	69954	2	M10 Flange Head Bolt
5	39172	1	Quick Link
6	35136	1	Pin with safety retainer
7	82076	1	Termination Strap

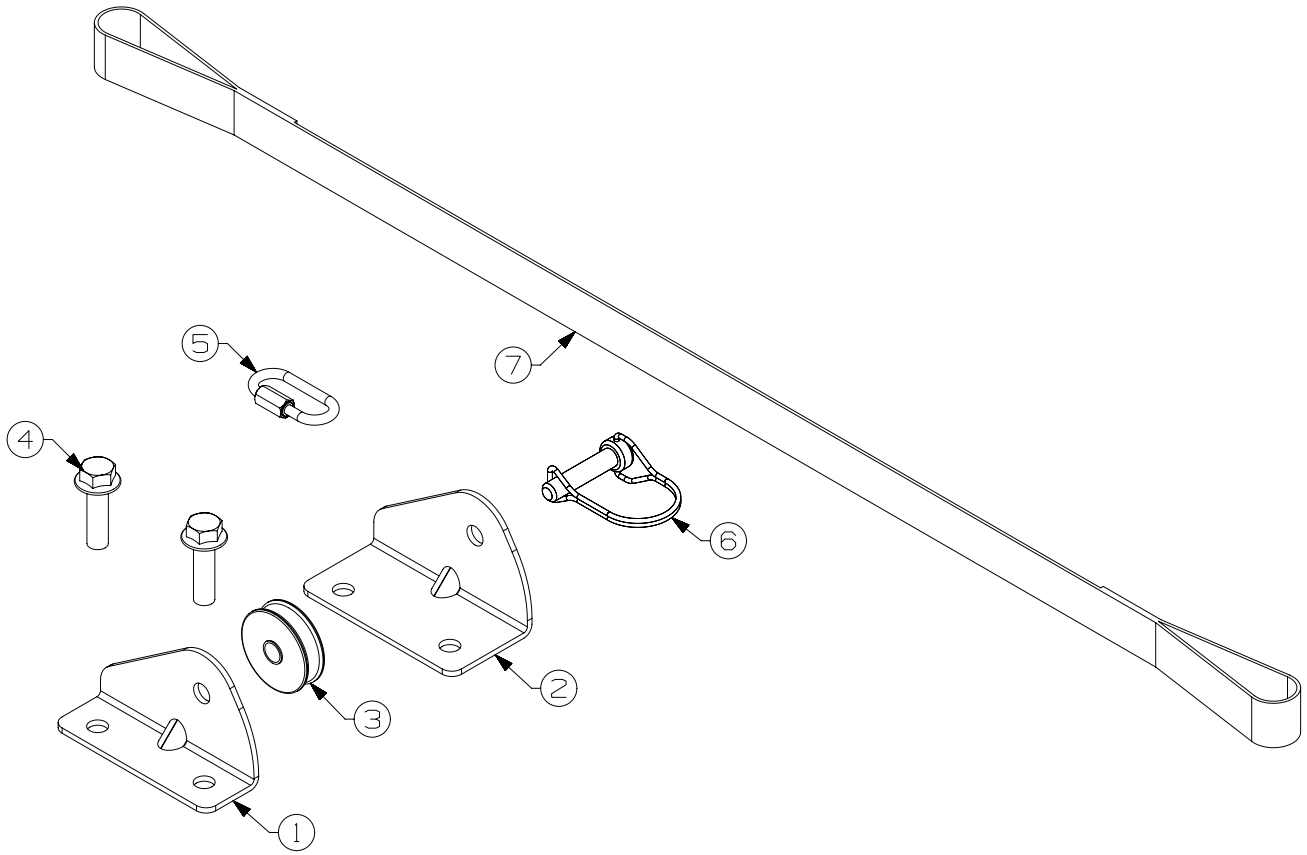

TOOLS REQUIRED

- Ratchet
- Sockets: 14mm, 15mm
- Box Wrenches: 17mm

TORQUE SPECIFICATIONS

Please use the recommended torque specifications when assembling this product unless otherwise specified in the instructions.

FASTENER SIZE	FASTENER TORQUE	
	lb-ft	(N.m)
M6	(7.5)	10
M8	(18)	25
M10	(37)	50

INSTALLATION INSTRUCTIONS

1. Install the pulley mounting bracket. This bracket must be installed on the right side of the plow as shown. Remove the two plow base bolts as shown in Figure 1.

NOTE: *The pulley mount contains two L brackets. The L-bracket with longer leg fits under shorter L-bracket.*



Figure 1

2. Position shorter L-bracket over longer bracket. Secure the brackets to tube assembly with longer M10 flange head bolts provided in this kit. See Figure 2.

Tighten the fastener at this time so that the bolt engages the nylon in the lock nut.

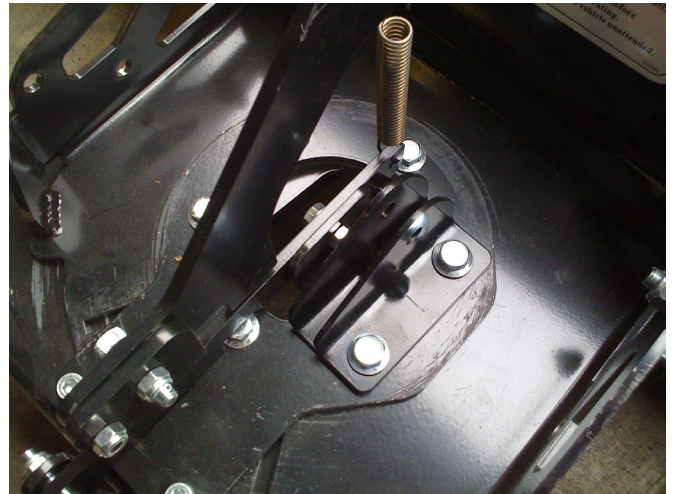

Figure 2

3. Install the pulley in the mounting bracket as shown (Figure 3).

Use the 3/8" retaining pin to secure the pulley in the mount.

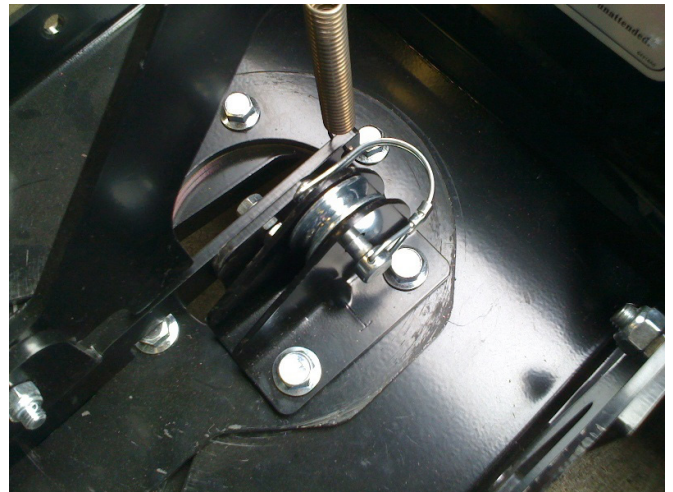

Figure 3

INSTALLATION INSTRUCTIONS

4. Install plow on vehicle. Slide plow to the vehicle or have second person help carry it to vehicle. Attach plow to plow mount. Secure plow to mount with pins. Make sure pins are secure to mount and will not come out.
5. Route the winch rope through the pulley assembly on plow (Figure 4).

NOTE: A roller fairlead is required for this application. The use of a plow roller fairlead (large roller) and a short synthetic rope is highly recommended.

6. Install the termination strap on the front rack (figure 5). Position this strap so that it is contacting the rack as close to the frame mounting points as possible.

Wrap the strap around the rack and front bumper as needed to position the end of winch rope in an area that will not damage the front of vehicle.

NOTE: The strap must be wrapped around the largest diameter tube available, this will improve life of strap. Make sure rope hook or termination link is located as far as possible from pulley on plow.



Figure 4



Figure 5

MAINTENANCE / CARE

1. Inspect all parts on the winch, winch mount, and related hardware prior to each use. Replace all hardware that appears rusted or deformed.
2. Inspect all nuts and bolts on the winch, winch mount, and related hardware prior to each use. Tighten all nuts that appear to be loose. Stripped, fractured, or bent bolts or nuts need to be replaced.
3. Check all cables prior to use. Replace cables that look worn or frayed.
4. Check all moving or rotating parts. Remove debris that may inhibit the part from moving freely.

CARELESS INSTALLATION AND OPERATION CAN RESULT IN SERIOUS INJURY OR EQUIPMENT DAMAGE. READ AND UNDERSTAND ALL SAFETY PRECAUTIONS AND OPERATING INSTRUCTIONS BEFORE INSTALLING AND OPERATING THIS PRODUCT.

