

# HONDA

## INSTALLATION INSTRUCTIONS

Accessory

**RIGHT PANNIER CASE**  
P/N 08L73-MKS-A00  
**LEFT PANNIER CASE**  
P/N 08L74-MKS-A00

Application

**CRF1100A/A4/D/D4**

Publication No.

**MII 17351**

Issue Date

**February 2020**

**Honda Dealer: Please give a copy of these instructions to your customer.**

### PARTS LIST

#### <Right pannier case>

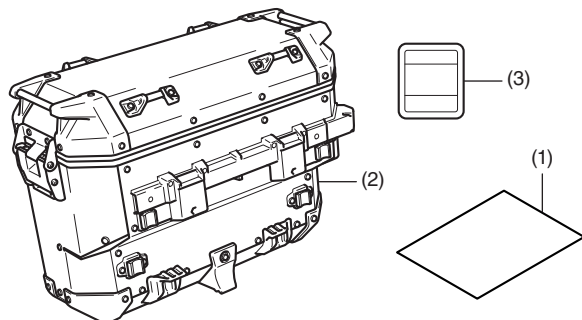

No.	Description	Qty
(1)	Installation instructions URL	1
(2)	Right pannier case	1
(3)	Label*	1

\* (for USA) **Not used.**  
(for CANADA) Apply the label onto the attached label.

#### 1 KEY INNER CYLINDER (Wave key type)

- Do not use the [ ] slots.

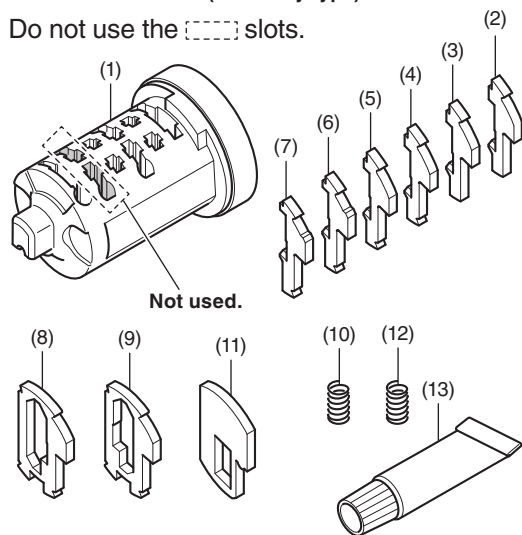

No.	Description	Qty
(1)	Inner cylinder	1
(2)	No.1 tumbler	6
(3)	No.2 tumbler	6
(4)	No.3 tumbler	6
(5)	No.4 tumbler	6
(6)	No.5 tumbler	6
(7)	No.6 tumbler	6
(8)	Sub-lock tumbler A	1
(9)	Sub-lock tumbler B	1
(10)	Spring (Silver)	13
(11)	Stopper tumbler	2
(12)	Stopper spring (Black)	2
(13)	Grease	1

#### <Left pannier case>

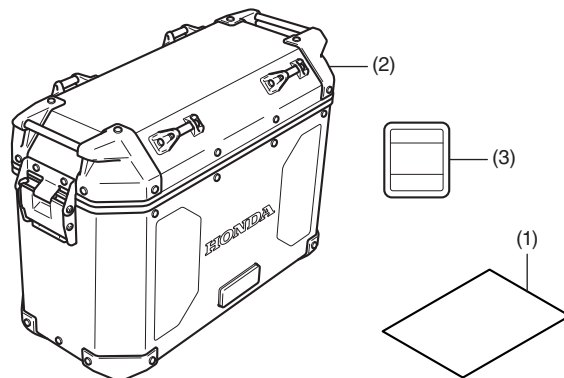

No.	Description	Qty
(1)	Installation instructions URL	1
(2)	Left pannier case	1
(3)	Label*	1

\* (for USA) **Not used.**  
(for CANADA) Apply the label onto the attached label.

#### 1 KEY INNER CYLINDER (Wave key type)

- Do not use the [ ] slots.

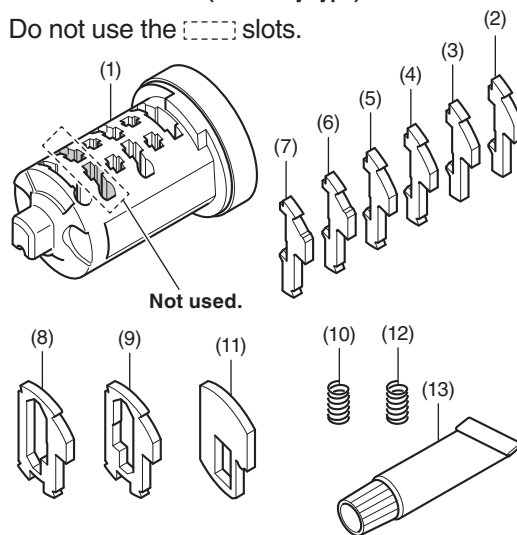

No.	Description	Qty
(1)	Inner cylinder	1
(2)	No.1 tumbler	6
(3)	No.2 tumbler	6
(4)	No.3 tumbler	6
(5)	No.4 tumbler	6
(6)	No.5 tumbler	6
(7)	No.6 tumbler	6
(8)	Sub-lock tumbler A	1
(9)	Sub-lock tumbler B	1
(10)	Spring (Silver)	13
(11)	Stopper tumbler	2
(12)	Stopper spring (Black)	2
(13)	Grease	1

# **PANNIER STAY** Sold separately

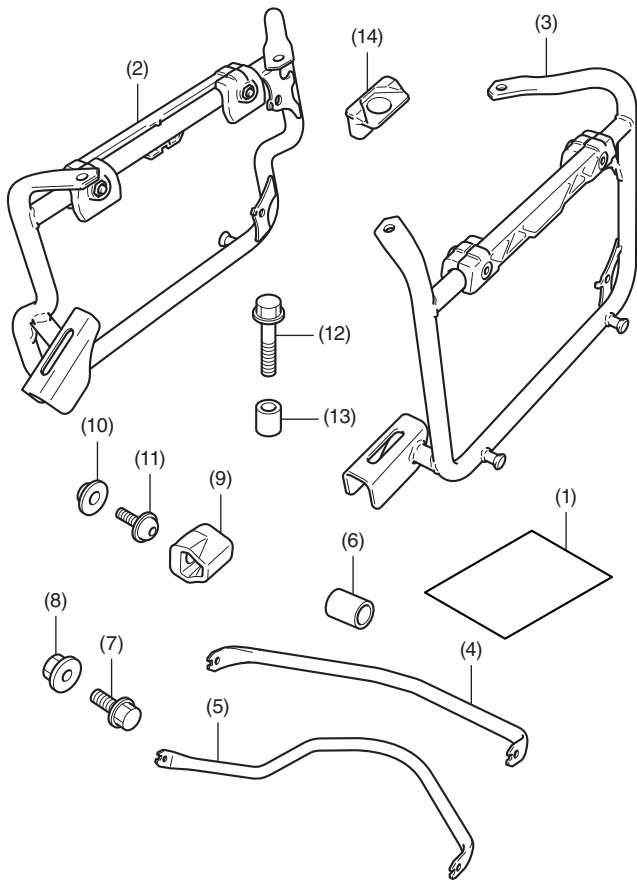

For installation, refer to the  
Installation Instructions of accessory.

No.	Description	Qty
(1)	Installation instructions URL	1
(2)	Right pannier stay	1
(3)	Left pannier stay	1
(4)	Upper cross pipe	1
(5)	Lower cross pipe	1
(6)	Tube	1
(7)	8 mm SH flange bolt	4
(8)	8 mm flange nut	4
(9)	Cushion	2
(10)	Flange collar	2
(11)	5 mm socket bolt	2
(12)	8 mm flange bolt	4
(13)	Collar	4
(14)	Pannier stay cap	4

# **REAR CARRIER** Sold separately

<CRF1100A/D only>

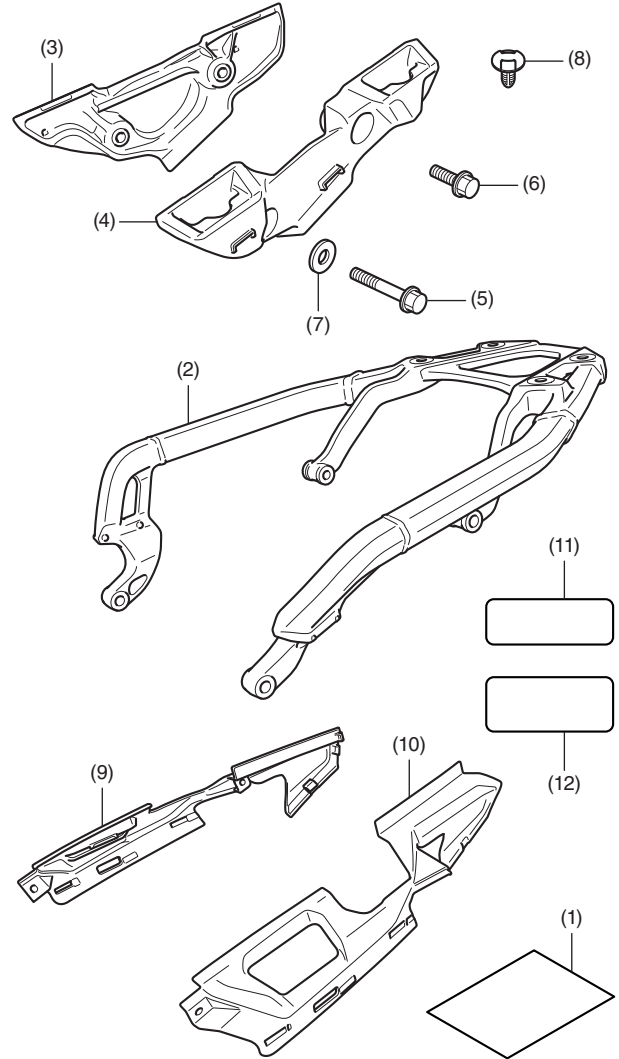

For installation, refer to the  
Installation Instructions of accessory.

No.	Description	Qty
(1)	Installation instructions URL	1
(2)	Rear carrier	1
(3)	Right pannier bracket	1
(4)	Left pannier bracket	1
(5)	8 mm flange bolt	4
(6)	8 mm bolt	2
(7)	Washer	4
(8)	Clip	4
(9)	Right pannier bracket cover	1
(10)	Left pannier bracket cover	1
(11)	Label (MKK-D00)	1
(12)	Label (MFG-900)	1

## MAXIMUM LOADING CAPACITY

- The weight of the cargo must not exceed the following maximum loading capacity:

Maximum Loading Capacity	
Right pannier case	22.0 lb (10.0 kg)
Left pannier case	22.0 lb (10.0 kg)

### < Notes regarding the key cylinder >

- This product is used to assemble a key cylinder matching the motorcycle key by combining six types of tumblers.
- When this key cylinder is installed in a box or similar equipment, the installed equipment can be operated with the motorcycle key.

#### Combine six types of tumblers.

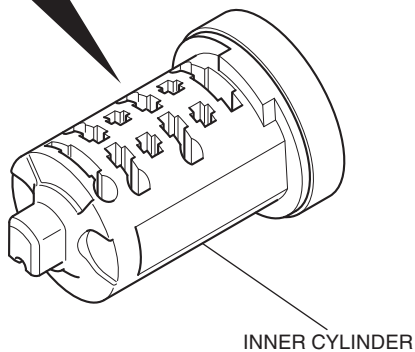
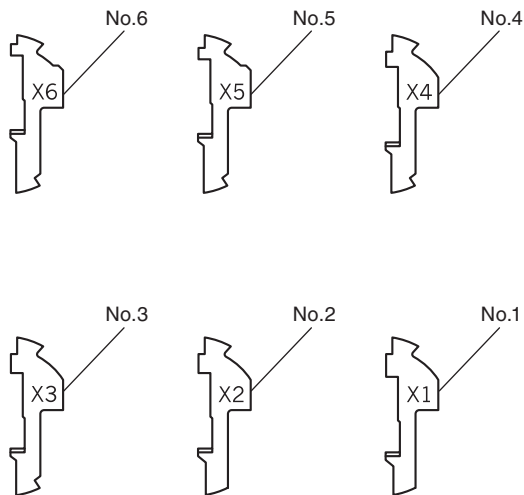

## INSTALLATION

- The two sub-lock tumbler types shown are provided.
  - The  part has a different slot for each of the two sub-lock tumbler types.
  - As the tumblers are small, keep them in the bag until they are used.

SUB-LOCK TUMBLER A

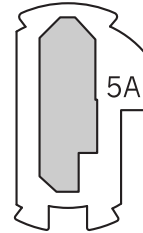

SUB-LOCK TUMBLER B

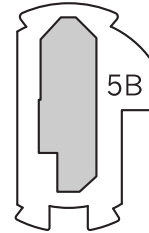

#### The stopper tumbler will be used later.

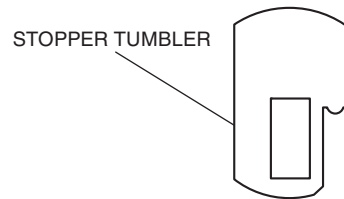

- The six tumbler types shown are provided.
  - The  part has a different width for each of the six tumbler types.
  - As the tumblers are small, keep them in the bag until they are used.

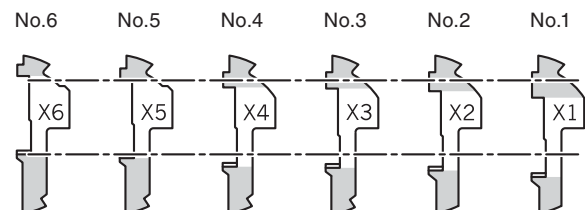

3. Install the tumblers and springs (silver) as shown.
- **First install four No.1 tumblers.**
  - **Note the installed tumbler in the chart below.**

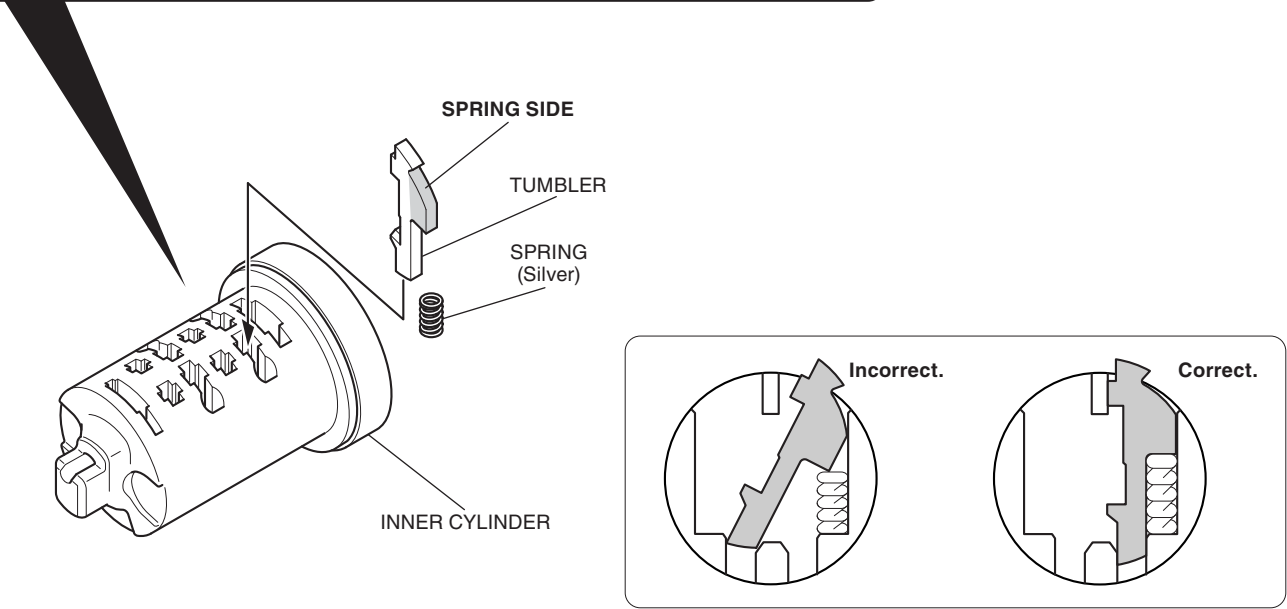
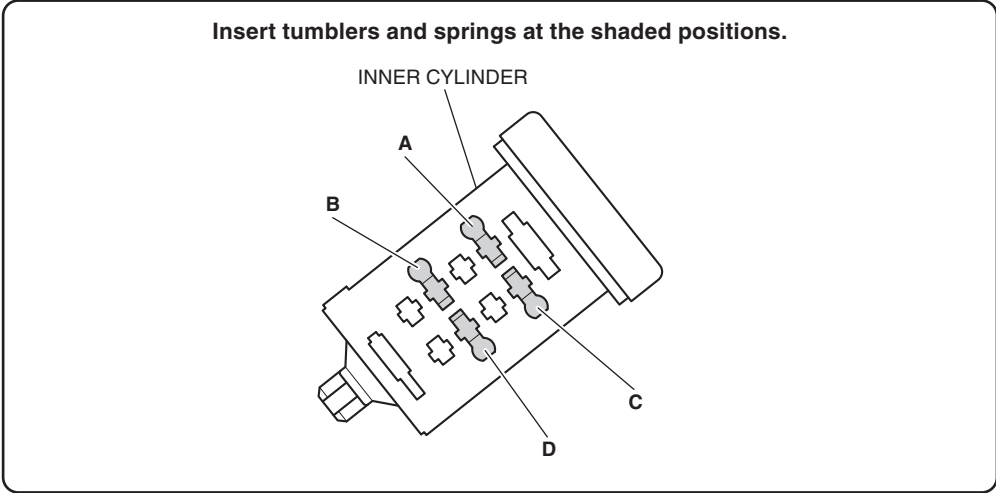

	Position A	Position B	Position C	Position D
No.1 tumbler				
No.2 tumbler				
No.3 tumbler				
No.4 tumbler				
No.5 tumbler				
No.6 tumbler				

4. Insert the key as shown.
- **Lightly press down on the tumblers from above, then insert the key.**

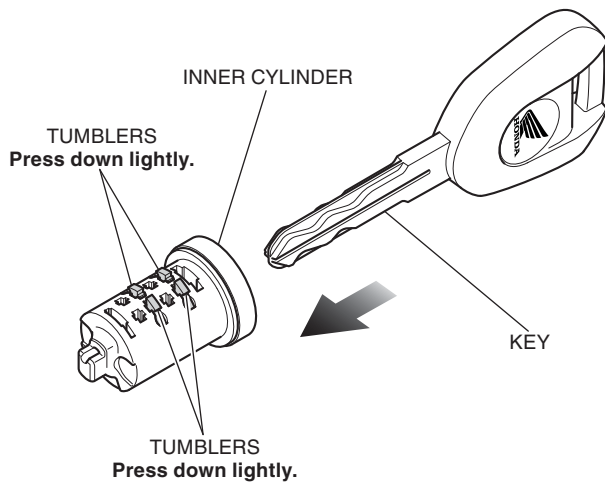

5. Confirm that some tumblers are projecting. Mark the positions of the projected tumblers.
- **The positions where tumblers project and the projecting height differ according to the key.**

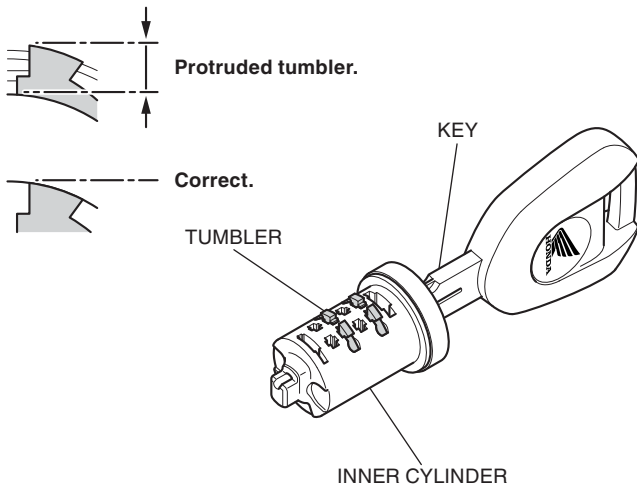

6. Press down lightly on the tumbler, pull the key out.
- **The tumbler spring may jump out when the tumbler is not pressed down lightly.**

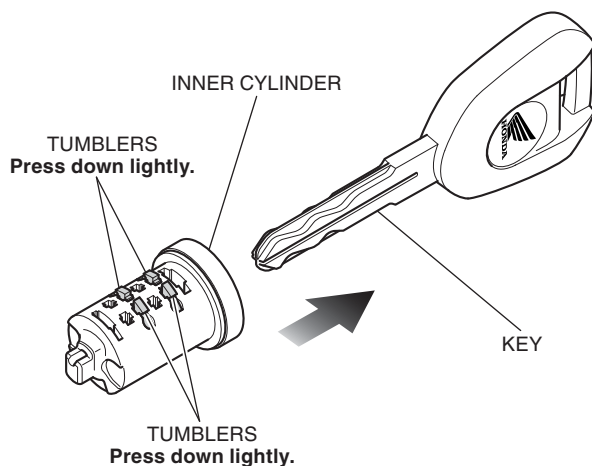

7. Pull out the projecting tumbler(s).
- **Leave the spring(s) installed.**

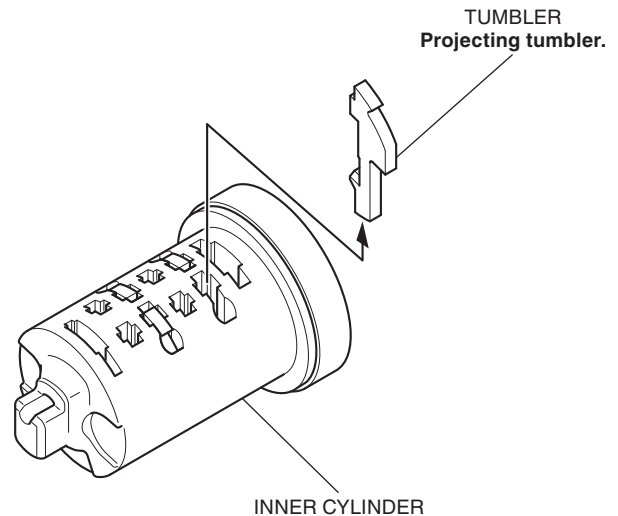

8. Insert a different tumbler(s) at the marked positions.
- **Start with the No. 2 tumbler and continue sequentially.**

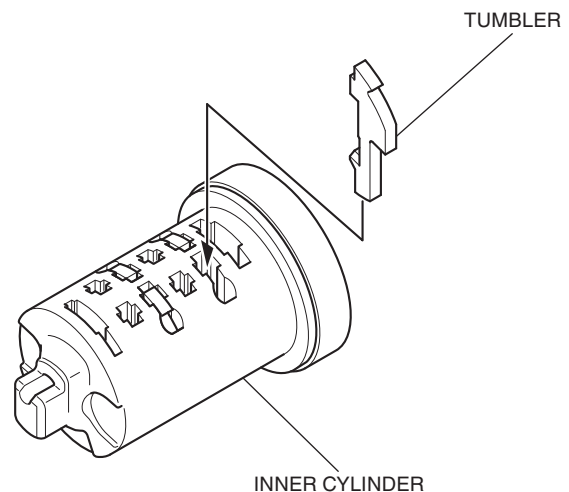

9. Repeat steps 4 to 8, inserting different tumblers at the marked positions until no tumblers are projected.
- **Lightly press down on the tumblers from above, then insert the key.**

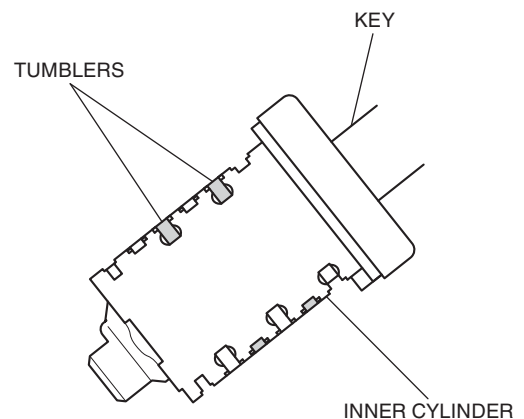

10. Install the tumblers and springs (silver) to the opposite side of the inner cylinder as shown.

- **First install two No.1 tumblers.**

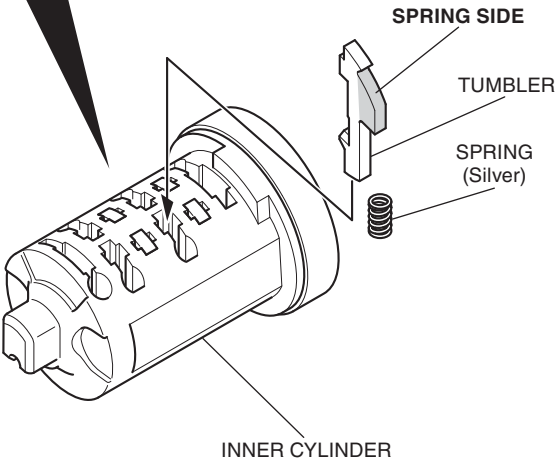
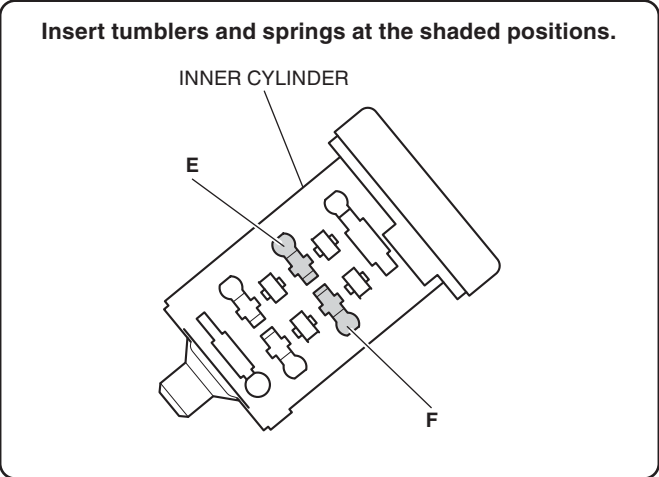

- **Note the installed tumbler to the chart below.**

	Position E	Position F
No.1 tumbler		
No.2 tumbler		
No.3 tumbler		
No.4 tumbler		
No.5 tumbler		
No.6 tumbler		

11. Use steps 3 through 8 to assemble the opposite side inner cylinder in the same manner.

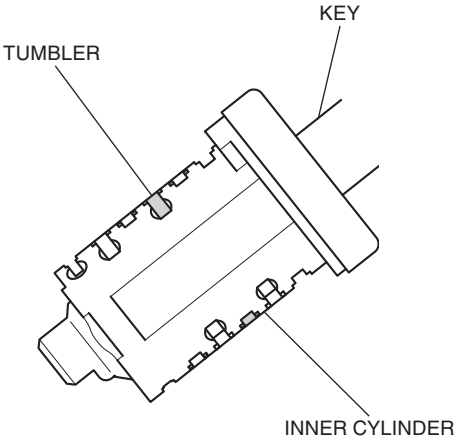

12. Install the sub-lock tumbler as shown.

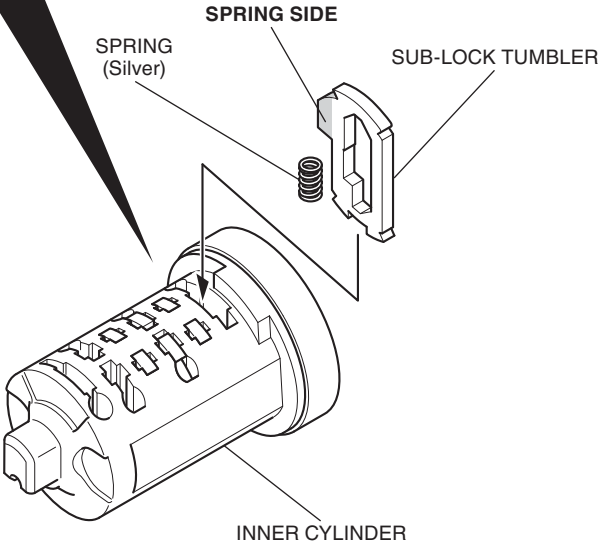
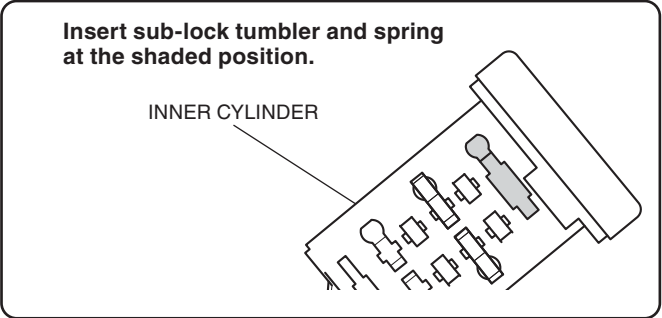

- **Note the installed tumbler to the chart below.**

Sub-lock tumbler A	
Sub-lock tumbler B	

13. Confirm that sub-lock tumbler is not projecting.
- **If the tumbler is projecting, change to another sub-lock tumbler and recheck.**

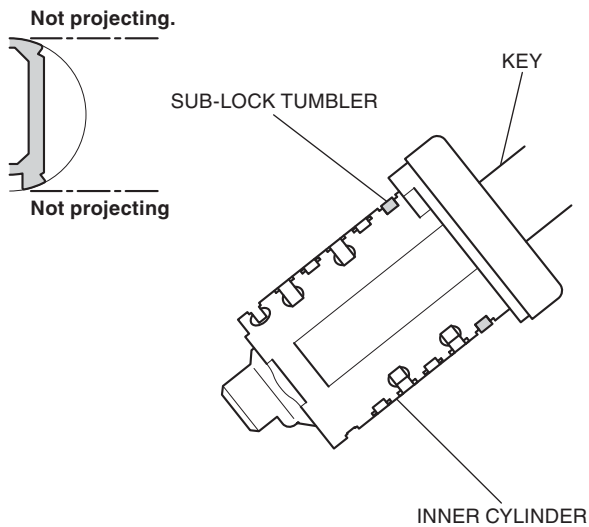

14. Remove the cap as shown.

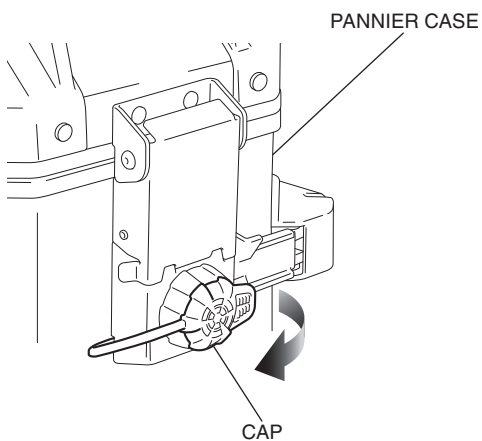

15. Insert the assembled inner cylinder into the key cylinder as shown.
- **Confirm the inner cylinder turns clockwise smoothly.**

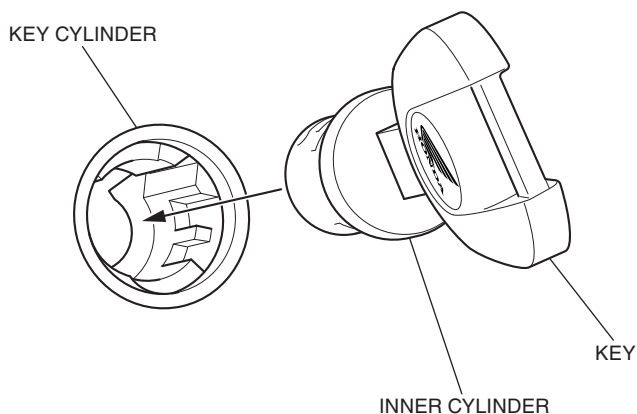

16. Pull out the inner cylinder.
17. Press down lightly on the tumblers and pull out the key.

18. Install the stopper tumbler and stopper spring (black) as shown.

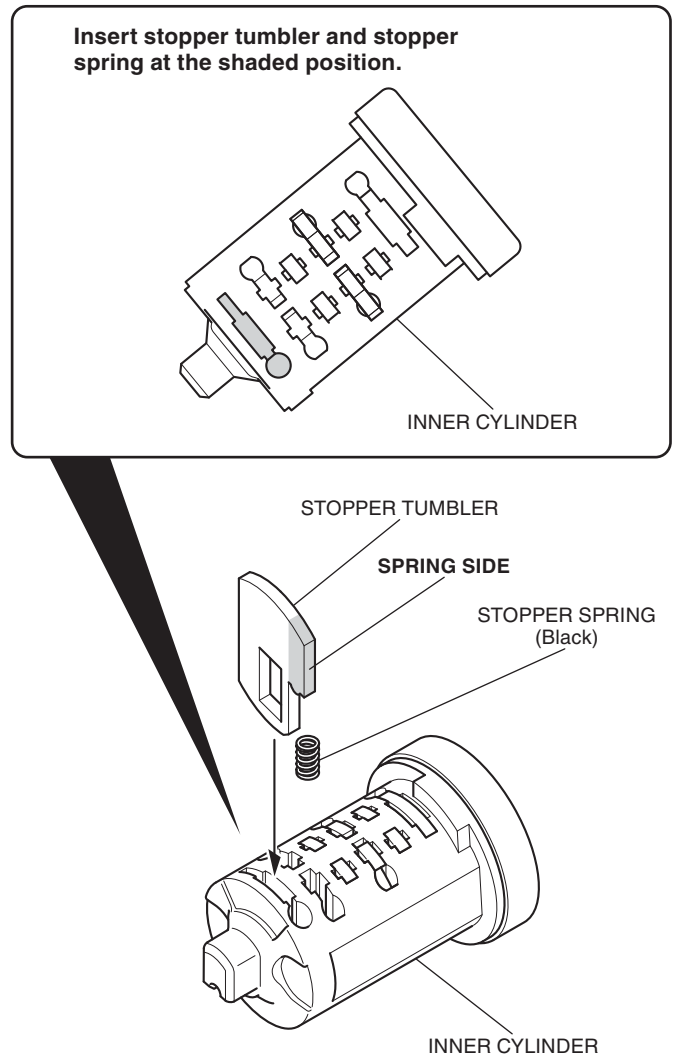

19. Insert the key as shown.
- **Lightly press down on the tumblers from above, then insert the key.**
  - **Confirm the stopper tumbler is projecting.**

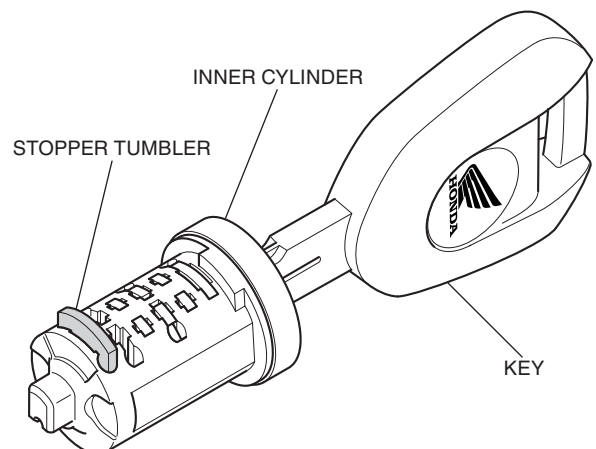

20. Apply grease to the shaded areas as shown.

- **Apply to the tumbler and to the outer circumference of the inner cylinder.**
- **Only use the supplied grease.**

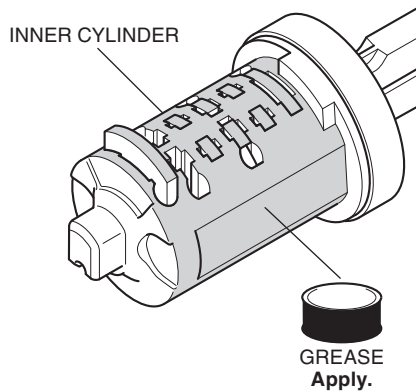

21. Install the inner cylinder by sliding the stopper tumbler along the slide guide while rotating it.

- **If the inner cylinder cannot be inserted, confirm that no tumblers other than the stopper tumbler are projecting.**

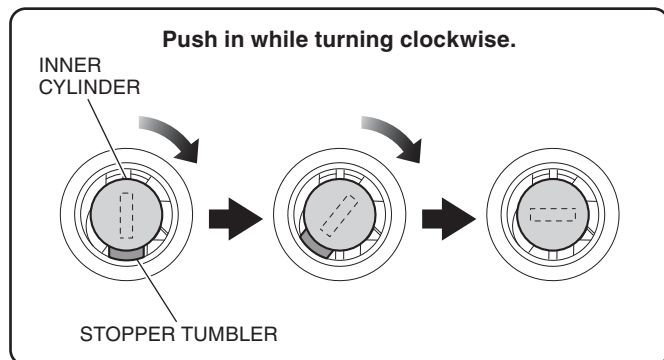
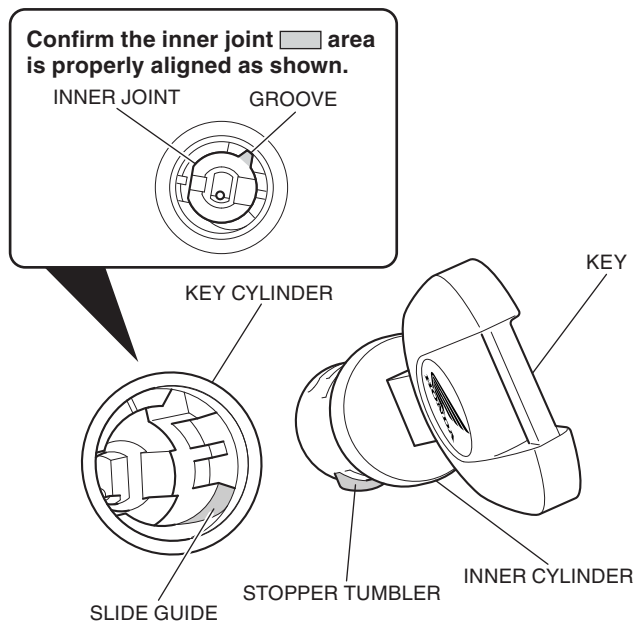

22. Pull out the key and check that the inner cylinder does not come out.

23. Install the inner cylinder on the opposite side in the same manner.

## USING THE PANNIERS

### How to Open the Panniers

1. Remove the cap as shown.

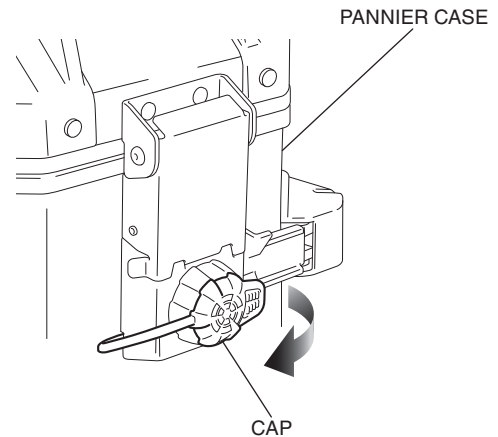

2. Insert the key and release the lock by turning the key clockwise.

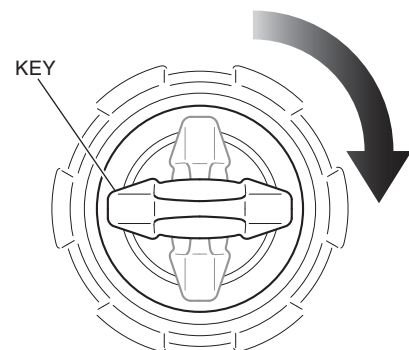

3. Pull the hinge up as shown.

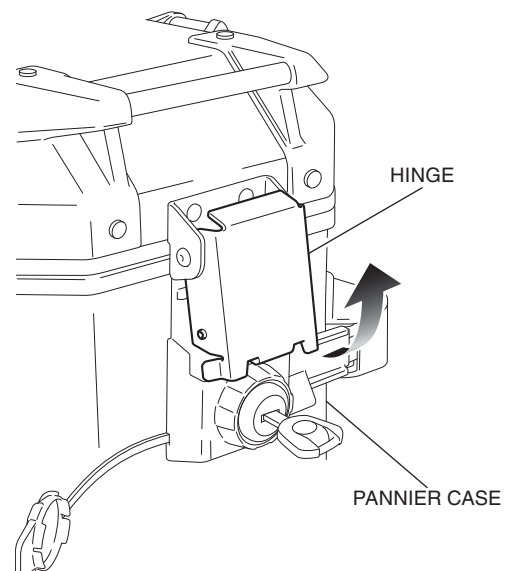



4. Release the hinge from the hinge bar as shown.

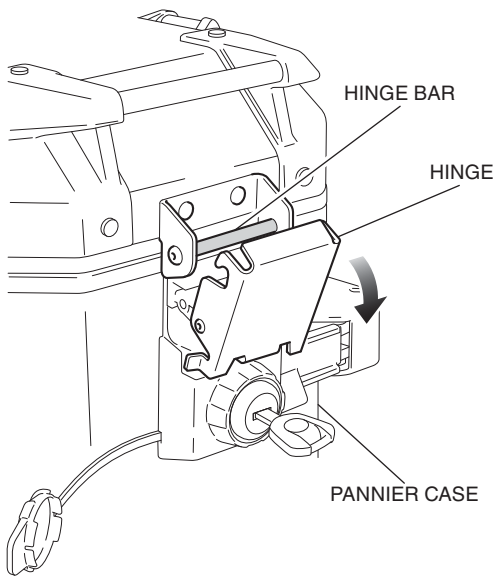

5. Open the lid as shown.

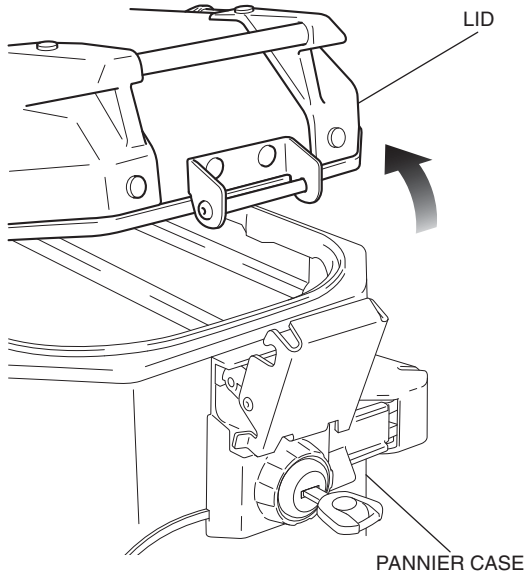

## How to Close the Panniers

1. Close and lock the pannier case in reverse order of opening.
  - **Be careful not to have stored items pinched when the pannier case is closed.**

## How to Install the Panniers

1. Install the rear carrier (sold separately).
  - **Perform this step on CRF1100A/D only.**
2. Install the pannier stay (sold separately).
3. Install the left pannier case as shown.
  - **First install the two bosses, then install the two cams.**
  - **Installation can be done when the key is in lock or unlock position.**
  - **When the pannier case can not be installed, check the lever for proper installation.**

<Left side>

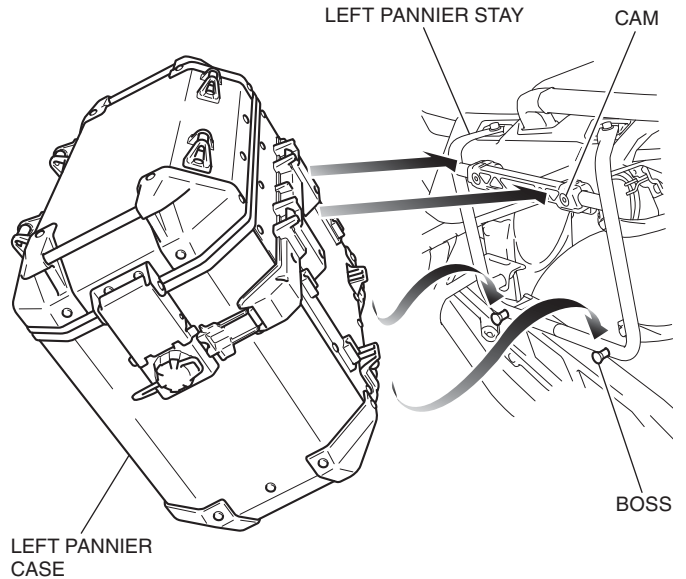

4. Make sure that the indicators in front and behind the pannier stay are green.
  - **When the indicator is red, the pannier case is not securely installed. Remove the pannier case and reinstall it.**

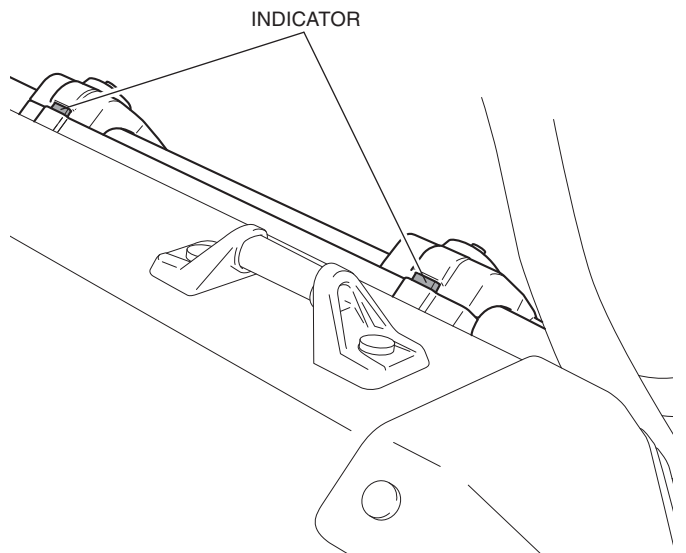

5. If the key is inserted, pull it out and install the cap.
6. Check that the left pannier case is installed securely by shaking the left pannier case taking care not to knock the motorcycle down.
  - **The left pannier case can come off during riding unless it is mounted securely.**

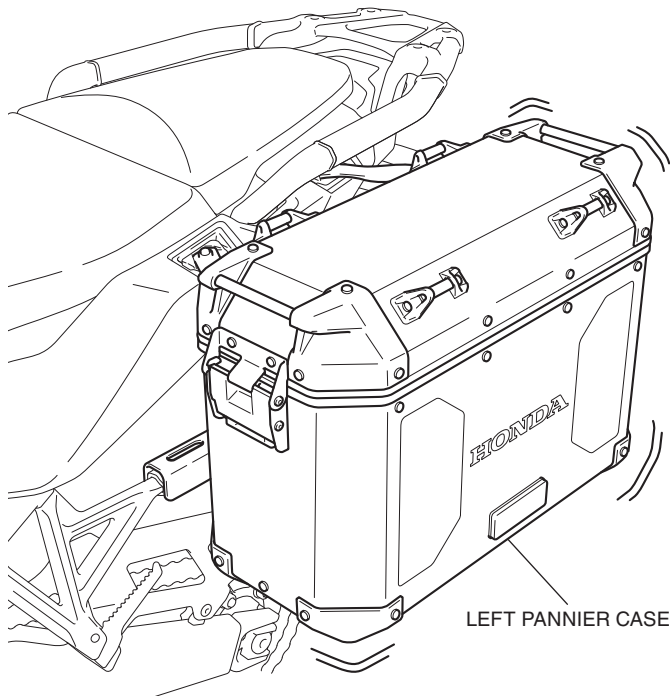

7. Install the right pannier case in the same manner as the left side.

### How to Remove the Panniers

1. Remove the cap as shown.

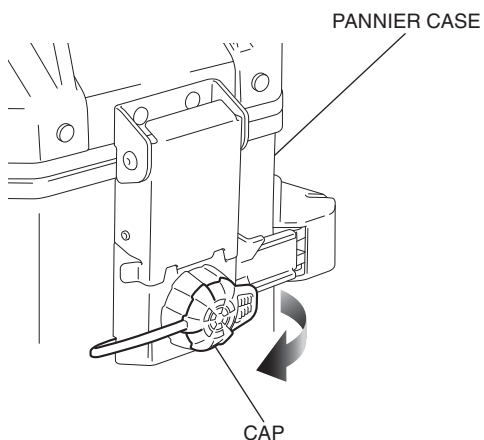

2. Insert the key and release the lock by turning the key clockwise.

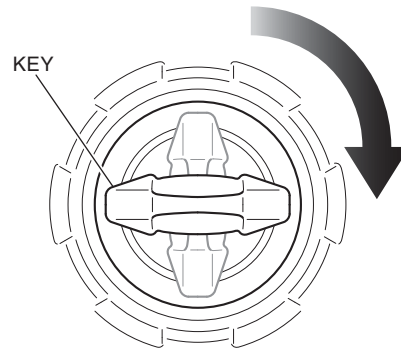

3. Pull the lever as shown.
  - **Make sure that the pannier stay indicator is red after pulling the lever.**

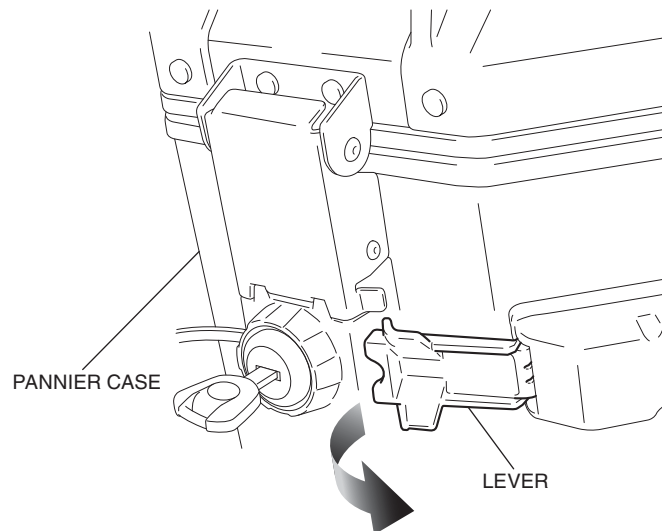

4. Remove the panniers in the reverse order of installation.

### How to Store the Pannier Inner bag

1. Open the pannier case and store the pannier inner bag.
2. Close the pannier case.
  - **Be careful not to have the stored item pinched when the pannier case is closed.**