



INSTALLATION INSTRUCTIONS

Accessory	Application	Publication No.
SADDLEBAGS (Wave key type) P/N 08L70-MKA-A30	After '15 NC700X/XD, NC750X/XD	MII 15736
		Issue Date
		March 2016

Honda Dealer: Please give a copy of these instructions to your customer.

PARTS LIST

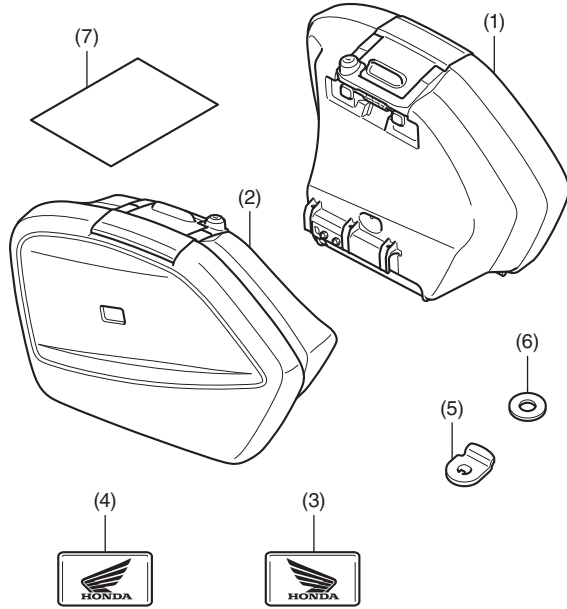

No.	Description	Qty
(1)	Right saddlebag	1
(2)	Left saddlebag	1
(3)	Right emblem	1
(4)	Left emblem	1
(5)	Cam plate	2
(6)	Washer	2
(7)	Installation Instruction URL	1

SADDLEBAG SUPPORT STAY / REAR CARRIER Sold separately

- This is necessary depending on the model, and the kit is different for each model.

SADDLEBAGS (Wave key type) Sold separately

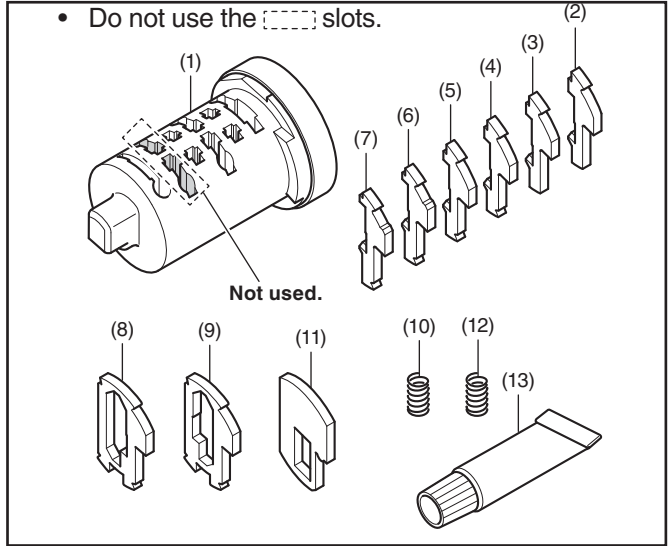

No.	Description	Qty
(1)	Inner cylinder	1
(2)	No.1 tumbler	6
(3)	No.2 tumbler	6
(4)	No.3 tumbler	6
(5)	No.4 tumbler	6
(6)	No.5 tumbler	6
(7)	No.6 tumbler	6
(8)	Sub-lock tumbler A	1
(9)	Sub-lock tumbler B	1
(10)	Spring (Silver)	13
(11)	Stopper tumbler	2
(12)	Stopper spring (Black)	2
(13)	Grease	1

1 KEY BODY PARTS Sold separately

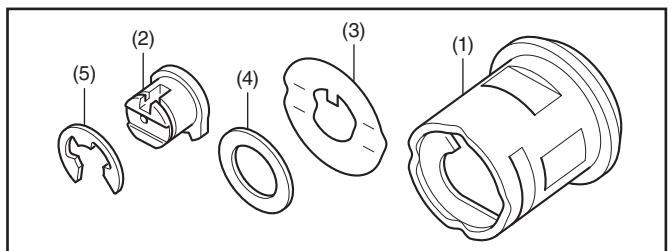

No.	Description	Qty
(1)	Cylinder body	1
(2)	Inner joint	1
(3)	Spring plate	1
(4)	Washer (Not used.)	1
(5)	E-ring	1

TOOLS AND SUPPLIES REQUIRED

Long nose pliers
Shop towel
Isopropyl alcohol
Torque wrench

TORQUE INFORMATION

Refer to the Service Manual for the torque values of the removed parts.

MAXIMUM LOADING CAPACITY

- The weight of the cargo must not exceed the following maximum loading capacity:

Maximum Loading Capacity	
Right saddlebag	6.0 kg (13.2 lb)
Left pannier	6.0 kg (13.2 lb)

< Notes regarding the key cylinder >

- This product is used to assemble a key cylinder matching the motorcycle key by combining six types of tumblers.
- When this key cylinder is installed in a box or similar equipment, the installed equipment can be operated with the motorcycle key.

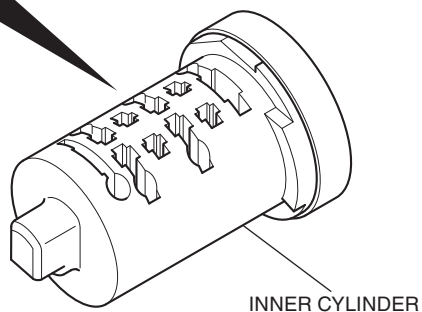
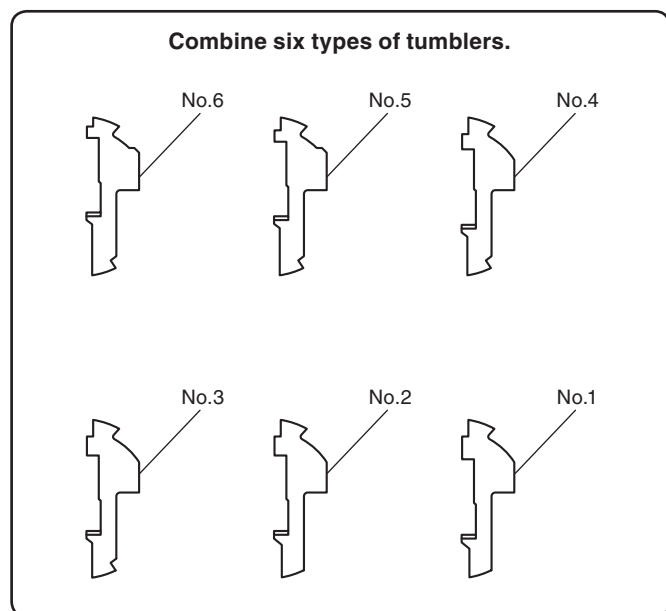

INSTALLATION

- As two key cylinders are required, make two cylinders using following procedures.
- The two sub-lock tumbler types shown are provided.
 - The  part has a different slot for each of the two sub-lock tumbler types.
 - As the tumblers are small, keep them in the bag until they are used.

SUB-LOCK TUMBLER A

SUB-LOCK TUMBLER B

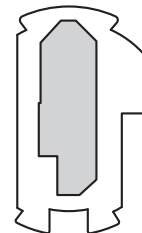
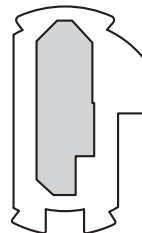

The stopper tumbler will be used later.



- The six tumbler types shown are provided.
 - The  part has a different width for each of the six tumbler types.
 - As the tumblers are small, keep them in the bag until they are used.

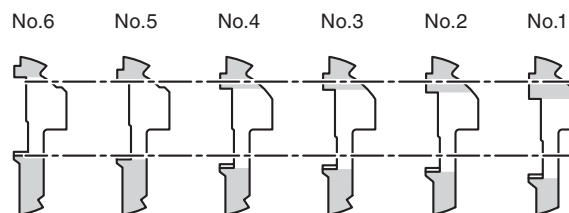

3. Install the tumblers and springs (silver) as shown.

- **First install four No.1 tumblers.**
- **Note the installed tumbler to below chart.**

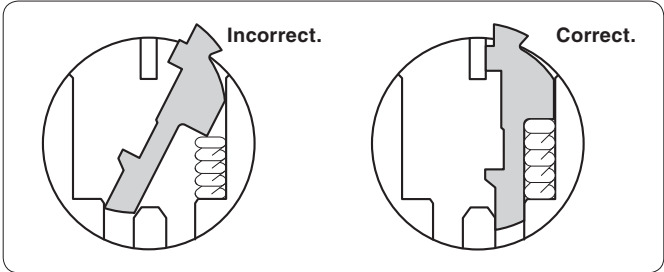
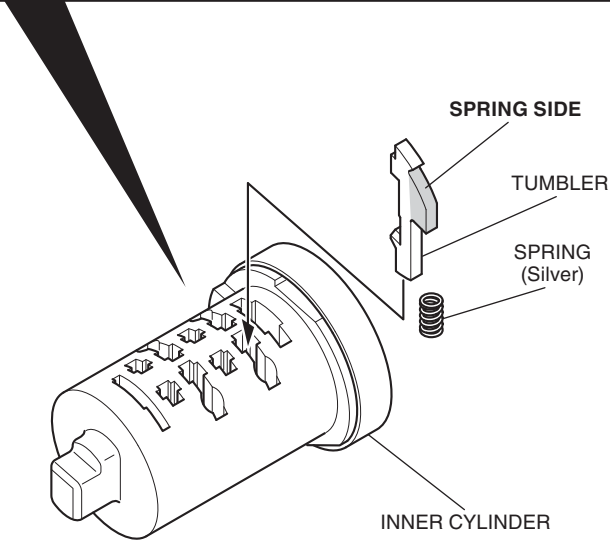
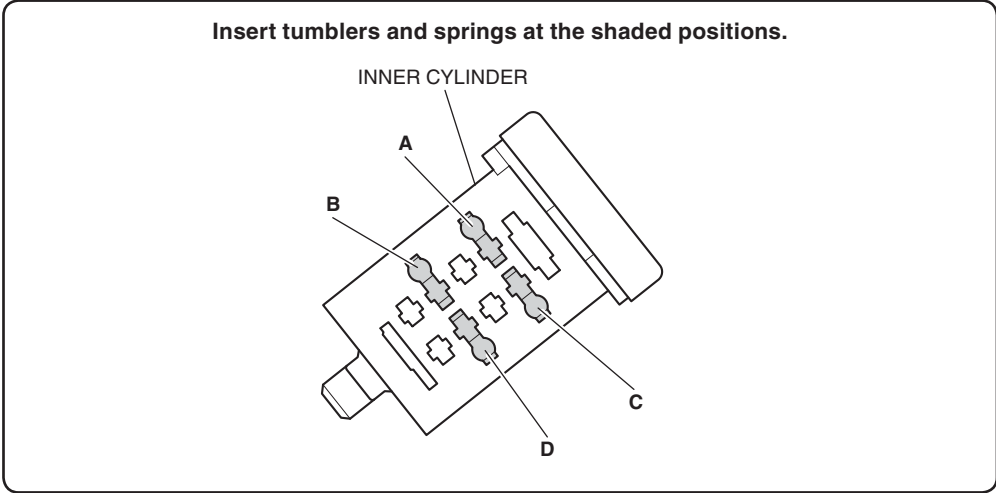

	Position A	Position B	Position C	Position D
No.1 tumbler				
No.2 tumbler				
No.3 tumbler				
No.4 tumbler				
No.5 tumbler				
No.6 tumbler				

4. Insert the key as shown.
- **Lightly press down on the tumblers from above, then insert the key.**

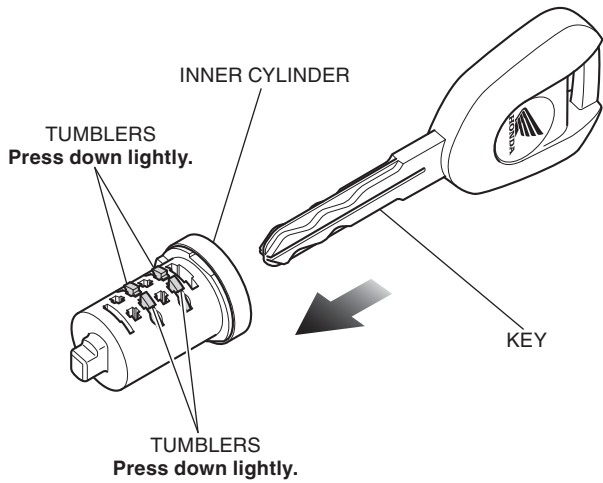

5. Confirm that some tumblers are projecting. Mark the positions of the projected tumblers.
- **The positions where tumblers project and the projecting height differ according to the key.**

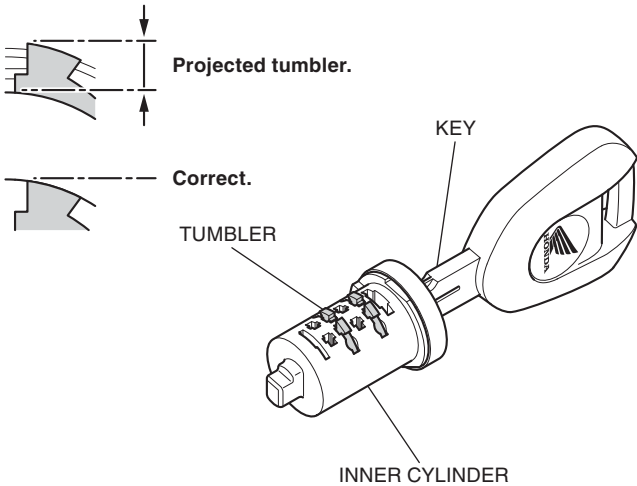

6. Press down lightly on the tumbler, pull the key out.
- **The tumbler spring may jump out when the tumbler is not pressed down lightly.**

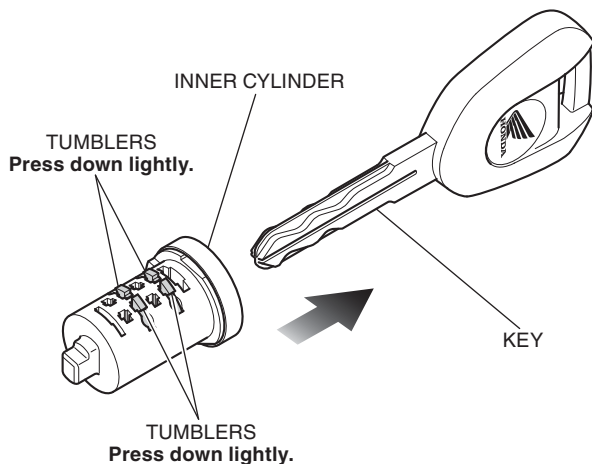

7. Pull out the projecting tumbler(s).
- **Leave the spring(s) installed.**

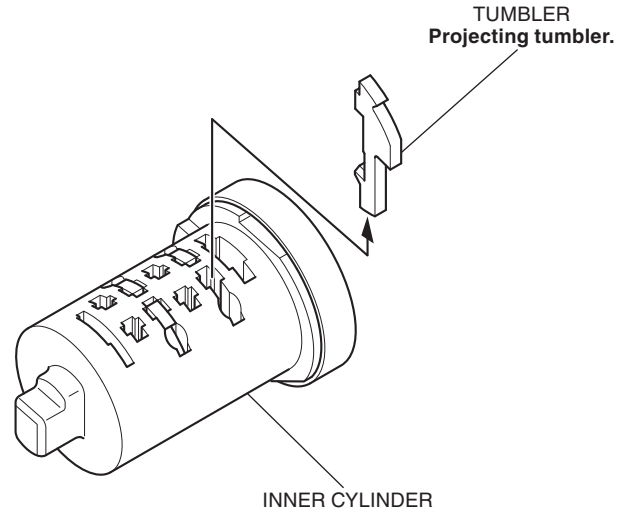

8. Insert a different tumbler(s) at the marked positions.
- **Use a tumbler of the next number up.**

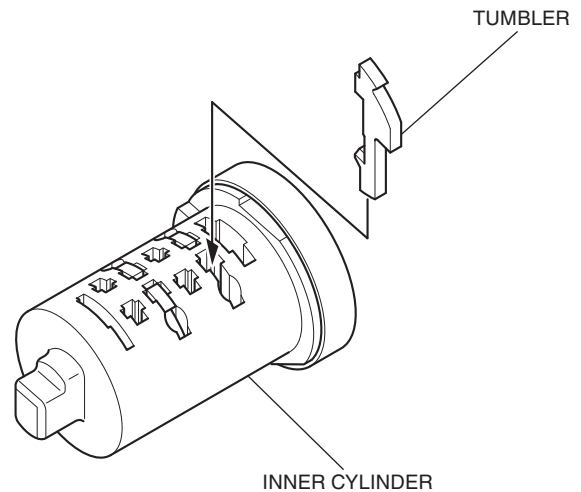

9. Repeat steps 4 to 8, inserting different tumblers at the marked positions until no tumblers are projected.
- **Lightly press down on the tumblers from above, then insert the key.**

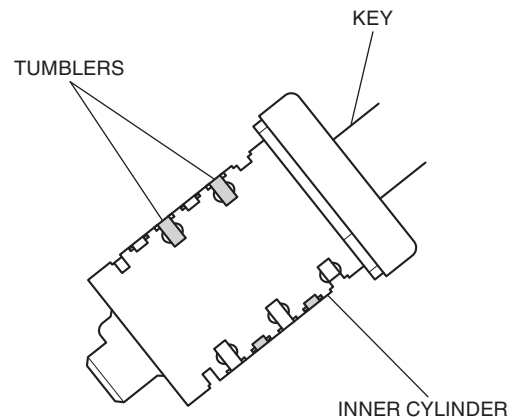

10. Install the tumblers and springs (silver) to the reverse side inner cylinder as shown.

- **First install two No.1 tumblers.**

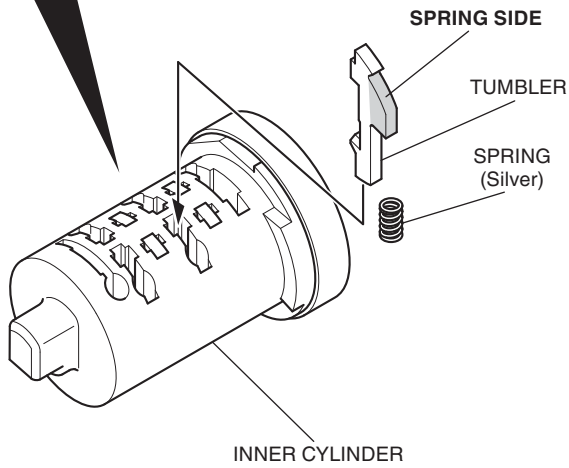
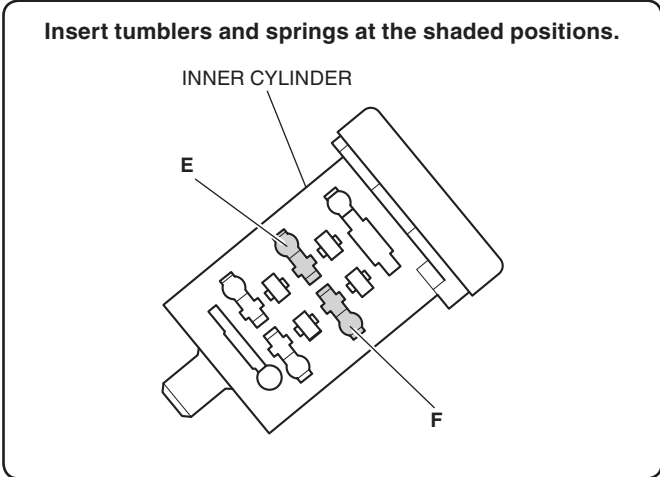

- **Note the installed tumbler to below chart.**

	Position E	Position F
No.1 tumbler		
No.2 tumbler		
No.3 tumbler		
No.4 tumbler		
No.5 tumbler		
No.6 tumbler		

11. Use steps 4 through 8 to assemble the reverse side inner cylinder in the same manner.

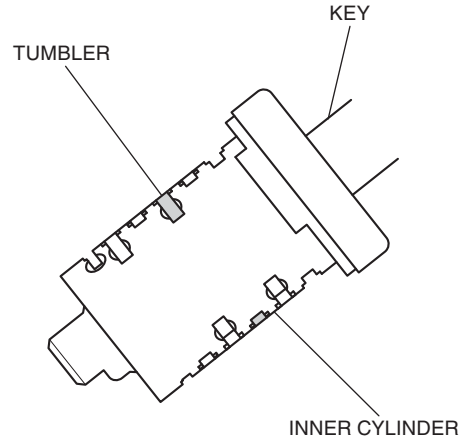

12. Install the sub-lock tumbler as shown.

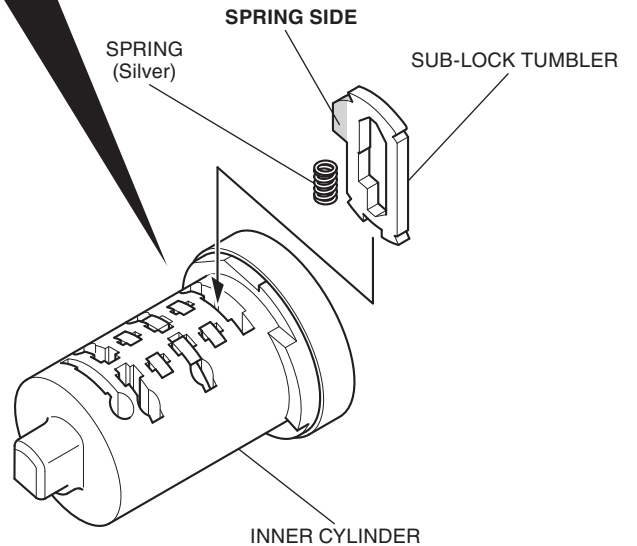
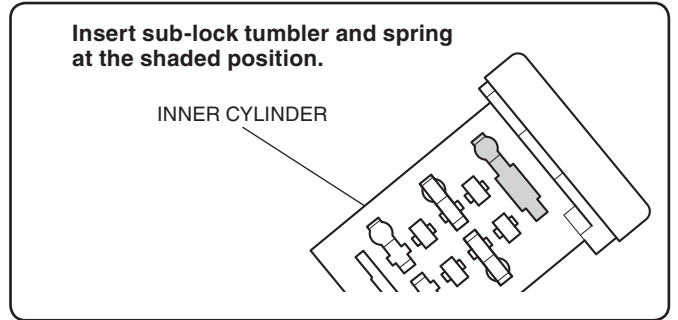

- **Note the installed tumbler to below chart.**

Sub-lock tumbler A	
Sub-lock tumbler B	

13. Confirm that sub-lock tumbler is not projecting.
- **If the tumbler is projected, change the another sub-lock tumbler and recheck.**

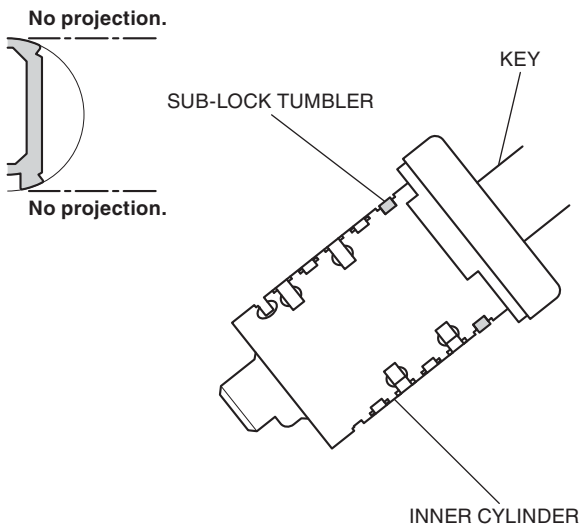

14. Insert the assembled inner cylinder into the cylinder body as shown.
- **Confirm the inner cylinder turns clockwise smoothly.**

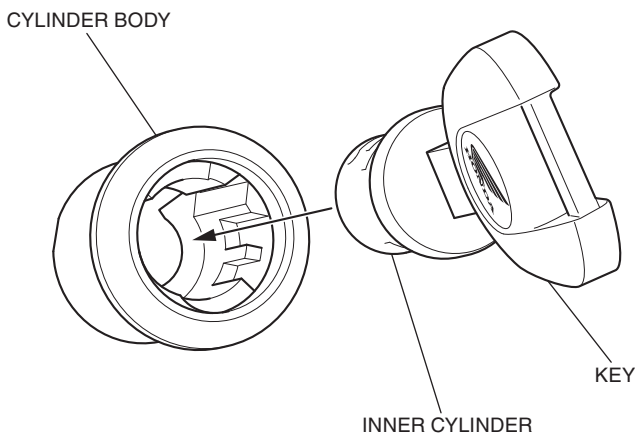

15. Pull out the inner cylinder.

16. Press down lightly on the tumblers and pull out the key.

17. Install the stopper tumbler and stopper spring (black) as shown.

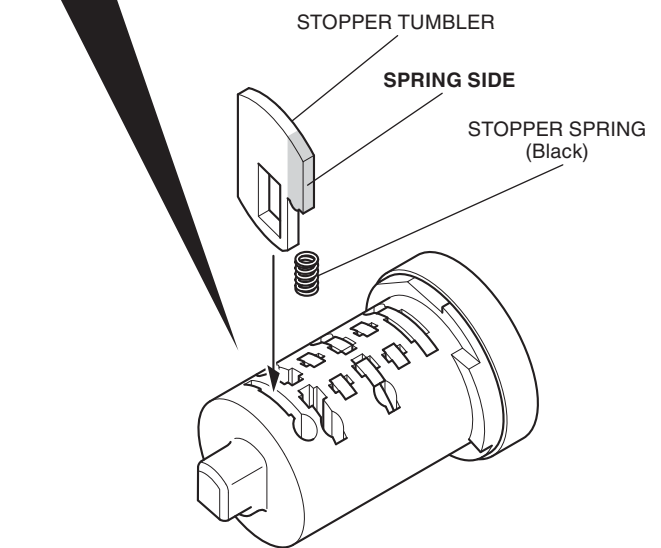
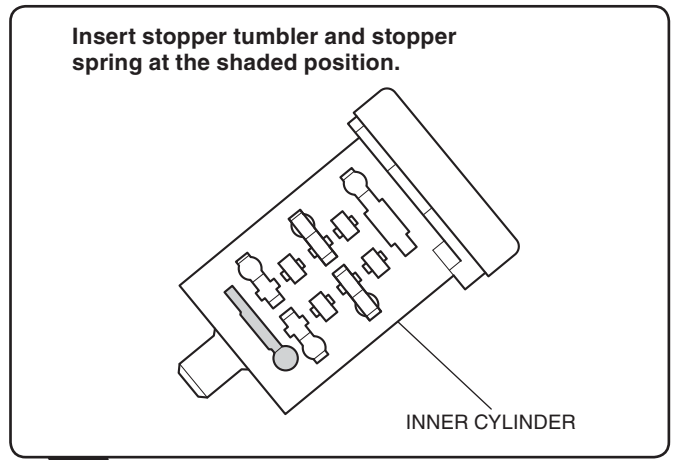

18. Insert the key as shown.

- **Lightly press down on the tumblers from above, then insert the key.**
- **Confirm that the stopper tumbler jumps out.**

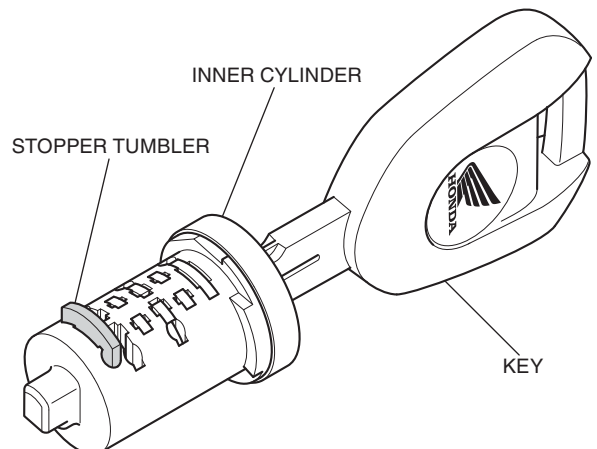

19. Apply grease to the shaded areas as shown.
- Apply to the inner joint, tumbler and to the outer circumference of the inner cylinder.
 - Only use the supplied grease.

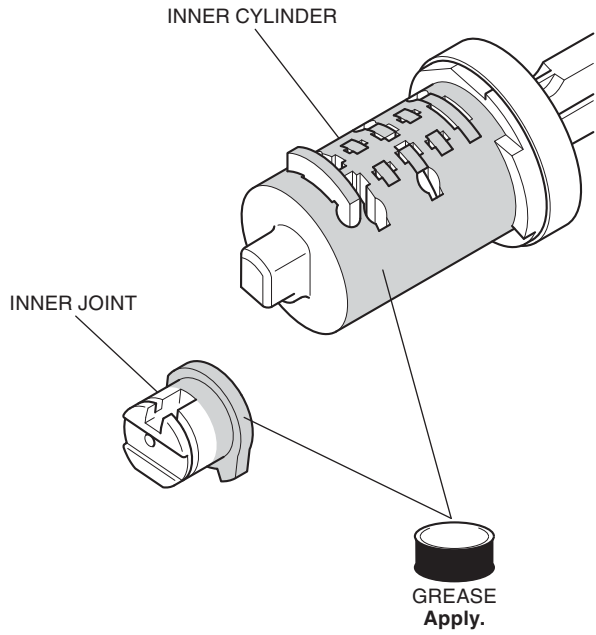

20. Install the inner joint into the cylinder body as shown.

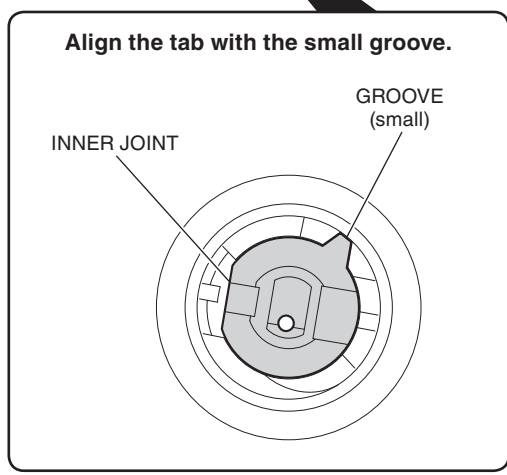
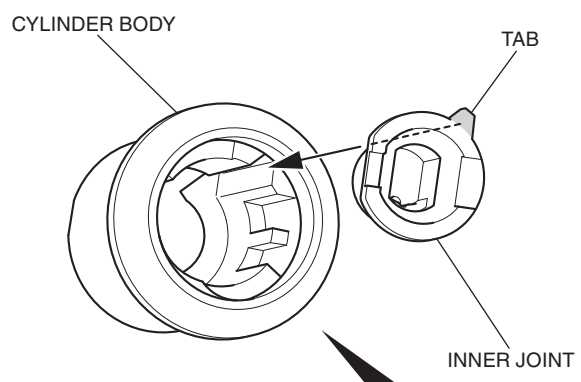

21. Install the inner cylinder by sliding the stopper tumbler along the slide guide while rotating it.
- If the inner cylinder cannot be inserted, again confirm that no tumblers other than the stopper tumbler have jumped out.

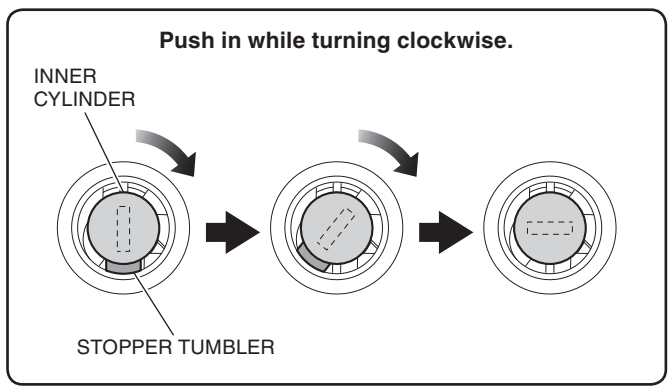
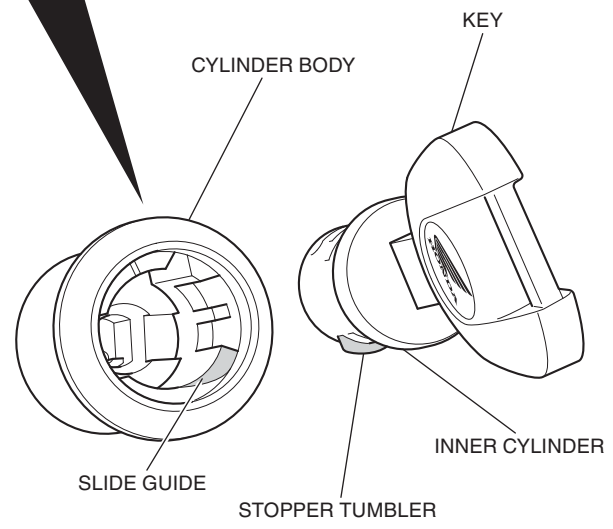
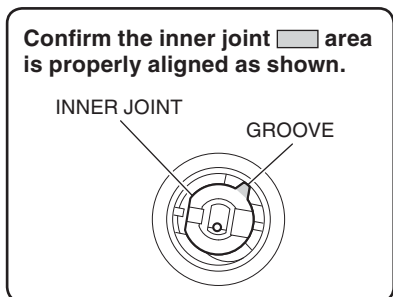

22. Draw out the key and check that the inner cylinder does not come out.

23. Install the cylinder body as shown.
- Only use the supplied grease.

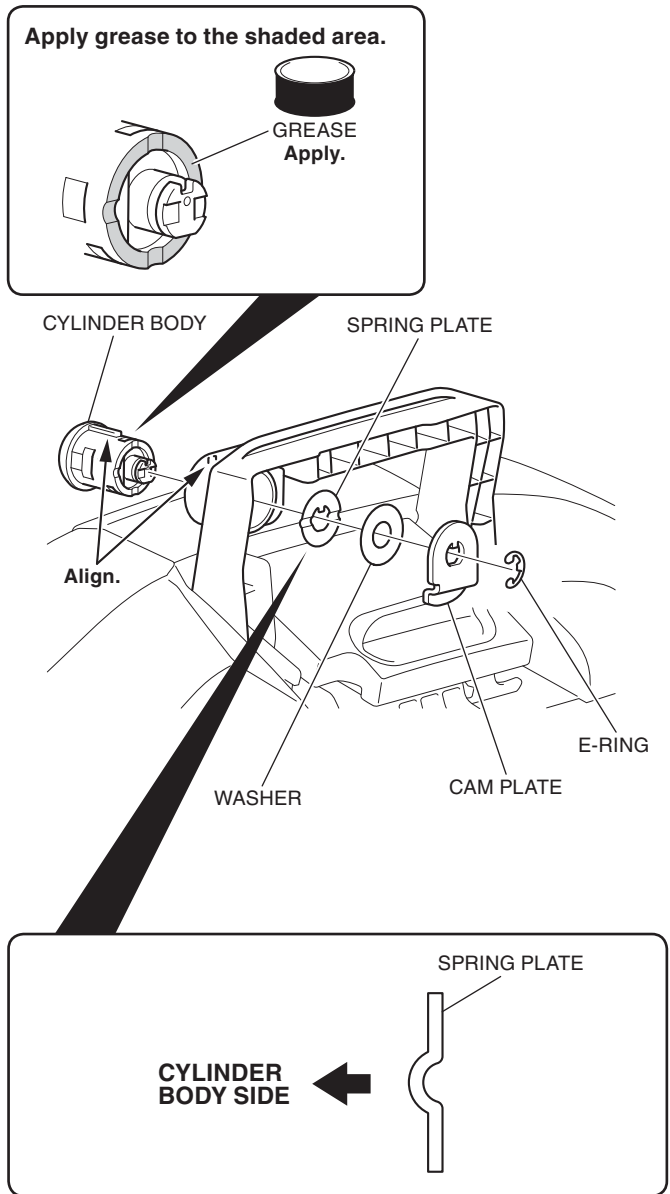

24. Turn the key and check the key lock mechanism as shown.
- If the key lock mechanism does not function properly, reassemble the key cylinder.

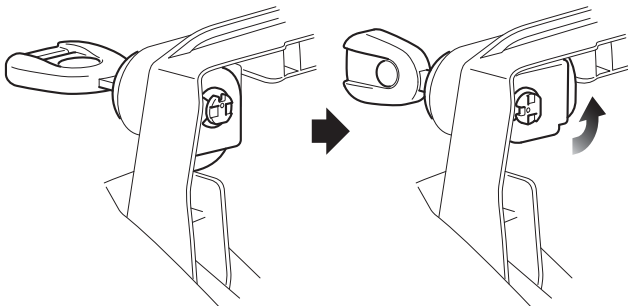

How to Install the Emblem

1. Attach the left emblem in the position shown.
 - Repeat on the right side.

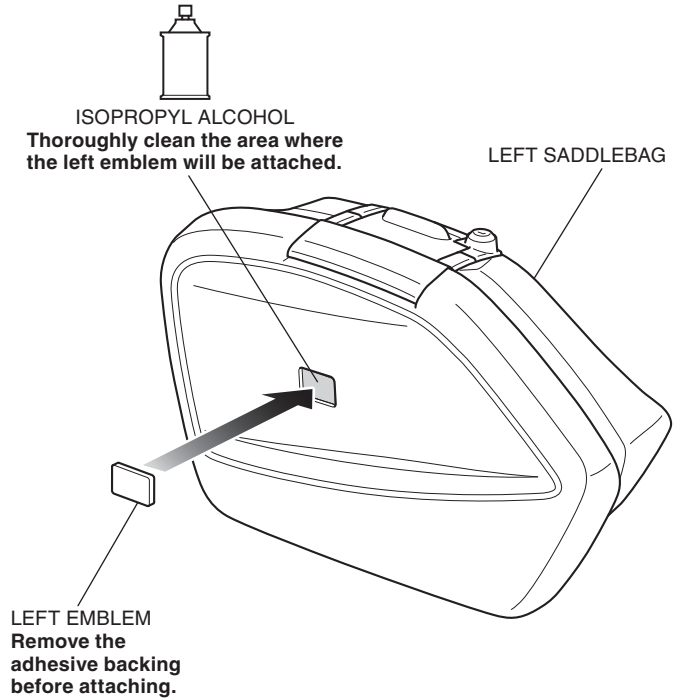

How to Open and Close the Saddlebags

1. Release the lock by turning the key clockwise.

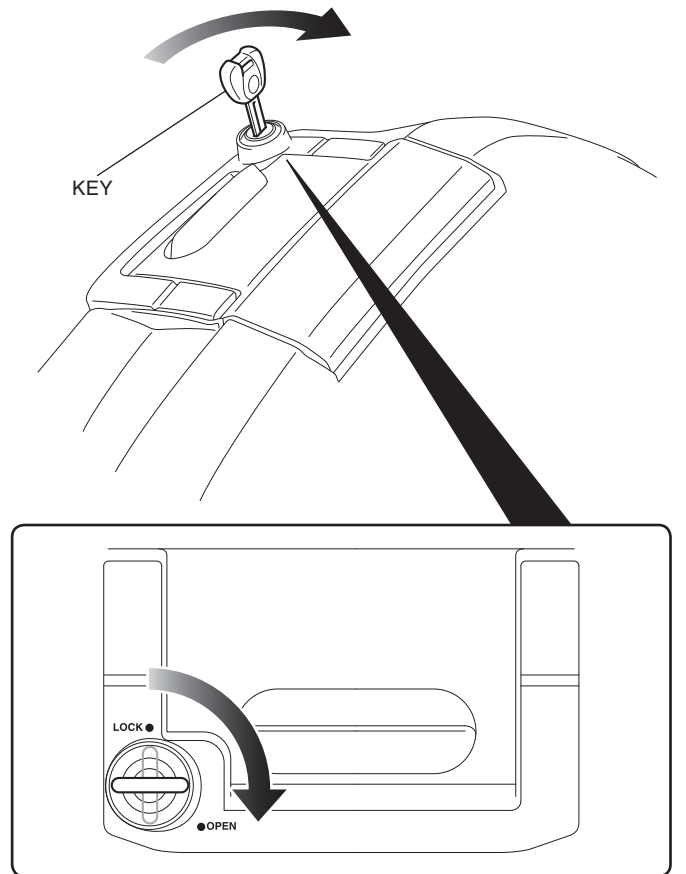

2. With the key turned clockwise, raise the plate lock and release it from the lid.

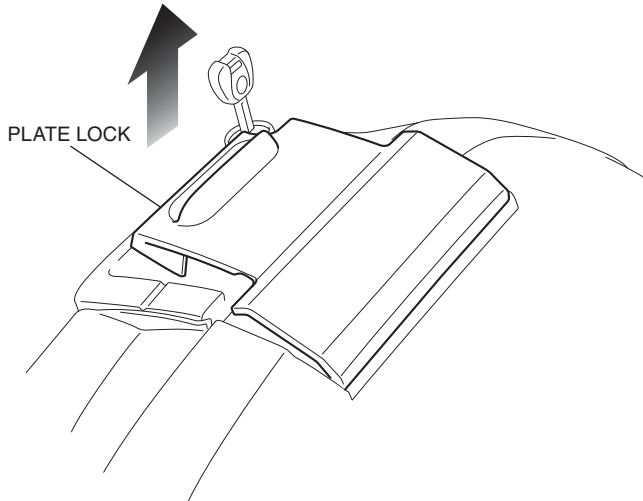

3. Open and close the lid with the plate lock released and raised.

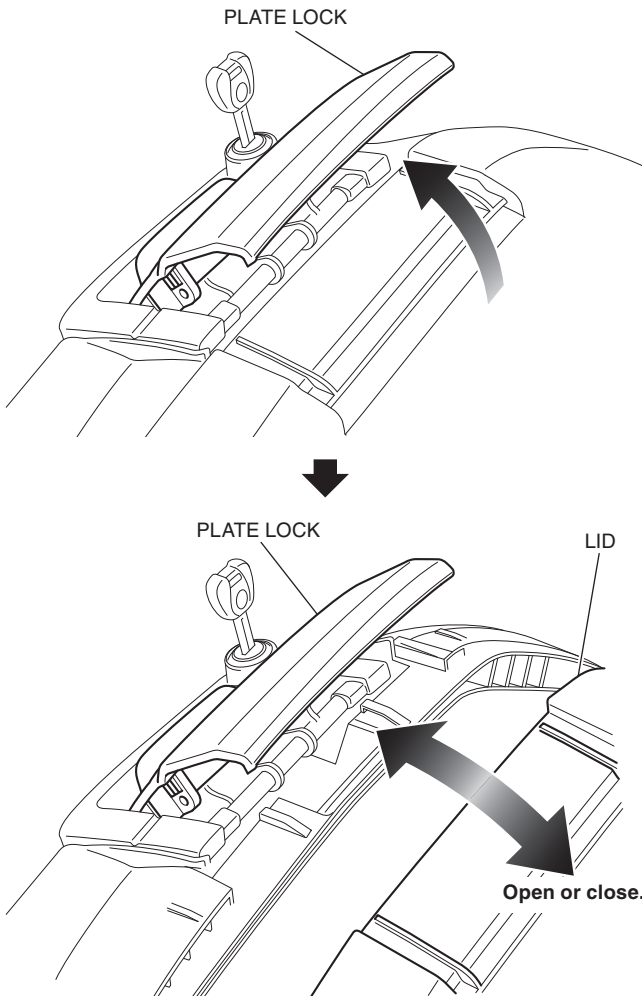

How to Install the Saddlebags

- Illustration shows NC700X type, other types are similar.

1. Release the lock by turning the key clockwise.
2. Attach the left saddlebag to the support stay as shown.

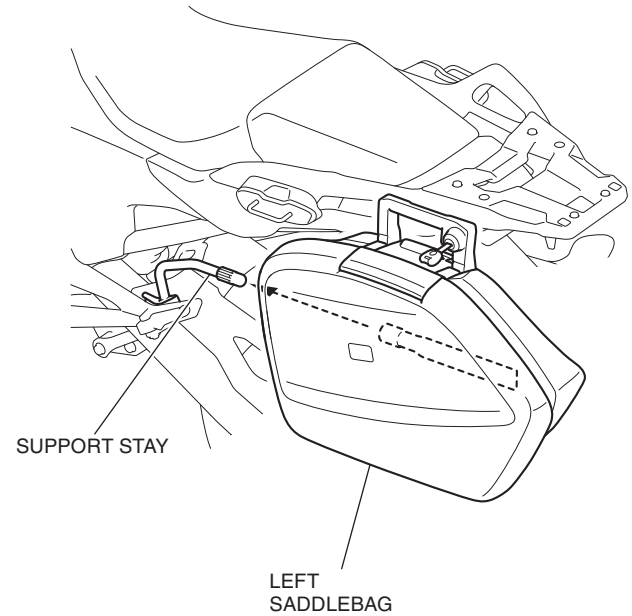

3. Insert the left saddlebag onto the loop hook of the saddlebag stay as shown.

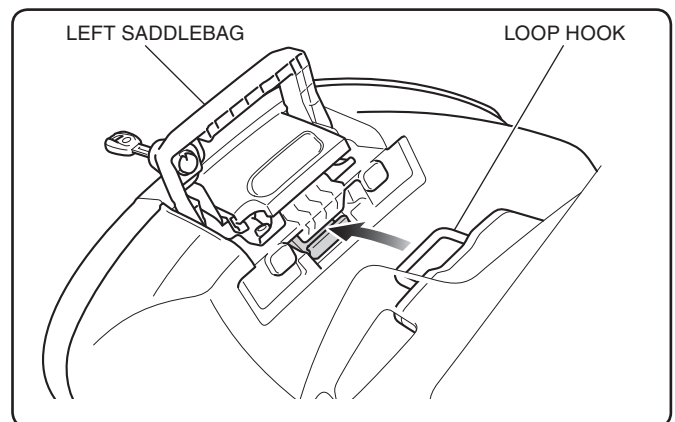

HANDLE LEVER
Install the left saddlebag with the handle lever raised.

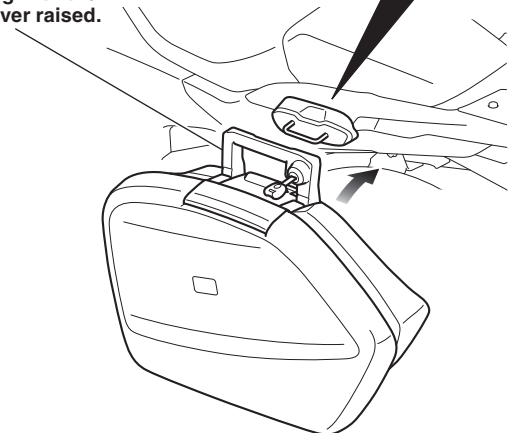

4. Lower the handle lever and lock the left saddlebag by turning the key counterclockwise as shown.

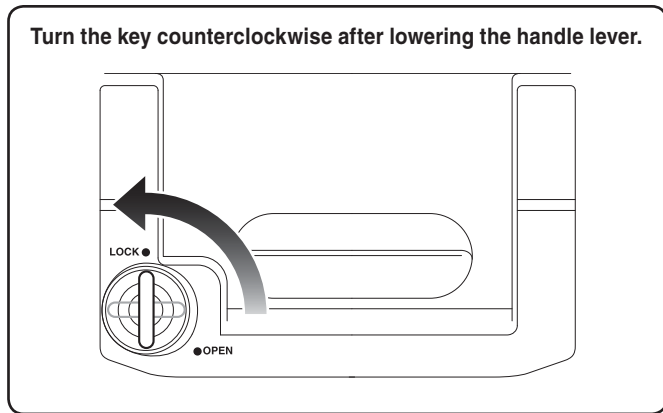

HANDLE LEVER



LEFT
SADDLEBAG

5. Be sure that the handle lever cannot be released and saddlebag is installed securely.
- **The saddlebag can come off while riding if it is not mounted securely.**

HANDLE LEVER

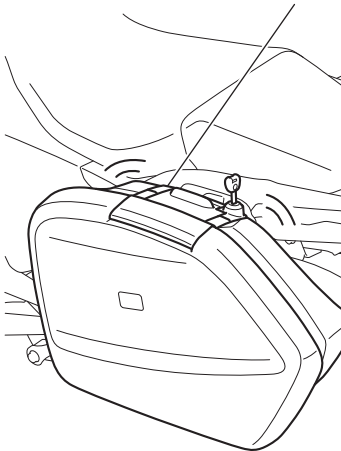

6. Install the right saddlebag in the same manner as the left side.

How to Remove the Saddlebags

1. Remove the saddlebags in the reverse order of installation.