

HONDA

INSTALLATION INSTRUCTIONS

Accessory

RADIATOR SHROUD
P/N 08F93-MGZ-J80

Application

CB500X/XA

Publication No.

MII 14565

Issue Date

May 2013

PARTS LIST

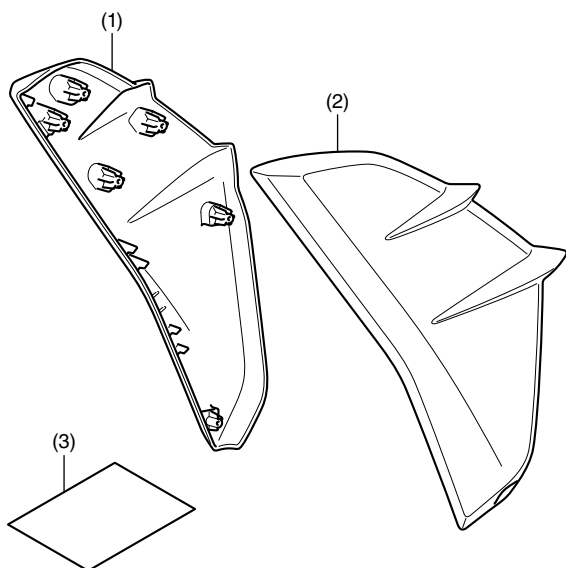

No.	Description	Qty
(1)	Right radiator shroud	1
(2)	Left radiator shroud	1
(3)	Installation Instruction URL	1

TORQUE INFORMATION

Refer to the Service Manual for the torque values of the removed parts.

INSTALLATION

▲ CAUTION

- To prevent burns, allow the engine, exhaust system, radiator, etc., to cool before installing the accessory.

NOTE:

- Take care not to damage the painted surfaces of the motorcycle.
- Reinstall the removed parts on the motorcycle and make sure that wires and harnesses are not pinched.

- Refer to the Service Manual for the motorcycle, remove the seat.

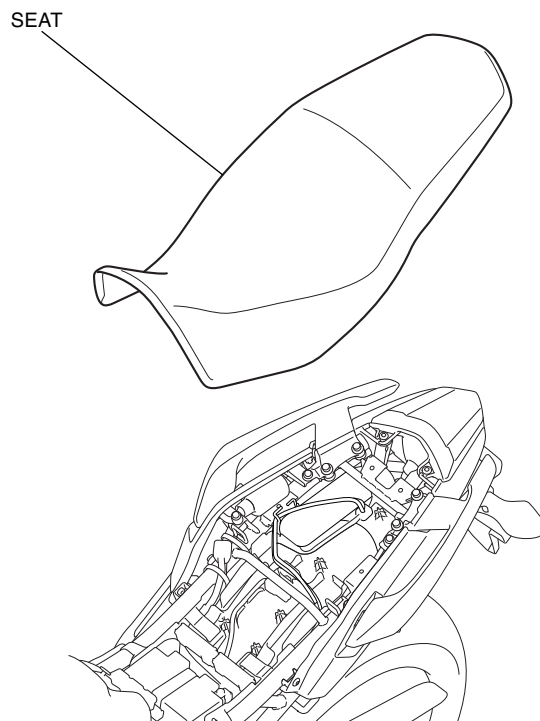

- Refer to the Service Manual for the motorcycle, remove the left and right side covers.

- Repeat on the right side.

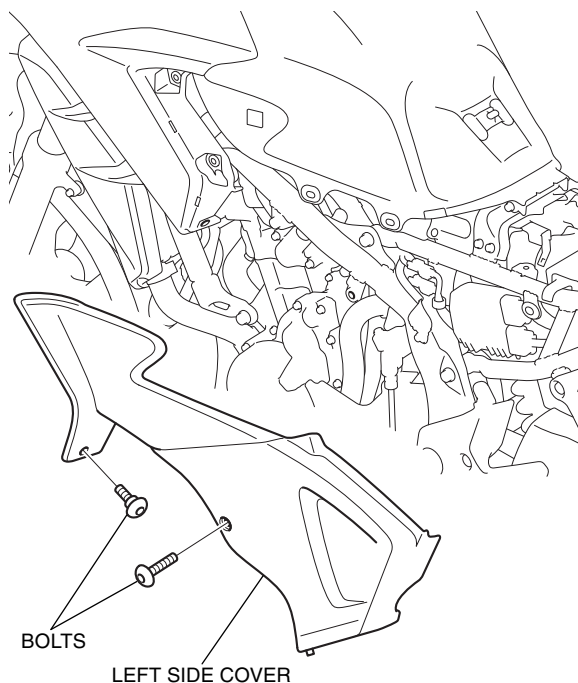

3. Refer to the Service Manual for the motorcycle, remove the left and right shrouds.

- Repeat on the right side.

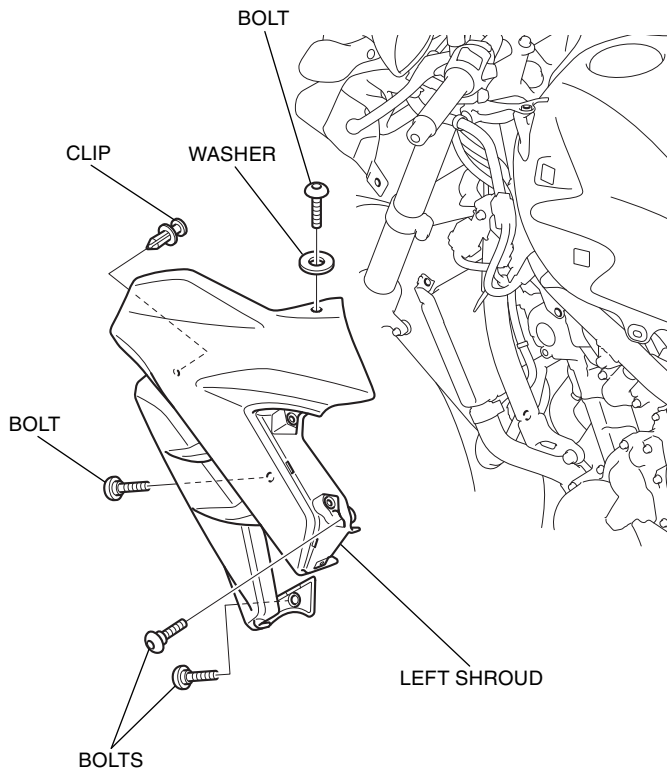

4. Remove the inner panel as shown.

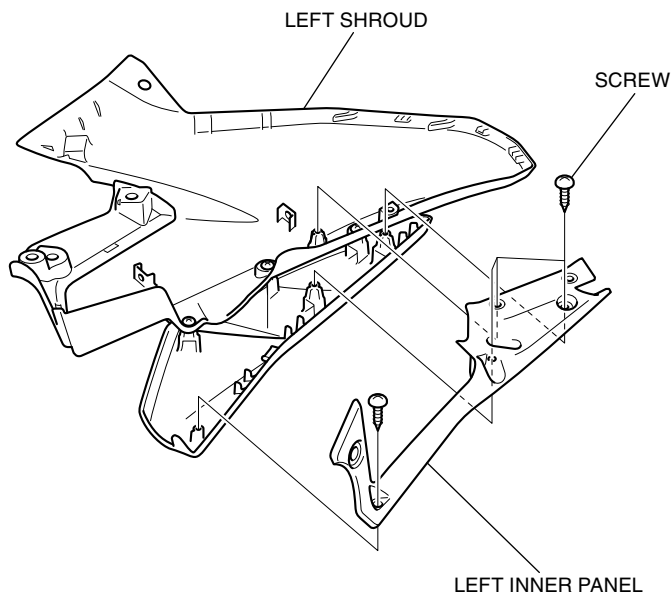

5. Remove the existing radiator shroud as shown.

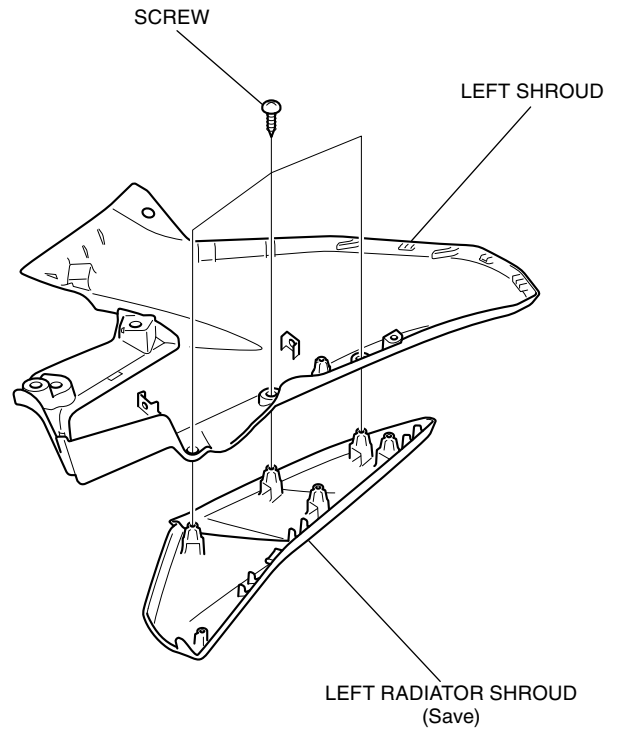

6. Install the accessory left radiator shroud in the reverse order of removal.
7. Use steps 4 through 6 to install the accessory right radiator shroud in the same manner.
8. Install the motorcycle's parts in the reverse order of removal.