

# HONDA

## INSTALLATION INSTRUCTIONS

Accessory  
**HUGGER**  
P/N 08F70-MGZ-J00

Application  
**CBR500R/RA**  
**CB500F/FA**  
**CB500X/XA**

Publication No.  
**MII 14448**  
Issue Date  
**February 2013**

### PARTS LIST

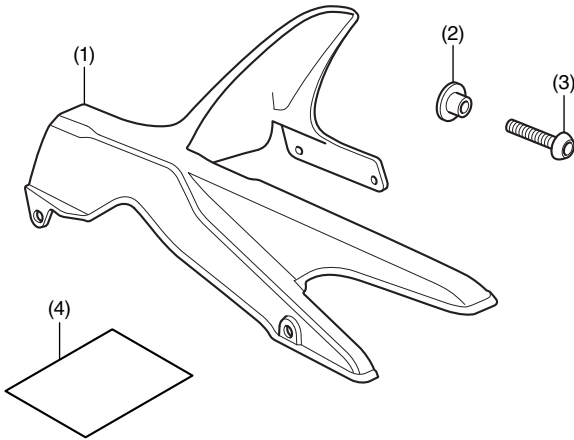

No.	Description	Qty
(1)	Hugger	1
(2)	Collar	2
(3)	6 mm socket bolt	2
(4)	Installation Instruction URL	1

### TOOLS REQUIRED

Hex wrench (5 mm)  
Torque wrench

### TORQUE CHART

Tighten all screws, bolts, and nuts to their specified torque values. Refer to the Service Manual for the torque values of the removed parts.

Item	N·m	kgf·m	lbf·ft
6 mm socket bolt	10	1.0	7

### INSTALLATION

#### NOTE:

- Take care not to damage the painted surfaces of the motorcycle.
- Reinstall the removed parts on the motorcycle and make sure that wires and harnesses are not pinched.
- **Illustrations show CBR500RA type, other types are similar.**

1. Refer to the Service Manual for the motorcycle, remove the left footpeg plate.

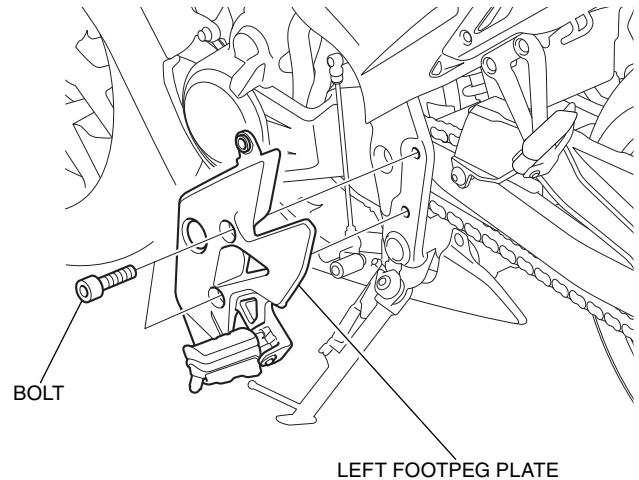

2. Remove the chain case as shown.

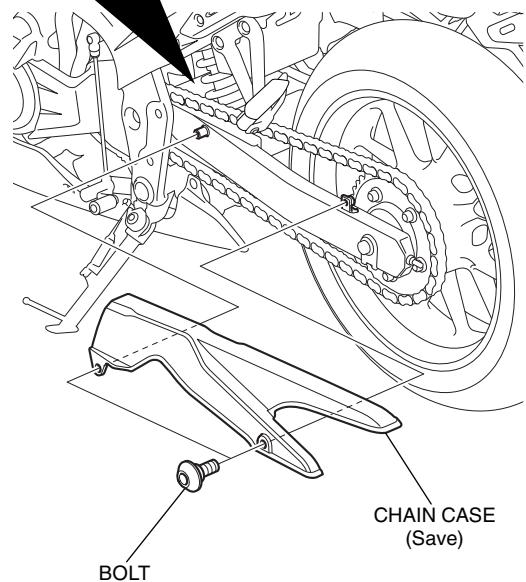
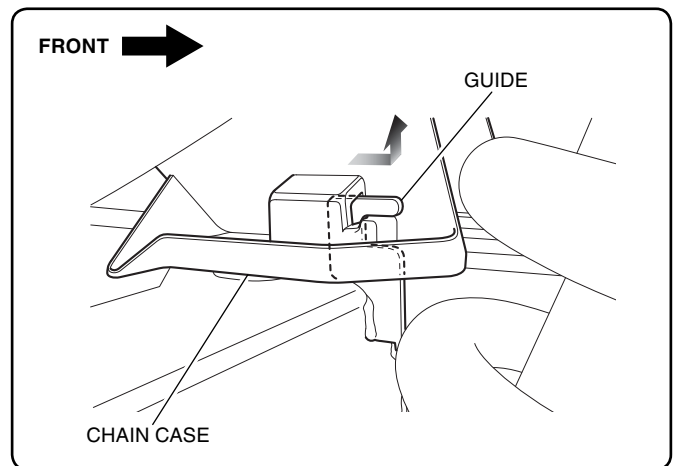

- Remove the bolts from the brake hose guides as shown.

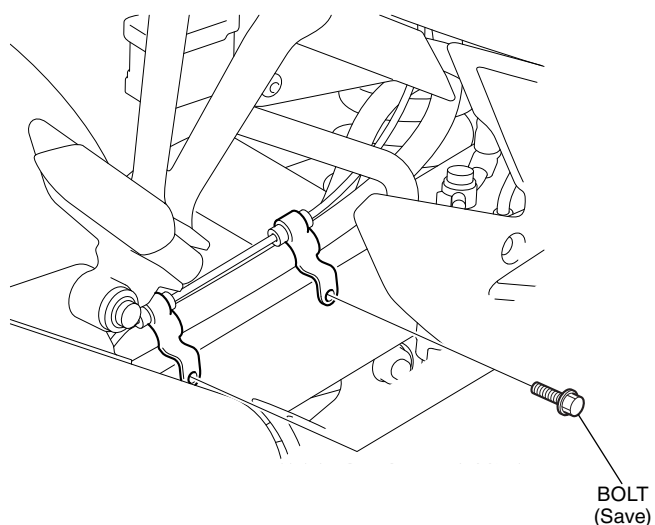

- Loosely install the hugger as shown.

<LEFT SIDE>

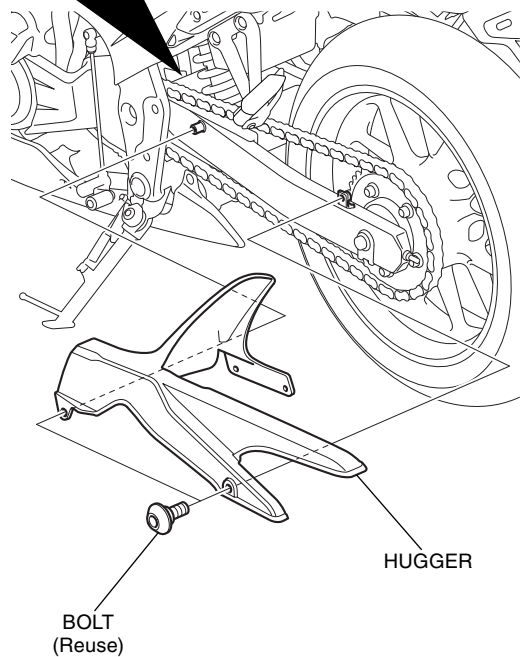
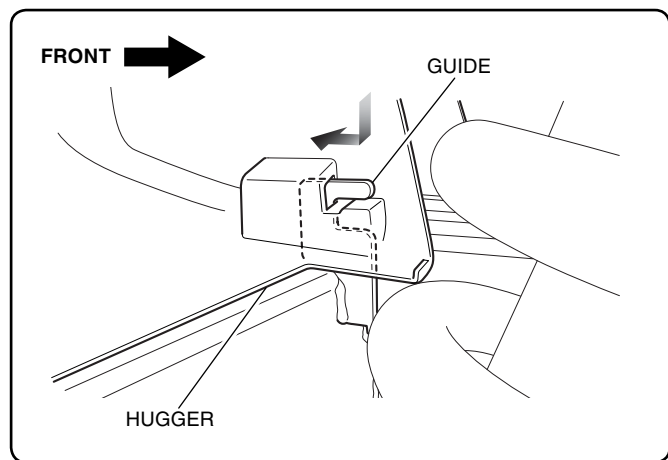

<RIGHT SIDE>

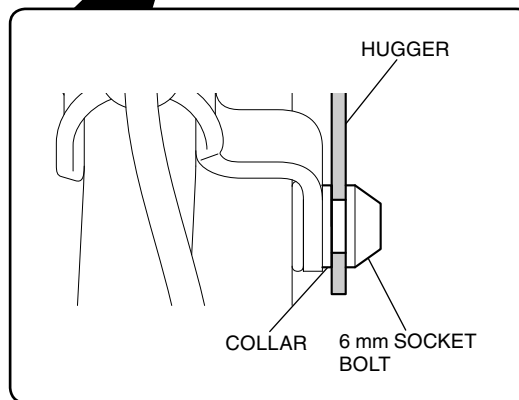
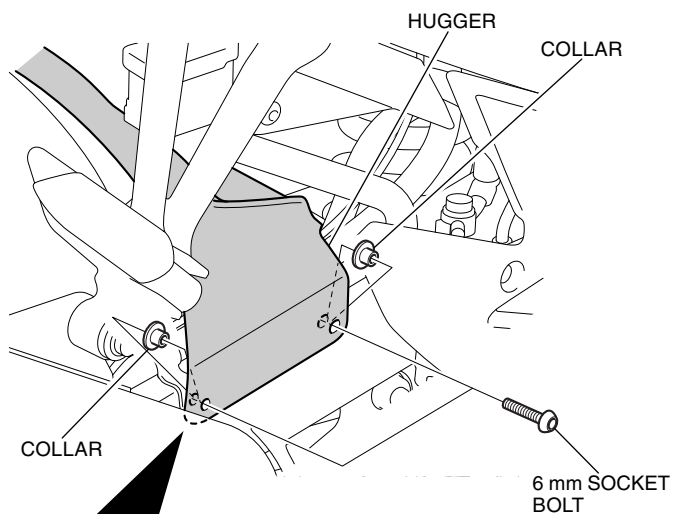

- Tighten all loosely installed hardware to the specifications in the torque chart.
- Install the motorcycle's parts in the reverse order of removal.