

HONDA

INSTALLATION INSTRUCTIONS

Accessory
CB RADIO
P/N 08E83-MKC-A00

Application
GL1800/D/DA

Publication No.
MII 16426
 Issue Date
January 2018

Honda Dealer: Please give a copy of these instructions to your customer.

PARTS LIST

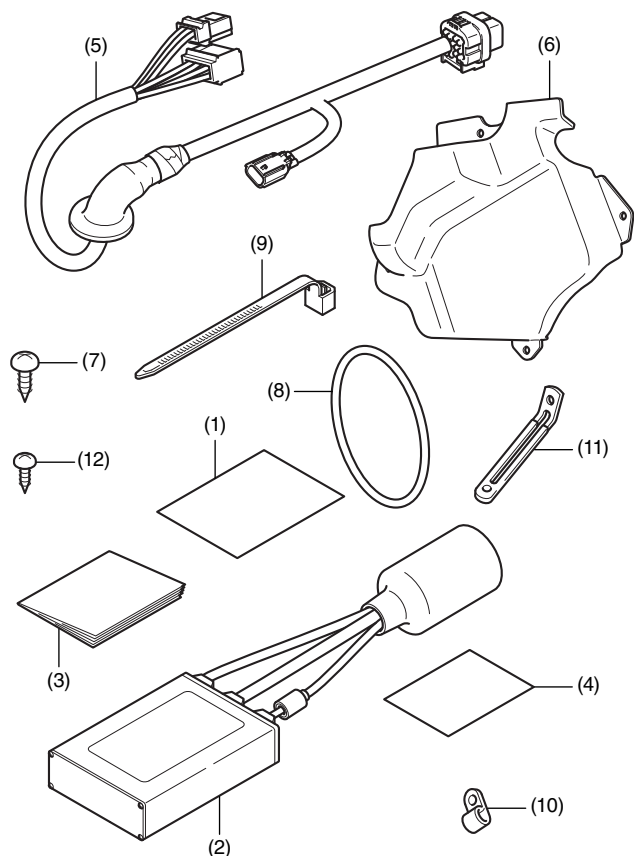

No.	Description	Qty
(1)	Installation Instructions URL	1
(2)	CB main unit	1
(3)	CB radio Owner's Manual	1
(4)	FCC rule book	1
(5)	CB radio sub harness	1
(6)	CB unit cover	1
(7)	5 mm screw	7
(8)	O-ring	1
(9)	Wire tie (long)	2
(10)	Clip	2
(11)	Clamp	1
(12)	4 mm screw	1

CB ANTENNA Sold separately

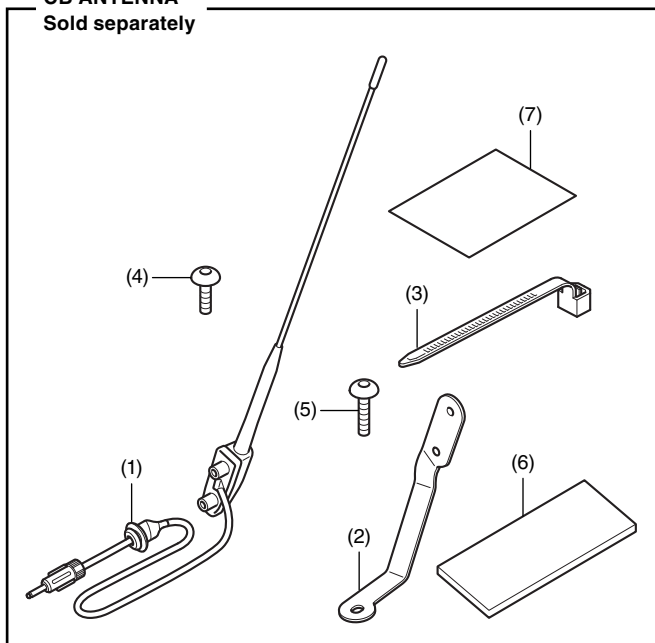

No.	Description	Qty
(1)	CB antenna	1
(2)	CB antenna stay	1
(3)	Wire tie (short)	2
(4)	6 mm socket bolt (short)	2
(5)	6 mm socket bolt (long)	1
(6)	Cushion	1
(7)	Installation Instructions URL	1

TOOLS AND SUPPLIES REQUIRED

- Phillips screwdriver
- Hex wrench (5 mm)
- Power drill
- Drill bit (14 mm)
- Hole saw (16 and 18 mm)
- Dish soap solution (Water:Dish soap / 100:1)
- Snips
- Ruler
- Scissors
- Isopropyl alcohol
- Shop towel
- Torque wrench

TORQUE CHART

Tighten all screws, bolts, and nuts to their specified torque values. Refer to the Service Manual for the torque values of the removed parts.

Item	N·m	kgf·m	lbf·ft
4 mm screw	1	0.1	0.7
5 mm screw	4.2	0.4	3.1
6 mm socket bolt	9	0.9	6.6

INSTALLATION

NOTE:

- Heat the bonding surfaces with a hair dryer if the ambient air temperature is below 70°F (21°C).
- The adhesive reaches full strength in 72 hours. Wait at least 24 hours before riding your motorcycle.
- Disconnect the negative (-) cable from the battery before installing this accessory.
- The memory of the clock will be erased when you disconnect the battery. Reset the clock after reconnecting the battery.
- Reinstall the removed parts on the motorcycle and make sure that the wires and harnesses are not pinched.
- Trim the excess ends off the wire ties after attaching them to the wire harnesses. Do not allow the cut part of the wire tie to interfere with another harness or brake hose.
- For installation of CB switch and CB PTT switch, refer to the installation instructions for the each accessory.

1. Open the left saddlebag lid as shown.
 - **Repeat on the right side.**

<Left side>

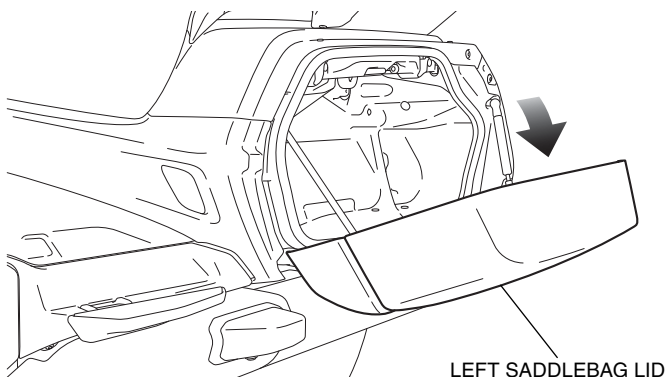

2. Remove the left side cover as shown, and disconnect the battery negative (-) cable.

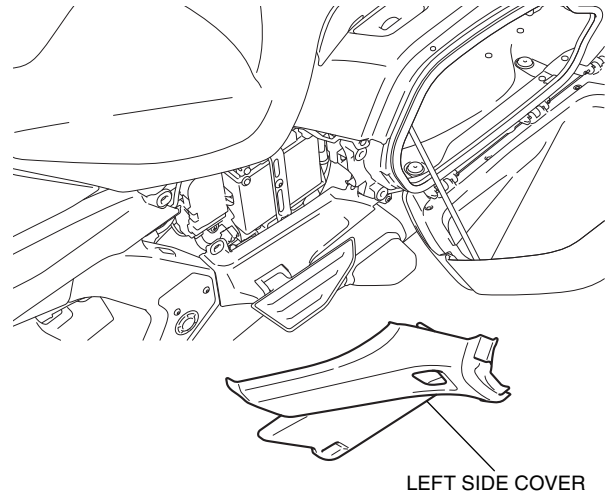

3. Remove the right side cover in the same manner as the left side.
4. Remove the seat as shown.

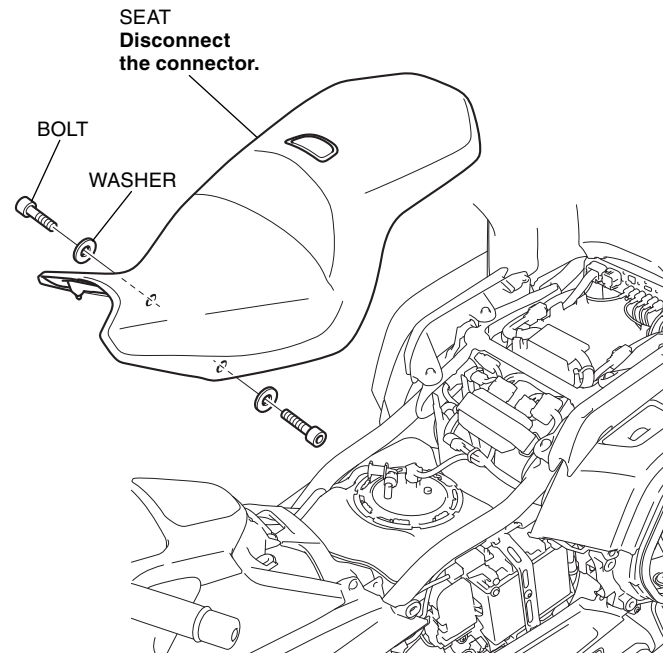

5. Remove the right and left passenger grips as shown.

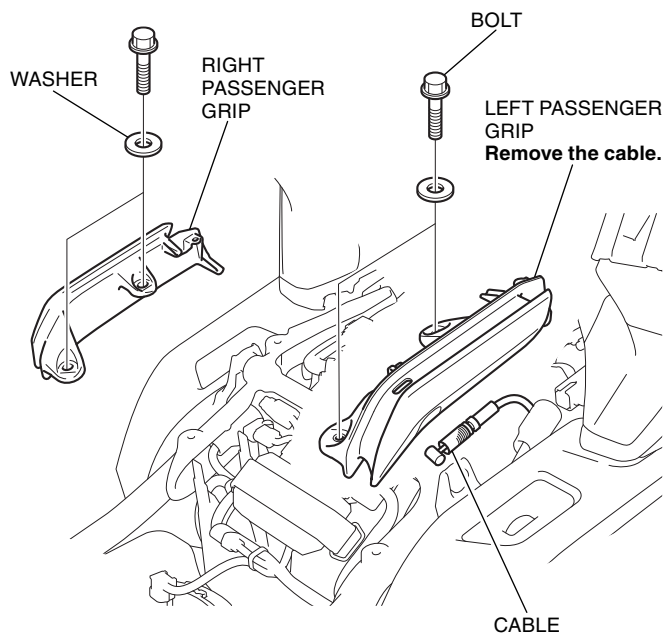

6. Open the rear trunk lid as shown.

- If necessary, refer to the Owner's Manual and use the emergency trunk cable to open the rear trunk lid.

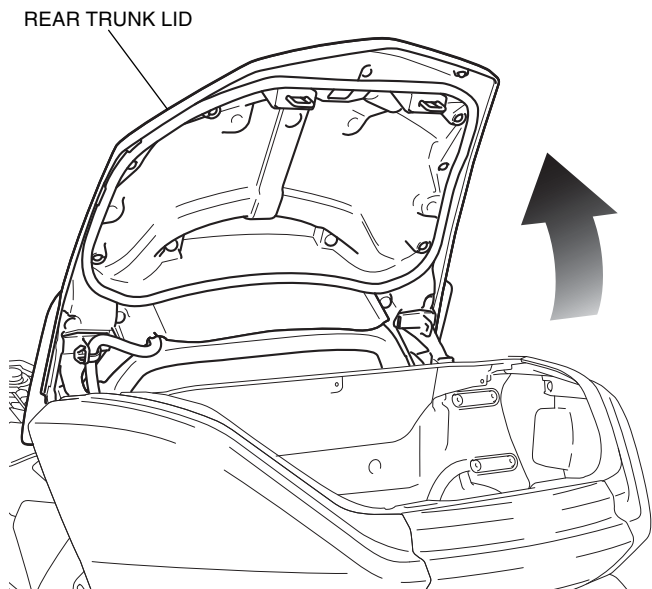

7. Remove the USB cord as shown.

- Perform this step on GL1800DA only.

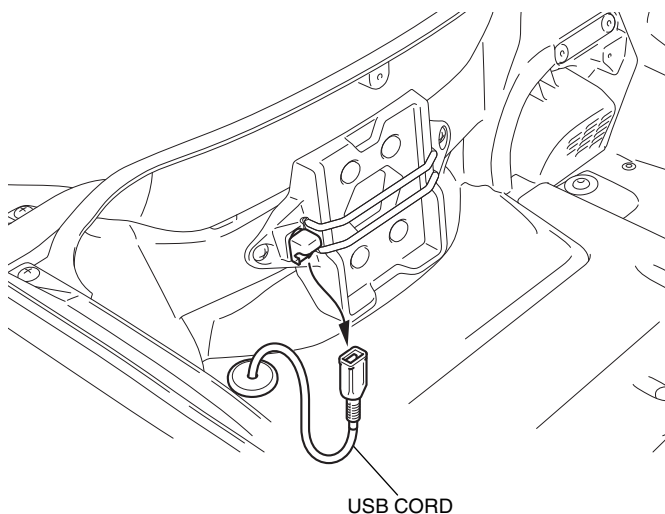

8. Remove the parts as shown.

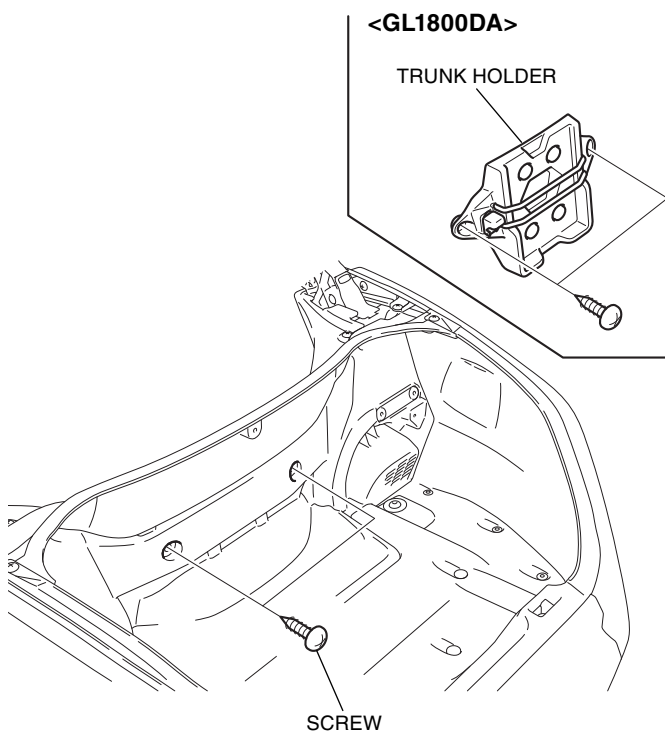

9. Remove the trunk front lower panel as shown.

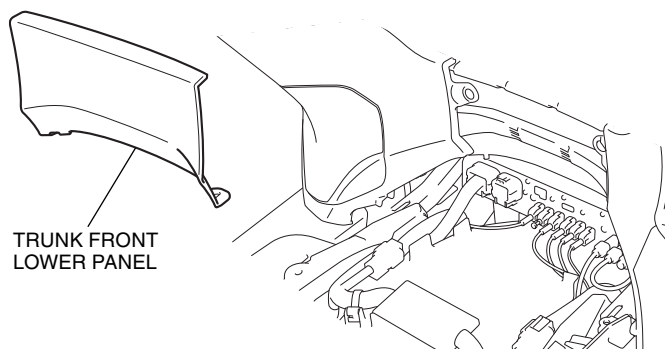

10. Remove the parts as shown.

- Repeat on the left side.

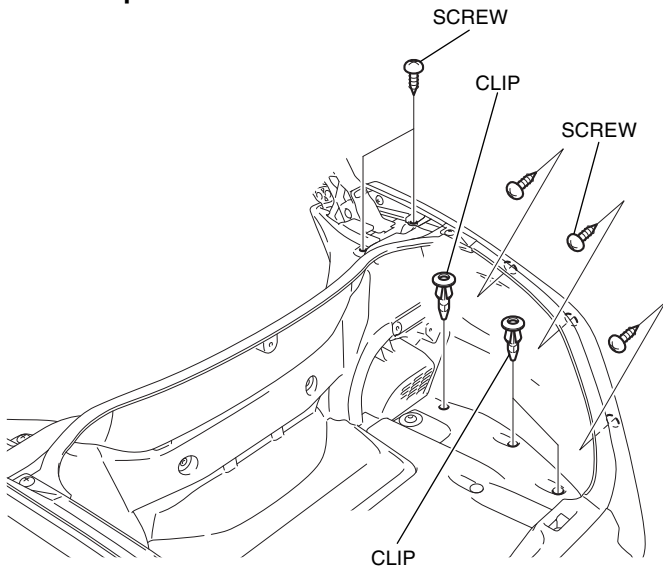

11. Remove the parts as shown.

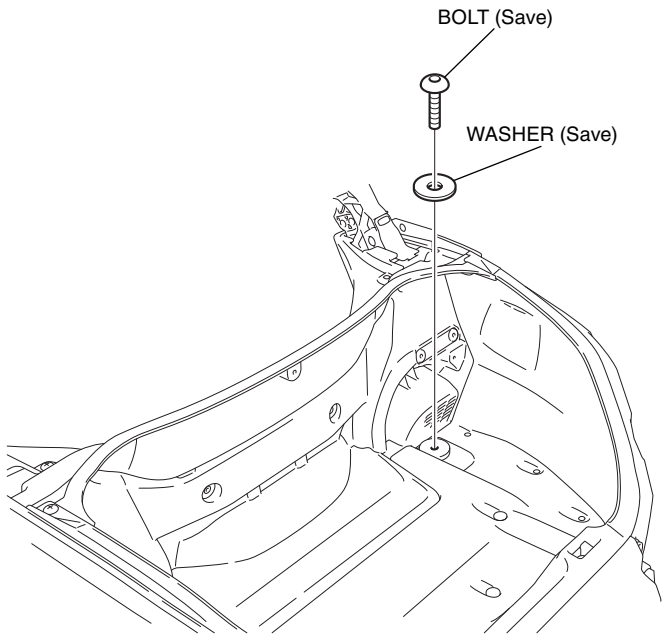

12. Remove the trunk right side cover as shown.

- Repeat on the left side.

<Right side>

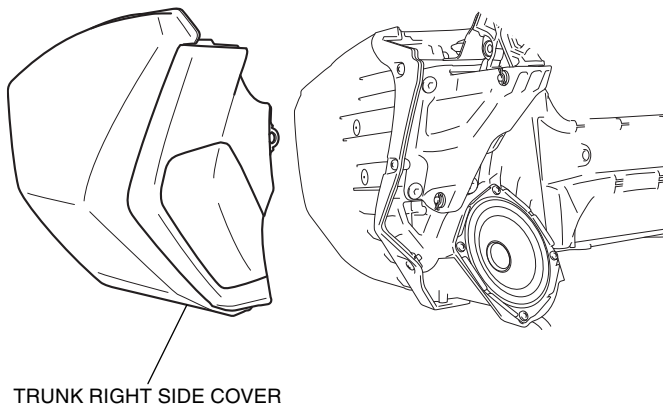

13. Remove the clips as shown.

- Repeat on the right side.

<Left side>

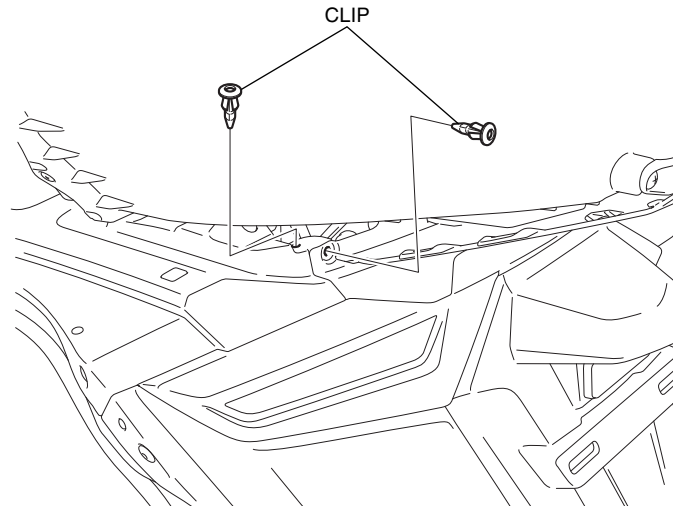

14. Disconnect the connector and remove the center trunk lower cover as shown.

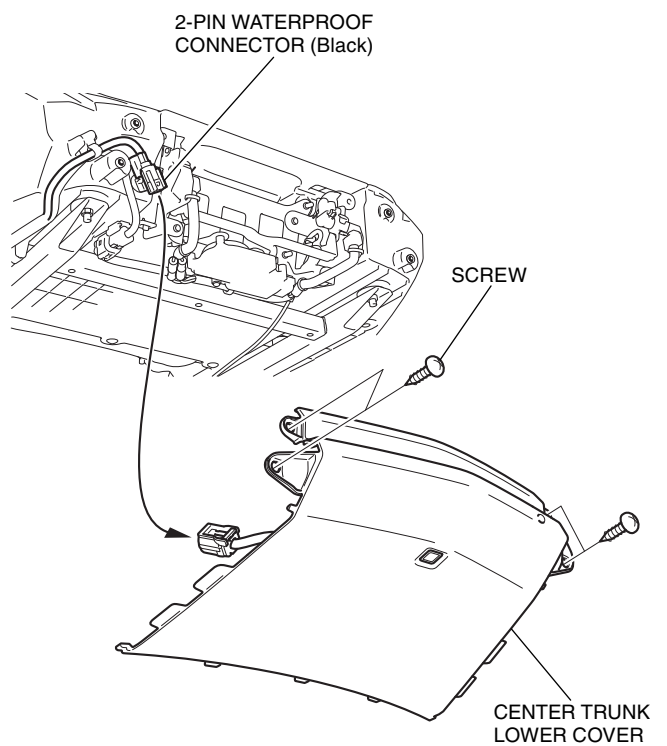

15. Remove the rear fender as shown.

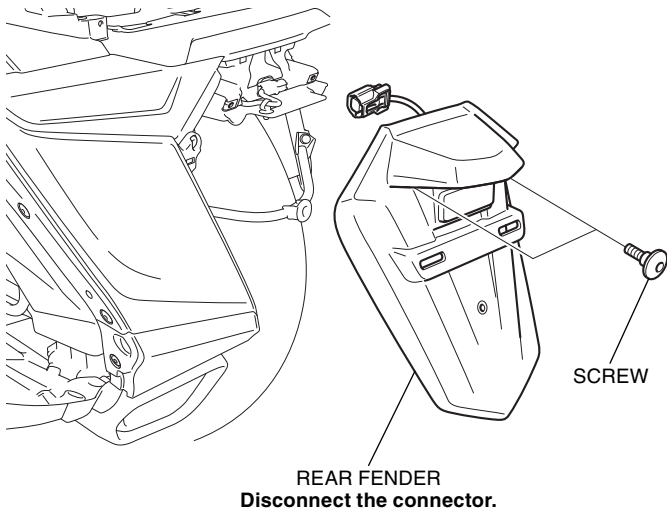

16. Remove the saddlebag rear center cowl as shown.

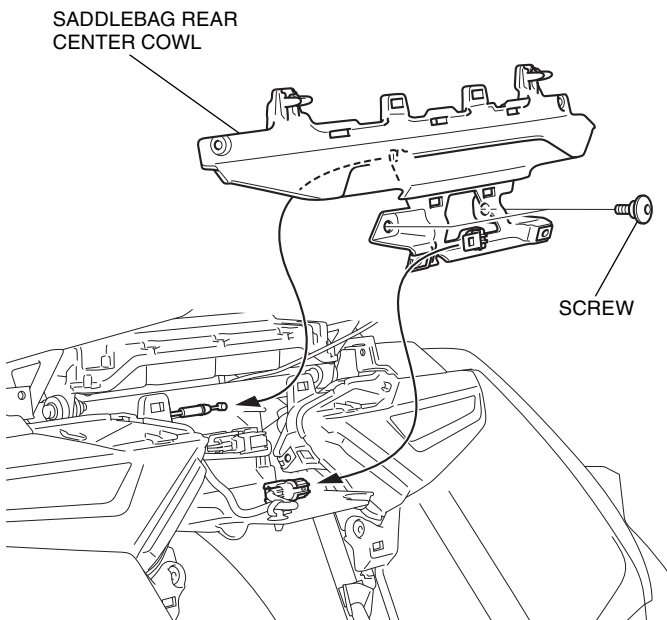

17. Remove the right saddlebag upper cover as shown.

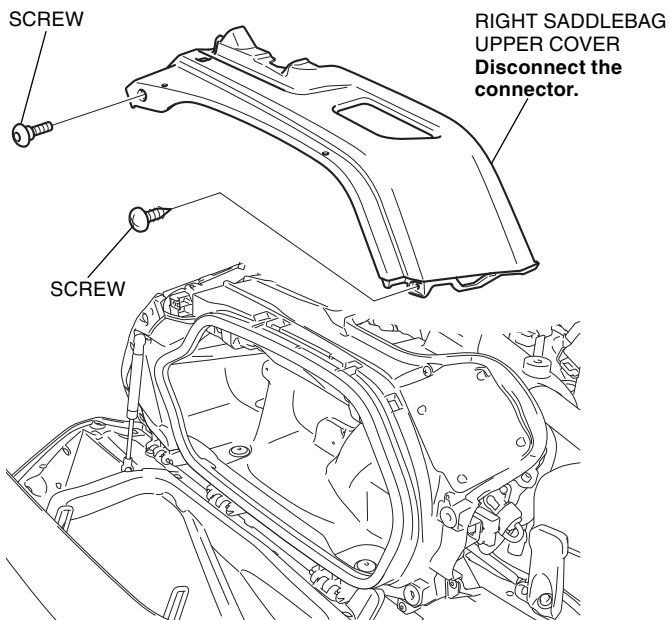

18. Remove the plugs as shown.

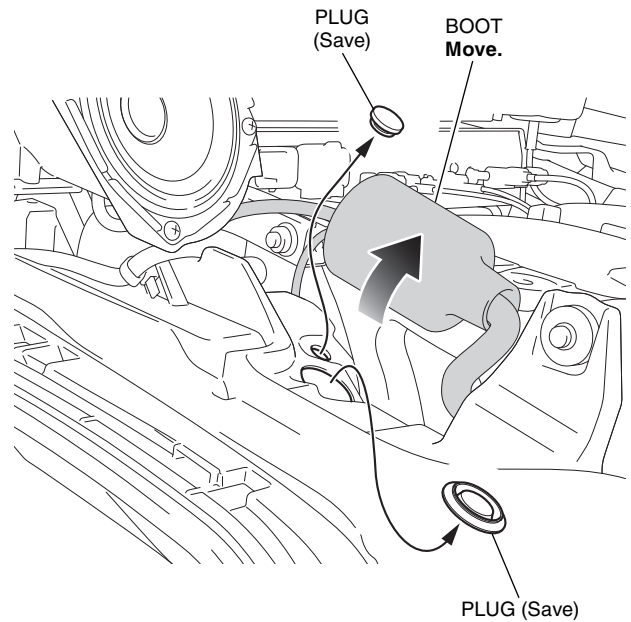

19. Loosely install the wire tie as shown.

<Right side>

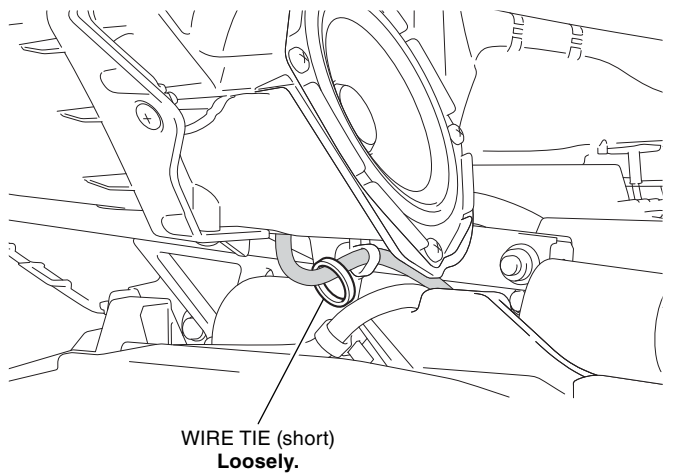

20. Clean the surface of the area shown with isopropyl alcohol.

<Right saddlebag inside>

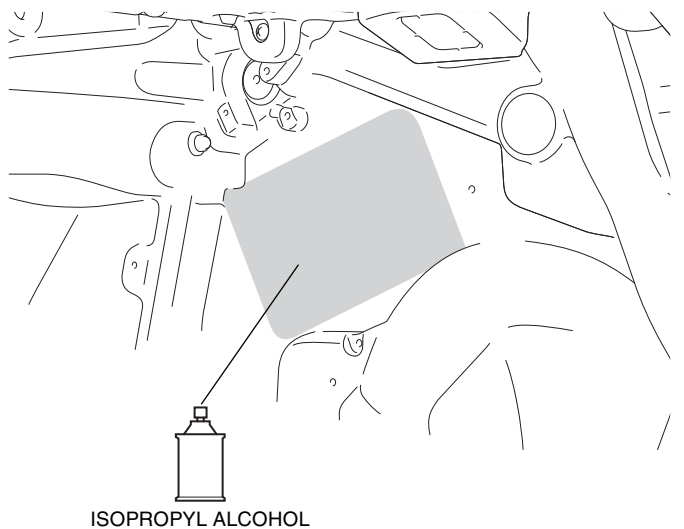

21. Attach the CB main unit as shown.

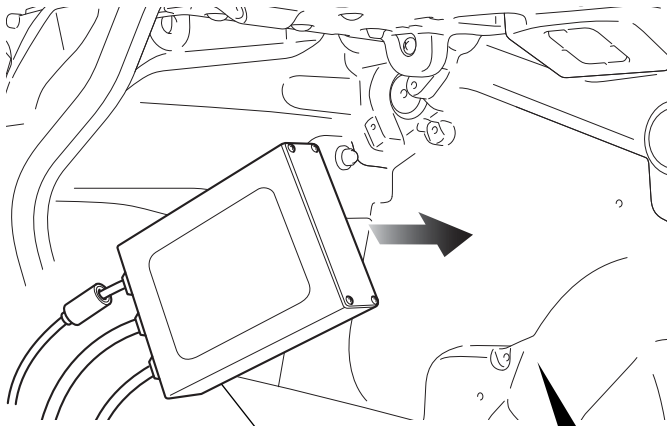

CB MAIN UNIT
Remove the adhesive
backing before attaching.

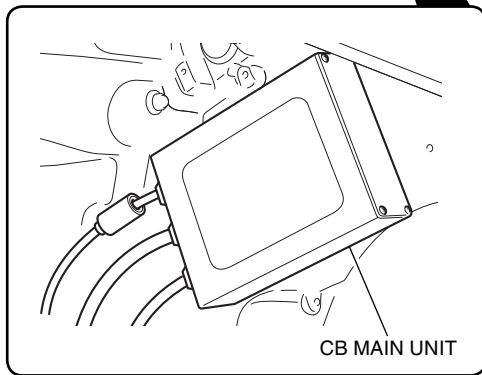

CB MAIN UNIT

22. Install the clips to the O-ring as shown.

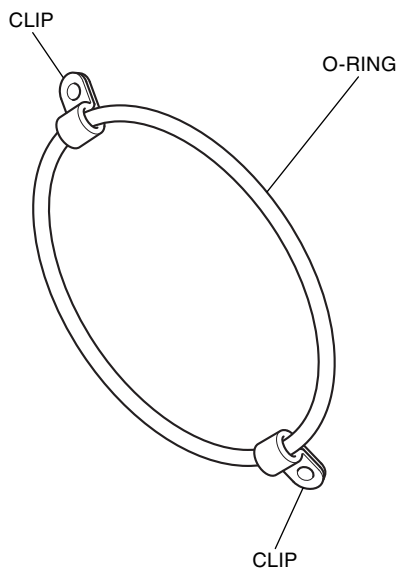

23. Install the clips with the 5 mm screws as shown.

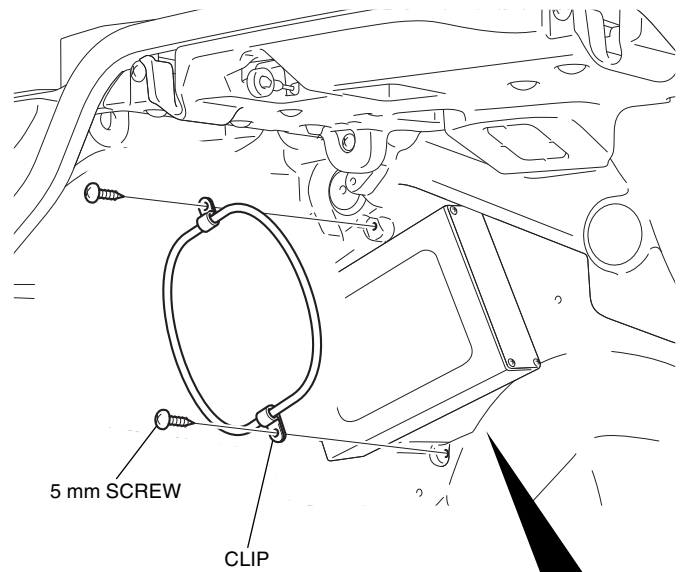

5 mm SCREW

CLIP

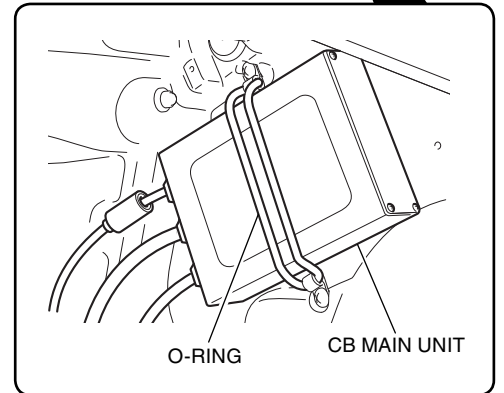

O-RING

CB MAIN UNIT

24. Install the clamp as shown.

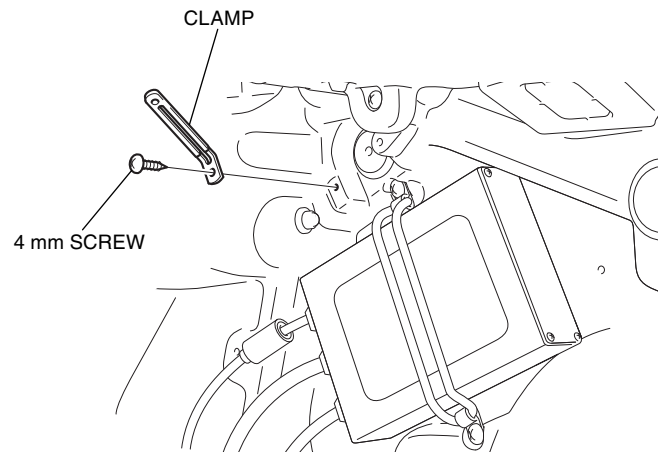

4 mm SCREW

CLAMP

25. Remove the screws as shown.

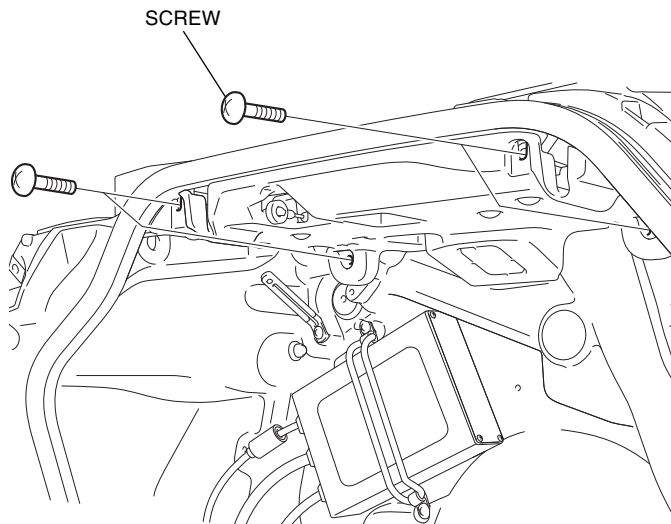

26. Remove the 12P Black connector as shown.

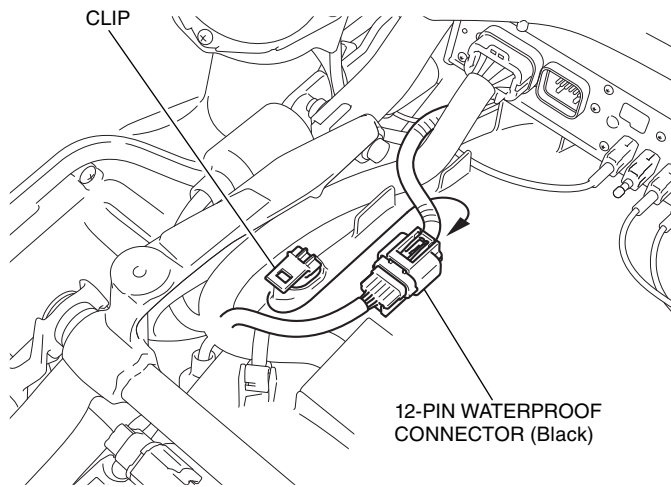

27. Route the CB radio sub harness as shown.

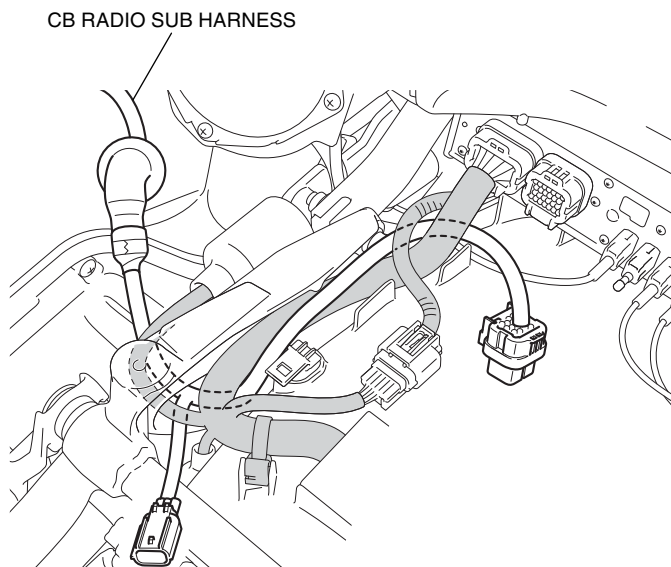

28. Apply dish soap solution to the position shown.

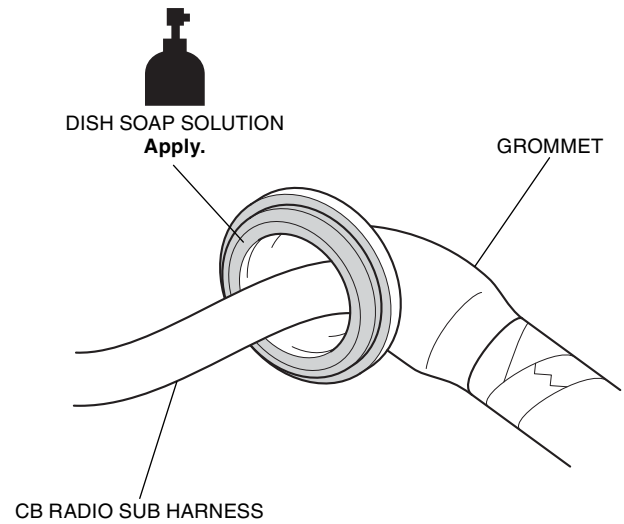

29. Route the CB radio sub harness as shown.

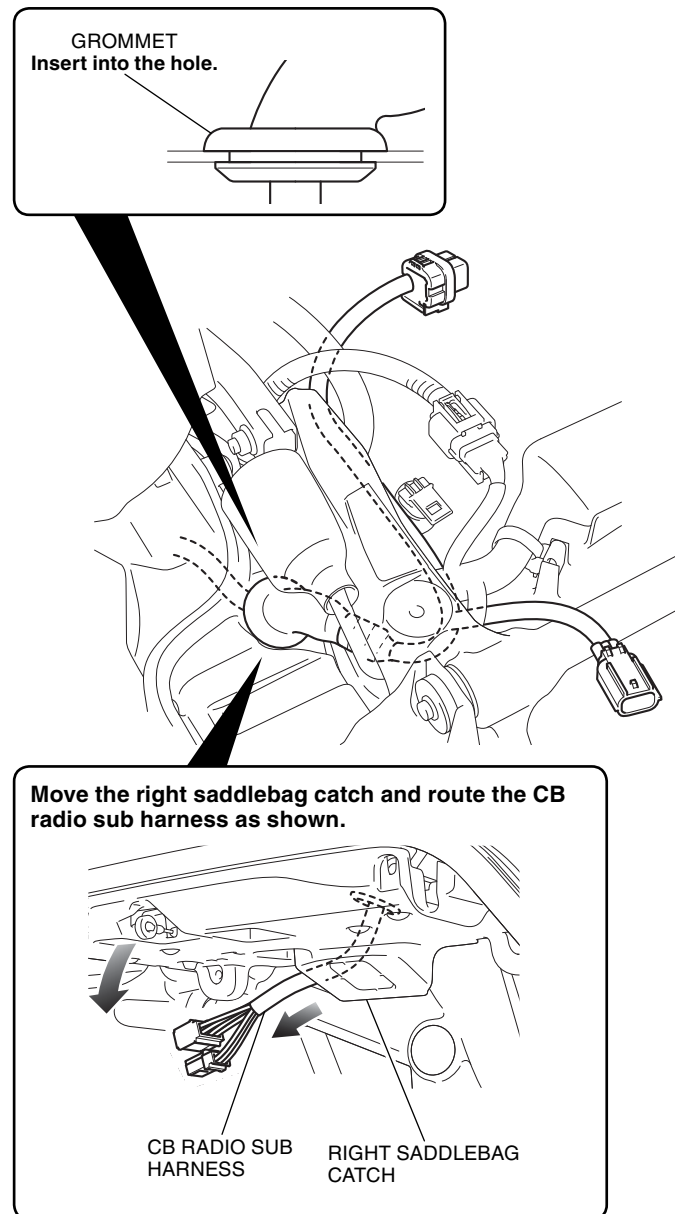

30. Connect the CB radio sub harness as shown.

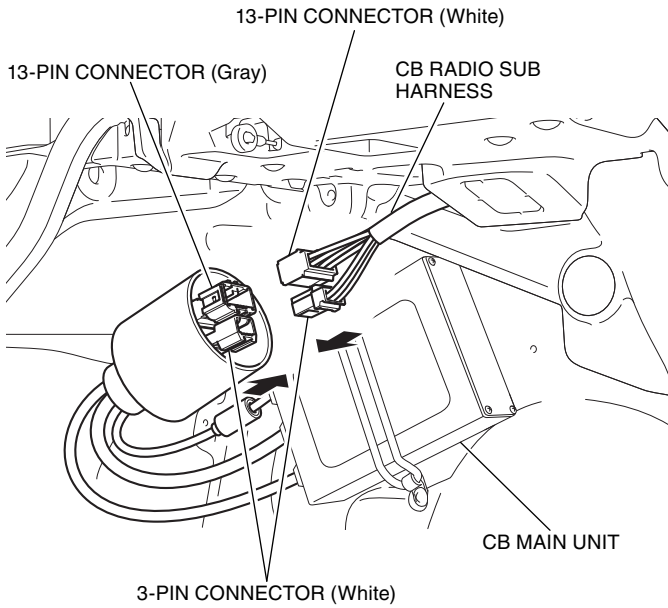

31. Install the right saddlebag upper cover in the reverse order of removal.

32. Drill a 16 mm hole at each marked point of the trunk inner box as shown.

- Remove the any burrs from the edge of the hole.

<Right side>

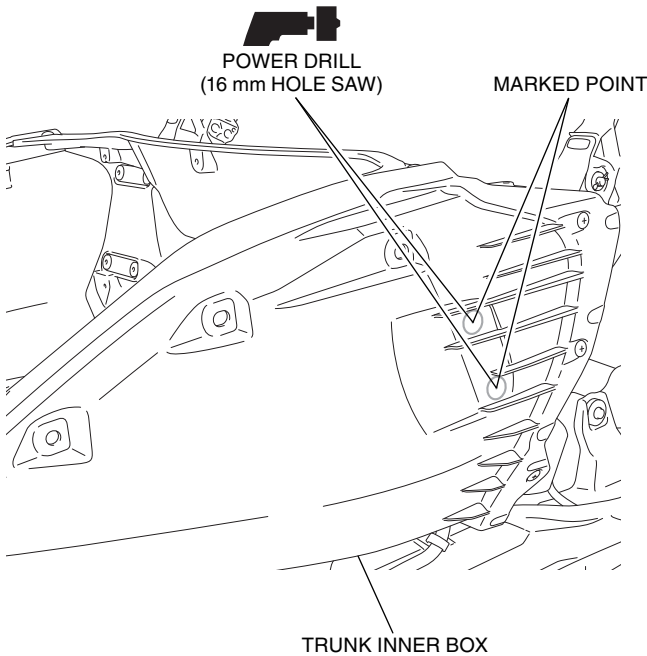

33. Drill a 14 mm hole at the two marked points of the right trunk side cover as shown.

- Remove the any burrs from the edge of the hole.

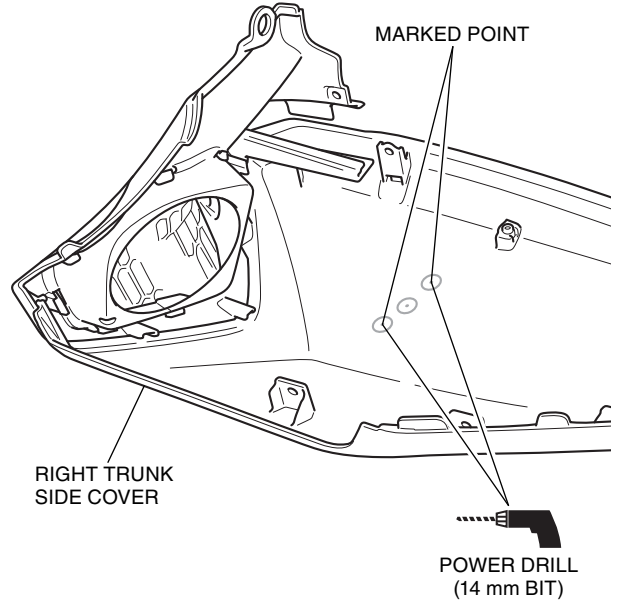

34. Drill an 18 mm hole at the marked point of the right trunk side cover as shown.

- Remove the any burrs from the edge of the hole.

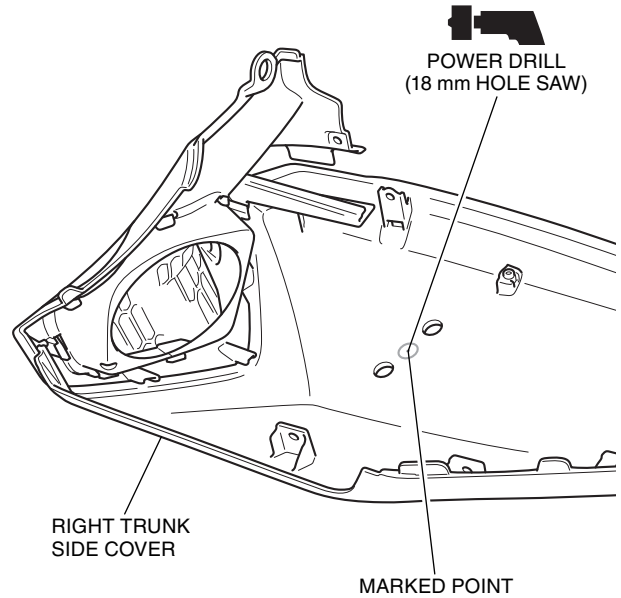

35. Clean the surface of the area shown with isopropyl alcohol.

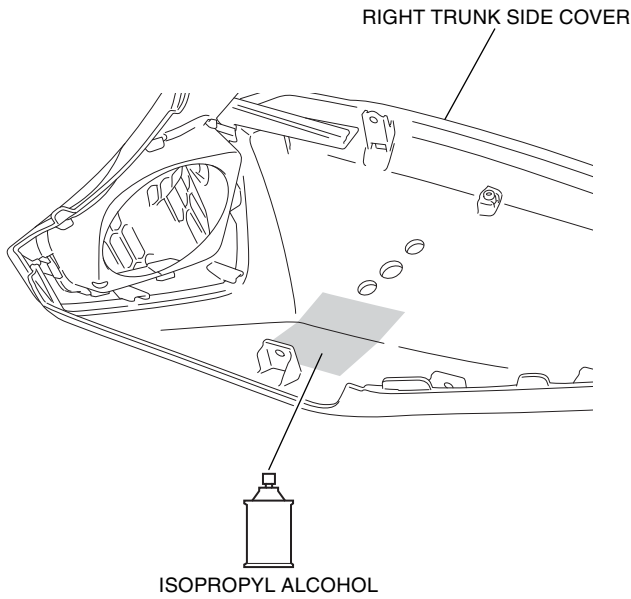

36. Route the CB antenna cord as shown.

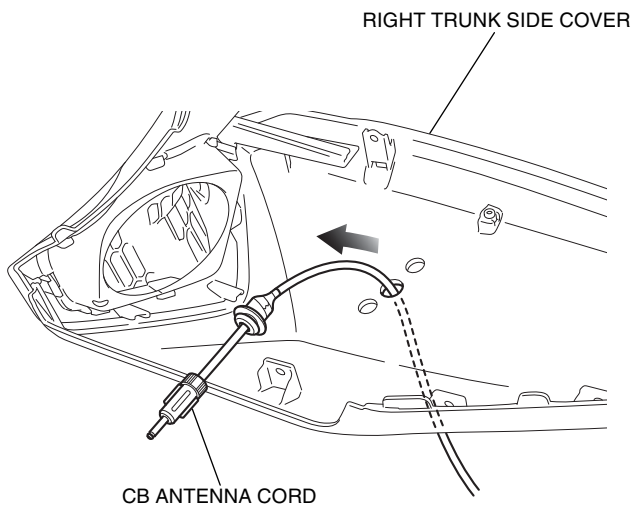

37. Cut the cushion to the dimensions shown.

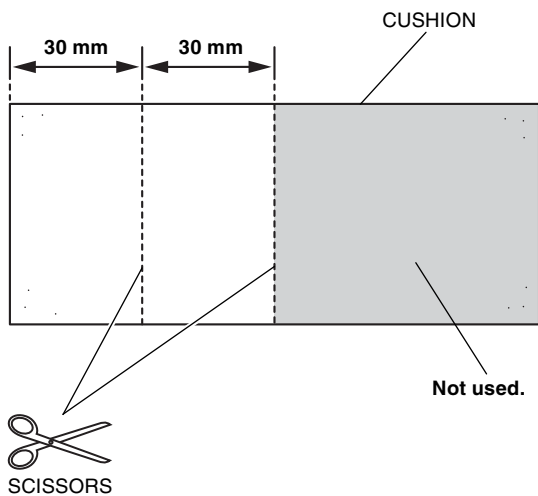

38. Attach the cut cushions as shown.

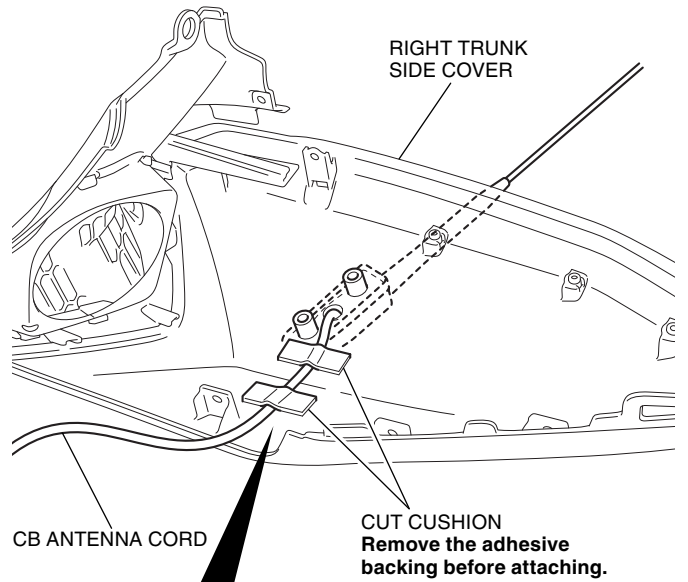

Align the cushion and CB antenna cord with the marked line.

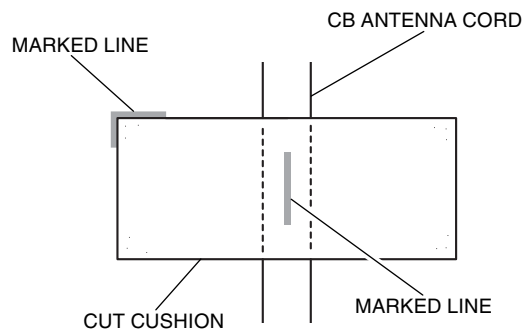

39. Route and secure the CB antenna cord, install the right trunk side cover in the reverse order of removal.

<Right side>

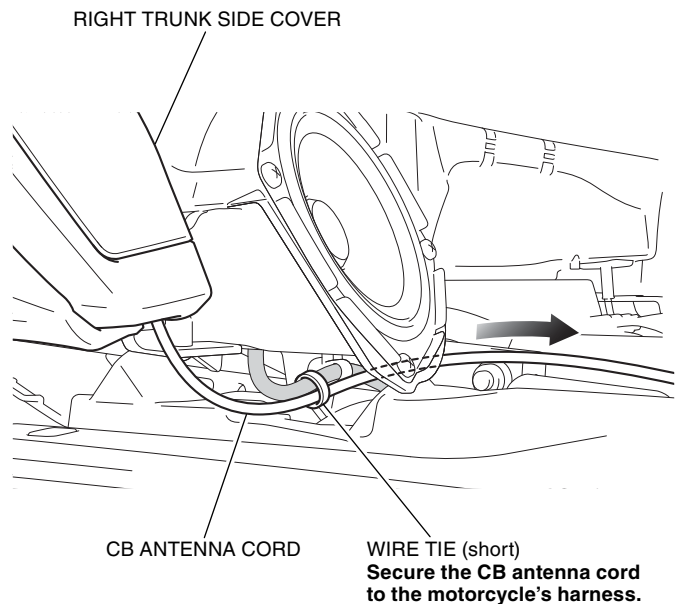

40. Apply Dish soap solution to the position shown.

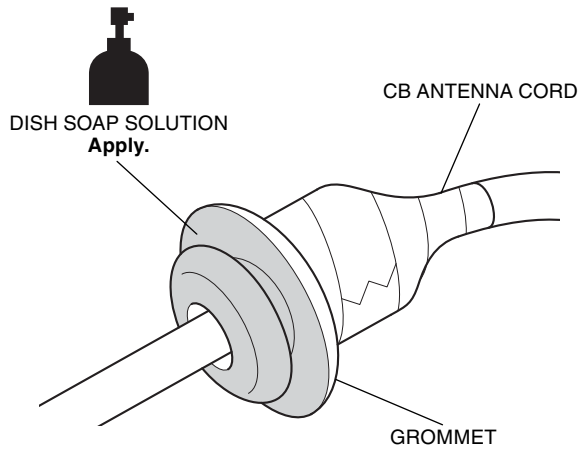

41. Route the CB antenna cord as shown.

- **Install the CB antenna cord, then return the boot to the original position.**

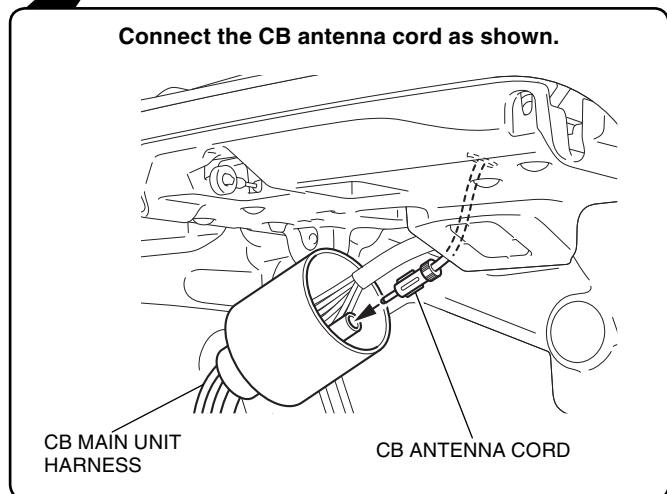
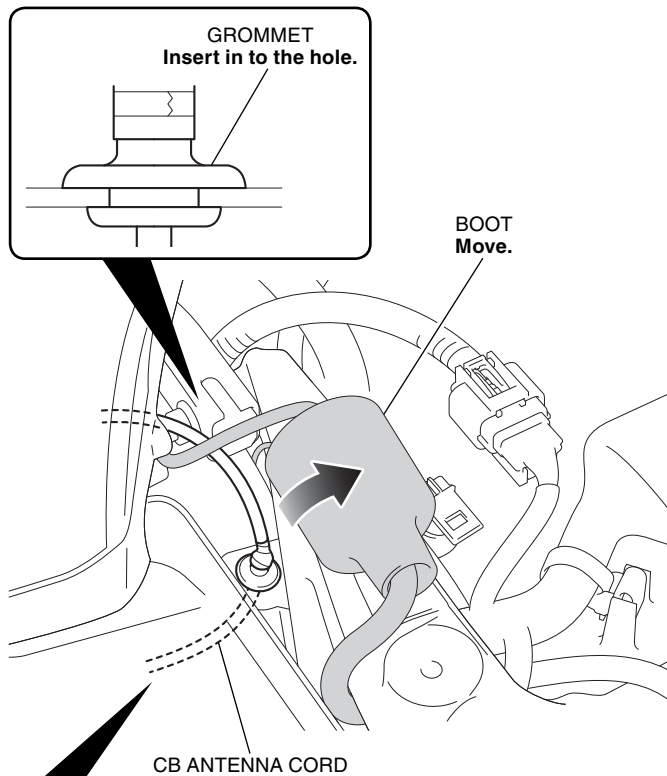

42. Install the CB antenna stay as shown.

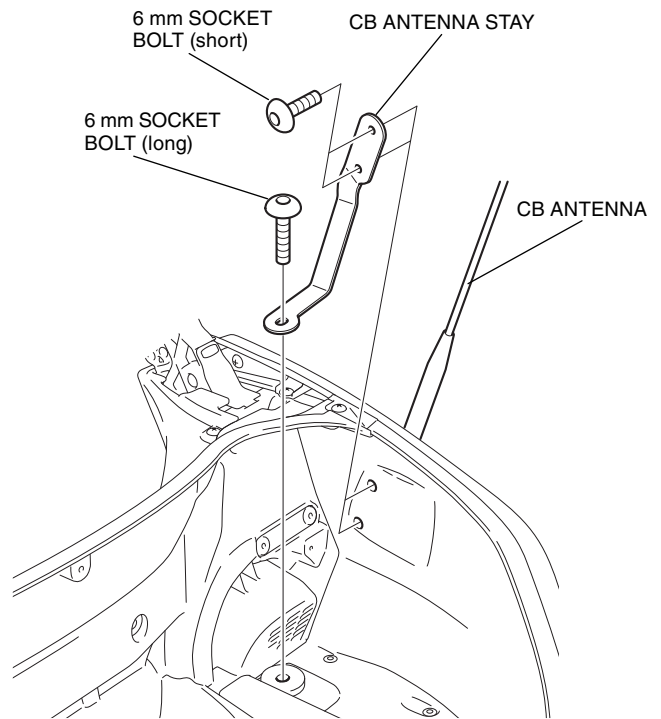

43. Secure the harness boot with the clamp as shown.

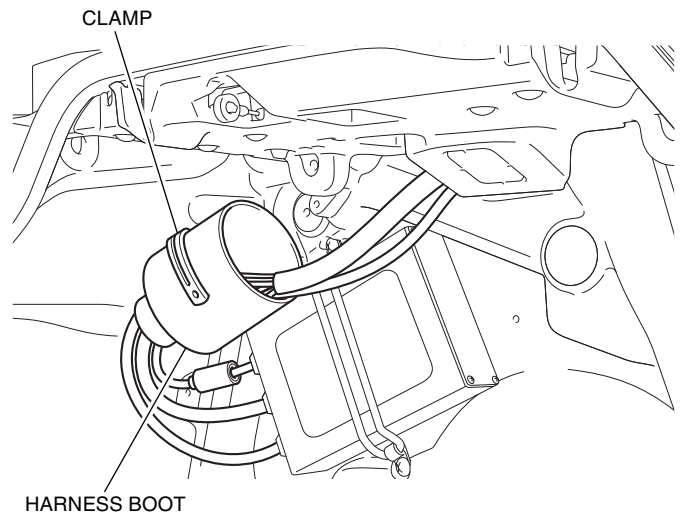

44. Install the right saddlebag catch in the reverse order of removal.

- **Confirm that any wire harness is not caught or too tight.**

45. Install the CB unit cover as shown.

- Confirm that any wire harness is not caught or too tight.

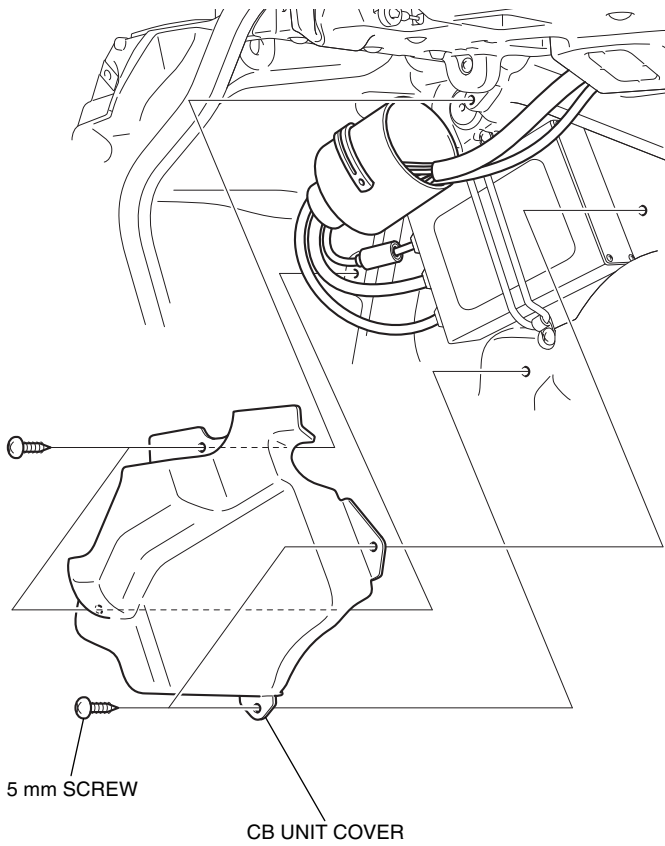

46. Move the boot and remove the dummy connector as shown.

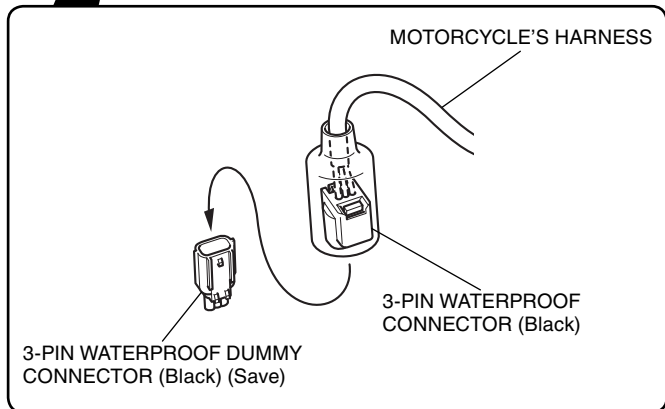
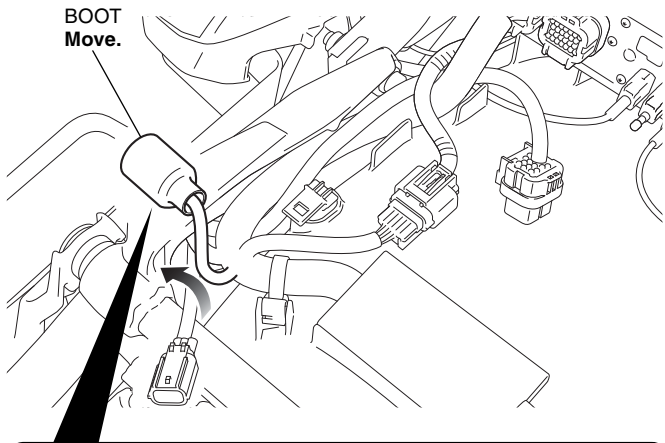

47. Connect the CB radio sub harness as shown.

- Set the boot to the original position.

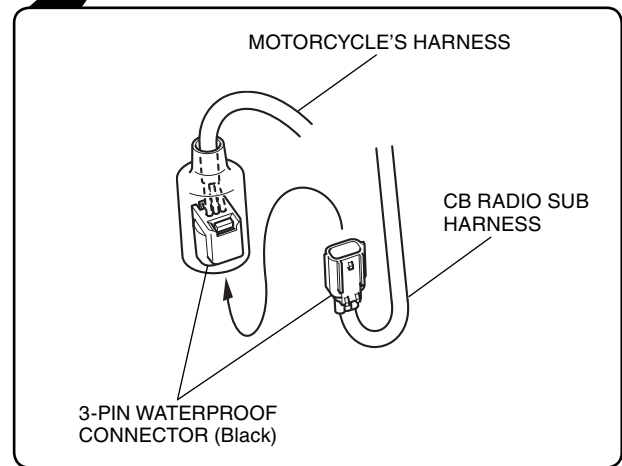
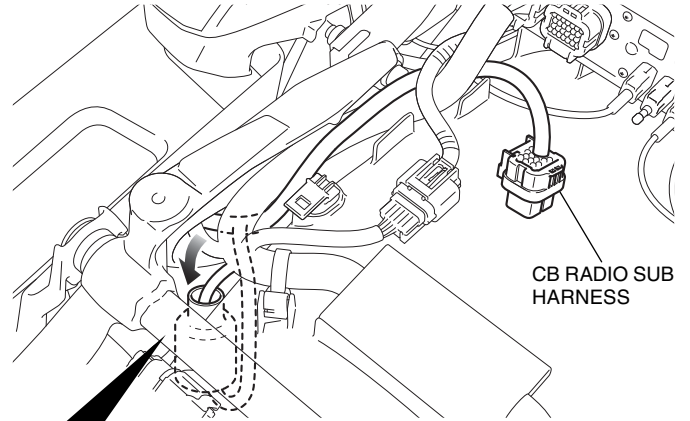

48. Remove the dummy connector as shown.

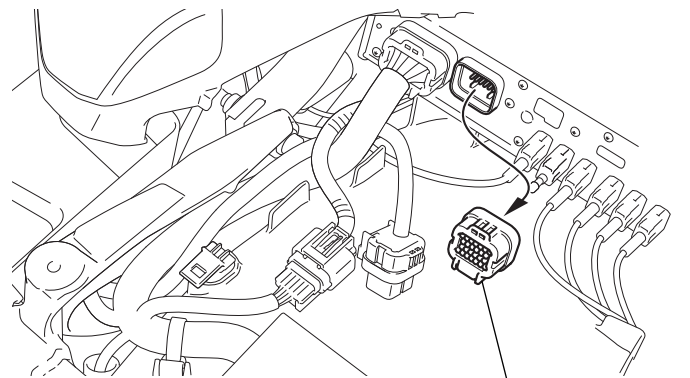

49. Connect the CB radio sub harness as shown.

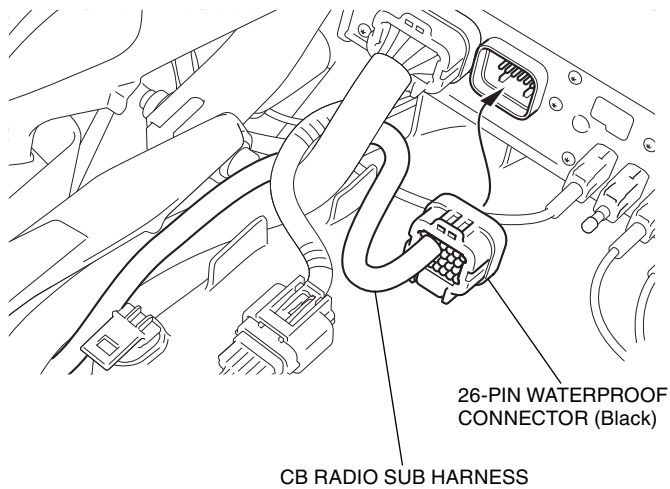

50. Secure the CB radio sub harness with the wire tie as shown.

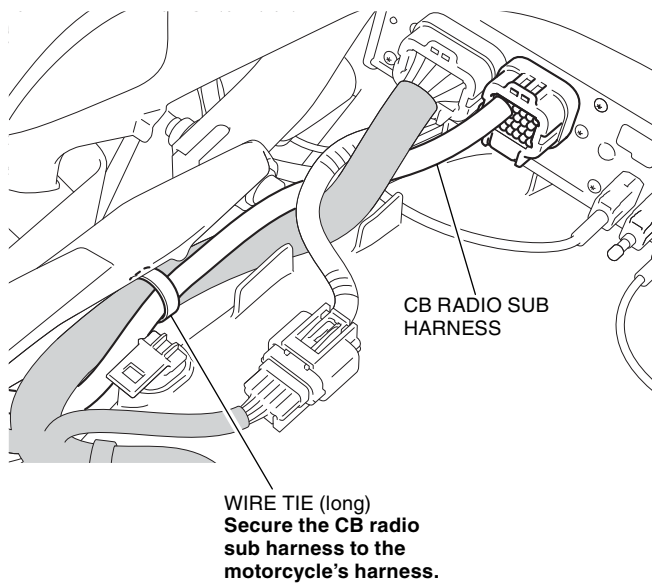

51. Install the connector to the clip.

52. Install the motorcycle's parts in the reverse order of removal.

- **Confirm that any wire harness is not caught or too tight.**

53. Check the CB radio, headlight and the other lights for proper operation.